

User Manual

Bluetooth Stereo Headset with Mic

Sacool Pro



www.avantree.com

1. Headset overview

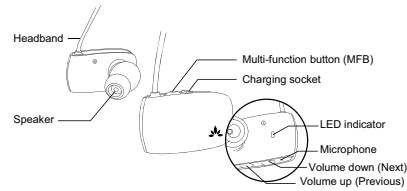

- 1 -

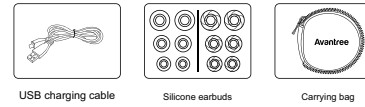

USB charging cable Silicone earbuds Carrying bag

NOTE: All accessories are also available on avantree.com

2. Connect

- Press and hold the MFB for 4 seconds-The LED flashes blue and you will hear: "power on".
- Press and hold the MFB for 4 seconds-The LED flashes red and you will hear: "power off".

- 2 -

2.1 Connect with mobile phone

- Ensure your Sacool Pro is off.
- Press and hold the MFB for about 7-10 seconds until LED indicator flashes BLUE and RED alternately and you will hear "pairing".

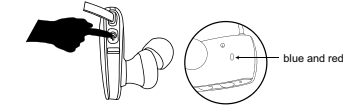

- Activate Bluetooth on your phone and select "Avantree Sacool Pro". When paired successfully, you will hear "connected".

Reconnect Bluetooth

- 3 -

Whenever you turn your Audition Pro on again, it will automatically reconnect to your phone. Otherwise, please press the MFB once to reconnect them.

2.2 Connect with PC/notebook

- Turn Sacool Pro off (press and hold MFB button for 4s).The LED indicator flashes red and you will hear "power off".
- Press and hold MFB button for 7-10s until LED indicator flashes blue and red alternately.
- Activate Bluetooth on your PC/notebook and select "Avantree Sacool Pro".

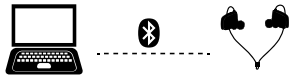

NOTE: Make sure the PC/notebook is Bluetooth-enabled and supports the A2DP

- 4 -

profile; otherwise you may need a separate Bluetooth dongle that supports this feature. For additional details on how to set up with a PC/notebook, please see support.avantree.com

2.3 Connect with two mobile phones simultaneously

- Pair your Sacool Pro with the first phone using the MFB as above.
- Repeat the process to pair your Sacool Pro to the second phone.
- Turn off and turn on your Sacool Pro. Your Sacool Pro will now automatically connect with either or both of the two paired phones when in range.
- Audio priority is given to the second phone. To switch, manually connect or disconnect from the Audition Pro via Bluetooth settings on the first or second phone.

3. How to wear the Sacool Pro

- Hold the headset as shown, with the button side in your left hand.

- 5 -

- Put the earbuds in your ears, with the cord over the ears and to back of your head.
- Adjust position of earbuds in your ears for maximum comfort.
- Adjust length of cable using the silicone piece to make the headset secure.

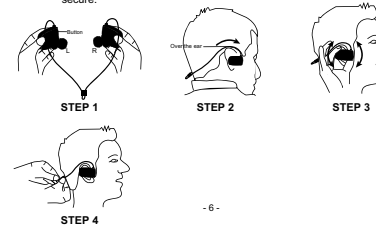

- 6 -

NOTE: Make sure your phone is in an armband / pocket / handbag on the left of your body. Otherwise, disconnection might be caused by your body blocking the Bluetooth signal.

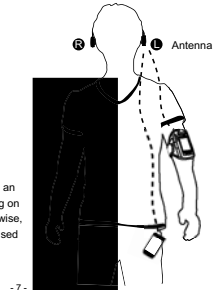

- 7 -

4. How to use

⏻	On/Off	Press and hold MFB 4 seconds
	Answer a call	Press MFB once
	End a call	Press MFB once
	Reject a call	Double click MFB
↻	Redial last number	Double click MFB
	"V+" and "V-"	Voice Dial / Command Short press "V+" and "V-"
⏻	Play music	Press MFB once
	Pause music	Press MFB once
V +	Volume up	Press "V+" once
V -	Volume down	Press "V-" once
V +	Previous track	Press and hold "V+"
V -	Next track	Press and hold "V-"

- 8 -

5. How to charge

When the LED blinks red, you should recharge your headphones. Remove the Micro USB port protector and charge the headphones via the supplied Micro USB cable. It normally takes about 2 hours to fully charge the battery. The LED will stay red when charging and will turn off when charging is complete.

Charging requirement: You can plug our supplied Micro USB cable to your own USB chargers (wall charger/travel charger/car charger, etc) with ==5V/500mA-2A or to a PC/Mac USB port. It is OK to use most mobile phone chargers on the market.

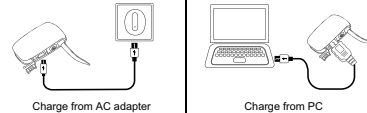

Charge from AC adapter

Charge from PC

6. Product specifications

Bluetooth version: 4.0
Support profiles: Headset, Handsfree, A2DP, AVRCP
Operational range: Class 2, 10 metres (33 feet)
Battery: rechargeable lithium battery
Talk time: up to 8.5 hrs
Music time: up to 8 hrs
Standby time: up to 80 hrs
Headset weight: 16g
Headset size: 36.2mm(L)x21.2mm(H)x29.7mm(W)

NOTE: The talk and standby times may vary when used with different mobile phones or other compatible Bluetooth devices and are also dependant on different usage styles, settings and operating environment.

Dispose of the packaging and this product in accordance with the latest provisions.



FCC ID: WJ5-ASBP

FCC Warning Statements

This equipment has been tested and found to comply with the limits for a Class B digital device, pursuant to part 15 of the FCC Rules.

These limits are designed to provide reasonable protection against harmful interference in a residential installation. This equipment generates,

uses and can radiate radio frequency energy and, if not installed and used in accordance with the instructions, may cause harmful interference

to radio communications. However, there is no guarantee that interference will not occur in a particular installation. If this equipment does

cause harmful interference to radio or television reception, which can be determined by turning the equipment off and on, the user is

encouraged to try to correct the interference by one or more of the following measures:

- Reorient or relocate the receiving antenna.
- Increase the separation between the equipment and receiver.
- Connect the equipment into an outlet on a circuit different from that to which the receiver is connected.
- Consult the dealer or an experienced radio/TV technician for help.

This device complies with part 15 of the FCC Rules. Operation is subject to the following two conditions:

- (1) This device may not cause harmful interference, and
- (2) this device must accept any interference received, including interference that may cause undesired operation.

changes or modifications not expressly approved by the party responsible for compliance could void the user's authority to operate the equipment.

FCC RF warning statement:

The device has been evaluated to meet general RF exposure requirement , The device can be used in portable exposure condition without restriction.