

ATTENTION

This manual explains how to safely operate the Camera Goggle.
Please read these instructions carefully before using the camera.

Keep this manual in a safe place for later reference

Disclaimer

While every effort has been made to ensure that the information contained in the guide is accurate and complete, no liability can be accepted for any errors or omissions. Liquid Image Co reserves the right to change the specifications of the hardware and software described herein at any time without prior notice.

Liquid Image Co declines all responsibility for damages due to improper use of this product, failure to adhere to the instructions given in this manual, or modifications to the CAMERA GOGGLE.

Cautions concerning data storage: Stored data may be lost or corrupted. It is recommended that any important data be copied onto a separate media (such as a hard disk, DVD-R or CD-R disk). Liquid Image Co makes no warranties and shall not be held responsible for damages resulting from corrupted or lost data due to a malfunction of the camera, the software, the memory cards, personal computer, peripheral devices, or for any losses that result from images that could not be recorded, are erased, destroyed, or damaged in any way due to a problem or a mistake while utilizing the camera or any of its accessories.

The Camera Goggle is a sophisticated electronic device and should be supervised by an adult at all times. This product should not be used by children under 13 years. This product is not a toy. The inserting of memory cards, USB cable, and battery must be performed by an adult 18 years or older who has read and understands this manual. An adult must always check all water resistant compartments prior to each use.

Products mentioned above or throughout the manual may be trademarks or registered trademarks of their respective companies.

CONTENTS

1.0 Get to know your CAMERA GOGGLE™	
1.1 Features	ENG- 2
1.2 Specifications	ENG- 2
1.3 System requirements	ENG- 2
2.0 Functional Parts	
2.1 Included Parts and Accessories	ENG- 3
2.2 Part Names - Front View	ENG- 4
2.3 Part Names - Back View	ENG- 4
2.4 Part Names - Ports and LCD Screen	ENG- 5
2.5 Part Names - Battery Compartment	ENG- 6
2.6 Replace Goggle Strap	ENG- 6
2.7 Replace Face Foam and Rotate Lens	ENG- 7
3.0 Camera Goggle Setup	
3.1 Recharging or Replacing the Li-ion Battery	ENG- 8
3.2 Inserting Micro SD/SDHC Memory Card	ENG- 8
3.3 Setting the Date and Time Mode	ENG- 9
4.0 Recording Pictures and Video	
4.1 720P Video Mode	ENG-10
4.2 1080P Video Mode	ENG-10
4.3 Still Image Photo Mode	ENG-11
4.4 Continuous Photo Mode	ENG-11
4.5 Power Off	ENG-11
5.0 Transferring Still Images and Video to a Computer	
5.1 Opening Memory Compartment	ENG-12
5.2 Connecting and Transferring Files	ENG-12
5.3 Disconnecting and Closing Memory Compartment	ENG-13
6.0 Viewing Videos and Still Images on TV	
6.1 Setting Correct NTSC/PAL Mode for your TV	ENG-14
6.2 Video and Still Image Playback on a TV	ENG-15
7.0 Video and Image File Size	ENG-15
8.0 WiFi Capabilities and Use with other WiFi Devices	ENG-16
9.0 Firmware and Product Updates	ENG-17
10.0 Care and Maintenance	ENG-17
11.0 Replacing Lenses	
10.1 Removing the Lens	ENG-18
10.2 Inserting the Lens	ENG-18
12.0 Camera Warnings and Precautions	ENG-18
13.0 Battery Warning and Precautions	ENG-20
14.0 Commonly Asked Questions and Troubleshooting	ENG-20

1.0 GET TO KNOW YOUR CAMERA GOGGLE**1.1 Features**

Video Clips, Still Images, Micro SD/SDHC Card support
Driver free for Windows XP/Vista/7 and Mac 9.x or above

1.2 Specifications - Subject to change without notice

Sensor	1/2.5" 5.0MP CMOS Sensor
Image Resolution *	12.0 Megapixels (4000x3000)
Lens	F/3.2 f=2.75mm (135 Degree FOV)
Focus range	.4m to infinity
Internal Memory	256MB NAND Flash Memory for CPU only
External Memory Card	Micro SD/SDHC Card supports up to 32GB Must be Class 6 and above
Video Mode **	30FPS@HD 1080P (1920X1080) with Audio 60FPS@HD 720P (1280x720) with Audio
File Format	Picture: JPEG, Video: H.264 MOV with Audio
Status Display	LCD Display
PC Interface	USB
TV Output	PAL and NTSC
Power	3.7V Lithium Rechargeable Battery 1150mAh
Auto Off System time	180 seconds
WiFi - Wireless	Apps for Android and iOS systems

* Quantity of pixels is only an approximate number ** Approximate frames per second

1.2 System Requirements ***

Operating System	Windows® XP (SP2 or higher) ,Vista™, Windows® 7 or Mac 9.x
CPU	Intel® Core™ 2 Duo CPU E6300 processor (or above), AMD Athlon 64 X2 3800+ (or above)
RAM	1GB RAM (2GB recommended for editing HD videos)
Memory	300 MB available hard disk space
Graphics Card	256 MB Graphics Card or above is recommended

*** No Software required to download files

Please note before use

1. Check if the Micro SD card of this equipment was installed properly.
2. Check if the memory card has enough free space.
3. The lithium battery must be fully charged before the first use. You can either use the supplied USB cable and charge it with your computer, or use a wall charger (sold separately)
4. A Liquid Image charging cable must be used to avoid damage to the camera.

2.0 Functional Parts

2.1 Included Parts and Accessories

Please check the contents now (before use) to confirm that it is complete.
Contact your Liquid Image Co dealer if anything is missing.

- USER MANUAL
- CAMERA GOGGLE™
- USB CABLE
- WARRANTY
- MICRO FIBER STORAGE BAG
- RECHARGEABLE LI-ION BATTERY 3.7V 1150mAh
- MX LENS
- EXTRA STRAP
- TEAR SHEETS
- TEAR SHEET STRAP CLIP
- NOSE GUARD
- REPLACEMENT FACE FOAM
- HEX ALLEN WRENCH

NOTE: The CAMERA GOGGLE will be referred to as the "CAMERA GOGGLE" throughout this instruction manual.

"If the product is exposed to a strong electrostatic charge, its memory contents may be damaged or the keys may stop working. In such case, reinstall battery to clear the memory and restore normal key operation."

WARNING: NEVER OPEN THE CAMERA BODY THAT IS FACTORY SEALED WITH SCREWS. THIS WILL VOID ANY WARRANTY. NEVER USE A SCREW DRIVER TO OPEN ANY PORTION OF THE CAMERA GOGGLE.

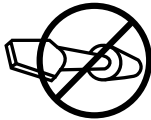

ENG-3

2.2 Part Names - Front View

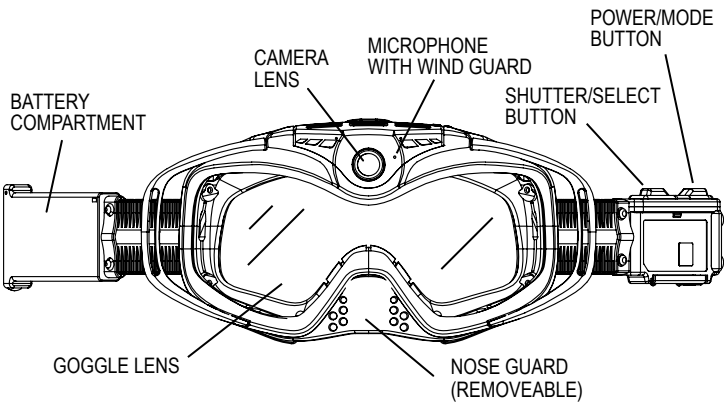

2.3 Part Names - Back View

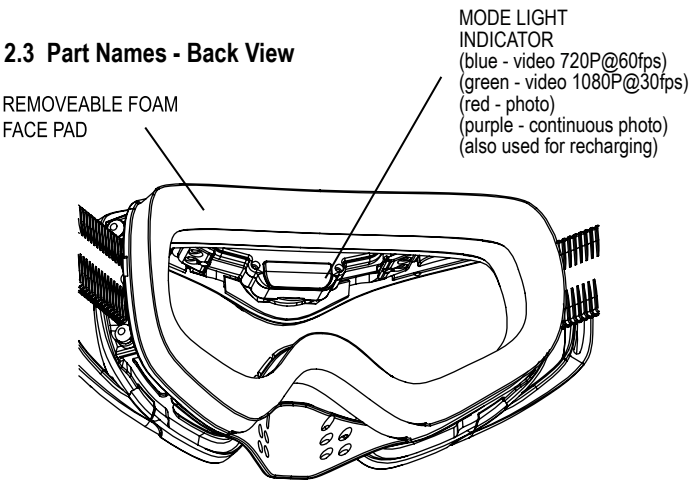

ENG-4

2.4 Part Names - Ports and LCD Screen

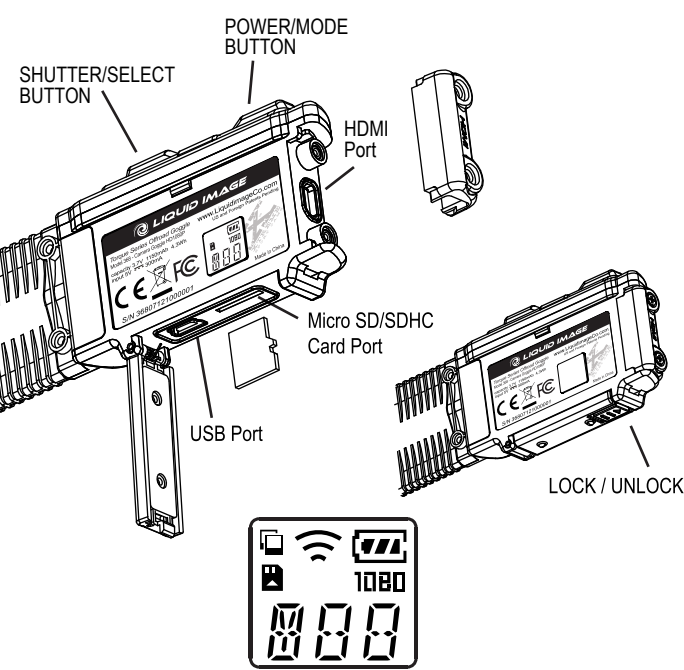

	Battery	shows the battery level
	Photo mode	Photo mode or
	WiFi	WiFi - when flashing, the WiFi is in standby mode When Solid, WiFi is turned on and ready
	SD card	Icon flashes continuously when no SD card is recognized
720	720 mode	720p@60 Frames per second mode
1080	1080 mode	1080p@30 frames per second mode

ENG-5

2.5 Part Names - Battery Compartment

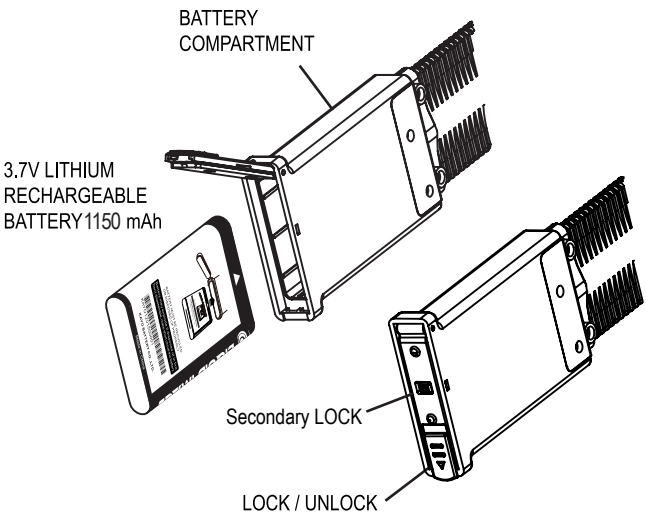

2.6 Replace Goggle Strap

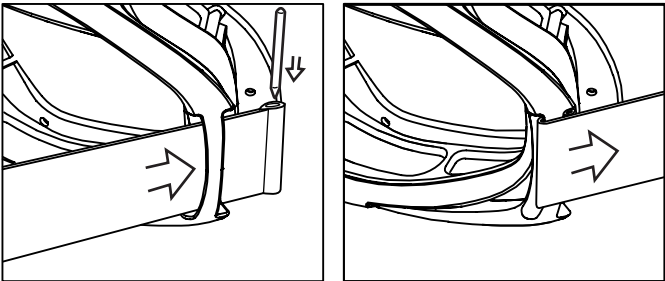

ENG-6

2.7 Replace Face Foam and Rotate Camera Lens

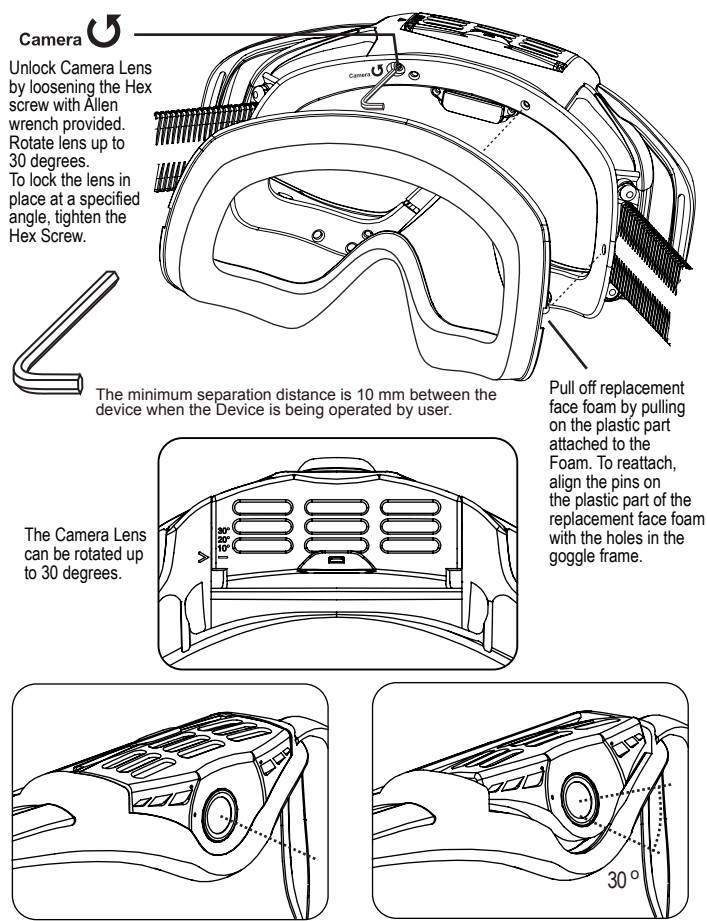

your CAMERA GOGGLE. This CAMERA GOGGLE works with both a Micro SD card or a Micro SDHC card up to 32 GB (Class 6+). Carefully read the instructions and warnings that come with the card. If your card is not FAT16 formatted, it will be reformatted once placed into the Micro SD/SDHC card slot on your CAMERA GOGGLE and the Power is turned on. Please note that any data on the card will be lost. Make sure to back up any data on the Micro SD/SDHC Card prior to inserting into the CAMERA GOGGLE.

NOTE: The CAMERA GOGGLE does not have internal memory to store the images and videos taken by the CAMERA GOGGLE. You must insert a Micro SD/SDHC card prior to taking images and videos. 4GB+ Micro SDHC Class 6+ is recommended for peak performance.

3.3 Setting the Date and Time Mode

This feature allows you to set the Date and Time to the photo or video file.

1. Press and hold the SHUTTER/SELECT button down. Press and hold POWER/MODE button for 2 seconds to turn on camera.
2. Continue holding the SHUTTER/SELECT button down and press the POWER/MODE button 3 times continuously and then release the SHUTTER/SELECT button. The LCD screen will access the Time Setting mode. You will be able to change Year (YY), Month (MM), Day (DD), Hour (hh), and Minute (mm). The first window will be YY for Year. Press the SHUTTER/SELECT button and the numbers will appear (eg. "12", means year 2012). The first number "1" in the year will start blinking.
3. Press the POWER/MODE button to change the blinking character from 0-9. Press the SHUTTER/SELECT button to select the number and move onto the next number "0". The setting process is from the left to right and will go through the different settings from Year, Month, Day, Hour, and minute. Once the number is confirmed by pressing the SHUTTER/SELECT button, the next digit will start blinking. Once you see the letters again such as MM for Month, press the SHUTTER/SELECT button to move to the numbers representing the month. Continue the process until you return to YY.
4. To get out of the Date and Time Setting Mode, press and hold the SHUTTER/SELECT button for 2 seconds. The GOGGLE will return to the Video mode (BLUE LED).
5. In case the battery needs to be replaced or the battery runs out, the date setting data will be maintained for 5 hours.

ENG-9

Approximate File Storage

Micro SDHC Card 32GB
Images: 20,000
Video: 354 minutes

3.0 CAMERA GOGGLE SETUP

CAUTION: An adult 18 years or older should perform this function. Always make sure the CAMERA GOGGLE is completely dry before performing these steps. Set up should always take place in a clean dry space with a controlled environment. These steps should be performed indoors to avoid exposure to the elements.

3.1 Recharging or Replacing Li-Ion Battery

Only use a Liquid Image Rechargeable 3.7V 1150mAh Lithium Battery with the CAMERA GOGGLE.

NOTE: The LCD indicator shows battery life. When no remaining bars are displayed, the battery is low and the LCD screen will show the word "LO" and will make a beeping sound. Recharge or replace battery to continue using. Files on the Micro SD/SDHC card will not be lost if battery power runs out or during replacement of the battery.

To Recharge Battery:

- 1) Open MEMORY COMPARTMENT door.
- 2) Plug USB CABLE into both the USB Port on the CAMERA GOGGLE and the Computer. The battery will start charging and the RED LED will start blinking. When the charge is complete, the RED LED will stop blinking and will switch to a solid GREEN LED light.

To insert or replace battery:

1. Unlock and Slide Battery Compartment door forward and then down to open.
2. Insert the Battery as shown on page ENG-6. Notches on the battery will only allow you to put the battery in one direction.
3. Close the BATTERY COMPARTMENT door carefully.

Estimated Battery life for a new 1150 mAh Rechargeable Lithium Battery

Still image mode: up to 5000 pictures

Video clip recording mode: up to 120 minutes

3.2 Inserting Micro SD or SDHC Memory Card - Mandatory

NOTE: A Micro SD/SDHC Memory Card may or may not be included with your CAMERA GOGGLE. It is recommended that you utilize a commercially sold Micro SD/SDHC Card to add memory storage to your CAMERA GOGGLE. It is best to utilize a high performance Micro SD/SDHC card as this will improve the performance of

ENG-8

4.0 RECORDING PICTURES AND VIDEO

NOTE: The GOGGLE has 4 modes and pressing the POWER/MODE button cycles through the modes in the following order: 720P Video@60 fps, 1080P Video@30fps, Still Photo, and Continuous Photo. To advance to the next mode, press the POWER/MODE button one time. The camera will remain on and ready to use for 180 seconds, after which the GOGGLE will turn off automatically. Press and hold the POWER/MODE for more than 3 second to turn off camera.

4.1 720P @ 60 FPS Video Mode - BLUE LIGHT

1. Press and hold POWER/MODE button for 2 seconds to turn on camera. The camera will power up in 720P @ 60 frames per second Video mode. Note: the BLUE MODE LIGHT INDICATOR is on and the GOGGLE is now in the VIDEO READY mode and set to take Videos. The LCD screen displays the 720P video icon.

2. Press the SHUTTER/SELECT button once. Recording begins. Note: the BLUE MODE LIGHT INDICATOR is blinking. The light will continue to blink until the camera stops recording.

3. To stop recording, press the SHUTTER/SELECT button again.

4.2 1080P @ 30 FPS Video Mode - GREEN LIGHT

1. Press and hold POWER/MODE button for 2 seconds to turn on camera. The camera will power up in 1080P @ 30 frames per second Video Mode. Note: the GREEN MODE LIGHT INDICATOR is on and the GOGGLE is now in the 1080P READY mode and set to take videos. The LCD screen displays the 1080P Video icon.

3. Press the SHUTTER/SELECT button once. Recording begins. Note: the GREEN MODE LIGHT INDICATOR is blinking. The light will continue to blink until the camera stops recording.

3. To stop recording, press the SHUTTER/SELECT button again.

ENG-10

4.3 Still Image Photo Mode - RED LIGHT ■

- 1. Press and hold POWER/MODE button for 2 seconds to turn on camera.
 - 2. Press the POWER/MODE button 2 times again for less than a second each to change to Photo Mode.
- Note: the RED MODE LIGHT INDICATOR is on and the GOGGLE is now in the PHOTO READY mode and set to take still images. The LCD screen displays the Camera icon.
- 3. Press the SHUTTER/SELECT button once. A still image is captured.

NOTE: To capture the sharpest images, it is important that the distance between the camera and the subject is at least .4 Meters (16 inches).

4.4 Continuous Photo Mode - PURPLE LIGHT ■

- 1. Press and hold POWER/MODE button for 2 seconds to turn on camera.
- 2. Press the POWER/MODE button 3 times again for less than a second to change to Continuous Photo Mode.

Note: the PURPLE MODE LIGHT INDICATOR is on and the GOGGLE is now in the CONTINUOUS PHOTO READY mode and set to take continuous images. The LCD screen displays the Continuous Camera icon.

- 3. Press the SHUTTER/SELECT button once and the camera will start taking still images every 2 seconds. The PURPLE LIGHT INDICATOR will continue to blink while taking pictures.
- 4. Press the SHUTTER/SELECT button again to stop taking images.

4.5 Power Off

- 1. Press the POWER/MODE button for more than 3 second to turn the camera off.
- NOTE: If either the POWER/MODE or the SHUTTER/SELECT button has not been used in 180 seconds or the Camera Goggle is not recording, the GOGGLE will turn off automatically.

5.0 TRANSFERRING STILL IMAGES AND VIDEO TO A COMPUTER

CAUTION: ALWAYS DRY THE GOGGLE BEFORE OPENING THE COMPARTMENTS.

The CAMERA GOGGLE has two ways to transfer your image and video files to a computer. The CAMERA GOGGLE comes with a USB cable to connect your CAMERA GOGGLE directly to a computer. You may also choose to purchase and use a commercially sold Micro SD/SDHC Card to store and transfer images and videos that were taken with the CAMERA GOGGLE. The computer does not require software to access the files stored on the CAMERA GOGGLE's Micro SD/SDHC card. The CAMERA GOGGLE will act as an external removable disc when the USB cable connects the camera to a computer.

5.1 Opening Memory Compartment

- 1. Make sure the CAMERA GOGGLE is thoroughly clean and dry. Follow the CARE AND MAINTENANCE instructions.
- 2. Open the MEMORY COMPARTMENT to expose the USB Port, and the Micro SD/SDCH port.

5.2 Connecting and Transferring Files

- 1. Choose a method to transfer files: USB or Micro SD/SDHC Card.

USB TRANSFER

Plug the USB cable into the USB connection port on the computer and then into the USB Port on the CAMERA GOGGLE. Press the POWER/MODE to turn on the CAMERA GOGGLE. NOTE: The USB cable will be able to access the files stored on the Micro SD/SDHC Card.

MICRO SD/SDHC CARD TRANSFER

Press down on the Micro SD or SDHC Card gently. The card will pop up for removal. Carefully remove the card and insert it into the Micro SD card adapter that comes with the Micro SD/SDHC Card and then insert the card into your computer's SD Card Slot as directed by the manufacturer.

** Make sure your computer's SD Card Slot can handle High Capacity SDHC cards as they are different than standard SD cards. You may need an adapter.*

CAUTION: Never insert a wet Micro SD/SDHC Card into a card adapter or into a Computer.

- 2. The connection screen opens on your computer monitor automatically. Choose the option: OPEN FOLDER TO VIEW FILES.
- NOTE: If the screen does not automatically open, look for a new hard drive icon on the computer next to your other hard drive icons. Click on the icon to view your image and video files.
- 3. The image and video files will appear in a folder.
 - 4. Copy the files to a folder on your computer (For example: My Pictures\California). Alternatively, you may copy the entire folder to your computer.
 - 5. If you wish to delete the data from the CAMERA GOGGLE's Micro SD/SDHC Card, select the files you wish to delete and press delete on your computer keyboard.
 - 6. Click the close button.

NOTE ON MEDIA PLAYERS:

There are multiple media players available online to play the HD (H.264) MOV video files created with the CAMERA GOGGLE. The preferred video player is **QUICKTIME**. If your default computer media player is unable to play the videos, your player may be out of date and you may need to update it online. You may also try using an alternate media player if your computer has one or if you choose to download one from a source that you trust online. For PC Users - Windows 7 can play the MOV files with Windows Media Player.

5.3 Disconnecting and Closing Memory Compartment

- 1. Safely disconnect the USB from your computer and from the CAMERA GOGGLE. Alternatively, if you transferred files using the SD Card method, disconnect the SD Card from the computer and then remove the Micro SD/SDHC card from the adapter. Reinsert the Micro SD/SDHC Card into your CAMERA GOGGLE.

NOTE: It is recommended that you always delete all the files from your Micro SD/SDHC card after transferring your files to a computer. This will free up space for more images and video files. Deleting files can only be done through the computer.

6.0 VIEWING VIDEOS AND STILL IMAGES ON A TV

The CAMERA GOGGLE can act as a media player and will be able to play videos and pictures directly from your CAMERA GOGGLE onto a television set. Connect an HDMI cable (not included) to the CAMERA GOGGLE and the HD television set.

IMPORTANT!

Make sure your camera is set to the correct NTSC or PAL video setting or your CAMERA GOGGLE will not work properly with your TV for either Video or photo playback. Select NTSC if viewing on a TV in North America. Choose PAL if viewing on a TV outside of North America or if viewing on a PAL TV in any region.

6.1 Setting correct NTSC/PAL mode for your TV

This feature allows you to set the TV video output mode to PAL or NTSC. Please check your Television Set to see if the TV can accept either PAL or NTSC video playing devices. The CAMERA GOGGLE is set at the factory in the PAL mode. If you need to change the output mode to NTSC or vice versa, follow the below directions.

- 1. Press and hold the POWER/MODE button for 2 seconds to turn on CAMERA GOGGLE, the BLUE LED light will turn on. Then, press and hold both the SHUTTER/SELECT and the POWER/MODE buttons for 5 seconds, at which time you will enter the TV Video Output setup mode. Release both buttons and you will see the current mode.

PAL
Mode

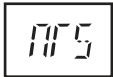
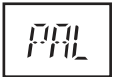

NTSC
Mode

- 2. To change the TV video output mode from PAL to NTSC or from NTSC to PAL, press the POWER/MODE button once. You may cycle between the two output modes by pushing the POWER/MODE button again.
- 3. To Select the TV output mode of either PAL or NTSC, press the SHUTTER/SELECT button once and the camera will save your selected mode, exit the TV video output mode, and return to the Video mode (BLUE LED).
- 4. To complete the TV video output mode setting on the CAMERA GOGGLE, restart the CAMERA GOGGLE by pressing the POWER/MODE button for more than a few seconds until the camera turns off. Press the POWER/MODE button again to restart the CAMERA GOGGLE. Your camera will now be setup in the TV Video Output mode that you selected. You do not have to repeat this procedure if you replace batteries. The CAMERA GOGGLE will remain in this mode until you decide to change the TV video output mode through the steps above.

6.2 VIDEO AND STILL IMAGE PLAYBACK ON A TV

1. With the CAMERA GOGGLE turned off, connect the HDMI cable (not included) to the CAMERA GOGGLE and the HD TV.
2. Turn on the CAMERA GOGGLE and the camera will automatically start up in video mode and begin playing the first video on the TV screen.
3. Press the SHUTTER/SELECT button to advance to the next video and press the POWER/MODE button to go back to the previous video.
4. To switch to the playback of Pictures, press and hold the POWER/MODE button for 3 seconds. You will now be in the picture mode. To advance to the next picture, press the SHUTTER/SELECT button and to go back to the previous picture, press the POWER/MODE button.
5. You can toggle between the Picture and Video mode by pressing the POWER/MODE button for 3 seconds.
6. To turn off, disconnect the HDMI cable from the CAMERA GOGGLE and press and hold the POWER/MODE button for a few seconds until the camera turns off.

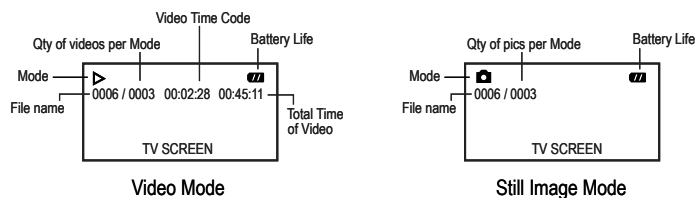

7.0 Video and Image File Size

When recording video it is very important that you are already familiar with the file size that your computer can store and playback. If you record a continuous video clip onto a CAMERA GOGGLE's Micro SD/SDHC card, you may not be able to download or play the video file on your computer because of the large file size. Also, your media player may not be able to play large HD Videos.

Please conduct a FILE SIZE TEST before you use your CAMERA GOGGLE to capture important images and video. Test various video file sizes to make sure your computer will be able to store and play the videos that you record. If you have difficulty in playing back video files smoothly, try taking a shorter video. You may also try opening the video file with a different media player as not all media players work the same.

ENG-15

Please read the sample chart below to estimate your file size per minute of recording time.

NOTE: Video file sizes will vary due to the complexity of the scene. The file sizes listed are only estimates.

Approximate Video File Sizes - CAMERA GOGGLE	TIME (min):	.5	1	10	20
	SIZE OF FILE:	45MB	90MB	900MB	1.7GB

NOTE: Depending on the battery's charge as well as the size of your Micro SD/SDHC card, you may be able to record a video for an hour or more. It is, however, best to take short videos. This will make transferring files and playing them back easier. The camera will split a video file over 1 hour into two files to improve the performance of the camera.

8.0 WIFI CAPABILITIES AND USE WITH OTHER WIFI DEVICES

This Camera Goggle has WiFi Capabilities that enable the Camera Goggle to connect to smartphones or tablets. As operating systems for smart phones change each year, please go to www.LiquidimageCo.com to see which operating system works with the Camera Goggle. With the use of downloadable Applications (Apps) from Google Play and the Apple Store, the Camera Goggle will be able to stream live video, remote playback images and video, remote control camera, as well as remotely control camera settings. Please visit the Liquid Image Website at www.LiquidimageCo.com to view and link to various Apps that will work with the Video Goggle WiFi Model. Tutorials and instructions of how to use each App is available on the Liquid Image website as well.

1. The WiFi feature on the Camera Goggle is off by default and will be represented on the LCD screen as a Flashing WiFi icon. (Note: The WiFi icon will take around 17 seconds after powering on before it starts blinking on the LCD screen. Please do not press any buttons until you see this icon. Also, the WiFi icon will not start up unless a MicroSD card is inserted in the Camera Goggle. Please make sure to use a Class 6 or above for the best performance of the Camera Goggle.)
2. To activate the WiFi feature once the WiFi icon is blinking, hold the SHUTTER/SELECT button down for 2 seconds. You will hear 2 beeps and the LCD screen will show a solid WiFi icon. The WiFi will take about 8 seconds to boot. So, do not press any buttons during this time.
3. Once the WiFi icon is solid on the Camera Goggle, go to your smartphone or tablet and connect your WiFi to the Camera Goggle. This is done in the Settings folder of your

ENG-16

smartphone or tablet device.

4. To turn off the WiFi feature, press and hold the SHUTTER/SELECT button down for 2 seconds to turn off the WiFi feature. The WiFi icon on the LCD screen will start blinking again

9.0 FIRMWARE AND PRODUCT UPDATES

! Liquid Image will update the software regularly, please refer to the information on our website and download the newest software. www.LiquidimageCo.com

1. Before updating the firmware, make sure the battery level is at least at the 50% level. Do not try to upload new firmware if the battery level is low as this may cause the camera to have difficulty uploading firmware in the future.
2. Copy the firmware file to the root directory of the SD card, outside of the main directory folders. Then, disconnect the USB cable and the camera will automatically shut down.
3. With the camera off, press and hold both the POWER/MODE button and the SHUTTER/SELECT BUTTON at the same time. Once you hear the camera beep, release both buttons.
4. The LCD will show "UP" in the LCD screen and then turn off. The new firmware is now installed.

10.0 CARE AND MAINTENANCE

1. Before each use, the goggle should be inspected for any cracks, deformities or damage. If there is any damage or deformation to the frame, or scratches or damage to the lens that could obstruct or impair vision, do not use. Replace any damaged parts such as the lens, strap or face foam prior to use.
2. Do not expose goggle to heat, strong detergents, or chemicals.
3. To clean, rinse the frame with tap water. A mild soap may be utilized on the frame only when needed. To prevent damaging the lens, only clean the lense with tap water. Dry with a soft cloth.
4. **IMPORTANT: Do not rub lens when wet.** When the inner lens surface is wet, it becomes soft and is more susceptible to scratching. Rubbing the inner lens when it is wet, may also reduce the effectiveness of the anti-fog coating.
5. To Dry: Gently shake snow and moisture off the lens. Use the micro bag or a soft cloth to gently blot away moisture or allow lens to air dry. Make sure ventilation ports are clear of snow or other debris. If wearing the goggle, motion will increase airflow and help to dry the goggle. Once the lens has completely dried and is at room temperature, use the micro bag or a soft cloth to remove any smudges.

ENG-17

6. To prevent scratching, do not use paper towels, ski gloves or clothing to clean the lens. Only use a micro bag or a soft cloth. Abrasive materials may scratch the lens.
7. For optimum life and performance of your lens, store completely dry and in the protective bag or case. Lens should be kept in a dry environment at room temperature when not in use. Store the lens away from direct sunlight, or excessive heat or cold.
8. To prevent scratching, do not place lens face down.

11.0 REPLACING LENSES

Wash and thoroughly dry hands prior to removing or inserting the lens. Do not change the lens while wearing gloves as the glove material may scratch the lens.

11.1 Removing Lens

1. Hold the bottom of the frame and grab the top of the frame from the inside.
2. Gently pull the top of the frame away from the lens.
3. Gently lift the lens out of the sides and bottom of the frame.

11.2 Inserting Lens

1. Insert the lens at the nose of the frame. Take care to align the notch of the lens with the post in the frame. Gently push the lens onto the post.
2. Continue inserting the lens into the groove along the bottom and sides of the frame. Make sure to push the lens completely into the groove of the frame.
3. Align the notch on the lens with the post at the top of the frame.
4. Check the lens to make sure that it is correctly set in the frame prior to use.

12.0 CAMERA WARNINGS AND PRECAUTIONS

Never touch the camera connection components that are exposed when the MEMORY COMPARTMENT OR BATTERY COMPARTMENT are open. There is a risk of shock if the components in the compartments become wet.

If the CAMERA GOGGLE emits a strange noise, smoke or odor, turn off immediately and remove the battery.

1. Using the CAMERA GOGGLE in a manner other than what the product use is intended for may result in injury to you, the product, or other persons.
2. This is not a safety Goggle. Only use for intended purposes. The Goggle lens

ENG-18

provides basic protection against wind, dirt, dust, snow and glare. The lens will not withstand a severe impact. This lens does not protect against hard or sharp objects. Care should be taken to avoid impact with hard or sharp objects.

3. Avoid jolts, drops, collision with other hard objects, or shaking of the CAMERA GOGGLE. These movements may damage the components.
4. Never open the camera body with a screw driver. There is a risk of shock if you touch the camera components.
5. Children under 13 years of age should never wear or operate the CAMERA GOGGLE.
6. Children age 13 to 17 should always have adult supervision with use of this product. The CAMERA GOGGLE is not a toy and needs to be treated with the same care as any other digital camera.
7. An adult age 18 or older should always dry the product thoroughly before performing the battery replacement or before performing the transfer of image and video files to a computer.
8. If the inside of the camera gets wet, immediately turn it off and dispose of the battery. Then dispose of the CAMERA GOGGLE in accordance with laws for disposing electronics in your country. Using the camera after any internal compartments have become wet may cause a fire or electric shock.
9. If the battery becomes wet, there is a risk of fire, shock, shorting the electrical system, or corrosion. Dispose of the battery immediately in accordance with the local laws in regards to proper battery disposal.
10. Do not place on an unstable surface or near the edge of a surface. The camera may fall, resulting in damage to the camera or injury. If the camera has fallen and its body is damaged, turn it off, remove the battery and dispose of the CAMERA GOGGLE in accordance with laws for disposing electronics. Using the camera after its body has been damaged may cause a fire or electric shock.
11. **Never leave the CAMERA GOGGLE in direct sunlight.** Never leave the Camera in the trunk of a car or in a car on a warm or hot day. Direct sunlight or high temperatures may damage the CAMERA GOGGLE or cause the housing to burst.
12. Do not use the CAMERA GOGGLE in a location where there is explosive gas, or any other flammable material in the air. Doing so may cause a fire or an explosion.
13. If the camera is not going to be used for a long period of time, remove the battery from the camera. This will prevent any possible excess heat or leakage of battery fluid that may result in injuries or damage to nearby objects.
14. Do not attempt to check the LCD display while moving. If riding or otherwise in motion, come to a complete stop and make sure you are not on a path that others may use. When motionless, remove the goggle to look at the LCD status display.

ENG-19

your lens or use a micro bag or soft cloth. Using gloves, clothing or other abrasive materials may remove the anti-fog coating when wet. If fogging occurs, it is possible that your anti-fog coating has rubbed off. You may need to replace your lens.

4. **My CAMERA GOGGLE is no longer working (no power).** Your battery may be completely drained or your micro SD/SDHC card may not be working. Thoroughly dry the CAMERA GOGGLE as directed in the CARE AND MAINTENANCE (section 10.0). Check the Goggle for any loose parts or open ports. **DO NOT OPEN THE FACTORY SEALED BODY OF THE CAMERA.** If there were any open ports, check to make sure they are not wet. Be careful not to touch any camera components inside the MEMORY COMPARTMENT or BATTERY COMPARTMENT. If the components are wet, follow the CARE AND MAINTENANCE (section 10.0). Check that the battery and the memory card are completely inserted. If that does not solve the problem, remove the battery and the micro SD/SDHC card. Fully charge the battery, then reinsert into the camera. If the battery was not the issue, check the micro SD/SDHC card by inserting another card, preferably a different brand, into the camera. Please note that micro SD/SDHC cards can fail. Be sure to use a card that meets the camera's specifications (see section 3.2). And be sure to follow the manufacturer's Care and Maintenance instructions. If you had previously recorded files to the micro SD/SDHC card that was removed from the camera, you may check the card on a computer to see if any files were recorded and if they appear to have recorded normally. NOTE: Any large changes in temperature, exposure to extreme temperatures or sudden jolts, including dropping your CAMERA GOGGLE may damage the camera components. If you have not dropped your camera or caused damage through any physical shaking or colliding of the camera with a hard object, or if you have not caused exposure to extreme temperatures or temperature fluctuations, there may be an issue of water leakage into one of the compartments.

5. **My CAMERA GOGGLE is "FROZEN" (Turned ON, but not functioning).** If your camera is "frozen" or not functioning while turned on, you may need to reset the camera functions. First, check to see if the memory is full. You will see the word "FUL" displayed on the LCD screen. Also check to see if your battery is empty or low. If that does not reset the functions of the camera, move to a clean and dry environment, check that the camera is completely dry in accordance with the CARE AND MAINTENANCE (section 10.0), then remove the battery. Reinsert the battery. Close the compartment door. Turn on the camera and retest the functions.

ENG-21



SOS message

When the camera shows SOS, it means the current recording document is damaged; the user can press any key to repair this document.



HOT message

When the LCD display shows HOT, it means the temperature of the camera is too high and needs to shut down for cooling. It won't damage the camera and is only for reminding the user that the temperature of the equipment cannot be too high. The user only needs to reboot the camera after it cools down.

13.0 BATTERY WARNINGS AND PRECAUTIONS

1. Only Liquid Image 3.7V 1150mAh batteries are to be used with the CAMERA GOGGLE.
2. Use only appropriate refuse points for environmentally correct disposal of spent batteries.
3. Batteries are to be inserted with correct polarity. See page ENG-6.
4. Parental guidance is necessary when installing or replacing battery.
5. Do not throw batteries into fire.
6. After use, always switch off the device. Take out battery to store the device.
7. The supply terminals are not to be short-circuited.
8. Do not drop, hit, or submit the battery to strong shocks.
9. Do not allow the battery to come into contact with fresh or salt water, or allow the terminals to become wet.
10. If the battery is leaking and the battery fluid gets on your skin or clothing, immediately rinse with clean water and seek emergency care.
11. Rechargeable batteries are only to be charged under adult supervision.

14.0 COMMONLY ASKED QUESTIONS AND TROUBLESHOOTING

1. **Is the CAMERA GOGGLE water proof?** The CAMERA GOGGLE is water resistant. It is not intended for underwater use. However, it is designed to withstand rain, sleet, and snow or a brief accidental submersion underwater. Be sure to always check that your battery and memory compartments are completely sealed prior to exposing them to moisture.
2. **My CAMERA GOGGLE has stopped recording.** If your camera stopped recording photos or videos, check to see if the memory is full or if your battery is empty. The LCD will display "FUL", if your memory is full. If the battery is empty the battery icon will not have any bars. It is also possible that your micro SD/SDHC card may have failed. Try an alternate card.
3. **My goggle fogs.** The CAMERA GOGGLE is treated with anti-fog on the inside lens, which should minimize any fogging under normal use conditions. Always air-dry

ENG-20

For more trouble shooting, visit our website's help section www.LiquidImageCo.com or email our CUSTOMER SUPPORT at support@LiquidImageCo.com.

Video Tutorials for product usage and trouble shooting are available on the website.

LIMITED WARRANTY: See limited warranty form included with this product. Colors and Style May vary from what is shown on the packaging.

Warning: TO PREVENT THE RISK OF FIRE OR ELECTRIC SHOCK, DO NOT EXPOSE THE INNER ELECTRONICS TO RAIN OR MOISTURE.

FCC ID: WGI-XSC-369 IC ID: 10385A-369

FOR AMERICAN USERS

The following advisory is included in accordance with the laws of the state of California (USA)

WARNING:

This product contains chemicals, including lead on the internal electronic board, known in the State of California to cause cancer, birth defects or other reproductive harm. **Wash hands after handling.**

Warning: Changes or modifications to this unit not expressly approved by the party responsible for compliance could void the user's authority to operate the equipment.

NOTE: This equipment has been tested and found to comply with the limits for a Class B digital device, pursuant to Part 15 of the FCC Rules. These limits are designed to provide reasonable protection against harmful interference in a residential installation. This equipment generates, uses and can radiate radio frequency energy and, if not installed and used in accordance with the instructions, may cause harmful interference to radio communications.

However, there is no guarantee that interference will not occur in a particular installation. If this equipment does cause harmful interference to radio or television reception, which can be determined by turning the equipment off and on, the user is encouraged to try to correct the interference by one or more of the following measures:

- * Reorient or relocate the receiving antenna.
- * Increase the separation between the equipment and receiver.
- * Connect the equipment into an outlet on a circuit different from that to which the receiver is connected.
- * Consult the dealer or an experienced radio/TV technician for help.

Shielded cables must be used with this unit to ensure compliance with the Class B FCC limits.

FOR CANADIAN USERS

This Class B digital apparatus complies with Canadian ICES-003.

ENG-22