

RECORDING FUNCTION

[Recording starting]

- (1) Button: Extensively pressing button "**REC**" starts the recording operation on the main menu screen as shown below.

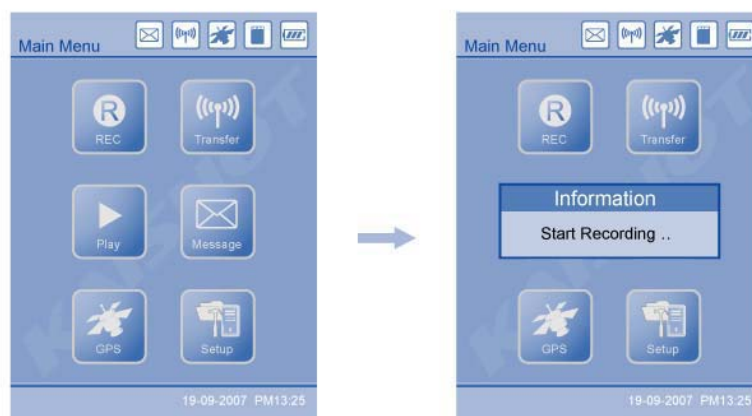

- (2) Icon: Use "◀◀" or "▶▶" to select "REC" and select "ENTER" to start recording.

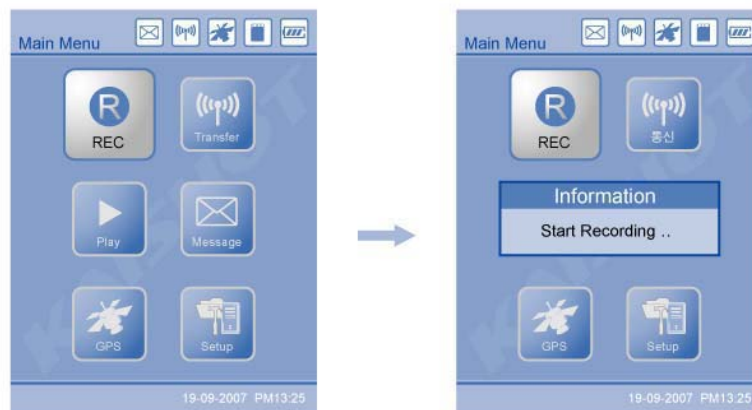

[Recording ending]

Extensively pressing "**REC**" to end the recording operation.

KAISHOT (mPVR)

PLAYING FUNCTION

[Playing starting]

- (1) Use "◀◀" or "▶▶" to select "▶", and select "ENTER" to display the animation list.
- (2) Use "◀◀" or "▶▶" to select a file to play, and then press "ENTER" to start playing.

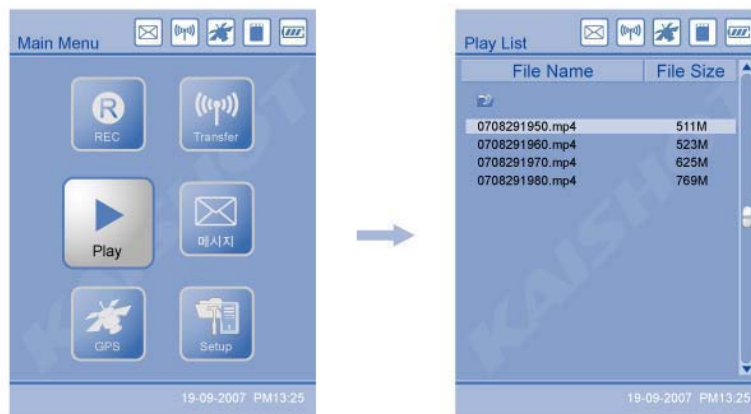

[Playing ending]

"REC" Extensively press (REC) to end the playing operation.
 After ending the playing operation, extensively press "ENTER" to return to the main menu.

REAL-TIME ANIMATION TRANSMISSION FUNCTION

[Starting real-time animation transmission]

Use "◀◀" or "▶▶" to select "Transfer" as shown below, and then press "ENTER" to start transmission of animation.

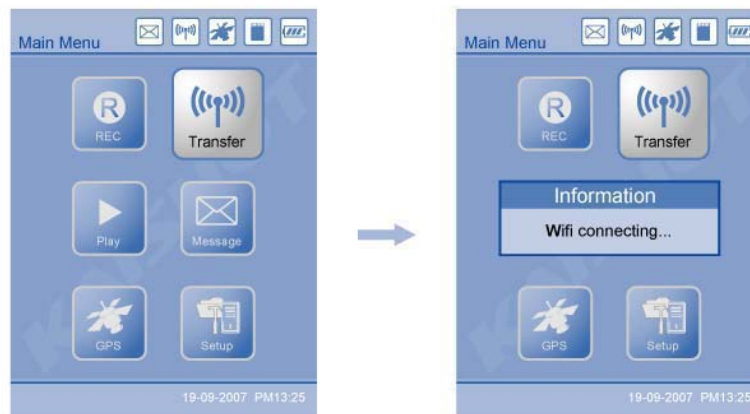

It is possible to real-time view animation of KAISHOT by entering IP information of KAISHOT ready for RTSP transmission through the KAISHOT-dedicated viewer.

[Ending transmission of real-time animation]

Stop the KAISHOT-dedicated viewer to stop transmission of real-time animation.

Extensively pressing "REC" on the KAISHOT terminal to end transmission of real-time animation.

MESSAGE CHECKING FUNCTION

- (1) Use "◀" or "▶" to select "Message", and then press "ENTER" to view messages.
- (2) Use "◀" or "▶" to select a file to view, and then press "ENTER" to view the file.



- (3) After viewing the message, briefly press "MENU" to return to the message list, and then briefly press "MENU" again to return to the main menu.

GPS FUNCTION

Use "◀" or "▶" to select "GPS", and then press "ENTER" to view GPS.

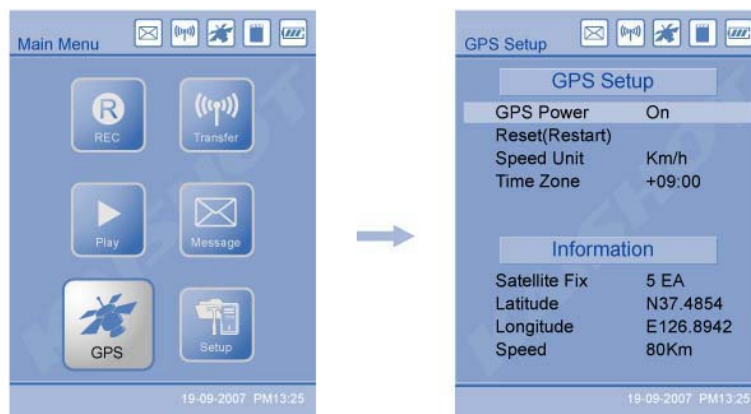

After viewing GPS, briefly press "MENU" to return to the main menu.

PREFERENCE SETUP

Use "◀" or "▶" to select "Setup", and then press "ENTER" to return to the setup menu.

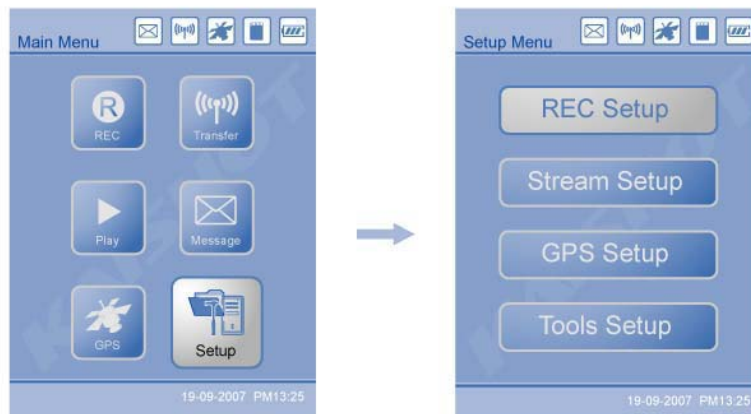

The submenus in the setup menu allow you to view and change the settings relevant to the functions.

Recording setup: This submenu allows viewing and changing the current settings relevant to the recording function.

Communication setup: This submenu allows viewing and changing the current settings relevant to real-time animation transmission and wireless modules such as WiFi.

GPS setup: This submenu allows viewing and changing the current settings relevant to the GPS function.

Tool setup: This submenu allows setting various functions of KAISHOT such as saving-mode setup, language selection and LCD brightness setup, and viewing information relevant to the functions.

Briefly press "MENU" in the setup up to return to the main menu.

*** Note**

Briefly press "MENU" if you desire to move to the previous (precedent) menu.

SPECIFICATIONS

[Main Unit specifications]

| ITEM | SPECIFICATIONS |
|------------------------|---|
| CPU | ARM920T |
| Microphone Input | internal 1Ch , external 1Ch |
| Internal Speaker | Output Power dissipation: up to 1W |
| External I/O Interface | USB 1.1 : 1ea AV out : 1ea (ϕ 3.5 AV Jack(RCA)) |
| Display | 2.4 inch color TFT-LCD (QVGA) |
| Keypad | 6 keys |
| Power supply | 3.7Vdc (when the battery is used) 5.0Vac (when the AC adapter is used) |
| Power consumption | Standby mode (GPS, WiFi, Camera off) : 1.65W Playback mode (GPS on, WiFi off) : 2.4W Record mode (GPS on, WiFi off) : 3.7W Stream transfer mode (GPS on, WiFi on) : 6W |
| AC Adaptor | 100~240Vac, 50~60Hz 5Vdc, 2A |
| Battery Pack | Li-Polymer, +3.7Vdc 2,100mAh : 63(H)x80(V)x10(w) 4,200mAh : 63(H)x80(V)x17(w) |
| Dimension | 63mm(W) X 110mm(D) X 28mm(H) |
| Operating Temperature | -10℃ ~ 60℃ |
| Material | Polycarbonate |
| Watertightness | IP 65 |
| Mass | 169.5g (2100mAh battery) 213.0g (4200mAh battery) |

※ The specifications and the information of the product may be subject to change without prior notice for the purpose of improving capabilities of the product.

[Hybrid Camera specifications]

| ITEM | SPECIFICATIONS |
|-------------------------------|---|
| TV System | NTSC / PAL |
| Image pickup element | 1/4" CCD |
| Lens & View Angle | 3.6mm(standard) F2.0 / 68° , lens exchangeable |
| Scanning System | 525 Lines, 60 fields/sec / 625 Lines, 50 fields/sec |
| Minimum illumination | 0.5 Lux F1.2 5600 \pm K |
| Wireless communication module | WiFi(802.11 b/g) , HSDPA |
| GPS module | SiRF star 3(Built In) |
| Dimension | 105mm(W) X 30mm(D) X 100mm(H) (include WiFi) |
| Operating Temperature | -20℃ ~ 50℃ |
| Material | Polycarbonate |
| Water Proof | IP 65 |
| Mass | 129.0g |

* The specifications and the information of the product may be subject to change without prior notice for the purpose of improving capabilities of the product.

[Function specifications]

| ITEM | SPECIFICATIONS |
|---------------------|--|
| OS | embedded OS (linux) |
| Video Input(Camera) | 1Ch, NTSC/PAL(selectable) |
| Video Output | 11Ch, NTSC/PAL(selectable) |
| Video Resolution | NTSC: [720 X 480] [640 X 480] [320 X 240] (W X H) PAL: : [720 X 576] [352 X 288] (W X H) |
| Video quality | High[1.5Mbps] Standard[1Mbps] Low[700Kbps] |
| Video frame rate | NTSC : Record mode 30/25/15 fps NTSC : Real Time Stream Transferring mode 30/25/20/15/10/5/3/2/1 fps PAL : Record mode 25/15/5 fps PAL : Real Time Stream Transferring mode 25/15/5/3/1 fps |
| Record mode | [Video + Audio] [Video only] |
| Real Time Protocol | RTSP/RTP/RTCP |
| Codec | H.264(video), AAC(audio) |
| File format | mp4 |
| Message format | Text/bmp/jpg/gif format bmp/jpg/gif image zoom (x1 , x2, x2.5) |
| Recording medium | Micro SD Card(Compatible with FAT32, Supporting up to 8GB) |
| Recording time | Continuous max. Recording time : 3hours Recording time : 1hour 10minutes / 1GB (720 X 480 / 30fps base) |
| One-push recording | Start recording by REC button |
| Playback speed | FF : [x1] [x4] REW : [x4] |
| Display Brightness | Dark ←→ Bright 10 steps |
| Saving mode | LCD turn off after 10sec,20sec,30sec,1min,3min,5min. |
| language | [English] [Japanese][Chinese] [Korean] |

* The specifications and the information of the product may be subject to change without prior notice for the purpose of improving capabilities of the product.

PRODUCT WARRANTY CERTIFICATE

| | | | |
|------------------|---------|-----------------|--------------------------------|
| Product Name | KAISHOT | Model No. | IDF-PVR01 |
| Date of purchase | | Serial No. | |
| Purchased at | | Warranty period | One year from date of purchase |

[Warranty period : Charger(One year), Battery(Six month)]

※ If it is not feasible to verify the purchase date, the warranty period starts on the date three months after the manufacture date or the customs clearance date of the product.

ID Fone provides users with the warranty services for the product pursuant to the regulations on consumer damage compensation as follows.

If your product takes place any problem, please contact the local dealer or the place of purchase for repair of the product by showing the warranty certificate. (If the purchase place or the local dealer is not available, please contact the service center.)

Free services

Free services are provided for product defect caused by the manufacturer or during normal operation of the product within the warranty period.

※ Receipt shall be provided when you desire reimbursement of the purchase price.

| Types of consumer damages | | details of compensation | |
|--|---|---|---|
| | | within the warranty period | after the warranty period |
| Requiring major repair within ten days after purchase | | Replacement or reimbursement | |
| Requiring major repair within one month after purchase | | product replacement or free repair | |
| Requiring major repair within one month after replacement of the product | | reimbursement | |
| Replacement of product not allowed | | | |
| Repair allowable | Failures in three times from same defect | free repair | Charged repair |
| | Fourth failure from same defect | product replacement, free repair or reimbursement | Charged repair |
| | Fifth failure from defects at various components | | |
| Repair not allowed | In such case that a provider lost a product requested of repair by a consumer | | |
| | In such a case that repair is not feasible though there are components for repair (within the component retention period (three years)) | product replacement or reimbursement | replacement after deducting fixed depreciation |
| | In such a case that repair is not feasible because of lack of components for repair (within the component retention period (three years)) | | reimbursement after deducting fixed depreciation plus 10% of depreciation |

※ Functional defect taken place during normal operation, but limited to failure defect (excluding non-failure, marketability damage or fault)

Charged services

① Non-failure

Services of product with non-failure may be charged. Please carefully read the user's manual.

(Services for product not allowed of repair shall be charged in accordance with defined criteria.)

| | |
|--|---|
| <ul style="list-style-type: none"> Service for product with problem caused reason the user is responsible for (e.g., password missing) Cleaning dusts or removing foreign materials from the product | Free service for the first service Charged from the second service |
|--|---|

② Failure caused by consumer's fault

- Failure due to fault or improper handling of the product by user (e.g., dropping, submersion, impact, damage, and forced operation)
- Failure due to repair by technicians of ID Fone, or service centers designated by ID Fone
- Failure due to intentional act or fault of consumer
- Failure or damage of product due to use of components or accessories not specified by ID Fone

③ Other cases

- Failure due to fire, salt water, flood, or abnormal power source
- Expiration of lifecycle of consumables (battery, charger, antenna or any other attachments)

ID Fone Co., Ltd.

Please keep this warranty & manual well as it's not republished.

FCC NOTE

:This equipment has been tested and found to comply with the limits for a Class B digital device, pursuant to Part 15 of the FCC Rules. These limits are designed to provide reasonable protection against harmful interference in a residential installation. This equipment generates, uses and can radiate radio frequency energy and, if not installed and used in accordance with the instructions, may cause harmful interference to radio communications.

However, there is no guarantee that interference will not occur in a particular installation. If this equipment does cause harmful interference to radio or television reception, which can be determined by turning the equipment off and on, the user is encouraged to try to correct the interference by one or more of the following measures:

- Reorient or relocate the receiving antenna.
- Increase the separation between the equipment and receiver.
- Connect the equipment into an outlet on a circuit different from that to which the receiver is connected.
- Consult the dealer or an experienced radio/TV technician for help.

THIS DEVICE COMPLIES WITH PART 15 OF THE FCC RULES.

OPERATION IS SUBJECT TO THE FOLLOWING TWO CONDITIONS:

(1) THIS DEVICE MAY NOT CAUSE HARMFUL INTERFERENCE, AND

(2) THIS DEVICE MUST ACCEPT ANY INTERFERENCE RECEIVED,

INCLUDING INTERFERENCE THAT MAY CAUSE UNDESIRE OPERATION

THE MANUFACTURER IS NOT RESPONSIBLE FOR ANY RADIO OR TV INTERFERENCE CAUSED UNAUTHORIZED MODIFICATIONS TO THIS EQUIPMENT. SUCH MODIFICATIONS COULD VOID THE USER'S AUTHORITY TO OPERATE THE EQUIPMENT.

Inquiries and after-sales service consulting for products

If you experience any trouble or inconveniency for use of the product, please call the service center before you visit the center.

Please contact local dealer or place of purchase

Use the chargers, the batteries and optional devices specified by ID Fone to prevent the terminal from malfunctioning. Warranty period: Charger: one year; battery: six months

Use of product other than those specified by ID Fone will void the warranty.