

FilmScan35 II



-Patent pending-

User Manual

Index

<i>I. Unpack FilmScan35 II.....</i>	<i>2</i>
<i>II. Install film into the film holder.....</i>	<i>3</i>
<i>III. Quick Start.....</i>	<i>7</i>
<i>IV. Operation Gudie</i>	<i>12</i>
<i>V. Specification</i>	<i>29</i>

I.Unpack FilmScan35 II



FilmScan35 II



Negative Film Holder



Slide Film Holder



USB adapter



USB cable



Clean brush



User manual

NOTE

- ✦ *We strongly suggest using a clean, dry, non-alcohol cotton swab to clean the glass surface periodically to produce a clear image during operation.*
- ✦ *Clean dust from filmscanner backlight, to use the clean brush to wipe the dust.*
- ✦ *Dust or dirt from the negative, slide films and cover tries may affect the scanned image quality, please make sure the materials are cleaned before inserting into the scanner.*
- ✦ *Please find recommend, professional purger from photo store to clean the dust on films if any to avoid damaging the only one copy of old films.*



II. Install film into the film holder

- ***Install the Slide into holder***

1. *Open the slide holder as illustrated*



2. *Put slide into positive slide slot*



3. *Close the film holder*



- ***Install the negative film into holder:***

1. *Open the film holder as illustrated*



2. *Install film into negative film slot*



3. *Close the film holder*



NOTE

- ✦ *To avoid mirror image, follow the serial numbers (from left to right) on top of film when install negative film into holder*



Figure 1

- ✦ *If the image is upside down [see fig. 2], the image can be corrected by Flip function in hard key of device before capture, or enter playback edit menu after capture[see fig. 3.4].*



Figure 2

Down/Flip button

(Flip hard key)

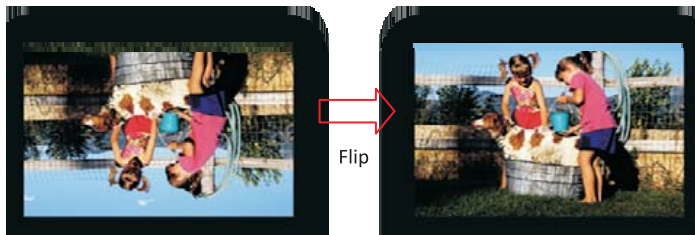

- *Press hard key on top of device in live view*

Figure 3



- *Playback mode menu*

Figure 4

III. Quick Start



1. *Put Film onto the film cartridge*



2. *Insert the film cartridge into FilmScan35 II*



3. *Connect USB cable to FilmScan35 II*



4. *Turn on Device by power button*



5. *Press OK button to capture the image*



6. *Follow the menu on display for scanning*



7. *After finished the capture, take out the SD card which stored capture images*



8. *Or read pictures from PC by MSDC mode*

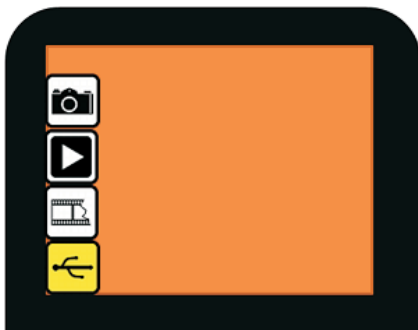

IV. Operation Gudie

Home: Main menu

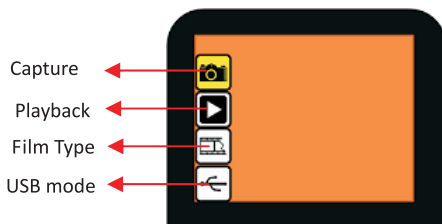

- Capture: capture mode (default)
- Playback: playback mode
- Film Type: define the film type which loaded in cartridge
- USB mode: MSDC (Mass Storage Device Class) mode

Home: No SD card



If there's no SD card been inserted to device, a warning icon NO SD card will be shown on display when enter main menu.

1. Capture



After welcome page, above menu will remain for 5 sec. User can press up/down button for desired menu. Or system will auto enter Capture mode if there is no action during this 5 second period.

1.1 Capture: Mirror/Flip (Hard Key)

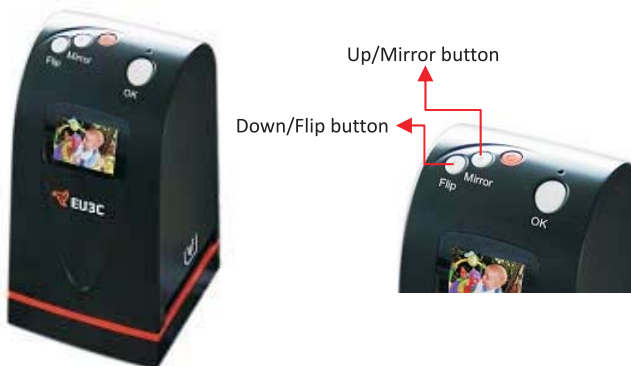



Mirror



- *Press Up/Mirror button to change image left to right*



Flip



- *Press Down/Flip button to upside down image*

1.2 Capture mode

Live view indicator
(flashing at 0.5sec rate)



Once enter capture mode, there will be a red indicator on left top corner to indicate it is in live view mode. When the film cartridge is inserted into the scanner slot, the image always shows the positive image according to previous defined Film Type (after power on, the Film Type is default to negative film). Reconfirm the film position through the display before press OK button.

1.3 Capture: Edit Menu



- Save: saves captured image
- Rotate+90: continue rotate +90 degrees
- Rotate -90: continue rotate -90 degrees
(this is for adjusting the user who took the portrait picture)
- Cancel: cancel any editing with this image
- Home: Back to main menu

1.4 Live View -> Capture/Edit Menu

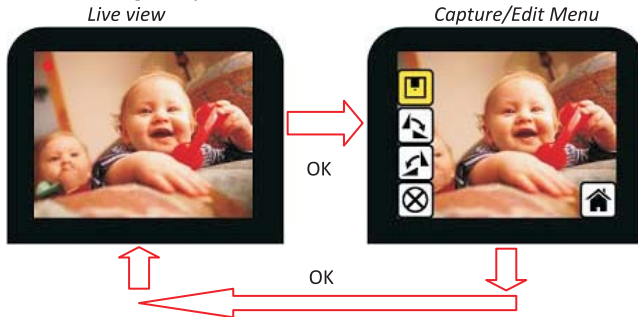

Once press OK button in live view, the edit menu will be appeared. When user press OK button again, the current image will be saved into SD card. The display will return to live view again.

1.5 Capture: Save



Once user press OK button on top of film scan 35-II, preview (live view) image will be selected and shown on the TFT which will take between 3-4 second with 4 icons shown on the left side of the screen. Save icon will be highlighted for user to confirm the saving by OK button. After the above step, display goes back to live view mode (preview)

1.6 Capture: Rotate +/-90 degrees



User can apply the up/down button for further editing (rotate +90/-90). Once user confirm rotate +90 degrees, they can press the OK button, the image will be rotate +90 degrees and cursor will remains at Save. Press OK button again will save the rotated image to SD card and screen will return to live view. For continuously rotate +90 degrees, move cursor to rotate again and press OK.

1.7 Capture: Cancel



Or select Cancel and press OK button to cancel any of the editing step with present selected image and FilmScan35 II goes to live view mode (nothing will be saved onto the SD card)

1.8 Capture: Home

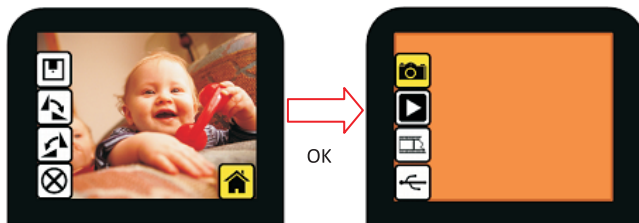

Go back to main menu, press OK button when select Home icon.

1.9 Exit from Edit mode back to Capture mode(Live View)



Once user presses OK button for save or cancel option, display will return to capture mode / live view. Then, user can move the film cartridge to next target film to capture.

1.10 Memory full



Once the images in SD card is full, user can see a SD card full once press save button. User has to down load the images to PC or replace another SD card for continue capture.

2. Playback

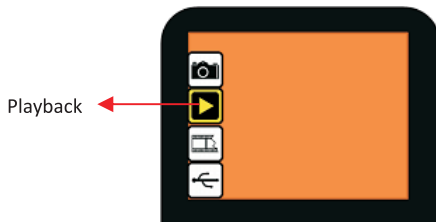

Press Down button to Playback mode when power on FilmScan35 II or access the main menu by Home icon if during operation. Press OK button to confirm the selection.

2.1 Playback: Auto Slide Show



Once user enter playback mode (default to slide show), 1.5 TFT will auto display all images stored in SD card with 2 seconds interval from previous captured image. User can also stop the slide show mode by press OK button.

2.2 Playback: Edit Menu



- Rotate+90: captured image rotate +90 degrees
- Rotate -90: captured image rotate -90 degrees
- Mirror: change image left to right
- Flip: upside down image
- Exit: returns to Slide show
- Delete: delete this picture stored in SD card
- Save: save the modified image onto SD card
- Home: returns to main menu

2.3 Playback: Slide mode -> Edit mode



User can interrupt (stop) the slide show mode to stand alone playback mode (single picture playback) by press OK button. (Pause slide show) Then user is able to scroll each picture by

up/down button. Once user select the picture stored in SD card which intended to be modified, then use OK button again to bring out the edit mode for modification.

2.4 Slide Show -> Single picture -> Edit mode

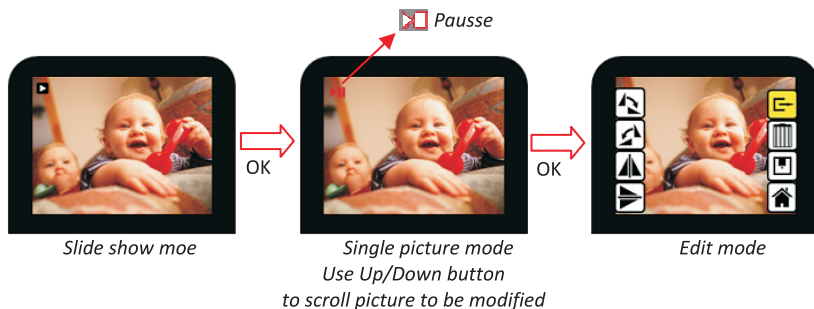

2.5 Playback: Rotate/Mirror/Flip/Save

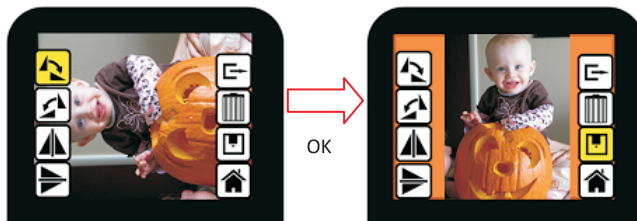

If user wants to Rotate +90 degrees by OK button, the image will be rotate +90 degrees and cursor will remains at Save. Press OK button again to save modified result and next picture will be shown (N+1). For continuously Rotate +90 degrees, move cursor to Rotate again and press OK. (Same for Rotate -90, Mirror, and Flip function)

2.6 Playback: Exit

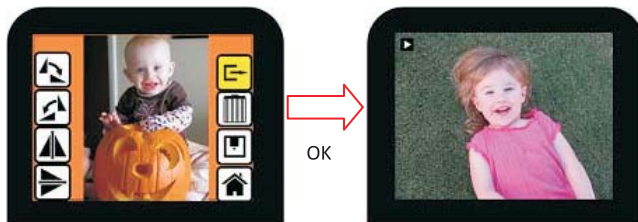

Once user select the EXIT function in edit menu, the display will go back to slide show starting with the current picture in SD card without saving any change of present picture

2.7 Playback: Delete

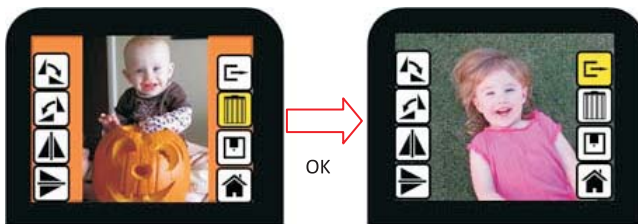

Delete will delete the present selected picture and next picture will be shown (N+1). Cursor goes to Exit icon. If user intend to process continuously delete, just move to delete icon again and press OK to confirm.

2.8 Playback: Home

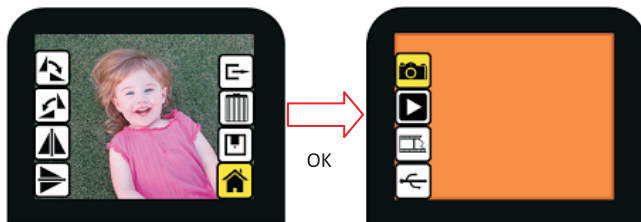

Go back to main menu, press OK button when select Home icon

2.9 Playback: No Picture

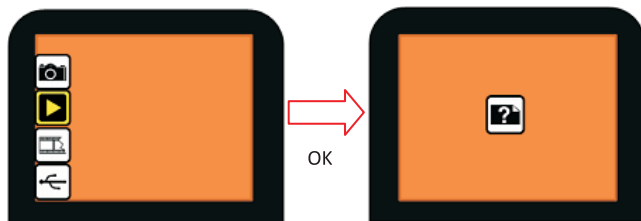

If there's no picture inside the SD card when enter playback mode, a No picture symbol will show on display.

3. Film Type

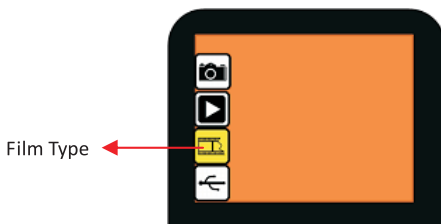

Change film type definition by enter Film Type menu when power on FilmScan35II or access the main menu by Home icon if during operation. Press down button for Film Type and press OK to confirm.

3.1 Film Type: Select Film Type

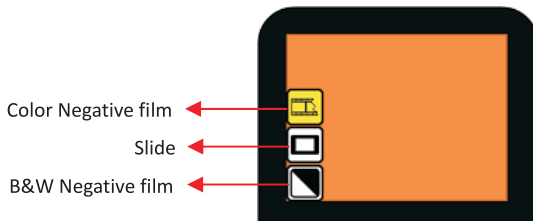

- *Negative film: select Negative film when cartridge loaded with negative film*
- *Slide: select Slide type when load slide in holder*
- *B&W film: select B&W when cartridge loaded with Black&White negative film*

3.2 Film Type Example

Color

Negative film



B&W

Negative film



Slide



Loaded

into

Cartridge

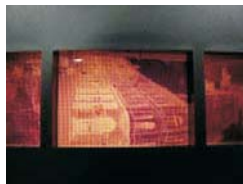

4. USB mode

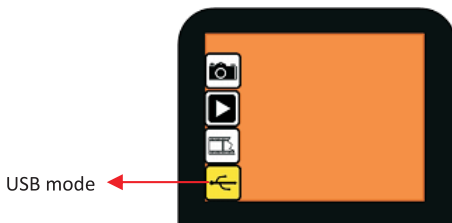

After finished capture, user can download the stored images from SD card to PC by take out the SD card from FilmScan35 II into PC. User can also select USB mode and press OK button when connect USB cable to PC. FilmScan35 II becomes a mass storage device and then user can review or edit images in SD card with PC.

4.1 USB Mode: Status



Once user select UsB mode, FilmScan35 II becomes a mass storage device and then a status icon shows on disply, then user can find an external USB disk device from my computer and review the images in SD card with PC.

Good bye page

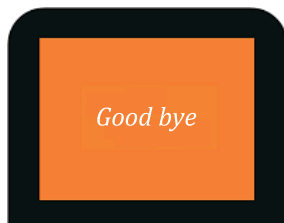

V. Specification

Image Sensor:	1/1.8 inch 5 mega CMOS sensor
Lens:	F no.= 2.0, 4 Glass elements,
LCD	1.5 Color TFT LCD
SD Slot	SD/MMC compatible
Focus Range:	Fixed focus
Exposure Control:	Automatic
Color Balance:	Automatic
Scan Quality	1,800 dpi
Data Conversion	10 bits per color channel
Scan Method	Single pass
Light Source	Back light (3 white LEDs)
Interface:	USB 2.0
USB Configuration	Mass Storage Device Class/MSDC
Power:	5V adapter, or USB power
Dimensions	82x86x152mm
Weight	0.41kg
Operating Systems	Windows XP/Vista 32/64 bits

This device complies with Part 15 of the FCC Rules. Operation is subject to the following two conditions: (1) this device may not cause harmful interference, and (2) this device must accept any interference received, including interference that may cause undesired operation.

NOTE:

THE MANUFACTURER IS NOT RESPONSIBLE FOR ANY RADIO OR TV INTERFERENCE CAUSED BY UNAUTHORIZED MODIFICATIONS TO THIS EQUIPMENT. SUCH MODIFICATIONS COULD VOID THE USER AUTHORITY TO OPERATE THE EQUIPMENT.

NOTE: This equipment has been tested and found to comply with the limits for a Class B digital device, pursuant to Part 15 of the FCC Rules. These limits are designed to provide reasonable protection against harmful interference in a residential installation. This equipment generates, uses and can radiate radio frequency energy and, if not installed and used in accordance with the instructions, may cause harmful interference to radio communications. However, there is no guarantee that interference will not occur in a particular installation. If this equipment does cause harmful interference to radio or television reception, which can be determined by turning the equipment off and on, the user is encouraged to try to correct the interference by one or more of the following measures:

- Reorient or relocate the receiving antenna.
- Increase the separation between the equipment and receiver.
- Connect the equipment into an outlet on a circuit different from that to which the receiver is connected.
- Consult the dealer or an experienced radio/TV technician for help.