

RADIO CONTROL TRANSBOTIX™

WARNING:
CHOKING HAZARD - Small parts
Not for children under 3 years

Features:

- Remote Controlled Transbotix with full function and 27 mhz. (Truck Mode)
- Robot Mode Transforms Into Truck Mode
- Poseable Robot with Detachable Accessories

CONTENT:

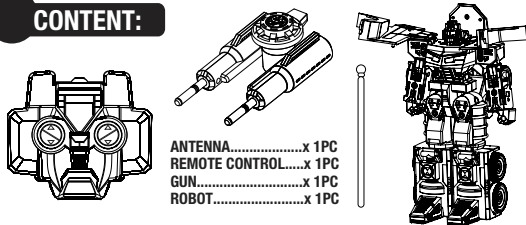

BATTERY CAUTION

- 1) Rechargeable batteries are not recommended.
- 2) Non-rechargeable batteries are not to be recharged.
- 3) Rechargeable batteries are to be removed from the toy before being charged.
- 4) Rechargeable batteries are only to be charged under adult supervision.
- 5) Do not mix alkaline, standard (carbon-zinc), or rechargeable (nickel-cadmium) batteries.
- 6) Do not mix old and new batteries.
- 7) Only batteries of the same or equivalent types as recommended are to be used.
- 8) Batteries are to be inserted with the correct polarity.
- 9) The supply terminals are not to be short-circuited.
- 10) If the batteries are loose, bend out the contacts for a tight fit.
- 11) Exhausted batteries are to be removed from the toy and be disposed of immediately; never dispose of batteries in fire.
- 12) If storing product for long periods of time, make sure to remove batteries.
- 13) Check the product periodically for signs of damage to electrical parts; do not play with product until damage has been properly assessed.

BATTERIES INCLUDED ARE FOR IN-STORE DEMONSTRATIONS ONLY.
PLEASE REPLACE OLD BATTERIES WITH NEW BATTERIES BEFORE USE.
If the unit malfunctions, please remove the batteries for one minute and reinstall again.
If the malfunctions persist, please replace with new batteries.
BATTERIES SHOULD BE INSTALLED BY ADULTS ONLY.
Rechargeable batteries are not recommended.

FCC STATEMENTS

This device complies with part 15 of the FCC rules. Operation is subject to the following two conditions:
1) This device may not cause harmful interference, and
2) This device must accept any interference received, including interference that may cause undesired operation.

NOTE: This equipment has been tested and found to comply with the limits for a Class B digital device, pursuant to Part 15 of the FCC Rules. These limits are designed to provide reasonable protection against harmful interference in residential installation. This equipment generated, uses and can radiate radio frequency energy and if not installed and used in accordance with the instructions, may cause harmful to radio communications. However, there is no guarantee that interference will not occur in a particular installations. If this equipment does cause harmful interference to radio or television reception, which can be determined by turning equipment off and on, the user is encouraged to try to correct the interference by one or more of the following measure:

- Reorient or relocate the receiving antenna.
 - Increase the separation between the equipment and receiver.
 - Connect the equipment into an outlet on a circuit different from that to which the receiver is needed.
 - Consult the dealer or an experienced radio/TV technician for help.
 - Warning: Changes of modifications to this unit not expressly approved by the party responsible for compliance could void the user's authority to operate the equipment.
 - This product is compliance with the essential requirements and other relevant provisions of directive 1995/5/EC Color & contents may vary.
- Please keep this packaging for future reference. Conforms to the safety requirements of ASTM F963 and EN-71

R/C CONTROLLER:

TO REPLACE BATTERIES REFER TO THE FOLLOWING DIRECTIONS & ILLUSTRATION:

1. Use a phillips screwdriver to loosen and remove the screw of the battery compartment door as both sides. (Pic.1)
2. Remove the battery compartment door.
3. Remove old batteries and replace with . 1 new "6F22" 9V batteries following the (+) and (-) positioning stated in the battery compartment. Dispose of old batteries properly. (Pic.2)
4. Fasten the screw to secure battery compartment door

TRANSBOTIX ROBOT:

TO REPLACE BATTERIES REFER TO THE FOLLOWING DIRECTIONS & ILLUSTRATION:

1. Push the "ON/OFF" button to "OFF" position. (Pic.1)
2. Use a phillips screwdriver to loosen and remove the screw of the battery compartment door as shown.
3. Remove the battery compartment door. (Pic.2)
4. Remove old batteries and replace with 4 new "AAA" batteries following the (+) and (-) positioning stated in the battery compartment. Dispose of old batteries properly. (Pic.3)
5. Fasten the screw to secure battery compartment door.

CE AGES
0-3 5
AND UP

(BATTERIES NOT INCLUDED)

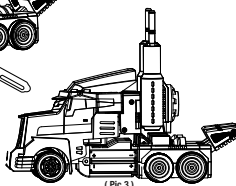
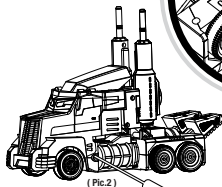
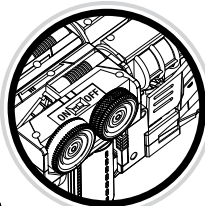
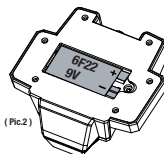
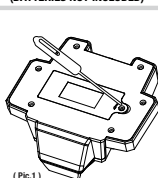

P.1

RC CONTROLLER

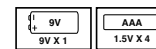
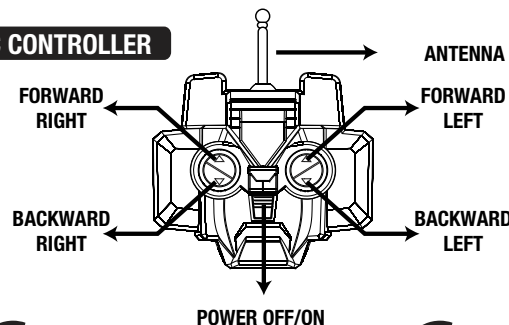

Requires 4 x 1.5v AAA batteries for Transbotix and 1x9v battery for transmitter (not included)

HOW TO MOVE - FORWARD

Press the upper left and forward button at the same time to move forward.

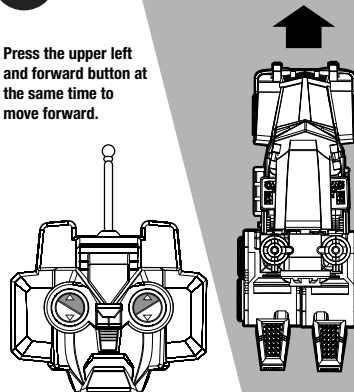

HOW TO MOVE - BACKWARD

Press the lower left and right backward button at the same time to move backward.

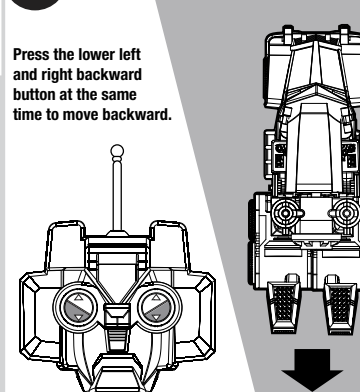

HOW TO CONTROL BY R/C

HOW TO TURN - RIGHT

Press the upper left forward button to turn RIGHT.

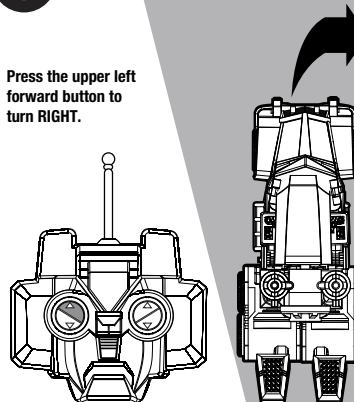

HOW TO TURN - LEFT

Press the upper right forward button to turn LEFT.

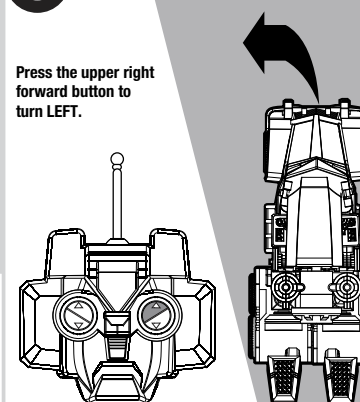

P.2

HOW TO TRANSFORM

STEP 1: TWISTING FOREARMS IN 90°

ROBOT MODE

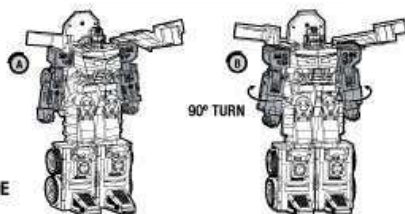

STEP 2: TWISTING ARMS IN 90°

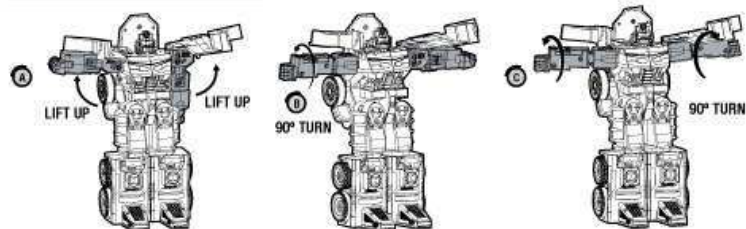

STEP 3: BODY & HEADS

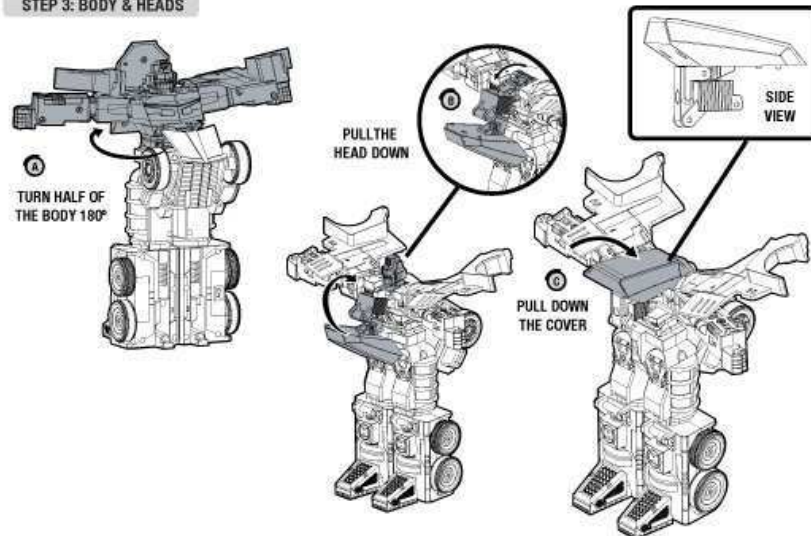

P.3

STEP 4: FOLDING BOTH ARMS

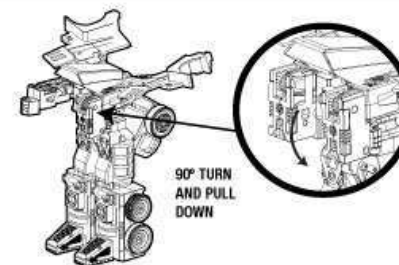
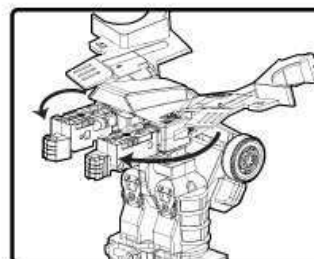

STEP 5: CLOSING 2 SIDES OF WINGS

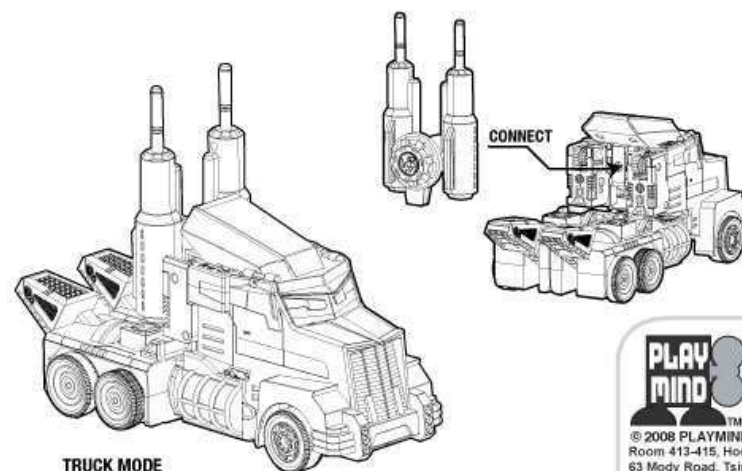
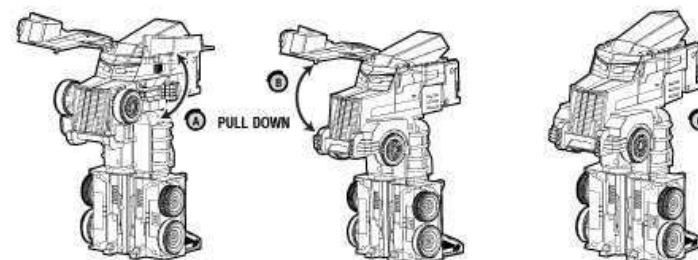

TRUCK MODE

P.4



© 2008 PLAYMIND LTD.
Room 413-415, Houston Centre,
63 Mody Road, Tsim Sha Tsui East,
Kowloon, Hong Kong
Visit us at: www.playmindltd.com

2008/7 REV. 1.0