

Specification:

PowerMeter (power measurement unit)

Number of strain gauge stripes: 8
Measurement accuracy: $\pm 2\%$

Data transmission: Wireless: ANT+sports protocol
 Cable: inductive, coil

Life span of battery: 1.500 hours

Shimano Dura-Ace 10 speed crank:

Cranks are available in lengths between 165 and 180mm
Integrated Axle Shimano Dura Ace FC7800

Chainrings: Bolt circle diameter: 130mm
 Chainring: 53/39
 other chainring combinations on request

Weight: 812g (incl. cranks, chainrings and axle)

Compatible with SRM PowerControl IV, V and VI

This PowerMeter is only available in the Professional Road version.

Installation of the front chainwheel

Follow the procedure in the figure.

- 1, 2 Use the special tool TL-FC32 to install the right adapter (counterclockwise thread) and the left adapter (clockwise thread).
Tightening torque: 35 - 50 N·m (305 - 435 in. lbs.)
- 3 Insert the right crank unit.
- 4 Set section A of the left crank into the axle of the right crank unit where the groove is wide.
(Insert a spacer when installing the FC-7803 left crank unit.)
- 5 Use the TL-FC16 to tighten the cap.
Tightening torque: 0.7 - 1.5 N·m (6 - 13 in. lbs.)
- 6 Push in the stopper plate and check that the plate pin is securely in place, and then tighten the bolt of the left crank arm.

Note : Each of the bolts should be evenly and equally tightened to 12 - 15 N·m (106 - 132 in. lbs.).

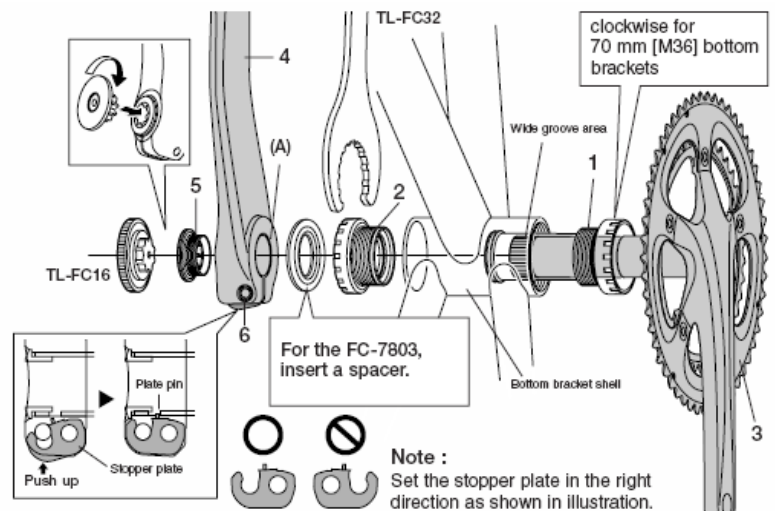

Sensor magnet mounting instructions

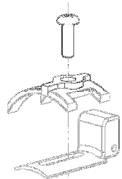

To mount the sensor magnet, remove the cable guide bolt and the cable guide below the bottom bracket.

Either remove the cable guide or slacken the cables to put the sensor cable between the guide and bottom bracket.

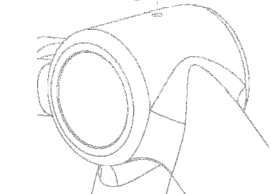

Adjust the sensor and then tighten the guide and bolt back on.

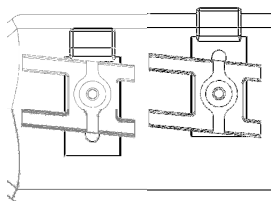

Important: Mount the sensor below the cable guide! Front and rear derailleur need to be adjusted if necessary!

The sensor cable housing has a long slit to adjust the distance to the lid of the Powermeter. It is essential that the clearance to the lid is at least 2-3 mm to prevent interferences or incorrect measurements.

Lastly, check to make sure you receive cadence and a zero offset as described in the PowerControl VI Short Manual. If the sensor cable moves you can use double stick tape to fix it to the bottom bracket.

Important Safety Instructions

After riding approximately 100 km (60 miles), use a torque wrench to re-check the tightening torques.

Please check

- on regular basis:
 - the tightening torques
 - that the tension of the chain is correct and that the chain is not damaged.
- before every ride:
 - that there are no cracks in the crank arms

Damages on the chain or the crank arm can cause that you fall off the bicycle, serious injuries or even death.

FCC Compliance

This device complies with part 15 of the FCC Rules. Operation is subject to the following two conditions:

1. this device may not cause harmful interference, and
2. this device must accept any interference received, including interference that may cause undesired operation.

This equipment has been tested and found to comply with the limits for a Class B digital device, pursuant to part 15 of the FCC rules. These limits are designed to provide reasonable protection against harmful interference in a residential installation. This equipment generates, uses, and can radiate radio frequency energy and may cause harmful interference to radio communications if not installed and used in accordance with the instructions. However, there is no guarantee that interference will not occur in a particular installation. If this equipment does cause harmful interference to radio or television reception, which can be determined by turning the equipment off and on, the user is encouraged to try to correct the interference by one of the following measures:

- Reorient or relocate the receiving antenna.
- Increase the separation between the equipment and the receiver
- Connect the equipment into an outlet that is on a different circuit from GPS unit.
- Consult the dealer or an experienced radio/TV technician for help.

This product does not contain any user-serviceable parts. Repairs should only be made by an authorized SRM service center. Unauthorized repairs or modifications could result in permanent damage to the equipment, and void your warranty and your authority to operate this device under Part 15 regulations.



Schoberer Rad Messtechnik GmbH
Rudolf Schulten Str. 6
D-52428 Jülich
Tel.: +49 (2461) 69123-0
Fax: +49 (2461) 69123-17

SRM Service Center Inc.
720 West Monument Street
Colorado Springs, CO 80904
USA
Tel.: +1 (719) 266 4127
Fax: +1 (719) 266 4284