

HX-P590

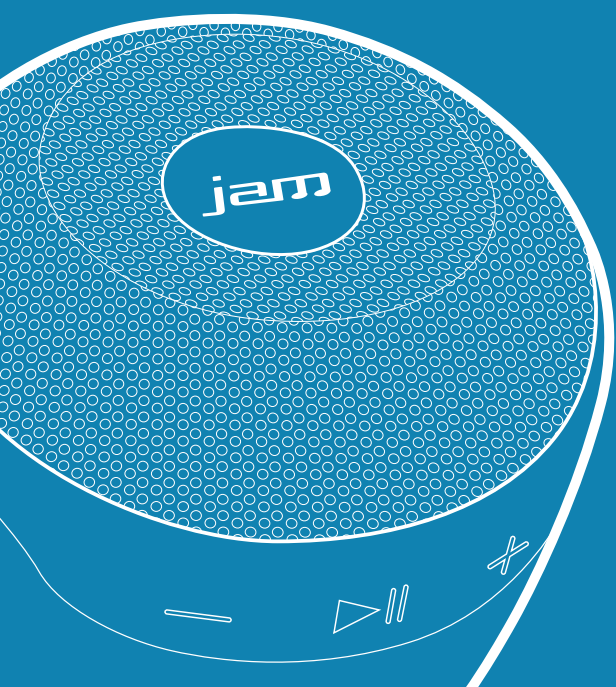

USER GUIDE

GUIDE DE L'UTILISATEUR / GUÍA DEL USUARIO



English.....	4
Français	24
Español	44



JUST TAP
AND ASK.

CONTENTS

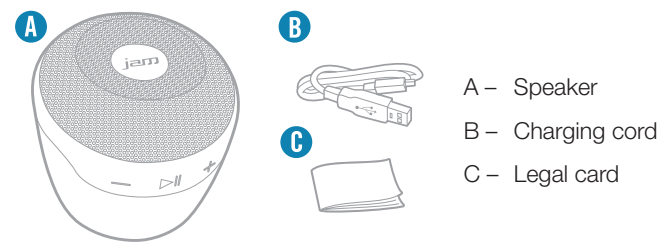

CHARGING

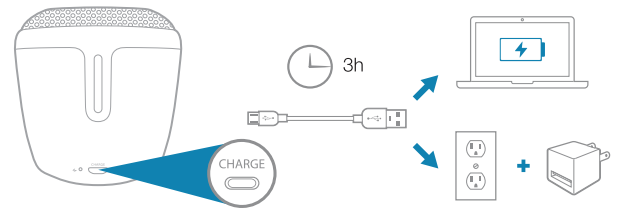

Charge X hours for up to X hours of play time over WiFi, or up to X hours using *Bluetooth*. AC adapter not included.

CONTROLS

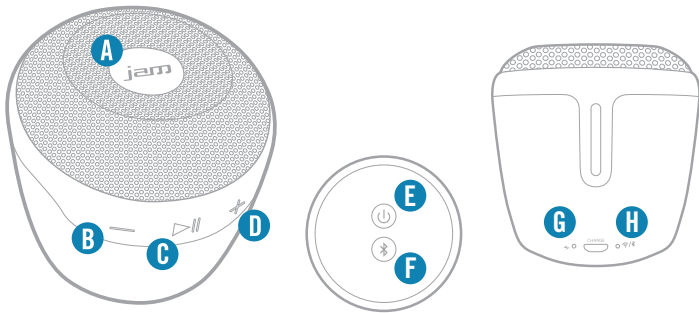

- A – Microphone button
- B – Volume down / previous track (⊖ 3s)
- C – Play/pause
- D – Volume up / next track (⊕ 3s)

- E – On/off
- F – Wi-Fi / *Bluetooth* mode selector
- G – Battery light
- H – Wi-Fi / *Bluetooth* light

Battery light

- Low battery
- Charging
- Ready

Wi-Fi / *Bluetooth* light

- Bluetooth* pairing mode
- Bluetooth* connected
- Ready to connect to WiFi network
- Connected to WiFi network

GETTING STARTED

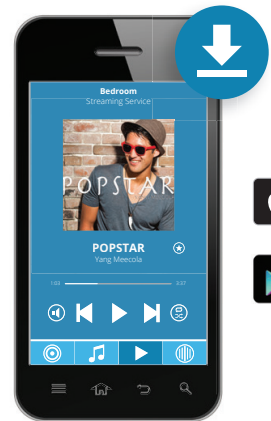

Download the JAM Wi-Fi app in the App Store or Google Play store, then install the app on your device.

CONNECTING TO WI-FI

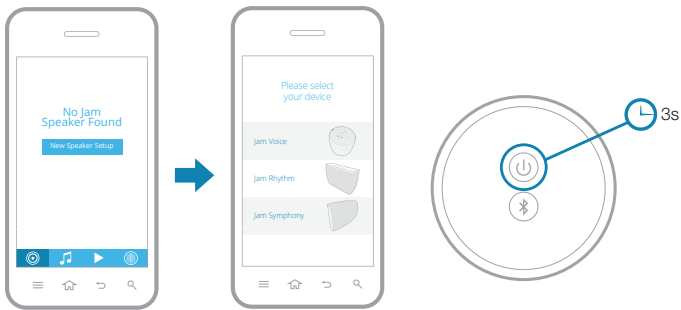

Ensure your device is connected to a wireless network, then open the JAM Wifi app. On the home screen, press New Speaker Setup to connect the speaker. You will be prompted to choose your speaker. Choose "JAM Voice" from the speaker list.

Power on your Jam Voice by pressing and holding the power button for 3 seconds. The LED light will flash white when ready to pair to your network.

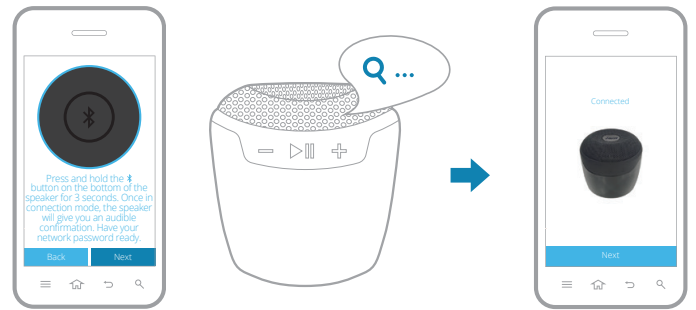

Have your wireless network password ready. Press and hold the [power] button on the bottom of your speaker for 3 seconds. After you do this, you will hear an audible confirmation: "Connecting to your network, this may take 1 – 3 minutes."

The app will prompt you to enter your network password. When connected, you will hear "Connected," the LED light on the speaker will turn solid white, and your app will show the above screen.

LOGGING INTO YOUR AMAZON ACCOUNT

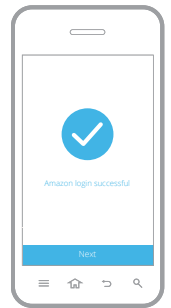
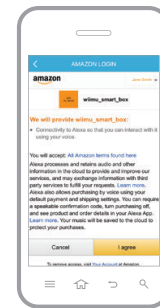
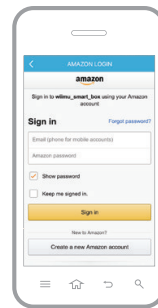
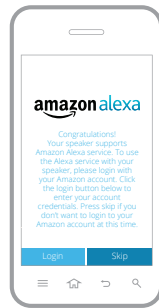

Once connected to your network, press the Login button to log in to your Amazon account, or skip this step. Note: You cannot utilize Alexa Voice Service if you are not logged into an Amazon account.

Sign into your Amazon account. If you do not already have an Amazon account, choose "Create a new Amazon account." It may take a few seconds for your account to load. Once logged in, the app will confirm your login successful. Note: You may be prompted to agree to Amazon terms before connecting.

USING ALEXA VOICE SERVICE

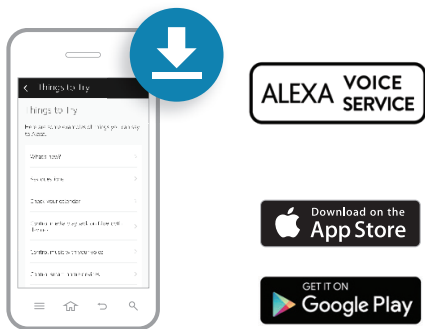

Download the Amazon Alexa app in the App Store or Google Play store where you can explore Things to Try, Alexa Skills, Smart Home Capabilities, and more.

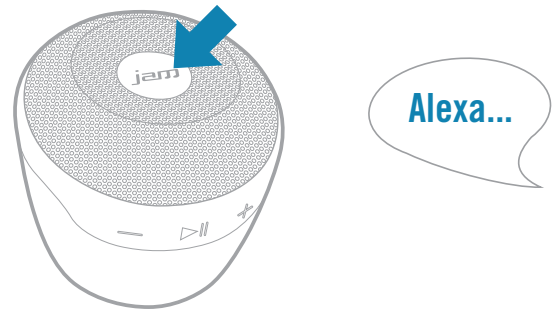

To activate Alexa, tap the JAM microphone button on the top of your speaker. You will hear a short tone. Next, ask Alexa a question, such as, “Alexa, what is the weather today in New York?” Or you can tell Alexa to do something, like, “Alexa, add milk to my shopping list,” or “Alexa, play jazz.”

LOGGING OUT OF YOUR AMAZON ACCOUNT

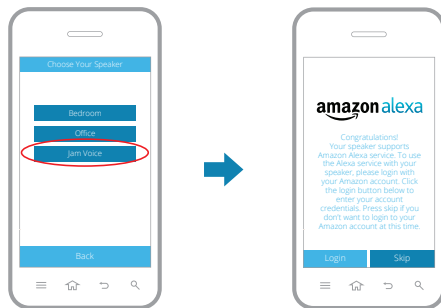

To log out of your Amazon account select the Amazon Alexa icon on your music source screen. You will then be prompted to choose your speaker and then choose to Login to your Amazon account.

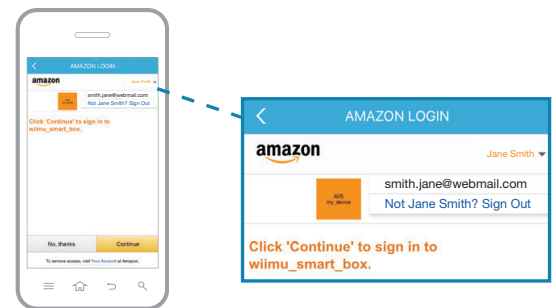

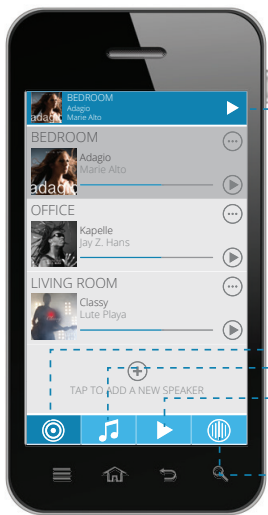

From this screen choose the account name in the right hand corner and choose "Sign out" from the drop down.

NAVIGATING THE JAM APP



Quick access play bar
View the current song and control the music.

 **Speaker screen**
View your speakers' activity.

 **Music source screen**
Select from your library or streaming services, and login to your Amazon account.

 **Now playing**
View the current song and control the music.

 **Intercom**
Talk through your speakers.

CHOOSE YOUR TUNES

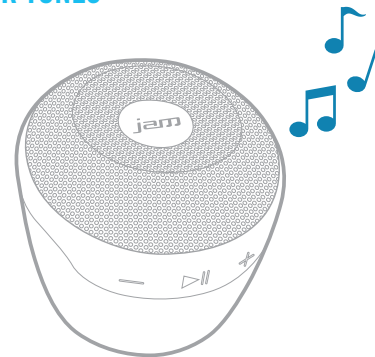

Press the  icon within the app to access the Music Source screen. Here you can easily play music from a variety of popular streaming services. You can also play your own music library without leaving the app, or log in to your Amazon account through the Amazon Alexa icon.

GROUPING AND UNGROUPING SPEAKERS

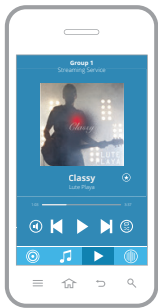

Grouping your speakers allows you to play the same music through multiple speakers.

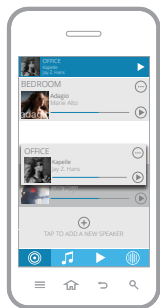

Within the app, press and hold the speaker you would like to group. Drag and drop to pair it with another speaker or add it to an existing group of speakers.

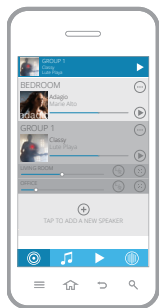

The speaker that you are dropping into (or the first speaker listed in a group) is the master speaker.

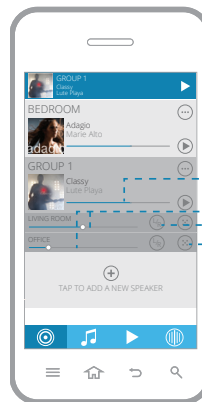

- Control the volume of all speakers in the group
- Control the volume of individual speakers
- Toggle between stereo, left, and right channels
- Release speaker from the group (release the master speaker to disband the entire group)

SPEAKER SETTINGS

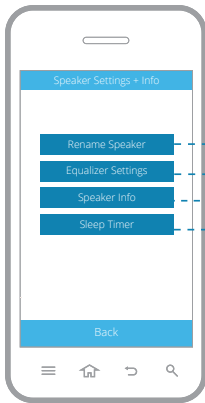
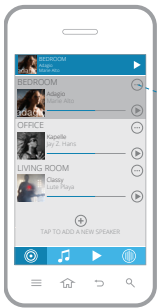

- Give your speaker a name, like Bedroom or Office
- Adjust the speaker's bass and treble
- Find info about your speaker and connectivity
- Set a sleep timer up to 4 hours

Tap next to a speaker to access its settings and information

SPEAKER INFO SCREEN

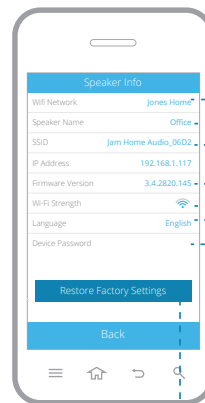

- The name of the WiFi network your speaker is connected to
- The name of your speaker
- Your speaker's SSID
- Your speaker's IP address
- The version number of your speaker's firmware
- The strength of the WiFi signal your speaker is receiving
- Choose the language of your speaker's audible prompts
- Your speaker's network password
- Restore your speaker to its original factory settings

USING THE INTERCOM

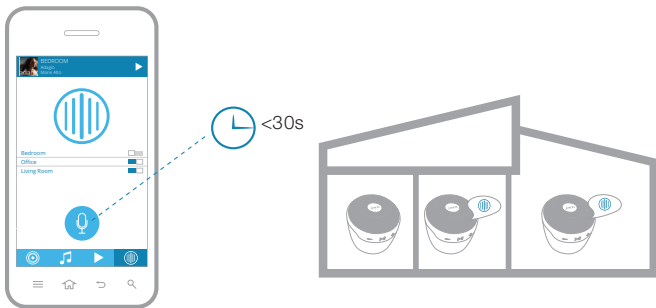

Press the  icon within the app, then use the toggle buttons to select the speaker(s) you'd like to broadcast to. Press and hold the microphone icon while saying your message (up to 30 seconds).

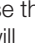
When finished, release the  icon. The message will then play on all selected speakers.

SPEAKER FIRMWARE UPDATE

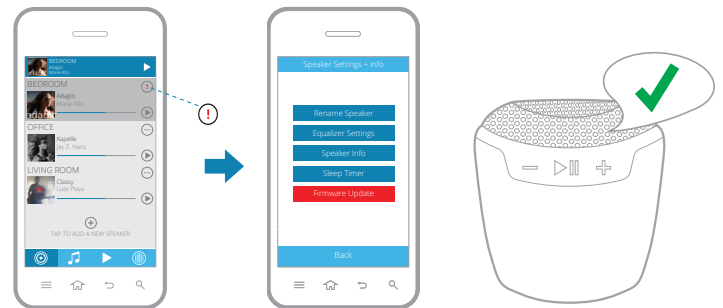

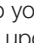
If you see  next to your speaker, a firmware update is available. Press the  icon and select Firmware Update from the menu.

Tap Download and Install to start the update. When complete, the speaker will provide an audible confirmation.

STREAM YOUR MUSIC ON THE GO

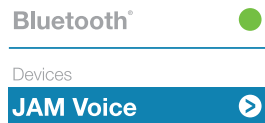
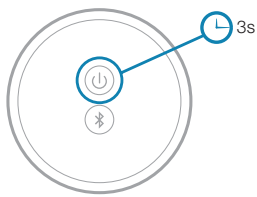

Power on your speaker by pressing and holding power button for 3 seconds. Your speaker will automatically go into WiFi mode. To switch to Bluetooth mode quickly, press the button on the bottom of your speaker and the LED light will switch to blinking blue.

Enable Bluetooth on your device and choose JAM Voice from the list. If prompted, enter code "0000."

RESET OR RESTORE YOUR SPEAKER

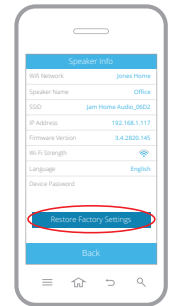
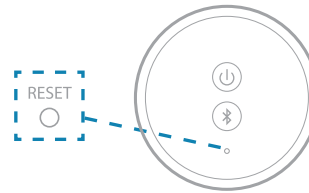

If you need to reset your speaker, use a paperclip to press the reset button on the bottom of your speaker. To completely restore your speaker to factory settings, choose "Restore Factory Settings" from the speaker info screen within the app or press and hold the the Bluetooth icon and power button together for 5 seconds.

CARE AND MAINTENANCE

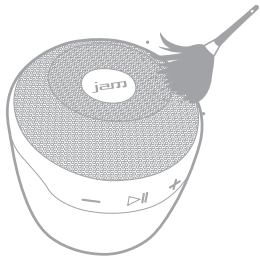

Gently dust your speaker with a soft, dry towel. Using water or harsh cleansers is not recommended.

STUFF OUR LAWYERS MAKE US SAY

ENGLISH

1 Year Limited Warranty

For detailed warranty instructions and information visit:
USA: www.jamaudio.com/customer-support/warranty-1yr
CAN: canada.jamaudio.com/warranty-1yr

To obtain warranty service on your JAM product, contact a Consumer Relations representative by telephone or email for assistance (you can find their contact info on page 1). Please make sure to have the model number of the product available.

FCC Compliance:

Note: This device complies with part 15 of the FCC Rules. Operation is subject to the following two conditions: (1) This device may not cause harmful interference, and (2) this device must accept any interference received, including interference that may cause undesired operation.

Note: This equipment has been tested and found to comply with the limits for a Class B digital device, pursuant to part 15 of the FCC Rules. These limits are designed to provide reasonable protection against harmful interference in a residential installation.

This equipment generates, uses, and can radiate radio frequency energy and, if not installed and used in accordance with the instructions, may cause harmful interference to radio communications. However, there is no guarantee that interference will not occur in a particular installation.

If this equipment does cause harmful interference to radio or television reception, which can be determined by turning the equipment off and on, the user is encouraged to try to correct the interference by one or more of the following measures:

- Reorient or relocate the receiving antenna.
- Increase the separation between the equipment and receiver.
- Connect the equipment into an outlet on a circuit different from that to which the receiver is connected.
- Consult the dealer or an experienced radio/TV technician for help.

Note: Changes or modifications not expressly approved by HMDX could void the user's authority to operate this equipment.

IC Caution: RSS-GEN Issue 4 November 2014

This device complies with Industry Canada's licence-exempt RSSs.

Operation is subject to the following two conditions: (1) This device may not cause interference, and (2) This device must accept any interference, including interference that may cause undesired operation of the device.

IMPORTANT SAFEGUARDS:

When using an electrical product, basic precautions should always be followed, including the following:

READ ALL INSTRUCTIONS BEFORE USING

- **WARNING:** Do not place speakers too close to ears. May cause damage to eardrums, especially in young children.
- Use this product only for its intended use as described in this manual. Do not use attachments not recommended by HMDX.
- HMDX is not liable for any damage caused to smartphones, iPod/MP3 players, or any other device.
- Do not place or store this product where it can fall or be dropped into a tub or sink.
- Do not place or drop into water or any other liquid.

- Not for use by children. THIS IS NOT A TOY.
- Never operate this product if it has a damaged cord, plug, cable, or housing.
- Keep away from heated surfaces.
- Only set on dry surfaces. Do not place on surface wet from water or cleaning solvents.

Attention California Residents:

WARNING: This product contains chemicals known to the State of California to cause cancer, birth defects, and other reproductive harm.

WARNING:

This product contains small parts that may present a choking hazard for young children.

CAUTION: All servicing of this product must be performed by authorized HMDX Service Personnel only.

The Spotify word mark and logos are registered trademarks of Spotify and are used under license by HoMedics, LLC.

The Spotify software is subject to third party licenses found here: www.spotify.com/connect/third-party-licenses

The iHeart word mark and logos are registered trademarks of iHeart and are used under license by HoMedics, LLC.

Google, Android, and Google Play word mark and logos are registered trademarks of Google and are used under license by HoMedics, LLC.

App Store is a service mark of Apple Inc. The Apple logo is a trademark of Apple Inc., registered in the U.S. and other countries. IOS is a trademark or registered trademark of Cisco in the U.S. and other countries and is used under license by Apple Inc.

All other trademarks and all other trade names belong to their respective owners.

