



Hisense Sero 7 Pro
Quick Start Guide

1. Getting Started

Welcome to Sero

To start, turn on your Sero by pressing and holding Power button until the Hisense logo appears. After boot animation, follow the on-screen instructions to set up your Sero.

1. Select the Language for your Sero
2. Connect to a Wi-Fi® network, sign in your Google Account

NOTE When you sign in with a Google Account, *step 4~6* will be cancelled.

3. Set the options about Google and location
4. Set the date and time of your Sero
5. Enter the owner name
6. Read the Google services
7. Sign up the VUDU account

Charge your Sero

Plug your Sero into a wall outlet using the Power Adapter and Micro-USB Cable included with your accessories.

NOTE To charge your Sero, you can plug it into a wall outlet. Also, your Sero will charge when connected to a computer. For more information, see *User Manual*. If Sero can not boot-up after not being used for a long time, please charge for about 30-60 minutes.

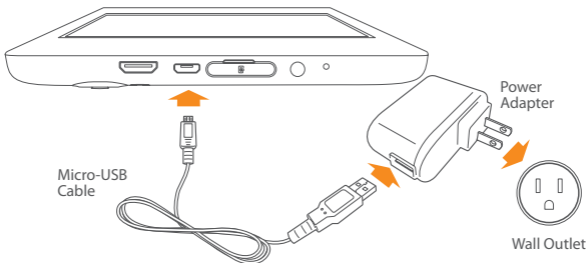

Unlock your Sero

To unlock your Sero after waking it from sleep mode, press the lock icon and drag it to the ridge of the circle.

Get to know your Sero



No.	Function	No.	Function
1	Power Button Press and hold it to turn on/off; Press it to put/wake the unit in/from sleep mode	8	Headphone jack
2	Volume Buttons	9	Status Bar Give status information about the unit. Press and drag it to check more information
3	Front Camera	10	App Icons
4	Rear Camera	11	WLAN and Bluetooth Antenna NOTE Avoid holding this region when using WLAN or Bluetooth.
5	Mini-HDMI jack	12	GPS Antenna
6	Micro-USB jack	13	NFC Antenna
7	Micro SD jack		

NOTE VUDU® and TEGRA ZONE® can not be uninstalled.

2. Touch navigation



Tap or Double Tap

To select a feature or item, touch your finger quickly to the screen.

Double tap your finger quickly on an item to bring up more details.



Press & Hold

Touch your finger to the screen and hold it there for approximately 2 seconds.

In many situations, pressing and holding will open a menu.



Slide or Drag

Touch your finger to the screen and slide it to another location on the screen.

Press and hold on an object and slide it to another location on the screen.



Zoom

Place two fingers about an inch apart on the screen. Slide them together to “zoom out”.

Slide your fingers apart to “zoom in”.



Rotate

Place two fingers about an inch apart on the screen.

Rotate them in clockwise or anti-clockwise.

3. Important Safety Instructions



WARNING
RISK OF ELECTRIC SHOCK
DO NOT OPEN



WARNING: TO REDUCE THE RISK OF ELECTRIC SHOCK, DO NOT REMOVE COVER OR BACK. NO USER-SERVICEABLE PARTS INSIDE. REFER SERVICING TO QUALIFIED SERVICE PERSONNEL.



The lightning flash with arrow head symbol, within an equilateral triangle is intended to alert the user that parts inside the product constitute a risk of electric shock to persons.



The exclamation point within an equilateral triangle is intended to alert the user that important operating and servicing instructions are in the papers with the appliance.

1. Read these instructions.
2. Keep these instructions.
3. Heed all warnings.
4. Follow all instructions.
5. Do not defeat the safety purpose of the polarized or grounding-type plug. A polarized plug has two blades with one wider than the other. A grounding type plug has two blades and a third grounding prong. The wide blade or the third prong are provided for your safety. If the provided plug does not fit into your outlet, consult an electrician for replacement of the obsolete outlet.
6. Protect the power cord from being walked on or pinched particularly at plugs, convenience receptacles, and the point where they exit from the unit.
7. Only use attachments/accessories specified by the manufacturer.
8. Refer all servicing to qualified service personnel. Servicing is required when

the unit has been damaged in any way, such as power-supply cord or plug is damaged, liquid has been spilled or objects have fallen into the unit, the unit has been exposed to rain or moisture, does not operate normally, or has been dropped.

9. Do not install near any heat sources such as radiators, heat registers, stoves, or other units (including amplifiers) that produce heat.
10. Unplug this unit during lightning storms or when unused for long periods of time.

Warning

- All packing materials such as internal bags, plastic collars, plastic films, and carton inserts are not part of this product and should be discarded.
- Do not try to disassemble the unit.
- Plug your Sero into a wall outlet to charge, only use the power adapter supplied with Sero.
- Do not expose the unit to moisture or water.
- Keep the unit clean by wiping it with a slightly damp cloth.
- To prevent hearing damage, never use headphones at excessive volume levels. Listening to loud sounds for an extended period may cause temporary or permanent hearing loss.
- Never use Sero while operating a motor vehicle or bicycle.
- If you feel discomfort in your hands or any pain using Sero, please stop immediately.
- In case of long periods of use, take frequent breaks.
- If a small part is coming out of the Sero, do not try to remove it. Keep it away from small children.
- Never force a connector into a port of Sero. If a connector and a port do not join with reasonable force, make sure that the connector matches the port and that you have positioned the connector correctly in relation to the port.
- To clean the screen, simply use a soft damp cloth. Do not use alcohol, solvent, aerosol spray or abrasive cleaners to clean your Sero.
- The product and the adapter should be periodically examined for conditions that may result in the risk of fire, electric shock, or injury to persons and that, in an event such conditions, the adapter should not be used until properly repaired.

- Operate Sero in a place where the temperature is between 0° and 35° C (32° to 95° F). Low - or high - temperature conditions might temporarily shorten battery life or cause Sero to temporarily stop working properly. Avoid dramatic changes in temperature or humidity when using Sero, as condensation may form on or within Sero.
- Store Sero in a place where the temperature is between -20° and 45° C (-4° to 113° F). Don't leave Sero in your car, because temperatures in parked cars can exceed this range.
- When you're using Sero or charging the battery, it is normal for Sero to get warm. The exterior of Sero functions as a cooling surface that transfers heat from inside the unit to the cooler air outside.
- The rechargeable battery in Sero should be replaced only by Hisense Service.
- A warning that batteries (battery pack or batteries installed) shall not be exposed to excessive heat such as sunshine, fire or the like.
- In order to maximize the battery lifespan of Sero, fully charging and discharging the battery every three months is recommended if Sero is not used frequently.
- In order to maximize the battery lifespan of Sero, to keep the battery level at around 50% is recommended if Sero is not used frequently.
- If Sero has not been used for a long period of time, the battery might be in over-discharge protection mode and may take longer to charge the battery.
- This device is restricted to indoor use when operating in the 5.15 to 5.25 GHz frequency band.
- The Wi-Fi function and the Bluetooth function can simultaneously operate, but can not simultaneously transmit.
- Never remove or insert microSD card while the Sero is powered on.
- The manufacturer is not responsible for any radio or TV interference caused by unauthorized modifications to this equipment. Such modifications could void the user's authority to operate the equipment.
- Sero North America edition is limited using channel 1-11. This limited operation can be only set by software and was done before the product down from the product line. All the products for North America marketing were embedded this limited before shipping. Customers have no way to choose the channel 12 & 13.

4. Certification and Compliance

Exposure to Radio Frequency Energy

Sero contains radio transmitters and receivers. When on, Sero sends and receives radio frequency (RF) energy through its antenna. The WLAN and Bluetooth® antenna is located **11** in back view of “Get to know your Sero”. Sero has been tested and meets the SAR exposure requirements for WLAN and Bluetooth operation.

Sero is designed and manufactured to comply with the limits for exposure to RF energy set by the Federal Communications Commission (FCC) of the United State. The exposure standard employs a unit of measurement known as the specific absorption rate, or SAR. The SAR limit applicable to Sero set by the FCC is 1.6 watts per kilogram (W/kg). Tests for SAR are conducted using standard operating positions specified by these agencies, with Sero transmitting at its highest certified power level in all tested frequency bands. Although SAR is determined at the highest certified power level in each frequency band, the actual SAR level of Sero while in operation can be well below the maximum value because Sero adjusts its WLAN transmitting power based in part on orientation and proximity to the wireless network. In general, the closer you are to a WLAN Router, the lower the WLAN transmitting power level.

Sero has been tested, and meets the FCC RF exposure guidelines for WLAN and Bluetooth operation. When tested at direct body contact, Sero’s maximum SAR value for each frequency band is outlined below:

FCC SAR

Frequency Band (MHz)	FCC 1g SAR Limit (W/kg)	Highest Value (W/kg)
Model: M470BSA		
2412-2462	1.6	1.059
5180-5240	1.6	0.7987
5260-5320	1.6	0.751
5745-5805	1.6	0.692

Additional Information For more information from the FCC about exposure to RF energy, see: www.fcc.gov/oet/rfsafety

The FCC and the U.S. Food and Drug Administration (FDA) also maintain a consumer website at www.fda.gov/Radiation-EmittingProducts/default.htm to address inquiries about the safety of mobile phones. Check the website periodically for updates.

For information about the scientific research related to RF energy exposure, see the EMF Research Database maintained by the World Health Organization at: www.who.int/emf

FCC Compliance Statement

This device complies with part 15 of the FCC rules. Operation is subject to the following two conditions: (1) this device may not cause harmful interference, and (2) this device must accept any interference received, including interference that may cause undesired operation.

NOTE This equipment has been tested and found to comply with the limits for a Class B digital device, pursuant to part 15 of the FCC Rules. These limits are designed to provide reasonable protection against harmful interference in a residential installation. This equipment generates, uses and can radiate radio frequency energy and, if not installed and used in accordance with the instructions, may cause harmful interference to radio communications. However, there is no guarantee that interference will not occur in a particular installation. If this equipment does cause harmful interference to radio or television reception, which can be determined by turning the equipment off and on, the user is encouraged to try to correct the interference by one or more of the following measures:

- Reorient or relocate the receiving antenna.
- Increase the separation between the equipment and receiver.
- Connect the equipment to an outlet on a circuit different from that to which the receiver is connected.
- Consult the dealer or an experienced radio/TV technician for help.



Model: M470BSA

FCC ID: W9HPADP0001

Disposal and Recycling Information



The symbol above means that according to local laws and regulations your product should be disposed of separately from household waste. When this product reaches its end of life, take it to a collection point designated by local authorities. Some collection points accept products for free. The separate collection and recycling of your product at the time of disposal will help conserve natural resources and ensure that it is recycled in a manner that protects human health and the environment.

5. Learn More

User Manual

In addition to this *Quick Start Guide*, please read the *User Manual* for complete information about all the features and functions of your Seró.

The PDF version of this *User Manual* can be downloaded at www.hisense-usa.com/support/manuals.asp.

Additional Support

For additional support information, please visit www.hisense-usa.com/support for:

- Product Registration.
- Accessories.
- Frequently asked questions.
- Firmware updates.
- Warranty Information.

You can also call our Electronics Consumer Care Center at 1-888-935-8880 or Email Service@hisense-usa.com.



This Tablet PC incorporates High-Definition Multimedia Interface (HDMI™) technology.

HDMI, the HDMI logo and High-Definition Multimedia Interface are trademarks or registered trademarks of HDMI Licensing LLC.

Hisense and associated logos where applicable are registered trademarks of Hisense Group in the United States and/or other countries. All other trademarks are property of their respective owners. 2013 Hisense USA, Corporation. All Rights Reserved.

Ver. 13.01
Printed in China



<http://hisense-usa.com/tablets>

ES-T130301

条形码

2 XXXX - 1128830 - 1111 - 1111