

### 1 ACCESSORIES LIST

- User Manual
- Quick Setup Guide
- Screw (M5 × 12) × 4
- Remote Control
- Batteries AAA × 2

### 2 INSTALLING THE STAND

Follow the illustrations below to complete the installation steps.

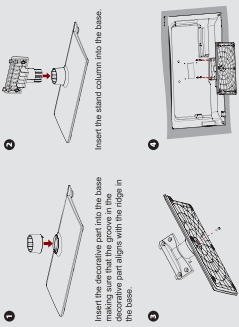

- Insert the decorative part into the base. The decorative part will fit into the slot on the bottom of the base.
- Insert the stand column into the base. The stand column will fit into the slot on the bottom of the base.
- Secure the stand column to the base with 1 screw (M4×12) provided.
- Secure the base stand to the TV with 4 screws (M5×12) provided.

**NOTE**  
Product images are only for reference. Actual product may vary in appearance. Carefully place your TV on a soft, cushioned surface to prevent damage to the TV or scratching to the screen.

### 3 INSTALLING A WALL-MOUNT BRACKET

If you want to attach the TV to a wall-mount bracket (not provided), you should first remove the stand if it is pre-attached.

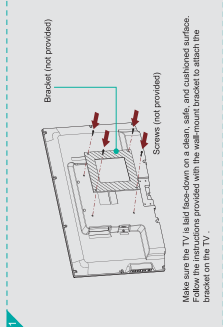

Note: As the TV is fixed to the wall, you should use a soft, cushioned surface. Follow the instructions provided with the wall-mount bracket to attach the bracket on the TV.

### 4 WARNING

- Do not touch the TV screen. The TV is not designed to be touched. Do not use long screws (not provided) which are 2 mm in length when measuring from the attaching surface of the mounting bracket.
- Be sure to use the provided spacers between the TV and the bracket when attaching the mount.
- Follow instructions provided with the wall bracket.
  - If you are not sure of your ability to complete the installation, contact a professional installer or service technician for assistance. The manufacturer is not responsible for any damages or injuries that occur due to misreading or incorrect assembly.
  - Be sure to use the provided spacers between the TV and the bracket when attaching the mount.

### 4 BUTTONS AND CONNECTORS

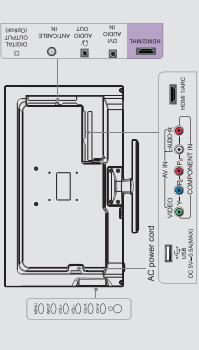

Item	Description
MENU	Display the on-screen menu to setup your TV's features.
INPUT	Select the different input signal sources.
VOL+/-	Adjust the volume.
CH A/V	Select the channel.
(Power button)	Turn on the TV or put the TV in standby mode. Caution: The TV continues to receive power even in standby mode.
ANTICABLE	Connect an antenna or cable TV to this jack.
HDMI	HDMI (High-Definition Multimedia Interface) provides an uncompressed, digital audio/video interface between this TV and any digital device, such as a set-top box. It also supports AV receivers and other AV devices. Connect the HDMI cable to the HDMI port on the TV and the HDMI cable to the HDMI port on the external video device.
COMPONENT IN	Connect to a DVD player, Digital Set-Top-Box, or other AV devices (1080P) audio and video and audio (L/R) output jacks on external video devices.
AV IN	Connect to a PC or other devices with a 3.5mm TRS jack.
DVI AUDIO IN	Connect headphones or speaker system using 3.5mm TRS jack. (10W stereo mini to L/R phone not provided).
DIGITAL OUTPUT	Connect an audio amplifier to this jack.
USB	Port for Digital Media Player and for software updates.

### 5 REMOTE CONTROL

**NOTE**  
The full battery set available for this model.

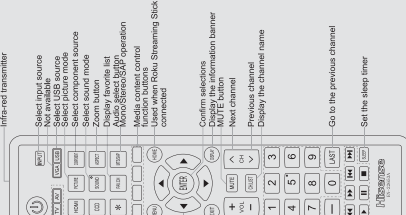

- Power on/off
- Select TV / AV source
- Adjust channel mode
- Used when the Remote Control is in Sleep mode
- MENU button
- More Up/Down with light
- Close the menu
- Increase volume
- Decrease volume
- Direct channel selection
- Select a signal sub-channel
- Media content control button
- Go to the previous channel
- Set the sleep timer

### CHANGE THE BATTERIES

- Slide the back cover to open the battery compartment of the remote control.
- Insert two AAA size batteries. Make sure to match the (+) and (-) ends of the batteries with the (+) and (-) ends positioned in the battery compartment.
- Close the battery compartment cover.



### 6 TV CONNECTORS

Check the jacks for position and type before making any connections. Loose connections can result in image or color problems. Make sure that all connections are tight and secure.

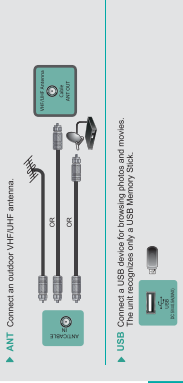

**ANT** Connect an outdoor VHF/UHF antenna.

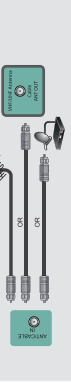

**USB** Connect a USB device for browsing photos and movies. The unit recognizes only a USB Memory Stick.

### 8 TURNING THE TV ON FOR THE FIRST TIME

**▶ Menu Language**

Settings are in English (French, or Spanish). To change the menu language, press [ENTER] button to confirm.

**▶ Picture Mode**

Picture mode is set to Realistic. To change the picture mode, press [ENTER] button to confirm.

**▶ Time Setting**

Time Zone: Select the local time zone according to your location. To select the time zone, press [ENTER] button to confirm. Press [Left] to select the number you want to set and press [Enter] to go to the next item.

**▶ TV Source**

Press [Enter] to select your TV Source: Antenna or Cable. If you select Cable, a message appears: "Are you sure you want to set the TV source to Cable?" Press [Enter] to exit the setting, a message appears: "Please Run Channel Auto Scan". Press [Enter] to scan channels from the menu of Channels.

### 9 HELP TOPICS

If you see a cable or satellite box connected to the TV, you should select the cable option. If you see a cable or satellite box connected to an AV Component or HDMI, you should select the cable option. If you see a cable or satellite box connected to an AV Component or HDMI, you should select the cable option. If you see a cable or satellite box connected to an AV Component or HDMI, you should select the cable option.

### POSSIBLE SOLUTIONS

- Confirm power cord is plugged into the AC outlet and the AC outlet is getting electricity.
- Attempt to power on unit using the power button on both the TV and the remote.
- Check the volume settings.
- Check the input mode for "TV".
- Check for the correct output connection on the external source and for the correct input connection on the TV.
- Make sure you have made the correct selection for the input mode for the incoming signal.
- If black and white picture first using TV from AC outlet and repeat after 60 seconds.
- Check Color Setting if picture is black and white.
- An electrical appliance may be affecting TV set. Turn off any appliances, if interference goes away, move appliance further away from TV.
- Insert the power plug of the TV set into another power outlet.
- If using an external antenna, check the direction, position and connection of the antenna.
- Adjust the direction of your antenna or reset of the TV to the channel.
- After switching to Cable, please auto program the channels. The TV will "remember" all the channels then the TV will allow you to surf the channels with [CH/V] buttons.

### REMOTE CONTROL DOES NOT WORK

- Confirm that TV still has power and is operational.
- Confirm that the remote control is fully charged.
- Check if the batteries are correctly installed.
- Clean the front of the remote control (LED window).
- If using a universal remote, be sure to select the TV mode on the remote.
- Remove and reinsert the batteries correctly to reset the remote or install new batteries.
- Press the Power button turn on the TV. With an universal remote if you have reset or changed the batteries this time, the camera should set on camera mode, not play mode). Observe the camera screen while you use the remote control. If the camera screen is not working, the remote control may be broken. If the remote control is not working, you need to repair or replace the remote control.

### 7 SPECIFICATIONS

Model Name	K20D0
Dimension	Without Stand: 28.98×19.40×3.97 inches (735.7×494.3×101.1 mm) With Stand: 28.98×19.40×3.97 inches (735.7×494.3×101.1 mm)
Weight	Without Stand: 12.13 lbs (5.5 kg) With Stand: 12.32 lbs (5.6 kg)
Active Screen Size (Diagonal)	31.5 inches
Audio power	6W × 6W
Power supply	120 V ~ 60 Hz
Receiving systems	NTSC
Receiving channels	Auto Tuning, Manual Tuning, Channel Memory
Tuner type	VHF 2-13 UHF 14-69 CATV 1 ~ 125
Environmental conditions	Digital Terrestrial Broadcast (DVB-T) 2 ~ 69 Digital Terrestrial Broadcast (DVB-T2) 1 ~ 135 Temperature: 41°F ~ 98°F (5°C ~ 36°C) Humidity: 20% ~ 85% RH
Component Input	RGB 160 Hz (604×480, 828×480, 1024×768) YUV 60 Hz (480i, 480 P, 720 P, 1080i, 1080 P)
HDMI Input	