

Remote Control

RSAG8.805.5097

FCC Notice

- This device complies with Part 15 of the FCC Rules. Operation is subject to the following two conditions: (1) this device may not cause harmful interference, and (2) this device must accept any interference received, including interference that may cause undesired operation.
- The manufacturer is not responsible for any radio or TV interference caused by unauthorized modifications to this equipment. Such modifications could void the user's authority to operate the equipment.

Industry Canada Notice

- This device complies with industry Canada license-exempt RSS standards(s). Operation is subject to the following two conditions: (1) this device may not cause interference, and (2) this device must accept any interference ,

Remote Control

including interference that may cause undesired operation of the device.

- Le présent appareil est conforme aux CNR d'Industrie Canada applicables aux appareils radio exempts de licence. L'exploitation est autorisée aux deux conditions suivantes: (1) l'appareil ne doit pas produire de brouillage, et (2) l'utilisateur de l'appareil doit accepter tout brouillage radioélectrique subi, même si le brouillage est susceptible d'en compromettre le fonctionnement.
- Under industry Canada regulations, this radio transmitter may only operate using an antenna of a type and maximum (or lesser) gain approved for the transmitter by industry Canada. To reduce potential radio interference to other users, the antenna type and its gain should be so chosen that the equivalent isotropically radiated power (e.i.r.p.) is not more than that necessary for successful communication. Conformément à la réglementation d'Industrie Canada, le présent

Remote Control

émetteur radio peut fonctionner avec une antenne d'un type et d'un gain maximal (ou inférieur) approuvé pour l'émetteur par Industrie

- Canada. Dans le but de réduire les risques de brouillage radioélectrique à l'intention des autres utilisateurs, il faut choisir le type d'antenne et son gain de sorte que la puissance isotrope rayonnée équivalente (p.i.r.e.) ne dépasse pas l'intensité nécessaire à l'établissement d'une communication satisfaisante.

FCC RF Safety Caution Statement

- This equipment complies with FCC RF radiation exposure limits set forth for an uncontrolled environment. This equipment must be installed and operated in accordance with provided instructions and must not be co-located or operating in conjunction with any other antenna or transmitter. End-users and installers must be provided with antenna installation instructions and transmitter operating conditions for satisfying RF

Remote Control

exposure compliance.

RF Exposure Statement for Canada

- The radiated output power of the Wireless Device is below the Industry Canada (IC) radio frequency exposure limits. The Wireless Device should be used in such a manner such that the potential for human contact during normal operation is minimized.

La puissance de sortie émise par l'appareil de sans fil Dell est inférieure à la limite d'exposition aux fréquences radio d'Industry Canada (IC). Utilisez l'appareil de sans fil Dell de façon à minimiser les contacts humains lors du fonctionnement normal.

Introduction

- The ERF6C11 remote control is a multifunction device that contains conventional TV buttons, the air mouse function, and the voice input feature. It can transmit

Remote Control

signals by two kind of modes, the infrared and the standard Bluetooth mode. When it works in infrared mode, the red indicator light flashes, while when it works in Bluetooth mode, it's the blue indicator light flashing.

- In the infrared mode, the air mouse experience is unusable. When the Bluetooth mode is activated, the air mouse is off in the default mode to save energy, but you can lightly shaking the remote control to activate the air mouse, and when you want to turn it off, just press the any arrow key.

Remote Control

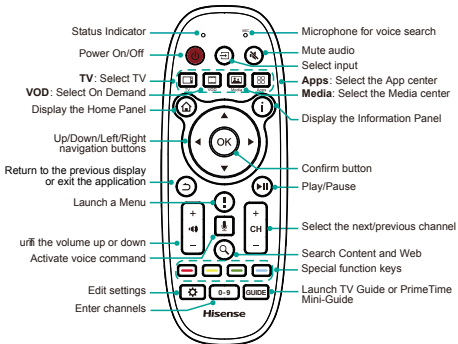

Remote Control

Pairing the Remote

The air mouse and microphone functions are available after the remote control is paired.

- **The First Method**

The Setup Wizard menu appears the first time you turn on the TV. Step of the remote pairing, press and hold down the [Red] and [OK] buttons simultaneously until the red LED turns on. When the red LED lights, release the buttons and wait for the TV to pair with the remote. The blue LED on the remote control will flash three times when the pairing is successfully completed.

Remote Control

● The Second Method

If the remote failed to automatically pair with the TV, you can manually pair the TV by following the steps below:

1. Enter **Settings > Wireless and networks > Bluetooth** to turn on **Bluetooth**.
2. Press and hold the [Red] button and [OK] button for three seconds simultaneously.
3. Select Find nearby devices to search the remote control, and the remote control will appear in available devices, then press [▲/▼] button to select the Hisense Remote Control and press [OK] to pair.

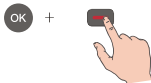

Remote Control

- The LED on the remote control will blink with each key press.
- In pairing mode, the LED will light continuously for ~60-seconds.
- When pairing is complete, the LED will flash three times.
- The LED light will blink continuously when the battery is low.
- Sleep Mode To conserve battery life, the remote control will automatically go into sleep mode thirty seconds after the last key press. Any movement or key press will immediately wake up the remote.

Battery Specification

AA 1.5V *2 , Alkaline battery

- When the battery is too low, the voice input may be automatically turned off, and you will find 'The battery of remote control is low, and the microphone stops working' displayed on TV screen.

Remote Control

- If you found there is no response of the red and blue lights indicators after pressing a button, you may need to reinstall or replace the batteries.

NOTES:

- The red LED must be on during Find nearby devices.
- After a successful pairing, the remote control will always work in the Bluetooth mode, and will not turn off automatically. As long as the TV is turned on, shake remote or press the remote control buttons, the TV and remote will connect automatically. Please do not stop the pairing status between TV and remote control.