

Item No.8801  
Radio Control Full Function  
Battery Operated  
Scale 1:64



Before operating your toy, please read this manual carefully, and keep this instruction manual for future reference as it contains important information.

**FEATURES:**  
Have fun racing your City Racer for up to 6 minutes on just a 2 minute charge.  
Reaches speeds of 200 feet a minute with a transmitter control range of 20 feet.

MADE IN CHINA

## Controls Overview

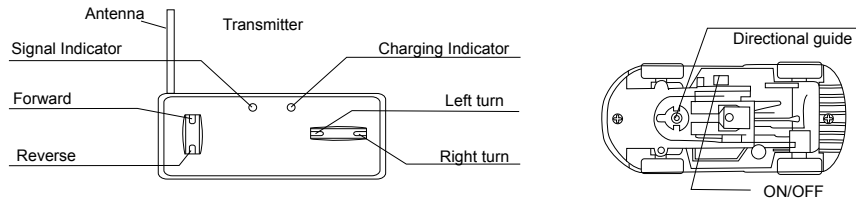

## Preparation

1

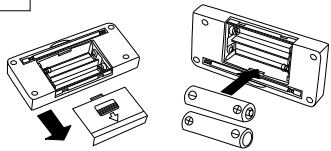

Slide the transmitter's battery compartment cover towards the direction shown to open it. Insert 2 x "AA" batteries with the correct polarity, then replace the battery compartment cover.

2

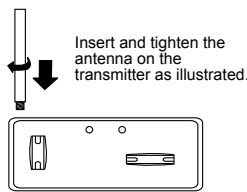

Insert and tighten the antenna on the transmitter as illustrated.

## Charger The City Racer

1



Open the charger cove as illustrated and take out the charging plug.

2

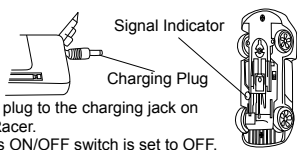

Insert the charging plug to the charging jack on the bottom of the Racer. Make sure the car's ON/OFF switch is set to OFF, otherwise the car will not charge! The charging indicator lights up to indicate charging is in progress.

3

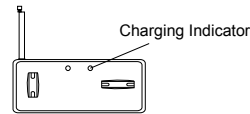

Charge for about 2 minutes. The Racer is fully charged when the charging indicator goes out. Play time is about 6 minutes.

## Operation

1. Extend the transmitter's antenna for better signal reception. Move the ON/OFF switch on the Racer to ON, and place it on the ground.

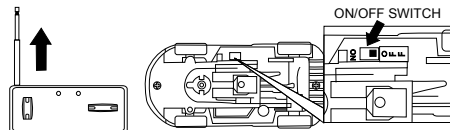

2. The transmitter is full-function:

- (1) The signal indicator lights up when any button on the transmitter is pressed.
- (2) The Racer runs forward and lights up its headlights when the transmitter's forward button is pressed. The Racer reverses when the transmitter's reverse button is pressed.
- (3) Pressing the left/right button on the transmitter while the Racer is running forward or in reverse, the Racer will make a left/right turn.

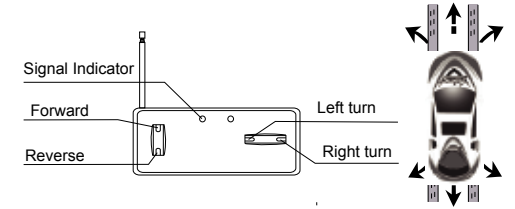

3.

If the Racer veers too much to the left (L) or right (R), adjust the Directional Control toward the opposite direction. This will help the wheels align and your Racer to run more straight.

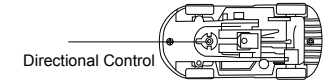

## BATTERY WARNING

- Do not mix battery types.
- Do not mix alkaline, standard (carbon-zinc) or rechargeable (nickel cadmium) batteries.
- Do not mix old & new batteries.
- The supply terminals are not to be short-circuited.
- Batteries are to be inserted with the correct polarity.
- Non-rechargeable batteries are not to be recharged.
- Remove batteries when not in use.
- Recycle or dispose of exhausted batteries according to federal, state or local laws.

## SAFETY PRECAUTIONS

- Adult supervision is recommended at all times.
- Do not operate during thunderstorms or rain.
- Avoid water, sand and snow when operating your vehicle.
- Do not submerge vehicle or transmitter in water.
- Never operate your vehicle on the street or highway.
- Do not use your vehicle near transmitter with the same frequency.
- Avoid high-impact collisions with people and objects.
- Keep this Instruction Manual for future reference as it contains important information.

## FCC INFORMATION

**Warning:** Changes or modifications to this unit not expressly approved by the party responsible for compliance could void the user's authority to operate the equipment.

**NOTE:** This equipment has been tested and found to comply with the limits for a Class B digital device, pursuant to Part 15 of the FCC Rules. These limits are designed to provide reasonable protection against harmful interference in a residential installation. This equipment generates, uses and can radiate radio frequency energy and, if not installed and used in accordance with the instructions, may cause harmful interference to radio communications.

However, there is no guarantee that interference will not occur in a particular installation. If this equipment does cause harmful interference to radio or television reception, which can be determined by turning the equipment off and on, the user is encouraged to try to correct the interference by one or more of the following measures:

- Reorient or relocate the receiving antenna.
- Increase the separation between the equipment and receiver.
- Connect the equipment into an outlet on a circuit different from that to which the receiver is connected.
- Consult the dealer or an experienced radio/TV technician for help.

REMARK : Receiver FCC ID  
FCC ID: W89-SMARTKID-49R

This device complies with Part 15 of the FCC Rules.

Operation is subject to the following two conditions:

- (1) This device may not cause harmful interference, and
- (2) this device must accept any interference received, including interference that may cause undesired operation.