

**RADIO  
CONTROL**

# TUNER RACER

ITEM NO.9023

SCALE 1:16

● A PARENT OR SUPERVISING ADULT SHOULD  
READ THE HANDING INSTRUCTIONS

## TRANSMITTER

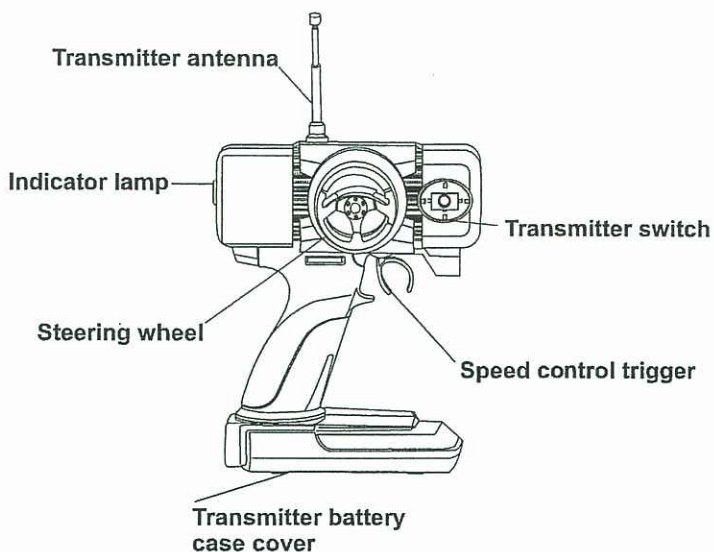

## R/C VEHICLE

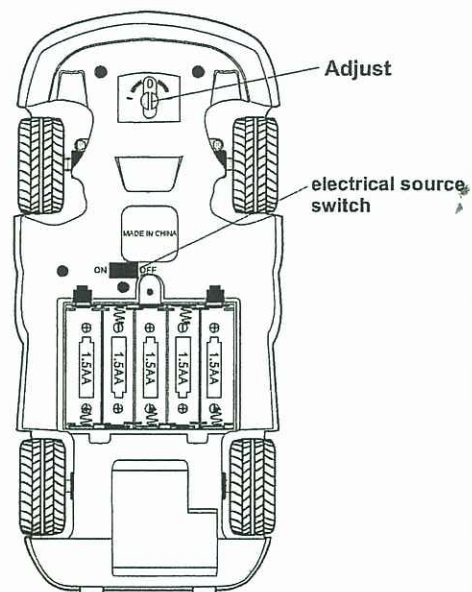

### ① HOW TO INSTALL TRANSMITTER BATTERY

Use a 9v battery for the transmitter. Always use fresh batteries and install properly.

- ① open transmitter battery cover.
- ② Insert 2 "AA" battery noting correct polarity. If power does not work properly, reinsert battery and make sure that connections are secure.
- ③ Close transmitter battery cover.

- If the switch is turned on and the indicator lamp does not light, check battery. If battery is properly installed and indicator lamp fails to light, battery may be depleted. Install fresh battery for playing.
- Take out the battery after playing.

### ① INSTALL TRANSMITTER BATTERY

Transmitter battery case cover

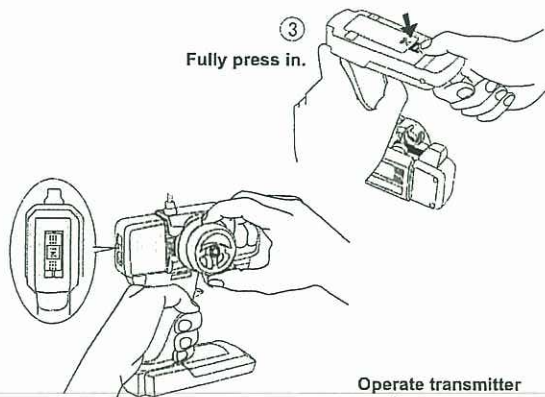
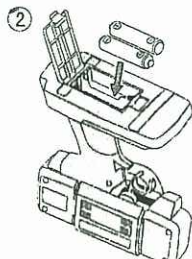
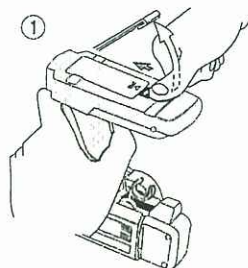

MADE IN CHINA

## 2 INSTALL RUNNING BATTERY

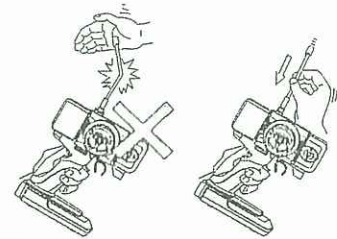
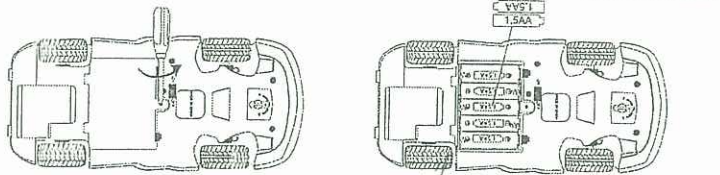

Carefully collapse antenna by holding bottom of antenna and not the tip.

## 3 HOW TO SWITCH ON

- 1 Fully extend antenna
- 2 Switch on transmitter
- 3 Switch on vehicle

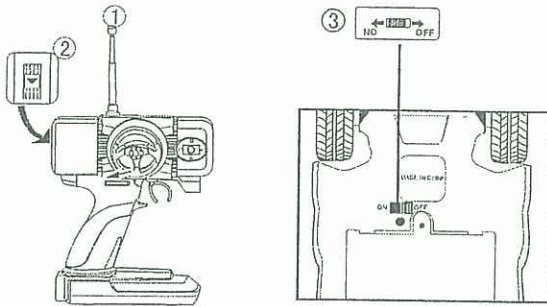

## 4 HOW TO CONTROL MODEL

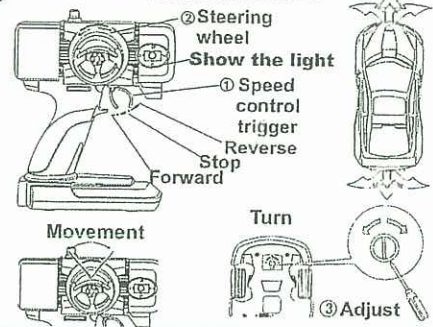

## 4 CONTROL OF THE R/C CAR

### 1 Speed control trigger

The speed control trigger operates when pulled or pushed with a finger. Pulling the trigger towards you runs the model forward. Pushing the trigger runs the model in reverse.

### 2 Steering wheel

Steers the model left and right. Turning the wheel right steers model to the right and turning the wheel left steers model to the left.

### 3 Adjust

Use the fine adjust on the front end of the chassis of the car to adjust the car's straight-line running performance. (R for right and L for left.)

## 5 SPEED CONTROL TRIGGER

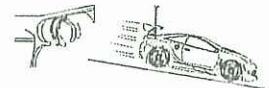

### SPEED LIMITER



## CAUTION

The car uses Ni-Cd batteries and is capable of reaching high speeds. Improper operation may be dangerous, please observe the following warnings.

### DURING OPERATION

- ▲ Make sure that running battery is correctly installed.
- ▲ Make sure that transmitter battery is correctly installed.
- ▲ Radio interference will cause the car to stop operation. This is a safety feature, not a malfunction.
- ▲ Do not touch tires during operation.
- ▲ Remove all batteries from transmitter and model after use.
- ▲ REMOVE BATTERIES AFTER USE fails to remove batteries can result in battery leakage, causing damage to the transmitter and car.

### WHEN STORING R/C MODEL

- ▲ Never store R/C model near fire, a hot place or in direct sunlight.
- ▲ Never store R/C model in a damp area, out doors or in the rain.

### TAKE CARE WHEN USING NI-Cd BATTERIES

- ▲ Enormous amounts of current can flow in the circuits when using Ni-Cd batteries. Improper handling can cause serious damage and accidents. Carefully follow the instructions included with your Ni-Cd batteries and charger for safe operation.

### CAUTIONS WHILE RUNNING R/C CAR

- ▲ Make sure that no one else is using the same frequency as yours in your running area. Using the same frequ-

ency at the same time, whether it is driving, flying or sailing can cause loss of control of the R/C Models, resulting in serious accidents. If someone is using the same frequency, move at least 1 km away to avoid interference.

- ▲ Never run an R/C model in the street or crowded areas, running R/C model in these areas can cause serious accidents and injuries.
- ▲ Avoid running the R/C model in standing water or rain, moisture in mechanics can cause malfunction.
- ▲ If you have control difficulties with correctly installed fresh batteries, it may be caused by radio wave interference. Try a different location or time to operate your R/C model.
- ▲ If you have thunder or see lightning, immediately stop running the R/C model and collapse transmitter antenna.
- ▲ Follow these basic rules for safe and enjoyable R/C operation. Please retain these instructions for future reference.

Changes or modifications not expressly approved by the party responsible for compliance could void the user's authority to operate the equipment.