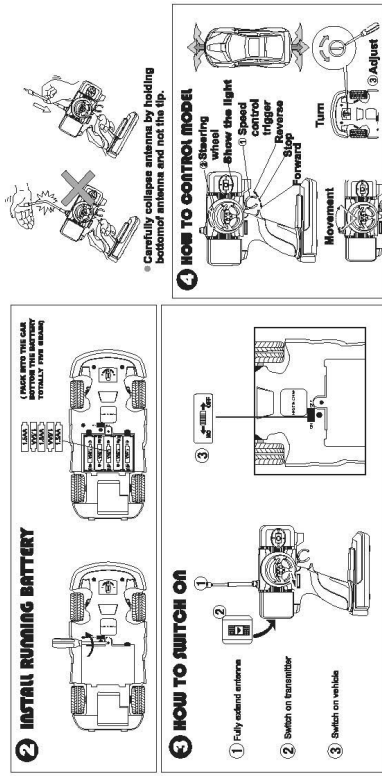
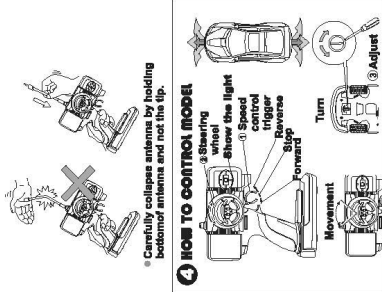
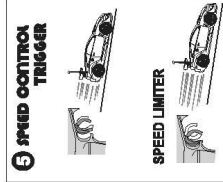

User manual

2 INSTALL RUNNING BATTERY
3 HOW TO SWITCH ON

- 1 Fully extend antenna
- 2 Switch on transmitter
- 3 Switch on vehicle

4 HOW TO CONTROL MODEL

5 SPEED CONTROL TRIGGER
SPEED LIMITER

- 1 Speed control trigger
The speed control trigger operates when pulled or pushed with a finger. Pulling the trigger towards you runs the model forward, pushing the trigger runs the model in reverse.
- 2 Steering wheel
Steers the model left and right. Turning the wheel right steers model to the right and turning the wheel left steers model to the left.
- 3 Adjust
Use the fine adjust on the front end of the chassis of the car to adjust the car's straight-line running performance. (R for right and L for left.)

4 CONTROL OF THE R/C CAR

ITEM NO.9023

TUNER RACER

SCALE 1:16

RADIO CONTROL

• A PARENT OR SUPERVISING ADULT SHOULD READ THE HANDING INSTRUCTIONS

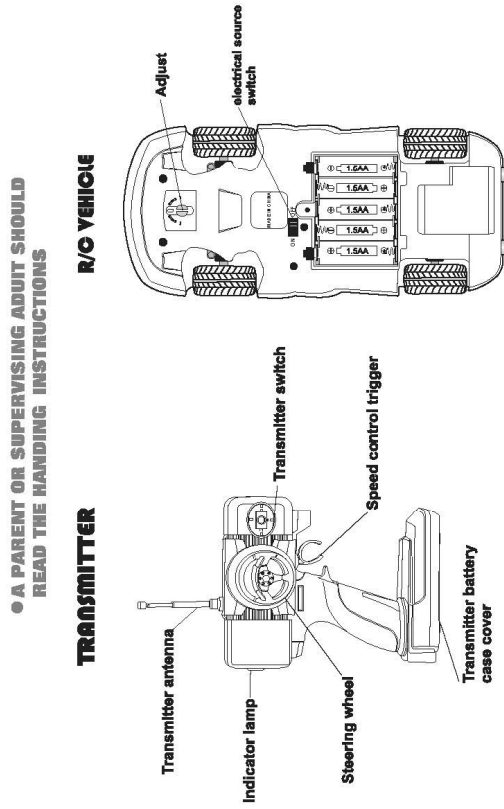
R/C VEHICLE
TRANSMITTER

- 1 HOW TO INSTALL TRANSMITTER BATTERY
Use a 9v battery for the transmitter. Always use fresh batteries and install properly.
 - 1 open transmitter battery cover.
 - 2 Insert 2 "AA" battery noting correct polarity. If power does not work properly, reinsert battery and make sure that connections are secure.
 - 3 Close transmitter battery cover.
- If the switch is turned on and the indicator lamp does not light, check battery if battery is properly installed and indicator lamp fails to light, battery may be depleted. Install fresh battery for playing.
- Take out the battery after playing.

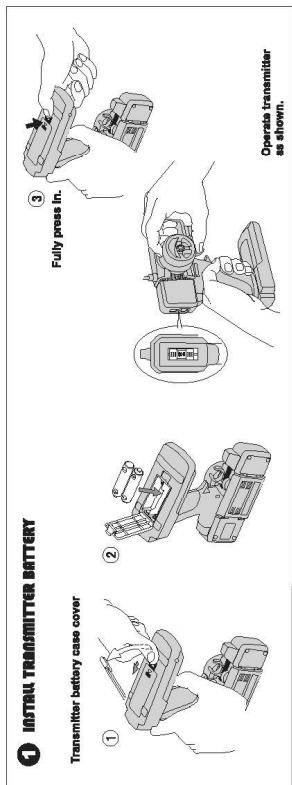
1 INSTALL TRANSMITTER BATTERY
Transmitter battery case cover
Operate transmitter as shown.

MADE IN CHINA

CAUTION

- The car uses Ni-Cd batteries and is capable of reaching high speeds. Improper operation may be dangerous, please observe the following warnings:
- OPERATION**
- ▲ Make sure that running battery is correctly installed.
 - ▲ Make sure that transmitter battery is correctly installed.
 - ▲ Do not touch the transmitter battery while the car is running.
 - ▲ Do not touch tires during operation.
 - ▲ Remove all batteries from transmitter and model after use.
- REMOVE BATTERIES AFTER USE** Failure to remove batteries can result in battery leakage, causing damage to the transmitter and car.
- ▲ Reorient or relocate the receiving antenna.
 - ▲ Increase the separation between the equipment and receiver.
 - ▲ Connect the equipment into an outlet on a circuit different from that to which the receiver is connected.
 - ▲ Consult the dealer or an experienced radio/TV technician for help.
- WHEN STORING R/C MODEL**
- ▲ Never store R/C model near fire, a hot place or in direct sunlight.
 - ▲ Never store R/C model in a damp area, out doors or in the rain.
- TAKE CARE WHEN USING NI-CD BATTERIES**
- ▲ Enormous amounts of current can flow in the circuits when using Ni-Cd batteries. Improper use can cause serious damage and accidents. Carefully follow the instructions included with your Ni-Cd batteries and charger for safe operation.
- CAUTIONS WHILE RUNNING R/C CAR**
- ▲ Make sure that no one else is using the same frequency as yours in your running area to avoid the same frequency interference.
 - ▲ Warning: Changes or modifications not expressly approved by the party responsible for compliance could void the user's authority to operate the equipment.
- ENJOY AT THE SAME TIME, WHETHER IT IS DRIVING, FLYING OR SAILING CAN CAUSE LOSS OF CONTROL OF THE R/C MODELS, RESULTING IN SERIOUS ACCIDENTS. IF SOMEONE IS USING THE SAME FREQUENCY, MOVE AT LEAST 1 km AWAY FROM THE MODEL.**
- ▲ Never run an R/C model in the street or crowded areas. Running R/C model in these areas can cause serious accidents and injuries.
 - ▲ Avoid running the R/C model in standing water or rain, moisture in the air can cause many problems. If you have difficulty with the car, try to use fresh batteries. It may be caused by radio wave interference. Try a different location or time to operate your R/C model.
 - ▲ If you have thunder or see lightning, immediately stop running the R/C model and collapse transmitter and receiver.
 - ▲ Follow these basic rules for safe and enjoyable R/C operation. Please retain these instructions for future references.