



Installation Instructions

Customizable Wireless Spotlight with Motion Sensor and Remote Control

MB130

Spotlight features:

Fully Adjustable: Light can be rotated 360° as well as up and down

Light Coverage: up to 400 sq ft

Durable, Weather Resistant: Tight seals and UV resistant material allow the light to work in all weather conditions

Remote Control: Control from up to 70 ft away

What is included per light:

- 1 Remote Controlled Spotlight
- Mounting Base
- 3 Screws & 3 Anchors
- 1 Remote Control with Mounting Bracket + 2 screws
- (1) 3V Coin Battery

What you need to install:

- 1 Small Screwdriver
- 3 D-Cell Alkaline Batteries

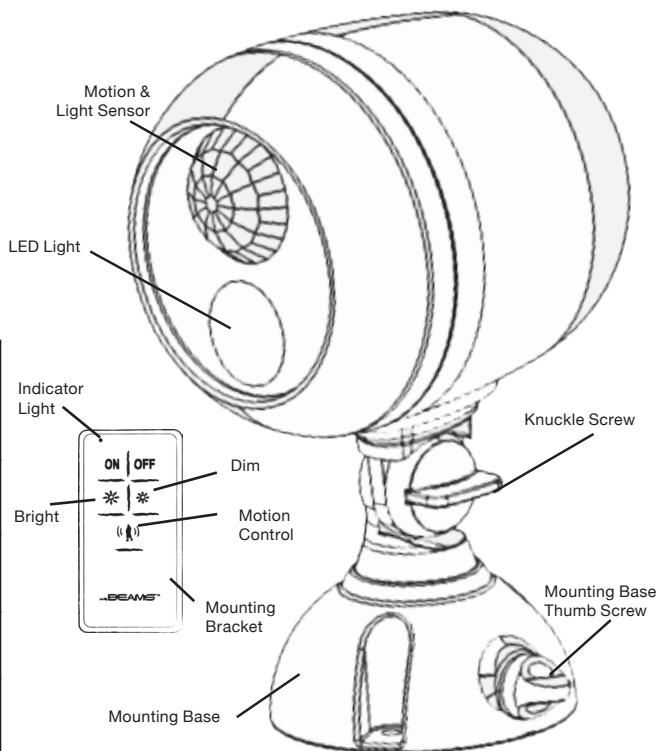

Customize your remote settings

| | |
|----------------------------------|--|
| Remote Control Activation | Spotlight can be turned on or off by pressing the remote control. Activating the remote will override the light sensor, and light can be activated at any time. Default mode is motion sensor on 30 second auto shut-off. |
| 2 Auto Shut-off Options | First activate the light with remote control. Next, hold the ON button down until light blinks. When it blinks 1x, auto shut off is set to 1 hour. When it blinks 2x, it is set to 4 hours. |
| 3 Brightness Modes | First activate the light with remote control. Next, press the Bright or Dim button on the remote to adjust the brightness. Brightness Options: 60, 90, or 140 lumens. |
| Motion Sensor Activation | Spotlight will activate when motion is sensed from up to 30 ft away. Motion sensor only activates in darkness to conserve energy. |
| Disable Motion | Activate light with the remote. Hold the motion sensor button down until light blinks. When it blinks 2x the motion sensor has been disabled. When it blinks 4x, the motion sensor has been enabled. Light will remember your last brightness setting. |

Set up

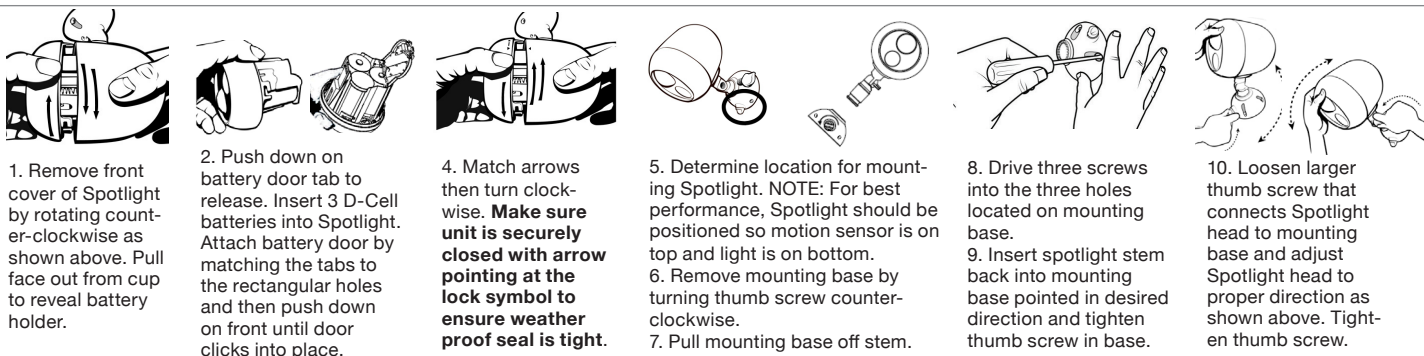

Using the remote

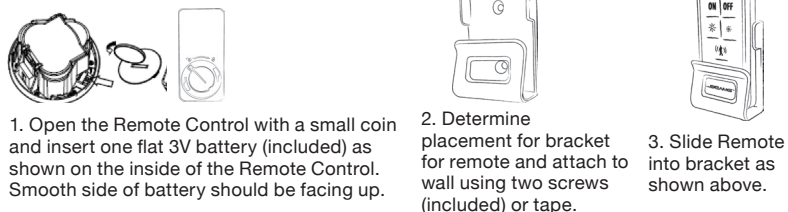

Syncing your light

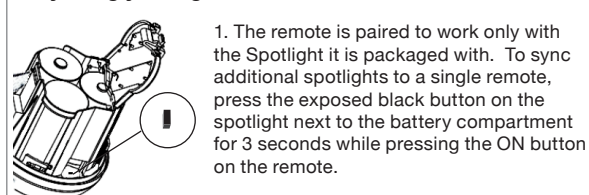

Tips:

- Use only new alkaline D-Cell batteries with 1.5V rating.
- Do not mix old and new batteries. If batteries are not new, it may cause light to malfunction.
- Install batteries with polarity in correct position.
- Antenna is only connected at one end. It acts as a receptor for the remote.

Battery Caution:

- 1) Do not mix old and new batteries
 - 2) Do not mix Alkaline, Standard (Carbon-Zinc) or Rechargeable (Nickel Cadmium) or (Nickel Metal Hydride) batteries
 - 3) Do not dispose of batteries in fire
 - 4) Batteries should be recycled or disposed of as per state and local guidelines
- Patent # 8,203,445



* Visit our website to view installation video.
 * 1 year limited warranty. See enclosed card for details.
 32333 Aurora Rd. Suite 100 Solon, OH 44139
 877.298.9082

MR BEAMS™
 Surprisingly Bright Light Anywhere
 www.mrbeams.com

Power supply: DC 3V

Operating Frequency:433.7MHz

FCC ID: W7DMB130

1. This device complies with Part 15 of the FCC Rules. Operation is subject to the following two conditions:
 - (1) This device may not cause harmful interference.
 - (2) This device must accept any interference received, including interference that may cause undesired operation.
2. Changes or modifications not expressly approved by the party responsible for compliance could void the user's authority to operate the equipment.