

Rosewill Inc.
Name: SPEAKER
Model: BZ-200
FCC ID: W6RBZ-200



FEATURES:

- Studio-Quality Sound Performance
- Immersive Bass & Crystal Clear Treble for Multimedia Entertainment
- Multiple Connections Compatible with Various Devices

SPECIFICATIONS:

RMS Output Power	50 Watts (@ 10% THD)
Subwoofer Driver	6.5 in
Tweeter Driver	2 x 3 in
Frequency Response	50 Hz - 20 kHz
S/N Ratio	≥ 74 dB
Separation	≥ 23 dB
Side Controller	Volume / Bass / Input Switch
Power Input	110 - 230V
Total Weight	8.50 lbs [3.85 kg]
Subwoofer Dimensions (L x W x H)	9.45 x 9.25 x 9.84 in [240 x 235 x 250 mm]
Satellite Dimensions (L x W x H)	3.94 x 3.54 x 7.87 in [100 x 90 x 200 mm]

PACKAGE CONTENTS:

- 2 x Wireless Stereo Speakers
- 6.5 in Woofer Speaker
- Wired Control Pod
- User Manual

I/O CONNECTIONS:

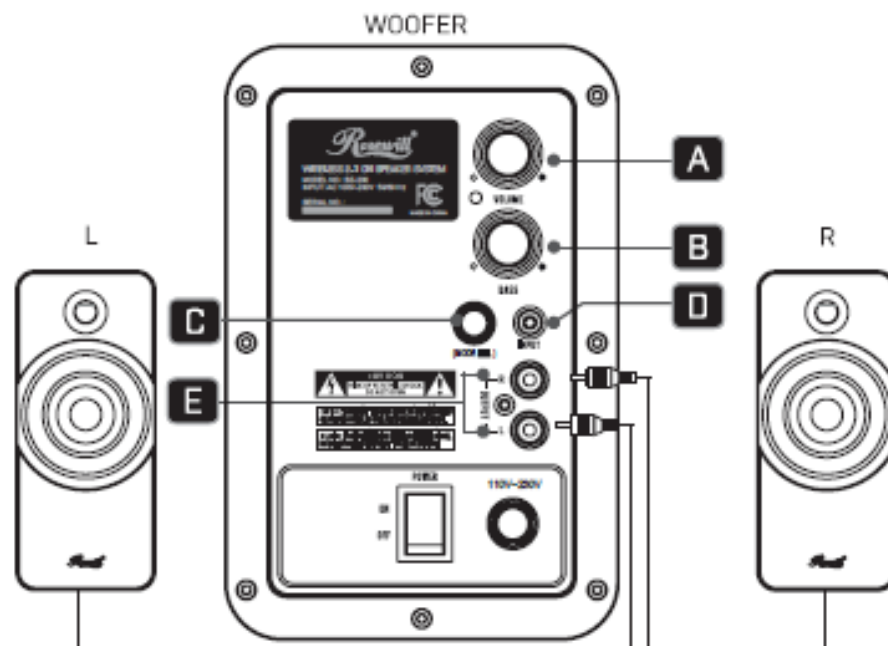

- A.** Volume Control
- B.** Intuitive Bass Control
- C.** Input Selection via Wired / Wireless Transmission
- D.** 3.5 mm Input Jack to Connect the Control Pod
- E.** Satellite Speakers Output Jack

I/O CONNECTIONS:

CONTROL POD

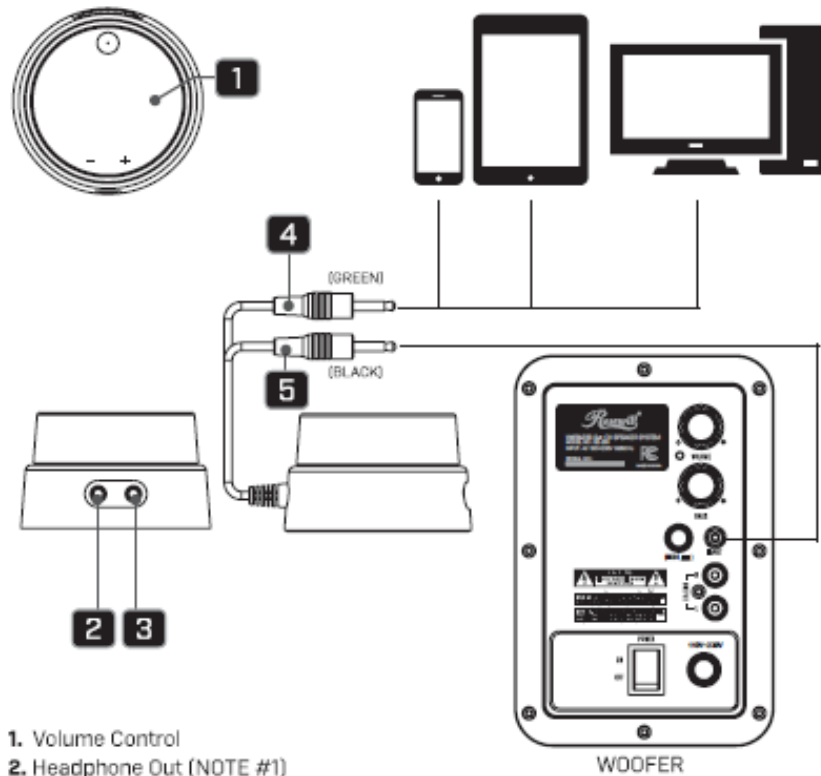

1. Volume Control
2. Headphone Out (NOTE #1)
3. Line In (NOTE #2)
4. Connect to Audio Devices (GREEN)
5. Line In: Connect to Woofer Input Jack (BLACK)

(NOTE): 1. The Output Signal will jump to Headphone while connected.
2. The Audio Source will jump to Line In while connected.

CONNECTION INSTRUCTIONS:

1. Connect the white / red **RCA** connectors from satellite speakers to the corresponding woofer output jacks.
2. Connect the control pod to woofer input jack and PC system (or compatible audio devices).
3. Make sure the operating system recognizes the speaker system.
4. Plug the AC power cord into a standard household electrical outlet.
5. You can now power on the speaker and tune settings as preferred.

BLUETOOTH MODE:

1. Press **MODE** and you will hear the prompt "beep".
2. When indicator light flashes quickly, the speakers are ready for pairing with your Bluetooth device.
3. Enable the Bluetooth function on your device, find "**BZ-200**" and connect.
4. Enter "**0000**" if password is required.
5. Stream audio or music from your device and adjust the volume properly.

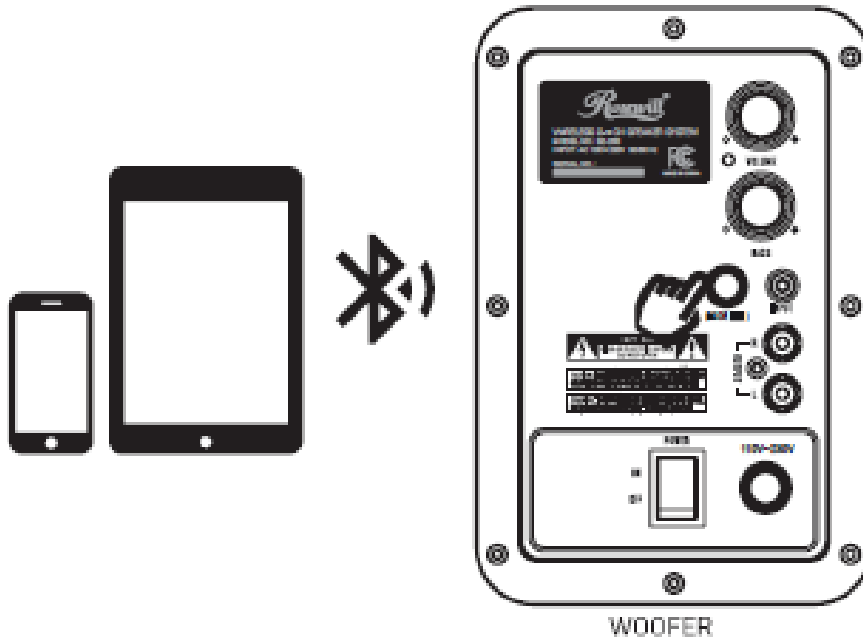

(NOTE): Wireless transmission distance may not exceed 32 feet.

WARNING:

1. Do not connect the AC power cord into an outlet until all connections are made.
2. Please remove AC power cord if you do not use this device for an extended period of time.
3. Do not expose the speakers to any water or moisture and make sure objects filled with liquids, such as drinks or vases, are not placed on top or nearby.

FCC Statement

This device complies with part 15 of the FCC Rules. Operation is subject to the following two conditions:

(1) This device may not cause harmful interference, and (2) this device must accept any interference received, including interference that may cause undesired operation. Any Changes or modifications not expressly approved by the party responsible for compliance could void the user's authority to operate the equipment.

Note: This equipment has been tested and found to comply with the limits for a Class B digital device, pursuant to part 15 of the FCC Rules. These limits are designed to provide reasonable protection against harmful interference in a residential installation. This equipment generates uses and can radiate radio frequency energy and, if not installed and used in accordance with the instructions, may cause harmful interference to radio communications. However, there is no guarantee that interference will not occur in a particular installation. If this equipment does cause harmful interference to radio or television reception, equipment generates, uses and can radiate radio frequency energy and, if not installed and used in accordance with the instructions, may cause harmful interference to radio communications. However, there is no guarantee that interference will not occur in a particular installation. If this equipment does cause harmful interference to radio or television reception,

- Reorient or relocate the receiving antenna.
- Increase the separation between the equipment and receiver.
- Connect the equipment into an outlet on a circuit different from that to which the receiver is connected.
- Consult the dealer or an experienced radio/TV technician for help.

FCC RF Radiation Exposure Statement

The device has been evaluated to meet general RF exposure requirement. The device can be used in portable exposure condition without restriction