

Brookstone

Wireless Indoor Speaker

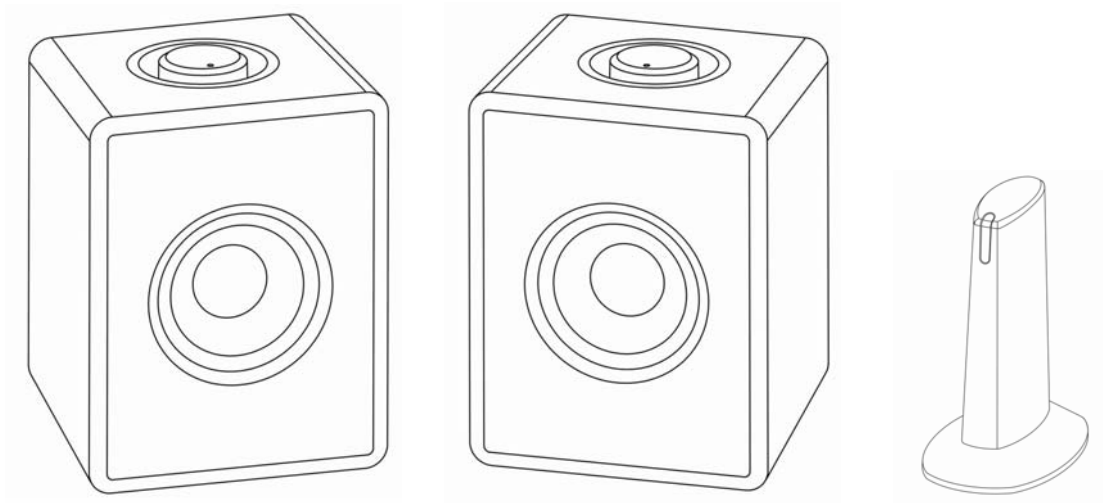

CAUTION — TO REDUCE THE RISK OF ELECTRIC SHOCK, DO NOT REMOVE COVER (or back). There are no user serviceable parts insides.



This symbol is intended to alert the user to the presence of non-insulated, “dangerous voltage” within the unit’s enclosure that may constitute a risk of electric shock.



This symbol is intended to alert the user to the presence of important operating and maintenance (servicing) instructions.

Warning

To reduce the risk of fire or electric shock, do not expose this unit to rain or moisture.

Do not place the speaker near heat sources such as radiators and heating vents.

Do not store the speaker in extreme temperatures.

Turn the transmitter and speaker power OFF when not in use.

FCC INFORMATION

This equipment has been tested and found to comply with the limits for a class B digital Device, pursuant to part 15 of the FCC Rules. These limits are designed to provide reasonable protection against harmful interference in a residential installation. This equipment generates, uses, and can radiate radio frequency energy and, if not installed and used in accordance with the instructions, may cause harmful interference to radio communications. However, there is no guarantee that interference will not occur in a particular installation. If this equipment does cause harmful interference to radio or television reception, which can be determined by turning the equipment off and on, the user is encouraged to try to correct the interference by one or more of the following measures:

- Reorient or relocate the receiving antenna.
- Increase the distance between the equipment and receiver.
- Connect the equipment to an outlet on a circuit different from which the receiver is connected.
- Consult the dealer or an experienced radio/TV technician for help.

This equipment complies with part 15 of the FCC Rules. Operation is subject to the following two conditions:

1. This equipment may not cause harmful interference.
2. This equipment must accept any interference received, including interference that may cause undesired operation.

CONTROLS

WIRELESS TRANSMITTER:

1. POWER INDICATOR
2. POWER ON/OFF SWITCH AND CHANNEL SELECTOR
3. STEREO OR MONO SELECTOR
4. RCA AUDIO LEFT IN JACK
5. RCA AUDIO RIGHT IN JACK
6. AC/DC ADAPTOR INPUT JACK

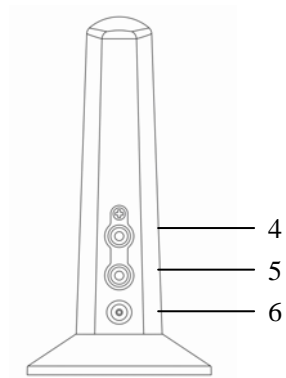
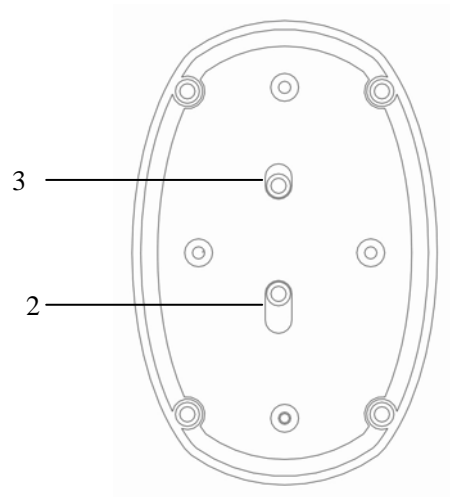
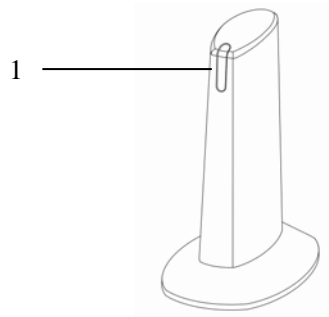

SPEAKER:

7. AC/DC ADAPTOR INPUT JACK
8. CHANNEL SELECTOR
9. SPEAKER POWER SWITCH AND VOLAUME CONTROL
10. SPEAKER POWER INDICATOR

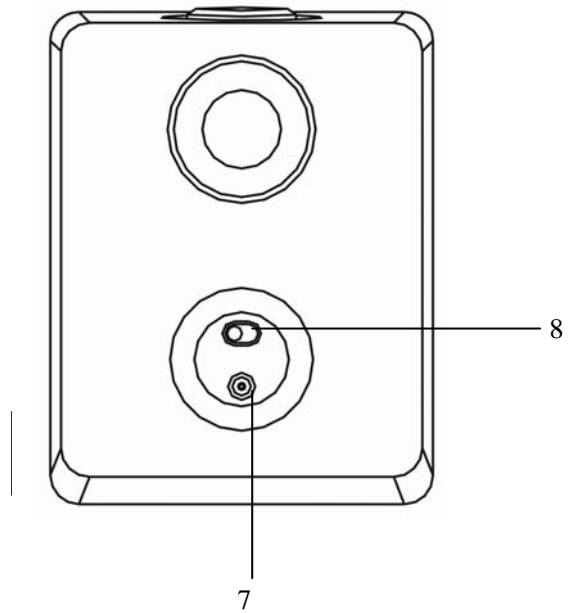
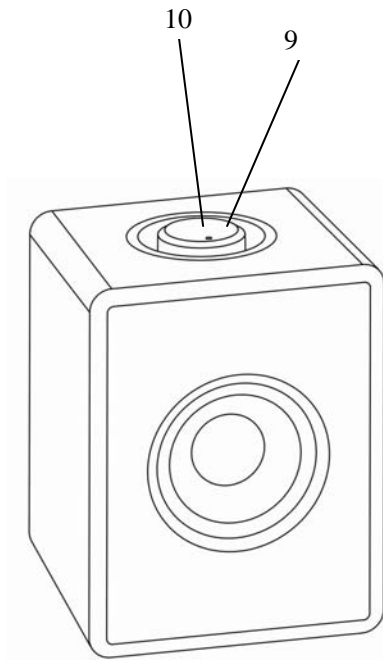

ACCESSORIES:

11. 3.5MM to RCA CABLE
12. DUAL RCA CABLE
13. AC 120V 60Hz to DC 9V 200mA Power Adaptor for Transmitter
14. AC 120V60Hz to DC 12V 1A Power Adaptor for Speaker
(2 sets)

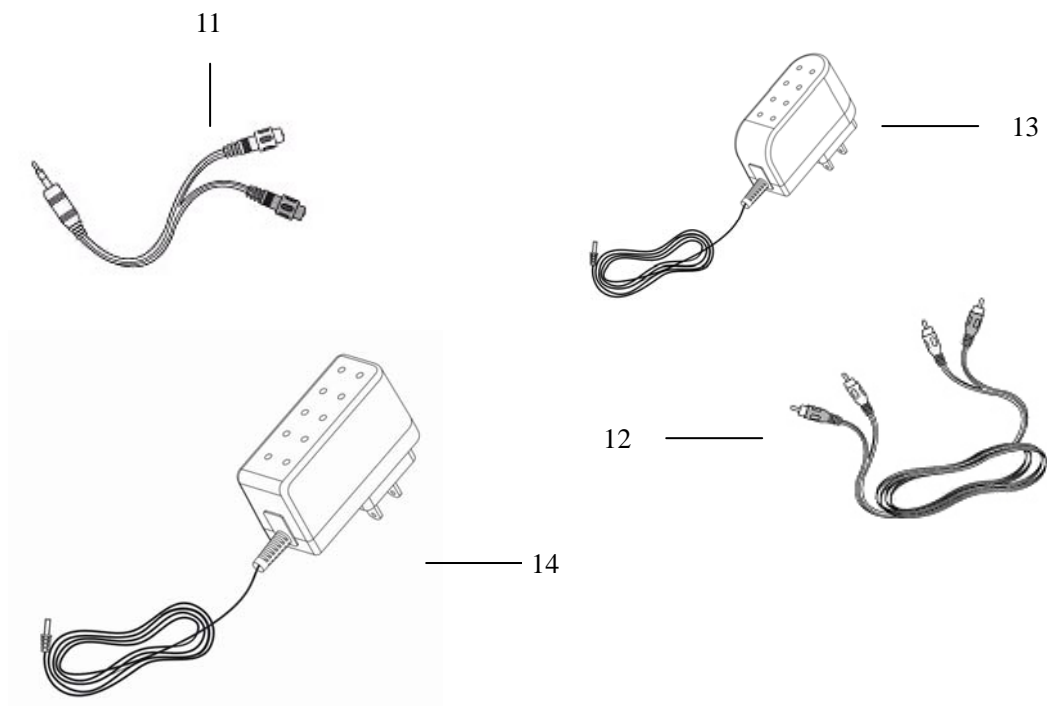

TRANSMITTER OPERATION:

Connecting the transmitter to an audio source

The transmitter may be connected two ways depending on your audio source. If your audio source has left and right RCA Audio output jacks, you will only use the DUAL RCA CABLE. If your audio source does not have left and right RCA output jacks, but rather a stereo headphone jack, you will use 3.5mm to RCA CABLE.

1. Insert the end of the DC Output plug of the Transmitter Power Adaptor into the DC9V input jack on the Transmitter and the other end of the AC Power plug of the Transmitter Power Adaptor into an electrical outlet.
2. Insert one end of the DUAL RCA CABLE into the appropriately colored R/L LINE IN jacks on the transmitter, and the other end into your audio source's left and right audio output jacks

Note:

3. If there are no fixed-level audio outputs on your audio source, connect the 3.5mm audio outputs or Headphone Jack for the 3.5MM CABLE connection

- Do not connect the DUAL RCA CABLE to speaker terminals on your TV or audio source. This may damage the transmitter, your TV or audio source.

SPEAKER OPERATION:

1. First of all, select the transmitter channel 1, 2 or 3, and The TRANSMITTER POWER INDICATOR illuminates.

Note: If the transmitter is connected to your audio source's variable-level output jacks, you may adjust the volume on your audio source. If the transmitter is connected to your audio source's fixed-level output jacks, no volume adjustment is needed.

2. Insert the end of the DC Output plug of the SPEAKER POWER ADAPTER into the DC12V input jack on the speaker, and the other end of the AC Power plug of the SPEAKER POWER ADAPTER into an electrical outlet.

3. Turn on your audio source.

4. Turn CH1, CH2, CH3 on the speaker as the same channel selected on the transmitter.

5. Turn on the POWER volume knob of the speaker and the SPEAKER POWER INDICATOR illuminates.

6. Adjust the speaker volume to your desired listening level.

Caution: Any changes or modification cautions to this device not explicitly approved by manufacturer could void your authority to operate this equipment.

Note:

- If signal interference occurs, adjust the channel on both the speaker and the transmitter.
- When not in use, Turn the power off the speaker and slide CHANNEL1, 2, 3 on the transmitter to the OFF position.

Care and Maintenance:

Wipe the transmitter and speaker with a soft, damp cloth. Do not use abrasive chemical

Speakers Specification:

Power On/Off with Volume Control	Yes
Fine Tuning:	Automatic
Speaker Unit	3" Speaker
Frequency Range:50Hz-20kHz
Dimensions of Speaker :5.35" x 5.4" x 6.8"

NOTE:

For the best transmission and reception range, wireless transmitter must be placed in vertical, upright position.