

Quick Start Guide BUGbase WiFi

From BUG Wiki

Contents

- 1 Safety Warnings
- 2 BUGbase Callout Diagram
- 3 Connecting BUGmodules
- 4 Getting Started
- 5 Removing Modules
- 6 Modules
- 7 Powering Down the BUGbase
- 8 Bug Labs Limited Warranty
- 9 Bug Labs Return Policy
- 10 FCC Statements
- 11 Related links

Safety Warnings

1. Do not get BUGbase or BUGmodules wet.
2. To avoid electrical shock use caution when handling battery.
3. Use caution when hacking hardware, **do not** open BUGbase or BUGmodules when unit is plugged in.
4. Keep the BUGbase and BUGmodules away from extreme temperatures and humidity conditions.
5. A clean BUG is a reliable BUG.

BUGbase Callout Diagram

BUGbase BUGWifi Edition Model #10012

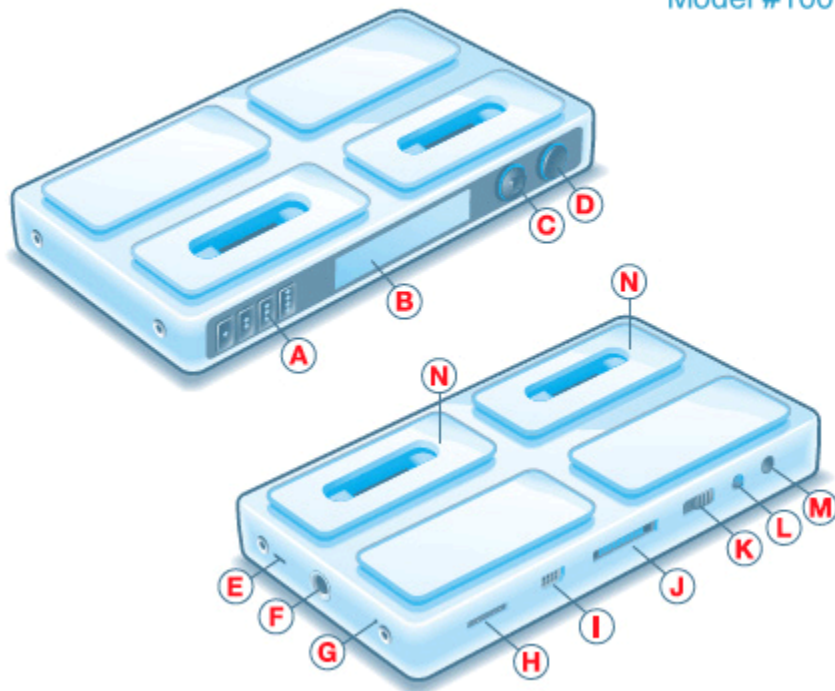

front

- A.** Hot Key buttons (user program)
- B.** Two line LCD
- C.** Four-way joystick controller
- D.** Select button (user programm)

side

- E.** WLAN Antenna
- F.** Tripod socket
- G.** Bluetooth® Antenna

back

- H.** SD memory card slot
- I.** USB On-The-Go connection
- J.** 30Pin Connector
- K.** On/Off switch
- L.** Charge indicator light
- M.** A/C power adapter connectio

top/bottom

- N.** Four BUGmodule connection

Connecting BUGmodules

Connecting BUGmodules to the BUGbase

The "Hook and Snap" Method

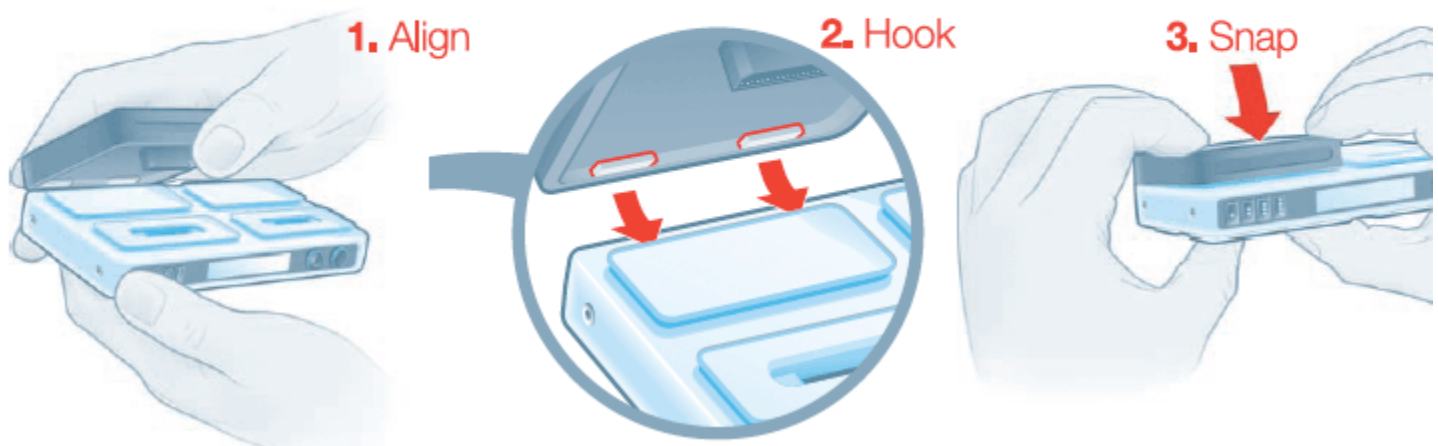

Caution: In order to avoid damage to connectors, always use the "Hook and Snap" method to connect BUGmodules to your BUGbase. If you would like to see a demonstration of this method, you can view a video for connecting BUGmodules (<http://youtube.com/watch?v=8-okyvLItyY>) .

Getting Started

1



1. Plug in the Power Adapter

Insert A/C power adapter into BUGbase.

2

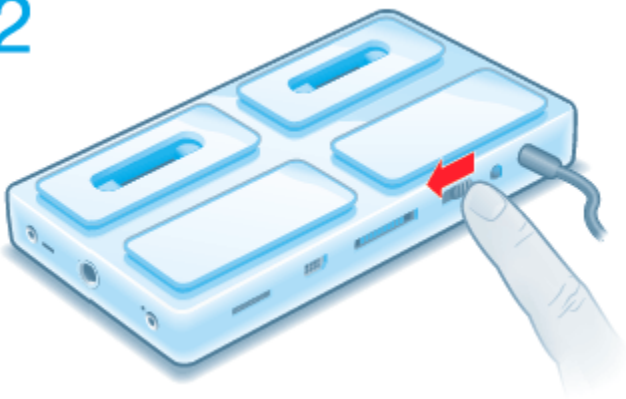

2. Turn on the BUGbase

Slide On/Off switch to the left. The switch will slide back and BUGbase will boot up. You will see the Hot Key buttons and LCD light up.

3. Connect BUGbase to a Computer

Please go to: <http://www.buglabs.net/start> to view platform specific installation procedures on connecting your BUGbase to your computer.

Caution: Do not connect BUGbase to your computer until you have completed the installation.

Removing Modules



Removing BUGmodules from the BUGbase

Reverse the "Hook and Snap" method by placing your thumb in the groove of the BUGmodule and gently rock the BUGmodule in the opposite direction. If you would like to see a demonstration of this method, you can view a video for removing BUGmodules (<http://youtube.com/watch?v=pu4mFErdCFI>) .

Modules

BUGlocate

BUGmodule
Model #11130

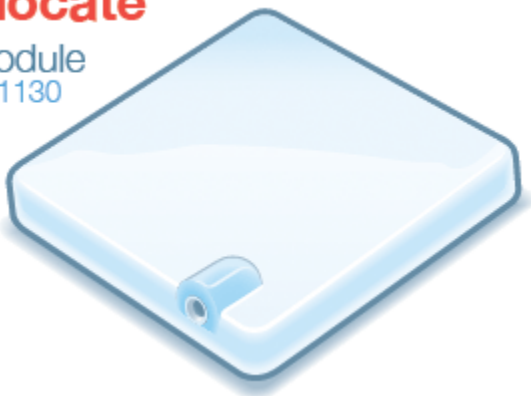

Description: GPS receiver with optional antenna plug.

Potential Uses: Navigation, mapping, surveying, tracking, locating and other location based services.

Device Nodes: tty_mxc

Kernel Nodes: bmi_gps

Interface Type: RS-232

For more details, go to: <http://www.buglabs.net/modules/buglocate>

BUGmotion

BUGmodule
Model #11140

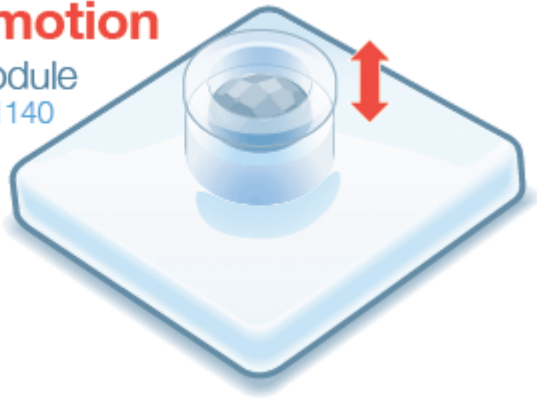

Description: Motion detector and accelerometer with adjustable collar.

Potential Uses: Sensing motion or movement and tracking acceleration.

Device Nodes: /dev/input/bmi_motion

Kernel Nodes: bmi_motion

Interface Type: RS-232

For more details, go to: <http://www.buglabs.net/modules/bugmotion>

BUGview

BUGmodule
Model #11110



Description: Full-color, hi-res, touch-sensitive LCD screen

Potential Uses: General interface for input and display.

Device Nodes: /dev/fb

Kernel Nodes: bmi_lcd

Interface Type: Compressed display interface (specialized)

For more details, go to: <http://www.buglabs.net/modules/bugview>

BUGvonHippel

BUGmodule
Model #11150

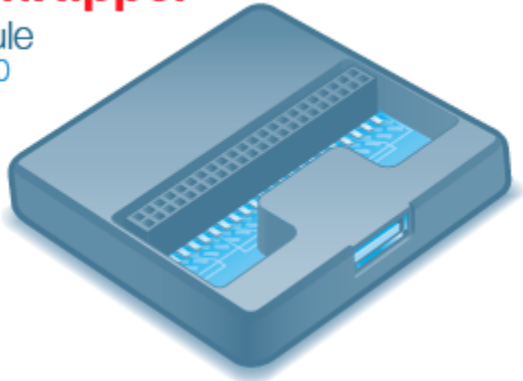

Description: Open board to make your own module.

Potential Uses: Your imagination is the only limit.

Device Nodes: /dev/bmi_vh

Kernel Nodes: bmi_vh

Interface Type: character device

For more details, go to: <http://www.buglabs.net/modules/bugvonhippel>

BUGsound

BUGmodule
Model #11160

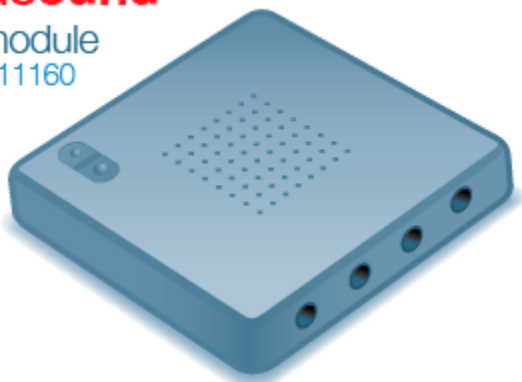

Description: Analog input/output module with on-board speaker and microphone.

Potential Uses: Create and listen to audio files.

Device Nodes: /dev/bmi_audio

Kernel Nodes: bmi_audio

Interface Type: character device

For more details, go to: <http://www.buglabs.net/modules/bugsound>

BUGbee
BUGmodule
Model #11170

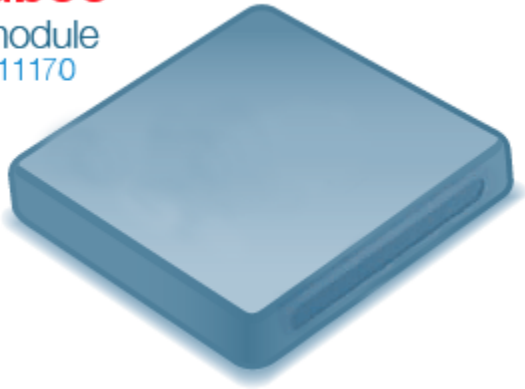

Description: A low-power radio module based on the 802.15.4 protocol.

Potential Uses: Creating a personal area network.

Device Nodes:

Kernel Nodes:

Interface Type: radio signal

For more details, go to: <http://www.buglabs.net/modules/bugbee>

Contains FCC ID: TFB-MATRIXHP, IC: 5969A-MATRIXHP

Powering Down the BUGbase

1. Press the 'Select' button to bring up the navigation menu.
2. Press down on the joystick controller four times, past 'Access', 'Modules', 'Programs', and 'Services', until you get to 'Settings'.
3. Press the joystick controller to the right once to get to 'About'.
4. Press down on the joystick controller twice to get to 'Shutdown'.
5. Press the 'Select' button to shut down BUGbase.

Bug Labs Limited Warranty

We at Bug Labs want and expect you to have a terrific experience with your BUG. If for some reason that is not the case we'll be happy to work with you in the hopes of making that happen. We do however need to present our policy as put forth by our attorneys.

Limited Warranty

Your new Bug Labs, Inc. product (the “Product”) is warranted by Bug Labs, Inc. (“Bug Labs”) to be free from defects in material and workmanship for a period of one year from the date of purchase (the “Warranty Period”). Bug Labs, at its option, will either repair or replace the Product, or refund the purchase price of the Product, in each case only if the Product is properly returned to Bug Labs during the Warranty Period in accordance with the Bug Labs Return Policy <http://store.buglabs.net/support> and the Product is found to be defective. If choosing to replace the Product, Bug Labs may furnish a refurbished unit or a unit that would not be sold as “new” merchandise.

What is Not Covered

DAMAGE TO THE PRODUCT RESULTING FROM ACCIDENT, FIRE, FLOOD, OR OTHER NATURAL DISASTERS, MISUSE, ABUSE, UNAUTHORIZED SERVICE, IMPROPER VOLTAGE OR POWER SUPPLY, OR VIOLATION OF THE CARE AND USE INSTRUCTIONS PRINTED ABOVE (INCLUDING, WITHOUT LIMITATION, BY OPENING THE PRODUCT’S CASING), WILL VOID THIS LIMITED WARRANTY.

This Limited Warranty is valid only for the original consumer with proof of purchase from an authorized retail vendor of the Product, or a recipient of gift from the original consumer with a copy of a gift receipt from an authorized retail vendor. The Limited Warranty is not transferable. No Limited Warranty service is available without proof of purchase. The Limited Warranty does not apply to any non-Bug Labs hardware product, any consumables (such as batteries), or any documentation or software code, even if installed on, or packaged or sold with, the Bug Labs hardware.

No Bug Labs reseller, agent, or employee is authorized to make any modification, extension, or addition to this Limited Warranty. If any term is held to be illegal or unenforceable, the legality or enforceability of the remaining terms shall not be affected or impaired.

How to Obtain Limited Warranty Service

If you believe you need Limited Warranty service for your Product, please email us at support@buglabs.net, call us at 1-866-9BUGLAB (1-866-928-4522) between the hours of 9am-5pm, M-F, EST, or write to us at Bug Labs, 598 Broadway, 4th Floor, New York, NY 10012, Attn: Warranty Service. Our Customer Service Team will gladly assist you to identify and fix the problems you have experienced. If, despite this effort, you and Bug Labs cannot together resolve the problem, Bug Labs will issue you a Return Material Authorization. Please return your Product to the address your Customer Service Specialist will provide you and include your Return Material Authorization with your package and refer to it in any subsequent communications. If Bug Labs determines that your Product has suffered a failure under the Limited Warranty, a repaired or replaced unit will be sent to you without cost. If your Product is found to be outside the Warranty Period or is otherwise not covered under the Limited Warranty, Bug Labs will return it to you at your expense.

PLEASE DO NOT RETURN YOUR PRODUCT WITHOUT A RETURN MATERIAL AUTHORIZATION as it will not be accepted and will be returned to you at your expense. Bug Labs will not, under any circumstance, furnish you a repaired or replaced Product prior to its receipt of your original product. The retail vendor from whom your Product was purchased does not have any authority to vary the terms of this Limited Warranty.

EXCEPT TO THE EXTENT PROHIBITED BY APPLICABLE LAW, ALL IMPLIED WARRANTIES (INCLUDING WARRANTIES OF MERCHANTABILITY AND FITNESS FOR A PARTICULAR PURPOSE) SHALL BE LIMITED IN DURATION TO THE DURATION OF THIS LIMITED WARRANTY, AND EXCEPT FOR THE LIMITED WARRANTY CONTAINED HEREIN, THE PRODUCT IS PROVIDED “AS IS AND WITH ALL FAULTS”.

UNDER NO CIRCUMSTANCES WILL BUG LABS BE LIABLE FOR INCIDENTAL, CONSEQUENTIAL OR PUNITIVE DAMAGES WHETHER OR NOT THE PRODUCT IS FOUND TO BE COVERED BY THIS LIMITED WARRANTY. This Limited Warranty gives you specific rights, and you may also have other rights that vary from state to state. In the event of a defect, to the extent permitted by law, these are your sole and exclusive remedies.

This Limited Warranty shall be governed by the laws of the State of New York without giving effect to any conflict of laws principles that may provide the application of the law of another jurisdiction. Any claim or dispute in connection with this Limited Warranty shall be resolved in a cost effective manner through binding non-appearance-based arbitration. The arbitration shall be initiated through an established alternative dispute resolution provider mutually agreed upon by the parties. The alternative dispute resolution provider and the parties must comply with the following rules: (a) the arbitration shall be conducted by telephone, online and/or be solely based on written submissions, the specific manner shall be chosen by the party initiating the arbitration; (b) the arbitration shall not involve any personal appearance by the parties or witnesses unless otherwise mutually agreed by the parties; and (c) any judgment on the award rendered by the arbitrator may be entered in any court of competent jurisdiction. If the foregoing arbitration clause does not apply for any reason, you agree to submit to the personal jurisdiction of the state courts located within New York, NY and the federal courts in the Southern District of New York for the purpose of litigating all such claims or disputes, which courts shall have exclusive jurisdiction of such claims or disputes. Notwithstanding the foregoing, Bug Labs may seek injunctive or other equitable relief to protect its intellectual property rights in any court of competent jurisdiction.

Bug Labs Return Policy

At Bug Labs, our goal is for you to have a great BUG experience, and to help you resolve any issues you may have with your BUGbase or BUGmodules. If our Customer Service team is unable to come up with a solution to your problems such that you need to return your products, please read below for our return procedures and policies. If you are not satisfied with your Bug Labs, Inc. product (the "Product"), Bug Labs allows you to return the Product, if it was purchased by you directly from Bug Labs and you obtain a Bug Labs return material authorization ("RMA") during the thirty (30) day period following the date Bug Labs shipped the product to you. If you return the Product unused, undamaged, in its original condition, in the original packaging, and in accordance with this policy, we will exchange it or offer a refund of the purchase price paid. Any refund will be made by crediting the account used to make the original purchase.

To begin the process of exchanging an item or obtaining a refund, please send an email to **support@buglabs.net**. You can also call us at **1-866-9BUGLAB (1-866-928-4522)** between the hours of 9am-5pm, M-F, EST. You are responsible for any shipping charges. Shipping and handling charges are not refundable. We will also assess a (U.S) \$25.00 open box fee on any opened Product, and we may also assess damage and missing part restocking fees.

Failure to follow the above procedures or otherwise in accordance with this policy, Bug Labs may either refuse delivery of such return or charge you a restocking fee. The time to credit your account may vary, depending on processing time. Please allow a minimum of four (4) weeks for Bug Labs to credit the account used to make the original purchase.

FCC Statements

Changes or modifications not expressly approved by the party responsible for compliance could void the user's authority to operate the equipment.

This device complies with part 15 of the FCC Rules. Operation is subject to the following two conditions: 1. This device may not cause harmful interference, and 2. This device must accept any interference received, including interference that may cause undesired operation.

NOTE: This equipment has been tested and found to comply with the limits for a Class B digital device, pursuant to part 15 of the FCC Rules. These limits are designed to provide reasonable protection against harmful interference in a residential installation. This equipment generates, uses and can radiate radio frequency energy and, if not installed and used in accordance with the instructions, may cause harmful interference to radio communications. However, there is no guarantee that interference will not occur in a particular installation. If this equipment does cause harmful interference to

radio or television reception, which can be determined by turning the equipment off and on, the user is encouraged to try to correct the interference by one or more of the following measures:

- Reorient or relocate the receiving antenna.
- Increase the separation between the equipment and receiver.
- Connect the equipment into an outlet on a circuit different from that to which the receiver is connected.
- Consult the dealer or an experienced radio/ TV technician for help.

This equipment complies with the FCC RF radiation exposure limits set forth for an uncontrolled environment. This equipment should be installed and operated with a minimum distance of 20 centimeters between the radiator and your body.

This transmitter must not be co-located except with BugBee modules.

The antennas used for this transmitter must be installed to provide a separation distance of at least 20cm from all persons and must not be located or operating in conjunction with any other antenna or transmitter.

- The combined output power is less than the FCC limit that requires hand-SAR evaluation - Complies with the Maximum Permissible Exposure limit

Related links

Quick Start Guide

Updated: August 2009

Retrieved from "http://bugcommunity.com/wiki/index.php/Quick_Start_Guide_BUGbase_WiFi"

- This page was last modified 18:35, 21 August 2009.
- This page has been accessed 18 times.
- [Privacy policy](#)
- [About BUG Wiki](#)
- [Disclaimers](#)