



OPERATOR'S MANUAL

1-888-9NO-BITE

www.allclearmister.com

U.S. Patent No. 6,951,073
Patents Pending

READ AND SAVE THESE INSTRUCTIONS

QUESTIONS OR COMMENTS

Please contact Universal Pest Solutions if you have any questions about your ALLCLEAR™ Cordless Mosquito Mister at:

1-888-9NO-BITE or www.allclearmister.com

**Universal Pest Solutions, LP
5950 Berkshire Lane, Suite 400
Dallas, TX 75225**

INTRODUCTION

Congratulations on your purchase of the ALLCLEAR™ Cordless Mosquito Mister, the only portable backyard mosquito device that when used with ALLCLEAR Mosquito Mister Concentrates delivers immediate and reliable control of mosquitoes and other biting insects* in your yard. Using our patented misting technology, the ALLCLEAR Cordless Mosquito Mister delivers a 3-minute, ultra-fine mist solution of water and concentrate to create a barrier of protection of up to 2,000 sq. ft. for up to 6 hours**.

Together, the ALLCLEAR Cordless Mosquito Mister and ALLCLEAR Mosquito Mister Concentrate quickly kill and repel mosquitoes and other biting insects, giving you and your family the freedom and confidence to enjoy hours of outdoor activities without the annoyance of biting insects.

ALLCLEAR Cordless Mosquito Mister delivers effective and powerful insect control. Incorporate the ALLCLEAR products into your complete mosquito management program. Please enjoy your ALLCLEAR products and use responsibly.

TABLE OF CONTENTS

Safety Information and Instructions	4
Mister Description.....	5
Mister Set-Up.....	6
Charging the Battery	6
Filling the Tank.....	7
Moving the Mister	7
Operation.....	8
Powering Mister ON and OFF	8
Positioning the Mister	9
Activating Mist Cycle.....	10
Maintenance	11
Storage and Winterization	11
Troubleshooting.....	12
Repair and Service	13
Product Registration.....	13
Warranty.....	13

goodbye mosquitoes.
hello backyard.



* When used with ALLCLEAR Concentrates. Other insects include: ticks, gnats, horse flies, stable flies, deer flies, face flies and others.

** Results may vary based on environmental factors such as rain, wind, sunlight, temperature, and humidity.



Safety Information & Instructions

PLEASE READ ENTIRE OPERATOR'S MANUAL AND ALLCLEAR CONCENTRATE DIRECTIONS BEFORE PLACING AND OPERATING YOUR ALLCLEAR CORDLESS MOSQUITO MISTER.



SAFETY AND PRECAUTIONS

CAUTION: ALLCLEAR Cordless Mosquito Mister and ALLCLEAR Mosquito Mister Concentrate must be operated in compliance with federal law, including all label directions.

WARNING: Make sure Tank Access Door is securely locked and inaccessible to children at all times to prevent access and accidental exposure.

WARNING: Do not activate Mist Cycle when people, pets, or food are present in misting area. Keep children away from mist and unit when machine is active.

GENERAL

- ALLCLEAR Cordless Mosquito Mister is designed for use ONLY with ALLCLEAR Mosquito Mister Concentrates. *(Not Included. Sold Separately.)*
- For outdoor use only.
- Read and follow ALLCLEAR Mosquito Mister Concentrate directions completely before use.

OPERATIONAL

- Operate Mister when needed and when mosquitoes are most active – typically dawn and dusk.
- Allow mist to dissipate before occupying treated area (usually 2 to 5 minutes).
- For optimal results, avoid using the Mister during high winds (>10 mph), heavy rainfall, fog, or when outside air temperatures fall below 50 degrees Fahrenheit.
- Do not activate when wind conditions might create a mist that can blow back to the user.
- Direct nozzles away from bodies of water, and eating and cooking areas when food is present.
- Turn main Mister Power Switch to OFF position when storing Mister indoors.
- Charge battery indoors, in a dry location, and away from outdoor elements.
- Be a good neighbor — some individuals may have sensitivities to pesticides or object to them drifting onto their property.

Mister Description

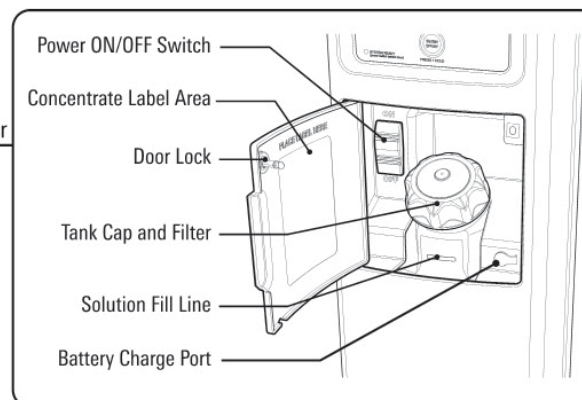
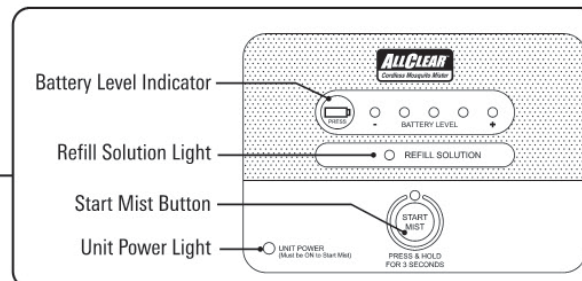
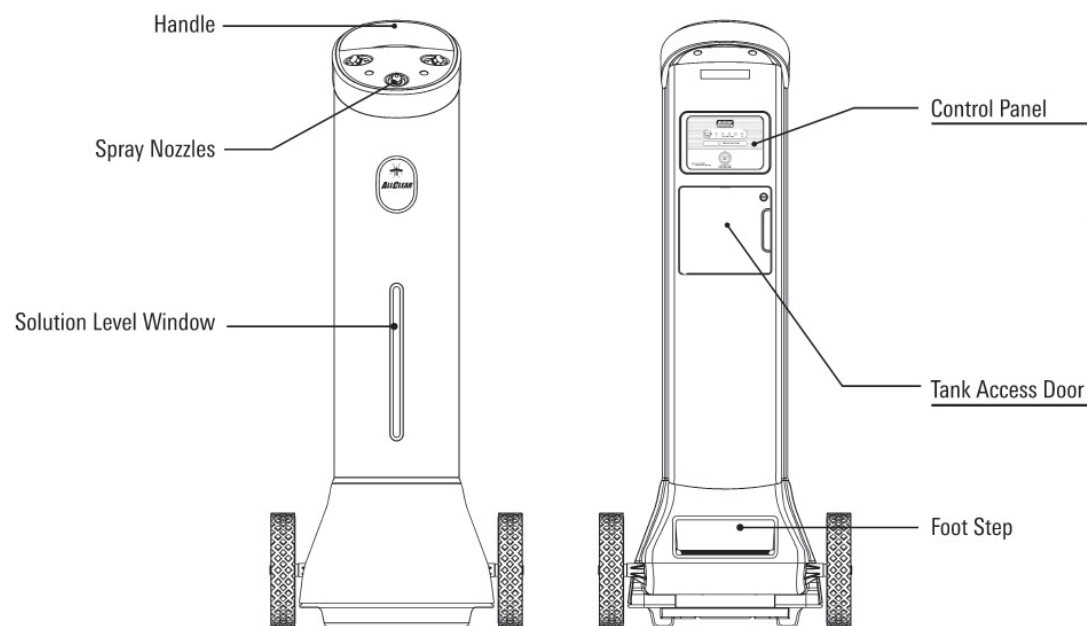

PARTS INCLUDED

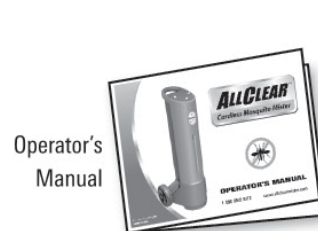
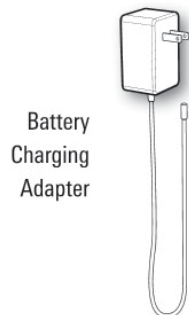
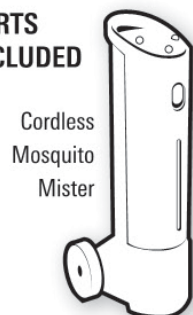

YOU'LL NEED: *Sold Separately*



OR



Mister designed for use ONLY with ALLCLEAR Concentrates. For more information about concentrates or where to purchase, visit: www.allclearmister.com





IMPORTANT TIPS

- Before using the ALLCLEAR Cordless Mosquito Mister for the first time, or at the start of each season, charge battery for 6 hours. Allow approximately 6 hours for subsequent battery charges.
- Fully charged, Mister battery will operate for approximately 25 mist applications before requiring a recharge.
- For best results, recharge battery when two lights are illuminated on Battery Level Indicator. Mister will not operate at full capacity when one or fewer Battery Level Indicator lights are illuminated. (See 'Checking Battery Charge Level' and 'Charging the Battery' instructions.)
- Battery Level Indicator lights will only illuminate if Mister Power Switch is in ON position (See 'Powering Mister ON/OFF' on page 8).
- Mister will not mist if Charging Adapter is plugged into unit or electrical outlet.
- Battery may be recharged at any time without harming the battery.

Mister Set-Up

CHARGING THE BATTERY

1. Move Mister to a dry, covered location with an electrical outlet such as a garage.
2. Open Tank Access Door and make sure Mister Power Switch is in OFF position.
3. Remove Battery Charge Port cap located inside Tank Access Door, lower right hand side (see illustration).
4. Insert Battery Charging Adapter into Mister Charge Port.
5. Charge battery for at least 6 hours for first-time charge.
7. After charging, unplug Battery Charging Adapter from Mister and electrical outlet.

NOTE: Mister will not mist if Charging Adapter is plugged into unit or electrical outlet.

6. Battery is charged when Battery Charging Adapter LED light is green (see 'Checking Battery Charge Level').

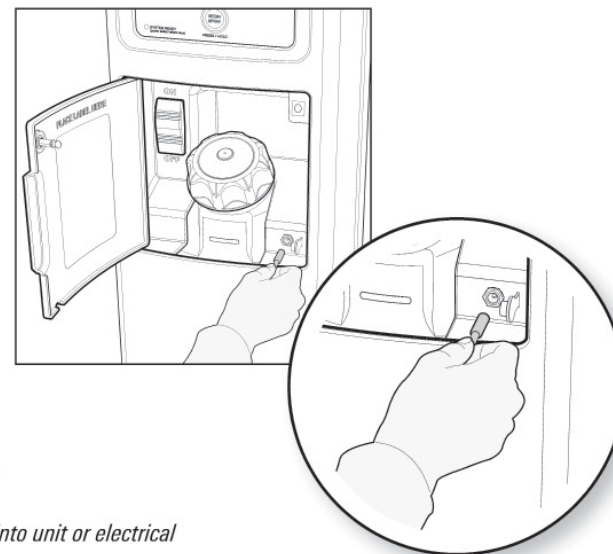

CHECKING BATTERY CHARGE LEVEL

Fully charged, the ALLCLEAR Cordless Mosquito Mister battery will operate for approximately 25 mist applications before requiring a recharge. To ensure battery is operating at capacity, periodically check Battery Level Indicator lights. For optimal operation, turn Mister Power OFF if not in use and recharge battery if two or fewer lights illuminate. (See 'Charging the Battery' instructions).

1. Turn Mister Power Switch to ON position

NOTE: Battery Level Indicator lights only illuminate when the Power Switch is in ON position.

2. Press Battery Level Indicator button located on Control Panel to determine battery charge level.
3. Recharge battery if two or fewer lights illuminate.

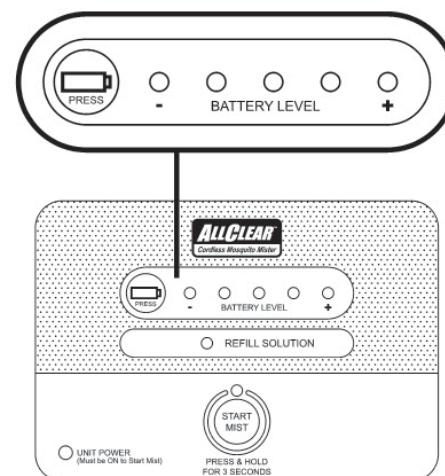

Mister Set-Up

FILLING THE TANK

1. Unlock Tank Access Door, located on the back of Mister. (Use dime or flat-edge screwdriver to open lock)
2. Unscrew Tank Cap.

NOTE: Beneath Tank Cap is a Filter. Leave in place when filling Tank. As needed, remove Filter and rinse clean with water. After rinsing, replace Filter in Tank opening.

3. Slowly fill Tank approximately halfway full with water. For best results, use a garden hose or watering can.
4. Slowly add one entire bottle of ALLCLEAR Concentrate. (Before adding concentrate, read all concentrate label instructions carefully.)
5. Slowly finish filling Tank with water to Fill Line.
6. Replace Tank Cap.
7. Close and lock Tank Access Door.

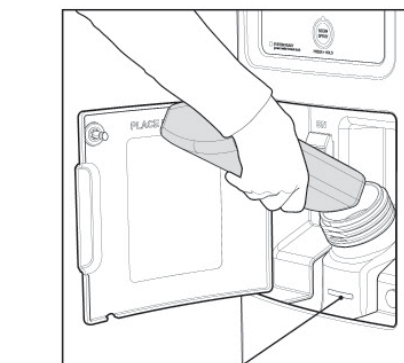

Solution Fill Line

NOTE: Steps 3, 4, & 5 — filling in this order sufficiently mixes solution (see Concentrate label). Solution will remain mixed for several months. If solution remains in Mister Tank longer than several months, gently rock the Mister back and forth for ten seconds to re-agitate water and concentrate. Fasten Tank Cap securely before rocking the Mister.

MOVING THE MISTER

The ALLCLEAR Cordless Mosquito Mister can be easily moved and positioned throughout the yard for optimal coverage.

1. Before moving Mister, make sure Tank Cap is securely fastened and Tank Access Door is locked.
2. Securely grasp Handle at top of Mister.
3. Place foot firmly into Foot Step, tilt Mister toward you, and walk in the desired direction pulling the mister behind you.
4. Mister can be moved throughout the yard with a full Tank.



IMPORTANT TIPS

- The ALLCLEAR Cordless Mosquito Mister is designed for use ONLY with ALLCLEAR Mosquito Mister Concentrates. *Not Included. Sold Separately.*
- Use a garden hose or watering can to fill Mister Tank with water.
- Refill Mister Tank only when Refill Solution Light on the Control Panel is illuminated and Tank is completely empty. This prevents incorrect solution mix which could affect operation.
- If solution remains in Mister Tank for several months, gently rock Mister back and forth for ten seconds to re-agitate water and concentrate. Fasten Tank Cap securely before rocking Mister.

TRANSPORTING MISTER IN A VEHICLE

The Mister can be transported in a car or other vehicle. When possible, transport Mister with an empty Tank. To transport Mister in a vehicle:

1. When possible, empty Tank of misting solution as per recommended operating instructions.
2. Securely fasten Tank Cap and lock Tank Access Door.
3. Stand Mister upright or lay Mister on backside with Control Panel facing down.
4. Securely position Mister to prevent movement when vehicle is in motion.



Operation

IMPORTANT TIPS

- Mister Power Switch (located behind the locked Tank Access Door) must be in ON position to activate Mist Cycle.
- Mister Power Switch (located behind the locked Tank Access Door) must be in ON position to check Battery Level Indicator.
- Mister Power will not turn ON if unit is connected to Charging Adapter.
- If Mister is left in ON position for 15 minutes without use, Mister will enter Sleep Mode.

POWERING MISTER ON AND OFF

POWERING MISTER POWER ON

1. Position Mister in desired location.
2. Unlock and open Tank Access Door.
3. Turn Power Switch to ON position.
4. When Mister Power is ON, the Unit Power Light on the Control Panel will illuminate.
5. Mister Power Switch may be left in ON position in between uses.
6. Mister will enter Sleep Mode if Power is in ON position for 15 minutes or more without use.
7. Unit Power Light on Control Panel will flash when Mister is sleeping.

'WAKING UP' MISTER

There are two ways to "wake up" Mister when in Sleep Mode:

1. Press and hold any button on Control Panel for at least one second.
2. Press and hold Remote Control ON button for one second.

TURNING MISTER POWER OFF

Turn the ALLCLEAR Cordless Mosquito Mister main Power Switch to OFF when:

- Mister not in use
- Recharging battery
- Refilling concentrate and water solution
- Storing Mister indoors or for the winter season

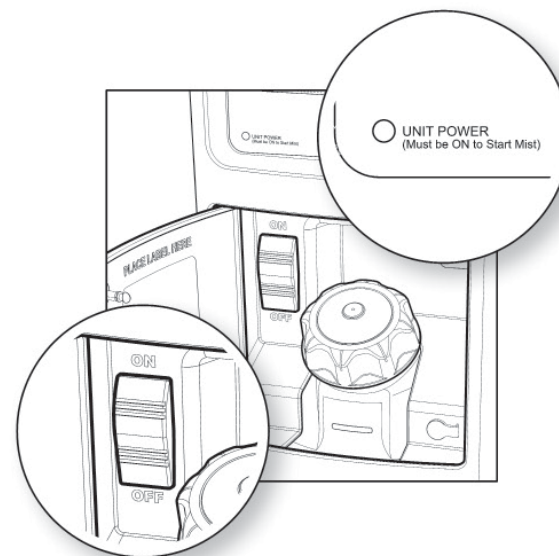

Operation

POSITIONING THE MISTER

Proper placement of the ALLCLEAR Cordless Mosquito Mister is important for optimal insect control.

1. Determine area to be protected.
2. Roll Mister into desired coverage area and establish direction of prevailing wind.
3. Position Mister according to wind conditions shown here.

EXAMPLE:

Treating a Patio Area. Determine prevailing wind. Depending on wind direction, place Mister on either side of, in the center of, or a few feet beyond center of patio so that prevailing winds will carry mist solution directly over patio and surrounding areas.



Position Mister at edge of desired coverage area with Mister nozzles facing mist area so that prevailing wind will carry mist solution over target area.

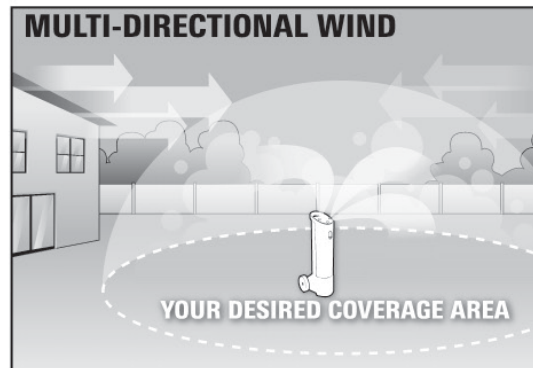

Position Mister in the center of desired coverage area so that the wind will carry the mist solution equally throughout desired coverage area.

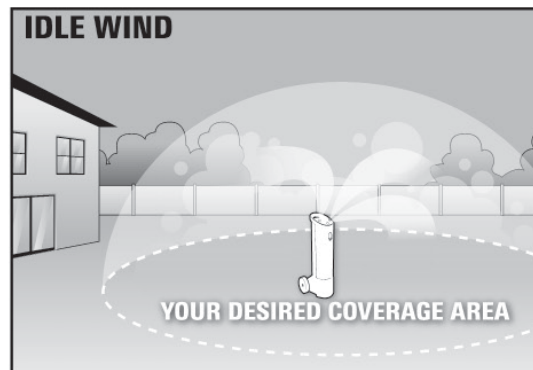

Position Mister in the center of desired coverage area or a few feet beyond center of coverage area.



IMPORTANT TIPS

- Mister performs best if positioned and activated near desired coverage area.
- Place Mister and direct Mister nozzles away from bodies of water and eating or cooking areas when food is present.
- Leave at least 2 to 3 feet between Mister and barrier such as a fence, house, or wall.
- Periodic movement of the Mister is recommended.



IMPORTANT TIPS

- The Start Mist button on the Control Panel turns Mist Cycle on and off.
- Mister Power Switch must be turned to ON position before Mist Cycle can be activated (located behind the locked Tank Access Door).
- Mist Cycle will not activate if Battery Charging Adapter is plugged into Mister.
- Avoid using the Mister during high winds (>10 mph), heavy rainfall, fog, or when outside air temperatures fall below 50 degrees Fahrenheit or other times when insects are typically not active.

Operation

ACTIVATING MIST CYCLE

WHEN TO ACTIVATE:

The ALLCLEAR Cordless Mosquito Mister can be used any time of day to provide immediate and reliable control of mosquitoes, gnats, ticks and other biting insects* for up to 6 hours in an area of up to 2,000 sq. ft. It is recommended that users activate Mist Cycle before spending time outdoors and especially when mosquitoes are most active. Refer to ALLCLEAR Concentrate label and/or go to www.allclearmister.com for additional application instructions.

WHAT TO EXPECT:

The ALLCLEAR Cordless Mosquito Mister kills and repels mosquitoes and other biting insects with a 3-minute, ultra-fine mist solution of water and ALLCLEAR Mosquito Mister Concentrate. The mist solution is atomized out from Mister and carried by the wind into desired coverage area. The atomized mist appears like a light fog and is visible for the first 5-10 feet from the machine during the 3-minute Mist Cycle. Even when no longer visible, mist continues to move throughout coverage area to kill and repel mosquitoes and creates an invisible barrier from insects for hours.

Depending on weather and wind conditions, mist may swirl high and low around Mister and/or it may move directly out from unit or drift behind Mister during Mist Cycle. This is normal operation if mist is moving into and toward the desired coverage area. If mist solution moves toward an undesirable area, stop Mist Cycle with Remote Control by pressing the 'OFF' button, allow mist to dissipate, and reposition Mister so mist can be carried by wind into desired area. (See page 9 for 'Positioning the Mister' instructions.)

ACTIVATING WITH REMOTE CONTROL

1. Before misting and during the Mist Cycle make sure no people, pets, or food items are in the mist area.
2. Press the ON button on the Remote Control device for one second
3. After depressing ON button, there is a 12 second delay accompanied by an audible warning beep from the Mister before the Mist Cycle begins.
4. From a location outside the misting area, watch mist movement to ensure mist moves toward desired area.
5. If mist moves toward an undesired area (e.g., bodies of water, neighboring properties, etc.), stop Mist Cycle by pressing OFF once on Remote Control device. See 'To Stop Mist Cycle' on page 11 for more information.
6. Mist Cycle ends automatically after 3 minutes.
7. Re-enter area after mist has dissipated (usually 2-5 minutes).
8. If needed, move or reposition Mister (See 'Positioning the Mister' instructions on page 9).



CAUTION: Store Remote Control device in an area inaccessible to children.

* When used with ALLCLEAR Concentrates. Other insects include: ticks, gnats, horse flies, stable flies, deer flies, face flies and others.

Operation

ACTIVATING DIRECTLY FROM MISTER

1. Before misting and during the Mist Cycle make sure no people, pets, or food items are in mist area.
2. To activate 3-minute Mist Cycle, Press & Hold for 3 seconds the Start Mist button on rear Control Panel.

NOTE: 3 second 'Press & Hold' feature is intended to prevent accidental activation from unauthorized users.

3. After pressing and holding Start Mist button for 3 seconds, light above button will illuminate.
4. Once illuminated, an audible warning beep begins and user has 12 seconds to leave misting area before Mist Cycle begins.
5. Mister begins 3-minute Mist Cycle.
6. From a location outside misting area, watch mist movement to ensure mist moves toward desired area.
7. If mist moves toward an undesired area (e.g., bodies of water, neighboring properties, etc.) use Remote Control to stop the Mist Cycle. (See 'To Stop Mist Cycle' instruction below. Do not stop Mist Cycle from Control Panel while unit is misting.
8. Mist Cycle ends automatically after 3 minutes.
9. Re-enter area after mist has dissipated (usually 2-5 minutes).
10. If needed, move or reposition Mister (See 'Positioning the Mister' instructions on page 9).

TO STOP MIST CYCLE

- Use Remote Control device to stop unit before or during mist cycle by pushing the OFF button once on the Remote Control device.
- Mister may also be stopped from the Mister Control Panel before unit begins to mist by pushing the Start Mist button once.
- Use Remote Control device to stop misting whenever possible. Do not stop mist cycle from Control Panel while unit is misting.

NOTE: If Mister is stopped, it will reset to original settings. The next time Mister is activated it will begin a new 3-minute Mist Cycle with a 12 second delay and audible warning beep.

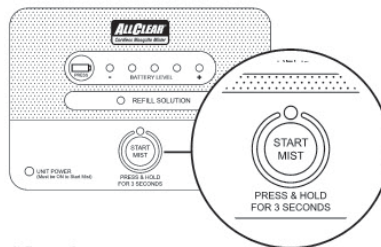

Maintenance

Taking care of the ALLCLEAR Cordless Mosquito Mister with these simple steps will provide optimal operation and longevity.

1. Check Mister Battery Level and Refill Solution Light periodically to ensure battery is charged and enough solution is present for operation. User should check these levels every 3 to 4 weeks (see 'Checking Battery Charge Level' instructions on page 6 and 'Filling the Tank' instructions on page 7).
2. Refill Mister Tank only when Refill Solution Light is illuminated. This will ensure the proper dilution rate of water to ALLCLEAR Mosquito Mister Concentrate is maintained (See 'Filling the Tank' instructions on page 7).
3. Move Mister when needed and/or if browning of grass or other foliage occurs.

Storage & Winterization

During months when outdoor temperatures fall below 40°F, store Mister in a sheltered location away from outdoor elements and in an area with temperatures above freezing (32°F, 0°C). When storing Mister for extended periods of time, store with an empty Tank.

1. To empty Tank, use all misting solution as per recommended operating instructions until Refill Solution Light is illuminated.
2. Switch main Power Switch to OFF position.
3. Close and lock Tank Access Door.
4. Roll and store Mister in a sheltered location with temperatures above freezing (32°F, 0°C).

CLEANING MISTER NOZZLES (OPTIONAL)

If desired, users can clean Mister nozzles before storing for the winter.

1. Turn nozzles counterclockwise. (Use wrench if needed.)
2. Remove nozzle. Nozzle filter is attached to nozzle.
3. Swish nozzle/filter under warm water until clean.
4. Refasten nozzles onto Mister.





Troubleshooting

PROBLEM	POSSIBLE CAUSE	SOLUTION
Mister battery will not charge	1. Battery Adapter is not fully engaged	1. Check that both Charger connections are complete (Mister Port and electric outlet)
	2. Battery is charged but Power Switch is OFF	2. Turn Power Switch to ON position
	3. None of the above	3. Contact Customer Service at 1-888-9NO-BITE
Mister Battery Level Indicator will not illuminate	1. Power Switch is OFF	1. Check Power Switch is in ON position
	2. Adapter is plugged into unit/electrical outlet	2. Unplug Adapter, Power ON unit, press Battery Level Indicator
	3. None of the above	3. Contact Customer Service at 1-888-9NO-BITE
Mister is not misting when Start Mist button is pushed	1. Power Switch is OFF	1. Check Power Switch is in ON position
	2. Not pressing and holding Start Mist button for 3 seconds	2. Press & Hold Start Mist button for 3 seconds
	3. Mister Battery Level low	3. Check level and charge battery if low (see page 6)
	4. Mister Tank empty	4. Check solution level and Refill Solution Light. Fill Tank if empty.
	5. Battery Adapter is plugged into Mister	5. Remove Battery Charging Adapter
	6. Start Mist button not functioning	6. Activate Mister with Remote Control. Press and hold Remote ON button for one second.
	7. None of the above	7. Contact Customer Service at 1-888-9NO-BITE
Remote Control will not operate Mister	1. Not pressing Remote ON button for at least one second	1. Press and hold the Remote ON button for at least one full second
	2. Remote Control batteries low	2. Replace Remote Control batteries
	3. 'Possible Causes' 3, 4, and 5 in above section	3. Try steps 3, 4, 5 above
	4. Remote Control is not functioning	4. Try activating Mister from the Control Panel
	5. None of the above	5. Contact Customer Service at 1-888-9NO-BITE
Mister is not controlling insects/ mosquitoes	1. Mister is not positioned properly	1. See page 9: Positioning the Mister
	2. Solution is low	2. Check Refill Solution Light on Control Panel. If illuminated see page 7.
	3. Mister concentrate needs to be agitated	3. Gently rock Mister back and forth for approximately 10 seconds (see page 7)
	4. Concentrate and water dilution is incorrect	4. Contact Customer Service at 1-888-9NO-BITE
Only 1 or 2 nozzles are spraying	1. Clogged nozzles	1. See page 11 for Nozzle Cleaning instructions
	2. Clogged tubing	2. Contact Customer Service at 1-888-9NO-BITE
Tank has fluid, but Refill Solution Light is illuminated	1. Mister sensors require reset	1. Turn Mister Power Switch to OFF and then to ON to reset unit

Repair & Service

Universal Pest Solutions is committed to excellent quality and service. If you have any questions about your ALLCLEAR Cordless Mosquito Mister or require replacement parts, please contact us at:

**1-888-9NO-BITE or 1-888-966-2483 or visit our Web site at:
www.allclearmister.com**

Please have ALLCLEAR Mister serial number ready when calling customer service. Serial number is located on the inside of the Tank Access Door.

Serial Number: _____

Product Registration

Go online and register your ALLCLEAR Cordless Mosquito Mister today!

Why Register?

- Activate Mister warranty
- Provide valuable product feedback
- Choose to review special offers and tips
- Chance to win free product!

To register go to www.allclearmister.com.

Warranty

UNIVERSAL PEST SOLUTIONS, LP
LIMITED WARRANTY: ALLCLEAR™ Cordless Mosquito Mister

What Is Covered:

With respect to the ALLCLEAR Cordless Mosquito Mister, this warranty covers any defects in parts, materials, or workmanship, subject to the exclusions set forth below.

How Long Coverage Lasts:

The warranty period is two (2) years from the date of the first consumer purchase of the ALLCLEAR Cordless Mosquito Mister.

Condition of Coverage:

This warranty applies only when the ALLCLEAR Cordless Mosquito Mister is used for personal, family, or household purposes.

What is not Covered:

This warranty does not cover the following: (a) damage caused by use with unauthorized or non-Universal Pest Solutions parts; (b) damage caused by accident, misuse, abuse, flood, fire, or external causes; (c) damage caused by use in a manner inconsistent with the permitted or intended uses described in the Operator's Manual; (d) damage caused by service performed by anyone other than a representative of Universal Pest Solutions, LP or an Authorized Service Provider for Universal Pest Solutions, LP; (e) an ALLCLEAR Cordless Mosquito Mister that is modified to significantly alter its functionality or capability, without the prior written consent of Universal Pest Solutions; (f) consumable parts, including batteries used in the remote control but excluding the battery used in the main unit of the ALLCLEAR Mosquito Mister, unless damage to a consumable part occurs due to a defect in ALLCLEAR Cordless Mosquito Mister parts, materials, or workmanship; (g) an ALLCLEAR Cordless Mosquito Mister that is rented, leased, or used for any other commercial purpose; and (h) an ALLCLEAR Cordless Mosquito Mister whose Universal Pest Solutions serial number is removed or defaced.

NO PERSON, AGENT, DEALER, OR DISTRIBUTOR IS AUTHORIZED OR EMPOWERED TO GIVE ANY OTHER WARRANTY OR TO ASSUME ANY OTHER LIABILITY ON BEHALF OF UNIVERSAL PEST SOLUTIONS.

UNIVERSAL PEST SOLUTIONS, LP SHALL NOT BE LIABLE FOR CONSEQUENTIAL DAMAGES RESULTING FROM ANY BREACH OF WARRANTY OR CONDITION. BECAUSE SOME STATES DO NOT ALLOW THE EXCLUSION OR LIMITATIONS OF CONSEQUENTIAL DAMAGES, THE FOREGOING LIMITATION OR EXCLUSION MAY NOT APPLY TO YOU.

What Universal Pest Solutions Will Do:

During the warranty period, Universal Pest Solutions, LP will have the option to repair, replace, or refund in full the original purchase price of any ALLCLEAR Cordless Mosquito Mister that is defective in parts, materials, or workmanship. When appropriate, repair may include or consist of replacing defective parts.

How to Get Service:

If you believe that your ALLCLEAR Cordless Mosquito Mister contains a defect in parts, materials, or workmanship, please do the following:

- Telephone Universal Pest Solutions at 1-888-9NO-BITE (1-888-966-2483). Please state the nature of your problem and have your proof of purchase (e.g., sales receipt) on hand.
- Contact an Authorized Service Provider. To locate the Authorized Service Provider nearest to you, please go to: www.allclearmister.com. You also may obtain a list of Authorized Service Providers by calling Universal Pest Solutions at 1-888-9NO-BITE (1-888-966-2483). If you call, please be prepared to state the nature of your problem and have your proof of purchase (e.g., sales receipt) on hand.

Universal Pest Solutions, LP is committed to excellent quality and service. If you have any questions or comments about your ALLCLEAR Cordless Mosquito Mister, please contact Universal Pest Solutions, LP at the following address:

Universal Pest Solutions, LP
5950 Berkshire Lane, Suite 400
Dallas, Texas 75225
1-888-9NO-BITE (1-888-966-2483)
www.allclearmister.com

This warranty gives you specific legal rights, and you may have additional legal rights that vary from State to State.



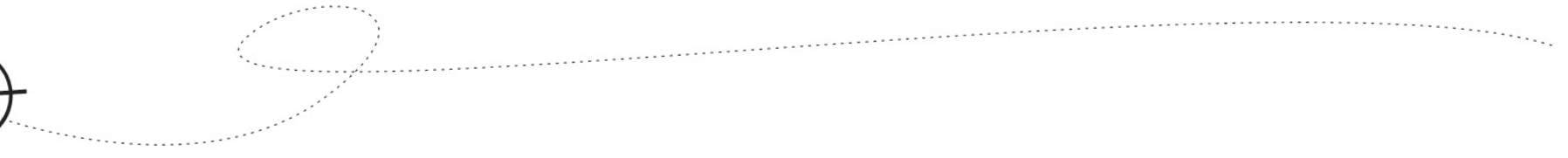

NOTES



NOTES



FCC ID: W3CACM2000

This device complies with Part 15 of the FCC Rules. Operation is subject to the following two conditions: (1) this device may not cause harmful interference, and (2) this device must accept any interference received, including interference that may cause undesired operation.

Universal Pest S O L U T I O N S

1-888-9NO-BITE or www.allclearmister.com

Universal Pest Solutions, LP
5950 Berkshire Lane, Suite 400
Dallas, TX 75225

ACM2000
MFG P/N 7520830000
v2-12-08

This product has been tested and complies with the specifications for a Class B digital device, pursuant to Part 15 of the FCC Rules. These limits are designed to provide reasonable protection against harmful interference in a residential installation. This equipment generates, uses, and can radiate radio frequency energy and, if not installed and used according to the instructions, may cause harmful interference to radio communications. However, there is no guarantee that interference will not occur in a particular installation. If this equipment does cause harmful interference to radio or television reception, which is found by turning the equipment off and on, the user is encouraged to try to correct the interference by one or more of the following measures:

- Reorient or relocate the receiving antenna
- Increase the separation between the equipment or devices
- Connect the equipment to an outlet other than the receiver's
- Consult a dealer or an experienced radio/TV technician for assistance

Universal Pest SOLUTIONS

1-888-9NO-BITE or www.allclearmister.com

Universal Pest Solutions, LP
5950 Berkshire Lane, Suite 400
Dallas, TX 75225

ACM2000
MFG P/N 7520830000
v2-12-08

FCC ID: W3CACM2000

This device complies with Part 15 of the FCC Rules. Operation is subject to the following two conditions: (1) this device may not cause harmful interference, and (2) this device must accept any interference received, including interference that may cause undesired operation.

Changes or modifications not expressly approved by the party responsible for compliance could void the user's authority to operate the equipment