

## SAFETY NOTE

1. This appliance can be used by children aged from 8 years and above and persons with reduced physical, sensory or mental capabilities or lack of experience and knowledge if they have been given supervision or instruction concerning use of the appliance in a safe way and understand the hazards involved.
2. Children shall not play with the appliance.
3. Cleaning and user maintenance shall not be made by children without supervision.
4. If the supply cord is damaged, it must be replaced by the manufacturer, its service agent or similarly qualified persons in order to avoid a hazard.
5. **WARNING:** the drive shall be disconnected from its power source during cleaning, maintenance and when replacing parts.
6. The instructions shall state that the A-weighted emission sound pressure level of the drive is equal to or less than 70 dB(A), e.g. by writing  $L_{pA} \leq 70 \text{ dB(A)}$ .
7. The mass and the dimension of the driven part shall be compatible with the rated torque and rated operating time.
8. The type of driven part the drive is intended for.
9. **WARNING:** Important safety instructions. It is important for the safety of persons to follow these instructions. Save these instructions.
10. Do not allow children to play with fixed controls. Keep remote controls away from children.
11. Frequently examine the installation for imbalance and signs of wear or damage to cables and springs. Do not use if repair or adjustment is necessary.
12. Watch the moving shutter and keep people away until the shutter is completely closed.
13. **WARNING:** Important safety instructions. Follow all instructions, since incorrect installation can lead to severe injury.
14. Before installing the drive, remove any unnecessary cords and disable any equipment not needed for powered operation.

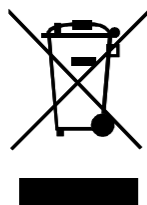

# DM35(45,59)R/SF, DM35(45)RL/SF, DM45(59)RM/SF, DM45RQ/SF

## Instruction | A-04

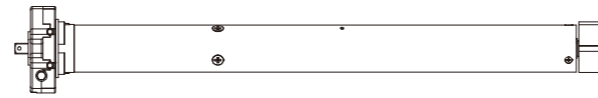

### Features

- Built-in Receiver
- Jog & Tilt
- Switch Direction
- Stall Protection
- Radio Lock
- Wind-sun-rain Sensor Compatible

### Fields Of Application

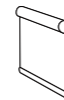

The motor is suitable for motorization of roller blinds.

### Specifications

Working Temperature: $-10^{\circ}\text{C} \sim +70^{\circ}\text{C}$	Radio Frequency: 433.925MHz
Rated Voltage: AC 120V,60Hz; AC 230V,50Hz; AC 220V,60Hz	Thermal Protection Time: > 4 minutes

Following data for reference

Rated Voltage (V)	Model	Rated Torque (N.m)	Rated Speed (rpm)
230	DM35R/SF-10/17	10	17
	DM35R/SF-13/14	13	14
	DM45R/SF-10/15	10	15
	DM45R/SF-20/15	20	15
	DM45R/SF-30/15	30	15
	DM45R/SF-40/15	40	15
	DM45R/SF-50/12	50	12
	DM45R/SF-60/8	60	8
	DM35RL/SF-6/28	6	28
120	DM45RM/SF-50/12	50	12
	DM45R/SF-50/13	50	13
	DM45RL/SF-20/32	20	32
220	DM59RM/SF-120/9	120	9
	DM45R/SF-50/13	50	13

\* For reference only.

### Attention

Never drop, knock, drill or submerge the motor. Keep the power cable in right position as following. Important safety instructions to be read before installation. Incorrect installation can lead to serious injury and will void manufacturer's liability and warranty.

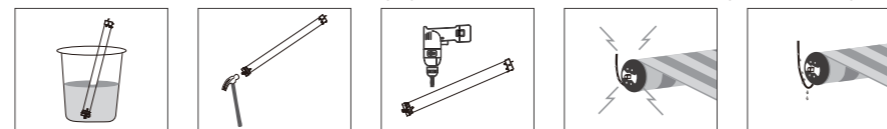

×

×

×

×

✓

### Wiring

Three wires: AC 230V,50Hz; AC120V,60Hz; AC220V,60Hz

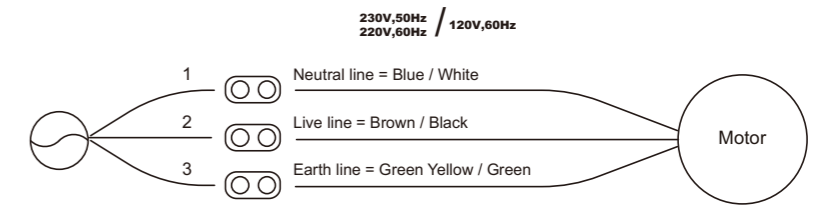

### Motor Installation

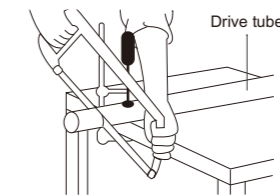

Step 1 Cut drive tube to required length.

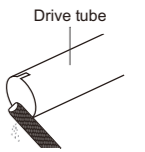

Step 2 Ensure tube edge is clean and burr-free.

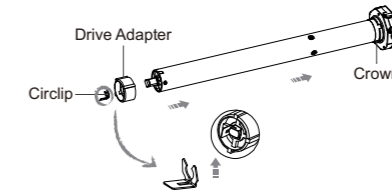

Step 3 Mount correct crown & drive adapter on the motor. Make sure drive adapter fits firmly and crown rotates freely.

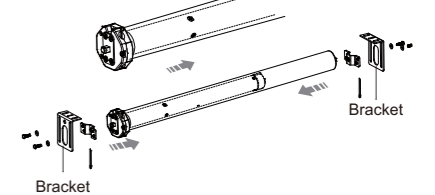

Step 4 Align the notches on the crown and drive adapter with the drive tube, slide and fit the motor into drive tube. Mount idler and bracket on both ends.

### Caution

1. Do not expose motor to humid or extreme temperature conditions.
2. Do not drill into motor.
3. Do not cut the antenna and keep it clear from metal objects.
4. Do not allow children to play with this device.
5. If power cable or connector is damaged, do not use.
6. Ensure correct crown and drive adaptor are used.
7. Ensure power cable and aerial is clear and protected from moving parts.
8. Cable routed through walls shall be properly isolated.
9. Motor is to be mounted in horizontal position only.
10. Before installation, remove unnecessary cords and disable equipment not needed for powered operation.
11. Installation and programming to be performed by a qualified professional, use or modification outside the scope of this instruction may void warranty.



Important Safety Instructions To Be Read Prior To Operation.

### Setting Notice

Please read following points of attention carefully before setting.

1. Please use accessories kits to protect the wires which are not used.
2. Operating:
  - ① The valid interval of the emitter button is 10s, the emitter will quit the set after 10s.
  - ② The motor will jog or beep for hint, please do the next step after the hint.
3. If the emitter lost, please setting up again with new emitter.
4. One motor can store maximum 10 channels; after fully stored, if pair new channels, only the last one will be covered circularly.

## Button Instructions

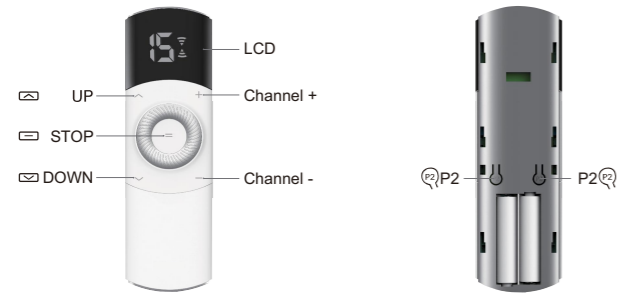

**Essential Settings**  
Step 1 to 2 must be completed to ensure proper operation.

### 1 Pair Additional Emitter

Method one



STOP

Power on motor (1 jog and make a long noise), within 10S, press STOP on new emitter for 2S (2 jogs and 3 beeps), the motor has been paired successfully.

Method two

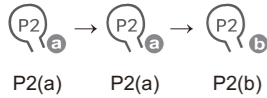

P2(a) P2(a) P2(b)

Press P2 (1 jog and 1 beep) and P2 (1 jog and 1 beep) on existing emitter, press P2 on new emitter (2 jogs and 3 beeps), new emitter has been paired to the motor successfully.

Method three

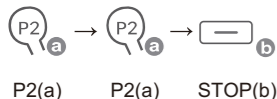

P2(a) P2(a) STOP(b)

Press P2 (1 jog and 1 beep) and P2 (1 jog and 1 beep) on existing emitter, press STOP on new emitter for 2S (2 jogs and 3 beeps), new emitter has been paired to the motor successfully.

\* (a) as existing emitter, (b) as new emitter to pair.

### 2 Switch Rotating Direction (Optional)

If press UP, the motor runs downward, try below to switch direction



UP DOWN

Within 30S after the emitter is successfully added, press and hold UP and DOWN buttons simultaneously for 2S (1 jog), the direction has been switched successfully.

### 3 Activate / Deactivate Jog / Tilt Mode



UP DOWN STOP

Press and hold UP and DOWN buttons simultaneously for 5S (1 jog), press STOP (1 jog and make a long noise), Jog / tilt mode is activated. If motor jogs twice and beep 3 times, Jog / tilt mode is deactivated.

\* Short press UP or DOWN, the motor will jog running; Press UP or DOWN for more than 2S, the motor continuous run.

### 4 Delete Additional Emitter

Method one



STOP(b)

Power on motor again (1 jog and make a long noise), within 10S, press STOP of the desired emitter for 2S (2 jogs and 3 beeps), emitter is deleted successfully.

Method two

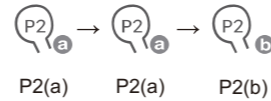

P2(a) P2(a) P2(b)

Press P2 (1 jog and 1 beep), press P2 again (1 jog and 1 beep), Press P2 button once of the desired emitter (2 jogs and 3 beeps), the emitter has been deleted successfully.

\* (a) and (b) are both coded emitters, this operation only removes the emitter (b).

### 5 Remove All Emitters



P2 STOP P2

Press P2 (1 jog and 1 beep), STOP (1 jog and 1 beep), and P2 (2 jogs and 3 beeps), all emitters are deleted.

### 6 Percentage Limits Setting



UP STOP

When the motor stops at any position, press and hold UP and STOP button simultaneously for 2S, the motor will run upwards and downwards once automatically and the upper and lower limits has been memorized by Hub, then the motor can be percentage control.

\* Once the motor finishes Percentage Limits Setting, sliding up the bar, the blind will run upwards, sliding down the bar, the blind will run downwards.

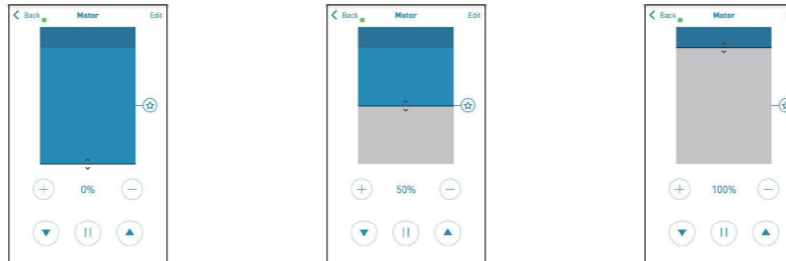

### Pair With Wind-sun Sensor For Roller Blinds.

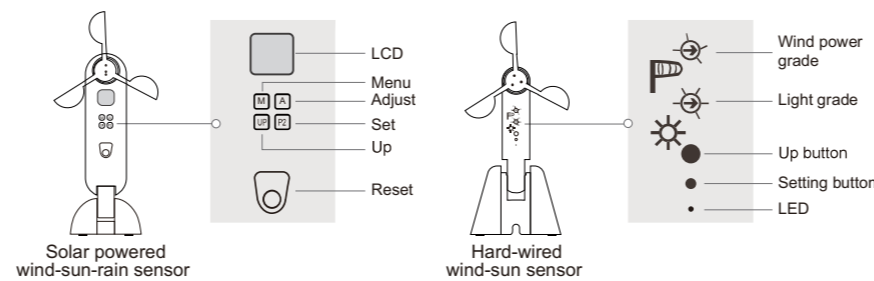

### 7 Adding / Deleting Wind-sun-rain Sensor

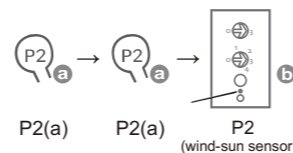

P2(a) P2(a) P2 (wind-sun sensor)

Press P2 (1 jog and 1 beep) and P2 (1 jog and 1 beep) on existing emitter, press P2 on the wind-sun-rain sensor (2 jogs and 3 beeps), wind-sun-rain sensor is paired to the motor.

\* Repeat same procedure will delete sensor.

\* Add multiple wind-sun-rain sensors only currently valid, other are covered; After the wind-sun-rain sensors is added successfully, the sun detection is turned on.

### 8 Enable / Disable Wind-sun-rain Sensor



P2 UP STOP

Press P2 (1 jog and 1 beep), UP (1 jog and 1 beep), STOP (1 jog and make a long noise), wind-sun-rain sensor is disabled. If motor jogs twice and beep 3 times, wind-sun-rain sensor is enabled.

\* The factory default wind-sun-rain sensor is enabled.

### 9 Enable / Disable Sun Detection

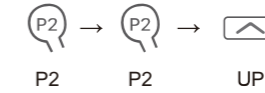

P2 P2 UP

Press P2 (1 jog and 1 beep), P2 again (1 jog and 1 beep), UP (1 jog and make a long noise), Sun detection is disabled. If motor jogs twice and beep 3 times, Sun detection is enabled.

\* The factory default sun detection is enabled.

### 10 Enable / Disable Rain Detection

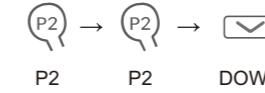

P2 P2 DOWN

Press P2 (1 jog and 1 beep), P2 again (1 jog and 1 beep), DOWN (1 jog and make a long noise), Rain detection is disabled. If motor jogs twice and beep 3 times, Rain detection is enabled.

\* The factory default rain detection is enabled.

### 11 Wind-sun-rain Control

When the wind is strong or the light is weak, the sensor sends signal to motor to run to the upper limit, when the light is strong, the sensor sends signal to motor to run to the lower limit. Once the strong wind command is received, the emitter can't control the sensor within 8 minutes. When the wind-sun-rain sensor is on, if the controller doesn't receive any response signal from the sensor, then the motor will be closed and the emitter will enter jog mode until receiving the response signal from the sensor.

### Quick Index

Settings	Steps
1 Pair Additional Emitter	Stop (hold down 2s)
	P2(a) → P2(a) → P2(b)
	P2(a) → P2(a) → Stop(b) (hold down 2s)
2 Switch Rotating Direction	Up + Down (hold down 2s)
3 Activate / Deactivate Jog / Tilt Mode	Up + Down (hold down 5s) → Stop
4 Delete Additional Emitter	Stop(b) (hold down 2s)
	P2(a) → P2(a) → P2(b)
5 Remove All Emitters	P2 → Stop → P2
6 Percentage Limits Setting	Up + Stop (hold down 2s)
7 Adding / Deleting Wind-sun-rain Sensor	P2(a) → P2(a) → P2 (wind-sun-rain sensor)
8 Enable / Disable Wind-sun-rain Sensor	P2 → Up → Stop
9 Enable / Disable Sun Detection	P2 → P2 → Up
10 Enable / Disable Rain Detection	P2 → P2 → Down

### Troubleshooting

Issues	Possible causes	Solution
The motor has no response	Power Failure Or Incorrect Connection	Double check power and cable connections, follow wiring instructions.
	emitter battery is low capacity	Replace battery
	Radio interference / shielding	Check antenna on motor is intact and exposed. Check for possible source of radio interference.
	Out of radio control range	Try control within closer range
The emitter can't control single motor	Multiple motors are paired to the same channel.	Always reserve an individual correctly (refer to motor functions) Try to use multi-channel emitters to control multi-motor projects, ensure each channel to control one single motor
The motor doesn't run or starts too slowly or make loud noise	Connections are incorrect.	Check connections
	Incorrect installation or overload	Check installation or overload
The motor stops during the going up or going down.	The motor has reached the lower limit	Adjust the new lower limit
	Running time exceeds 4 min	Let the motor cool for about 20 minutes

## **RF exposure statement**

This equipment complies with the FCC radiation exposure limits set forth for an uncontrolled environment. This transmitter must not be co-located or operating in conjunction with any other antenna or transmitter.

## **FCC Warning**

This device complies with Part 15 of the FCC Rules. Operation is subject to the following two conditions:

(1) This device may not cause harmful interference, and (2) this device must accept any interference received, including interference that may cause undesired operation.

NOTE 1: This equipment has been tested and found to comply with the limits for a Class B digital device, pursuant to part 15 of the FCC Rules. These limits are designed to provide reasonable protection against harmful interference in a residential installation. This equipment generates uses and can radiate radio frequency energy and, if not installed and used in accordance with the instructions, may cause harmful interference to radio communications. However, there is no guarantee that interference will not occur in a particular installation. If this equipment does cause harmful interference to radio or television reception, which can be determined by turning the equipment off and on, the user is encouraged to try to correct the interference by one or more of the following measures:

- Reorient or relocate the receiving antenna.
- Increase the separation between the equipment and receiver.
- Connect the equipment into an outlet on a circuit different from that to which the receiver is connected.
- Consult the dealer or an experienced radio/TV technician for help.

NOTE 2: Any changes or modifications to this unit not expressly approved by the party responsible for compliance could void the user's authority to operate the equipment.