

New Trusted Identity Begins

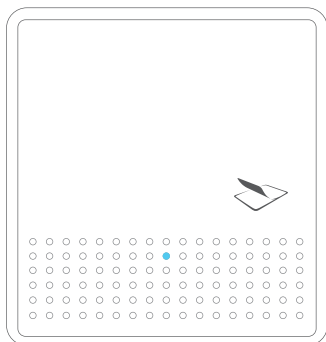

LAMINATOR



QUICK INSTALLATION GUIDE



614518

Features

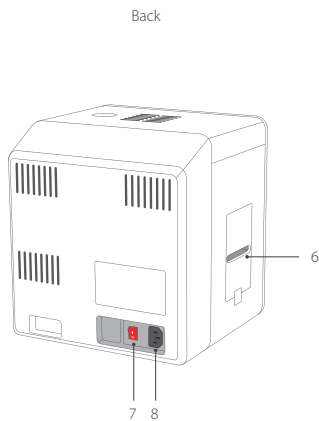
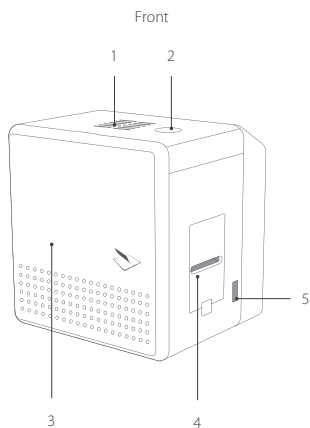

1. Air Vent
2. Physical Lock *option
3. Front Cover
4. Card Insert Slot
5. IR Comm. Port

6. Card Exit Slot
7. Power Switch
8. AC Power Connector

Included



SMART-81
Laminator

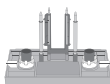

Laminator Film
Cartridge
(in the Laminator)



AC Power
cable

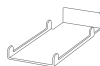

Binding Clamp



Quick Guide

Laminator Installation

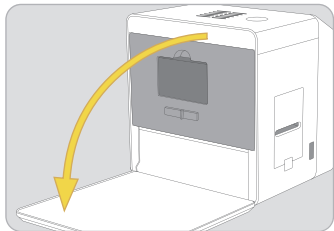

1. Open the front side of the Laminator cover.

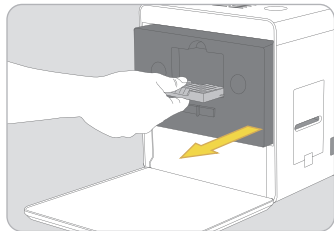

2. Hold the Laminator film cartridge handle and pull it out.

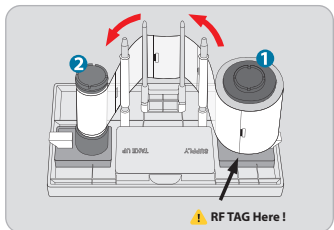

3. Insert the ① Laminator film SUPPLY core on the mounting place of the cartridge core until it "clicks". Wind the film around four shafts following the diagram arrow, and insert ② TAKE UP core into the core mounting until it "clicks".

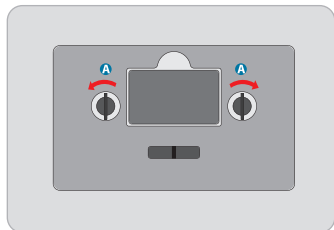

8. Adjust the tension of loaded Laminator film in the direction of the arrow using the Ⓐ TENSION KNOB on the front side of the film cartridge.

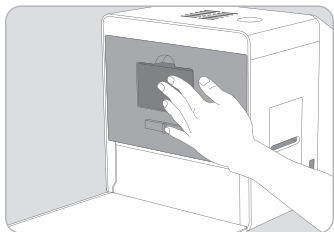

5. Mount the Laminator film cartridge.
The cartridge should be firmly combined with the Laminator.

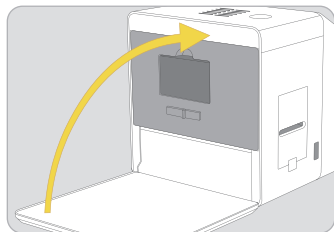

6. Close the front side of Laminator cover.



The RF tag side of the supply core should be mounted in the direction of the cartridge surface.

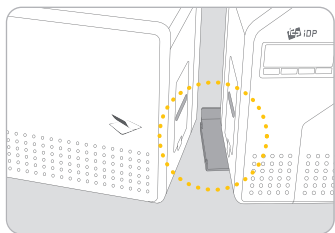

7. Connect the Printer and Laminator with binding clamps.

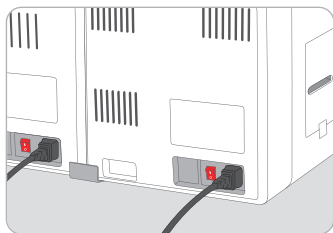

8. Connect the AC Power cable and USB cable.

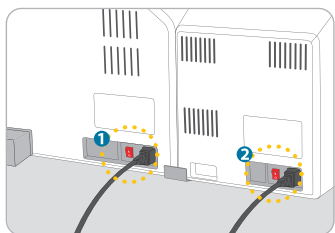

9. Turn on ① the Printer by pressing  the On/Off button at first and then, turn on ② the Laminator.

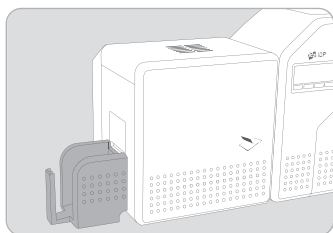

10. Install the Card stacker.

※ The Card stacker is included with the SMART-81 printer.

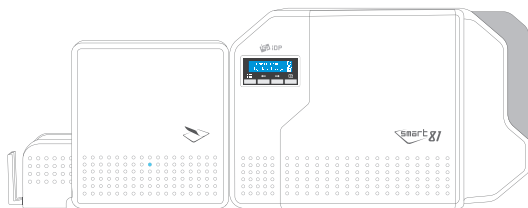

11. Check the model name displayed on the SMART-81 Printer LCD has been changed to SMART-81SL or SMART-81DL.

FCC Instructions

FCC Compliance Statement

This device complies with part 15 of the FCC rules. Operation is subject to the following two conditions: (1) This device may not cause harmful interference, and (2) this device must accept any interference received, including interference that may cause undesired operation.

FCC Interference Statement

This equipment has been tested and found to comply with the limits for a Class B digital device, pursuant to part 15 of the FCC Rules. These limits are designed to provide reasonable protection against harmful interference in a residential installation. This equipment generates, uses and can radiate radio frequency energy and, if not installed and used in accordance with the instructions, may cause harmful interference to radio communications. However, there is no guarantee that interference will not occur in a particular installation. If this equipment does cause harmful interference to radio or television reception, which can be determined by turning the equipment off and on, the user is encouraged to correct the interference by one of the following measures:

- Reorient or relocate the receiving antenna.
- Increase the separation between the equipment and receiver.
- Connect the equipment into an outlet on a circuit different from which the receiver is connected.
- Consult the dealer or an experienced radio/TV technician for help.

FCC Caution

Any changes or modifications not expressly approved by the party responsible for compliance could void the user's authority to operate this equipment. This transmitter must not be co-located or operating in conjunction with any other antenna or transmitter.



LAMINATOR

Specifications

Model		SMART-81L
Laminating	Laminating Type	Direct Heating Lamination
Film	Film Type	Clear, Holographic
	Film Thickness	0.6mil, 1.0mil
Speed	Single sided Lamination	20 sec./card (180 cards/hour)
System	Interface	1 LED Indicator
	Communication	-
	Power Supply / Consumption	Free Voltage (AC 100~240V, 50~60Hz) / 2.0A
	Temperature / Humidity	15~35°C / 35~70%
Dimensions	WxDxH (Millimeter / Inch)	240 x 224 x 260 / 9.5 x 8.8 x 10.2
	Kg/lbs	5.8 / 12.8
Option	Security	Physical Lock

IDP Corp., Ltd.

#601, 50, Digital-ro 33-gil,
Guro-gu, Seoul, Korea,
08377

T +82-2-6099-3700

F +82-2-6099-3717

E sales@idp-corp.com

IDP Americas, Inc.

1485 S County Trail, Unit 306
East Greenwich, RI 02818
USA

T +1-401-400-7111

F +1-401-667-7445

E sales@idpamericas.com

IDP Middle East

13F, Jafza View 18, Downtown
Jebel Ali P.O.Box 17588,
Dubai U.A.E.

T +971-4-889-5900

E mea@idp-corp.com