

BLUE RIDER Hi Bluetooth Stereo Headset

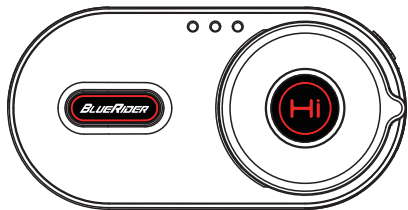

Simplified Operation Manual

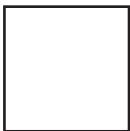

Online Operation and Installation Manual (complete version)

Attention

Attention

Thank you for purchasing Dimton , Hi Bluetooth stereo headset. For the best user experiences, please read this manual before using.

Sound volume warning

Listening for long period of time or to loud sounds may cause impaired hearing.

Disassembly or modification

The Hi is precisely made in the factory. Any disassembly or modification may damage the device. Please do not tear any of the safety regulation and serial number stickers from the device, which will void warranty. Please contact us at service@dimton.com if needed.

Warranty:

In normal use, we offer one year warranty of the headset and half year warranty of the wires from the date of purchase. Any disassembly or modification will void warranty.

Hi Appearance Design

Status light Battery indicator Rotation button

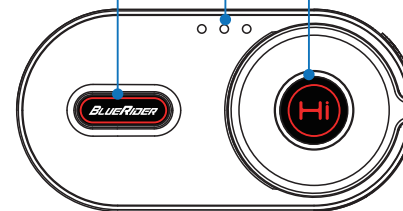

USB charger cable port

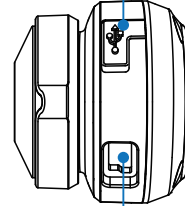

Speaker & microphone set port

When USB charger cable is connected, Bluerider status light will emit red light. After it is fully charged, the red light will be off. Due to water-proof function, please use DIMTON USB charger cable. Do not use unauthentic USB charger cable, which will cause malfunction.

Please do not insert the wrong cable to speaker & microphone set port. This will burn off the circuits.

Switch on / Switch off / Battery indicator

Switch on When the device is off, long press the rotation button for 3 seconds to switch on. The Bluerider status light will flash blue light slowly.

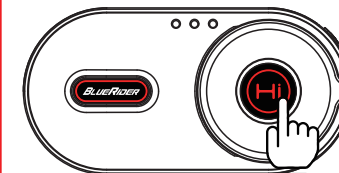

Switch off When the device is on, long press the rotation button for 3 seconds to switch off.

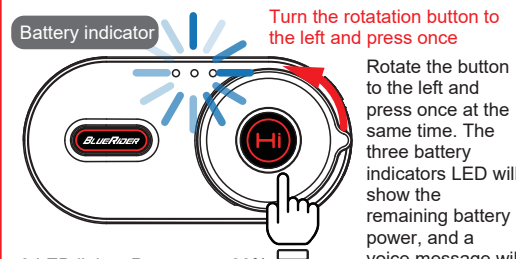

3 LED lights: Power over 90%

2 LED lights: Power over 50%

1 LED light: Power lower 50%

No LED light: Power lower than 10%, Bluerider status light will emit red light.

Turn the rotation button to the left and press once

Rotate the button to the left and press once at the same time. The three battery indicators LED will show the remaining battery power, and a voice message will also tell the battery power.

Pairing with cellphone / Memory clearance

Pairing with cellphone

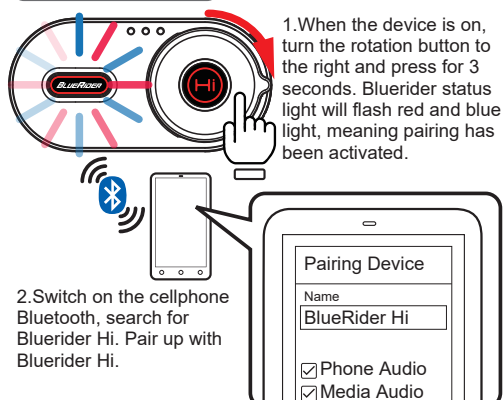

1. When the device is on, turn the rotation button to the right and press for 3 seconds. Bluerider status light will flash red and blue light, meaning pairing has been activated.

2. Switch on the cellphone Bluetooth, search for Bluerider Hi. Pair up with Bluerider Hi.

3. After completing pairing, Bluerider status light will turn into blue and red light flashing slowly.

Memory clearance

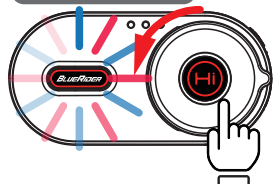

When the device is on, turn the rotation button to the left and press for 6 seconds. Bluerider status light will flash quickly, meaning memory clearance.

Play/Stop music/Adjust volume/Next song/Previous song

Play/Stop music

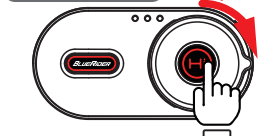

Turn right and press

When the device is connected to the cellphone, and both devices are on, turn the rotation button to the right and press, the music will turn on. When the music is playing, turn off the music by doing the same operation.

Adjust volume



Turn left to volume down

When the music is playing, turn the rotation button to the right, the volume will be up. Turn the rotation button to the left, the volume will be down.

Previous song



Turn right for 2 seconds

When the music is playing, turn the rotation button to the right for 2 seconds, then previous song will play.

Next song



Turn left for 2 seconds

When the music is playing, turn the rotation button to the left for 2 seconds, then next song will play.

Answer phone call/Reject phone call/Redial

Answer phone call/Hang up

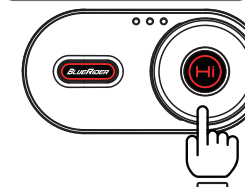

When there is a phone call, press the rotation button once to answer the phone call.

During the call, press again to hang up the call.

Short press the rotation button to answer calls

Reject phone call



When there is a phone call, long press the rotation button for 2 seconds to reject.

Long press the rotation button to reject calls

Redial the last call

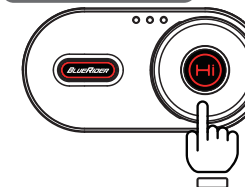

When the device is on, short press the rotation button twice to redial the last call.

Short press the rotation button twice to redial calls

Voice command

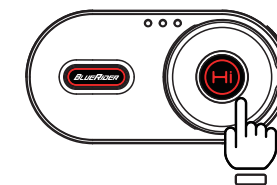

Short press to activate Siri/OK Google

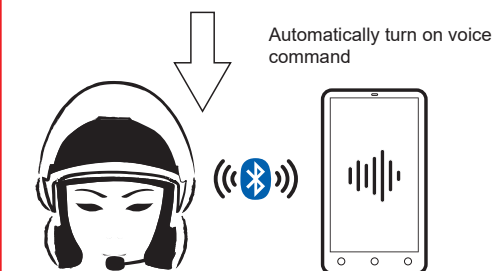

When the device is paired with cellphone, and both devices are on, short press rotation button to activate voice command in phone

Android phone: activate OK Google
iPhone: activate Siri

*The cellphone must be equipped with voice command

BLUERIDER

Hi

Bluetooth Stereo Headset

Simplified Installation Manual

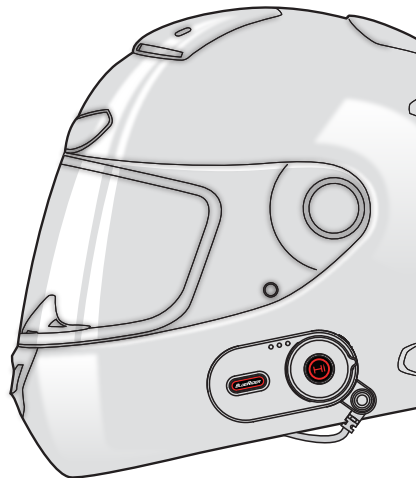

Content In Package

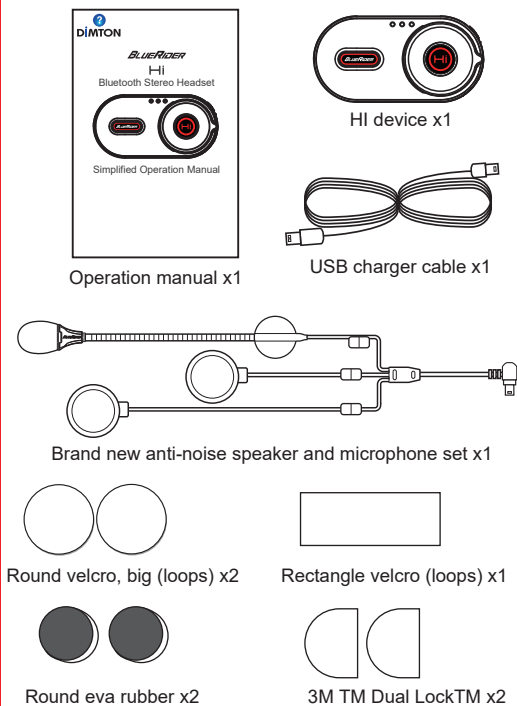

Speaker Installation

Upper view from top of helmet

The shorter wire is the LEFT side speaker

The longer wire is the RIGHT side speaker

*According to European safety regulations, one side of speakers is removable. Please make sure that both sides of speaker are installed at correct positions.



Normal installation
Install round velcro directly

Round velcro, big (loops) x2

If the lining of the helmet is too thick, causing the speaker too far from the ear, please install the round eva rubber first to make the speaker nearer.

Round eva rubber x2 Round velcro, big (loops) x2

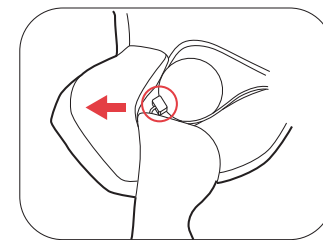

Install the speaker according to the ear pocket shape, so the square plug of the speaker won't pop out.

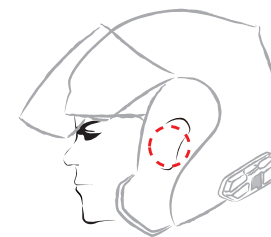

Please make sure that the speakers are in the center of the ear to receive the best sound.

Microphone Installation

View of the helmet lining

Remove the helmet lining, stick the rectangle velcro (loops) to the lining, then place the round velcro (hooks) of the microphone to the rectangle velcro (loops). Then button up the lining.

Rectangle velcro (loops) x1



▲ Microphone in correct position



▲ Microphone away from position, affecting voice receiving

The microphone is flexible anti-noise structure, minimizing ambient noise and physical vibration. Please keep the word "Bluerider" outward.

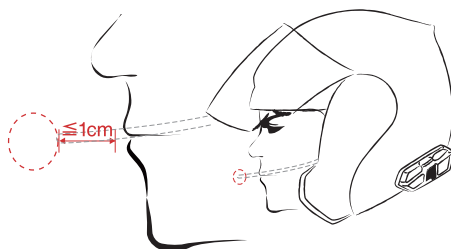

The distance between microphone and mouth should be less than 1 cm. The closer to the mouth, the better quality.

Device Installation

3MTM Dual LockTM has been glued already

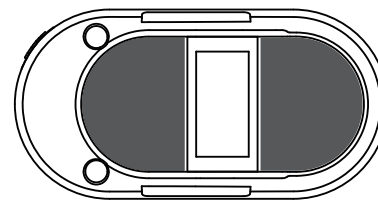

Please place on a relatively flat surface.

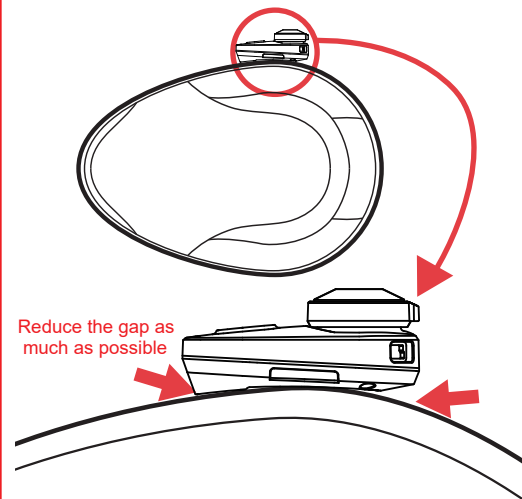
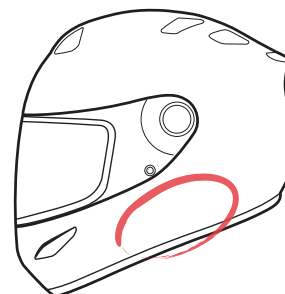

Reduce the gap as much as possible



Dimton social networking service

Please keep the word "Bluerider" outward.

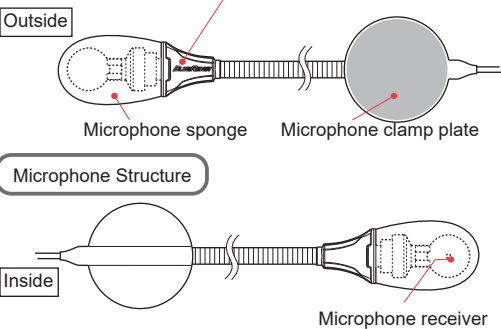

FCC regulatory conformance:

This device complies with Part 15 of the FCC Rules. Operation is subject to the following two conditions:

- (1) This device may not cause harmful interference.
- (2) This device must accept any interference received, including interference that may cause undesired operation.

NOTE: This equipment has been tested and found to comply with the limits for a **Class B** digital device, pursuant to part 15 of the FCC Rules. These limits are designed to provide reasonable protection against harmful interference in a residential installation.

This equipment generates uses and can radiate radio frequency energy and, if not installed and used in accordance with the instructions, may cause harmful interference to radio communications. However, there is no guarantee that interference will not occur in a particular installation. If this equipment does cause harmful interference to radio or television reception, which can be determined by turning the equipment off and on, the user is encouraged to try to correct the interference by one or more of the following measures:

- Reorient or relocate the receiving antenna.
- Increase the separation between the equipment and receiver.
- Connect the equipment into an outlet on a circuit different from that to which the receiver is connected.
- Consult the dealer or an experienced radio/TV technician for help

NOTE: The manufacturer is not responsible for any radio or TV interference caused by unauthorized modifications to this equipment. Such modifications could void the user's authority to operate the equipment.

RF Exposure

This equipment complies with FCC radiation exposure limits set forth for an uncontrolled environment.

IC regulatory conformance

This device complies with CAN ICES-003 (B)/NMB-003(B).

This device contains licence-exempt transmitter(s)/receiver(s) that comply with Innovation, Science and Economic Development Canada's licence-exempt RSS(s). Operation is subject to the following two conditions:

- (1) This device may not cause interference.
- (2) This device must accept any interference, including interference that may cause undesired operation of the device.

Cet appareil est conforme à la norme CAN ICES-003 (B)/NMB-003 (B).

Cet appareil contient des émetteurs / récepteurs exempt (s) de licence qui sont conformes aux RSS exemptes de licence d'Innovation, Sciences et Développement économique Canada. Son fonctionnement est soumis aux deux conditions suivantes:

- (1) Cet appareil ne doit pas provoquer d'interférences.
- (2) Cet appareil doit accepter toute interférence, y compris les interférences susceptibles de provoquer un fonctionnement indésirable de l'appareil.

RF Exposure

This equipment complies with IC radiation exposure limits set forth for an uncontrolled environment.

Cet équipement est conforme aux limites d'exposition aux radiations de la IC définies pour un environnement non contrôlé.