

IMPORTANT REGULATORY INFORMATION

This device complies with Part 15 of the FCC Rules:

Operation is subject to the following two conditions:

1. This device may not cause harmful interference, and
2. This device must accept any interference that is received, including any interference that may cause undesired operation.

WARNING:

Changes or modifications to this unit not expressly approved by the party responsible for compliance could void the user's authority to operate the equipment.

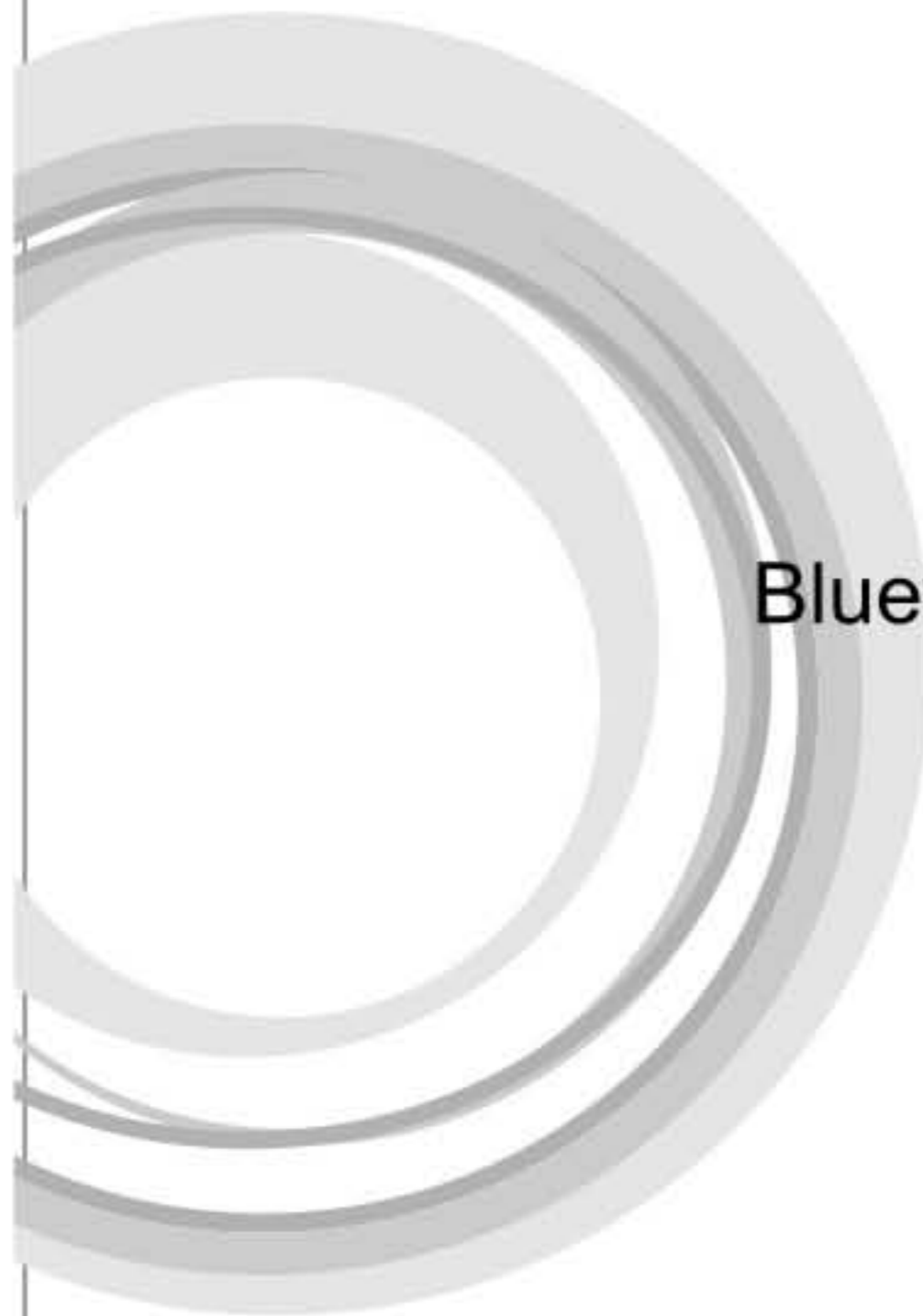

Bluetooth Headset BH-320 User's Guide

繁體中文.....	1
English.....	17

歡迎購買藍牙耳機BH-320,我們希望您對耳機的操作使用感到滿意.

請閱讀本使用說明書,以便了解并充分利用耳機的多種功能.

交通安全

- 當您開車時,駕駛是您的首要職責.
- 在開車時使用耳機,請遵守所在國家或所在地區的規定.

目錄

1 簡介.....4	3 基本使用方法10
藍牙無線技術.....4	佩戴耳機.....10
2 使用入門.....5	使用掛帶佩戴耳機.....11
概述.....5	通話管理12
充電器和電池.....6	調節聽筒音量13
為電池充電.....6	使麥克風靜音或
開機或關機.....7	取消靜音.....13
在耳機和兼容	在手機與耳機間
手機間配對.....7	切換通話.....13
斷開耳機與	將耳機與多部
手機的連接.....8	手機一起使用.....13
將配對耳機重新	清除設置14
連接至手機.....8	4 電池信息.....15
疑難解答.....9	維護和保養.....16

1.簡 介

使用藍牙耳機BH-320,無論您外出旅行還是在辦公室內,都可以隨意撥打和接聽電話.您可以將耳機連接至支持藍牙無線技術的兼容手機.

使用耳機前,請仔細閱讀本<<用戶手冊>>.您還應閱讀手機的<<用戶手冊>>,以了解重要的安全和維護信息.將耳機與其配件放在小孩接觸不到的地方.

■ 藍牙無線技術

通過藍牙無線技術,您可以連接至兼容的通信設備,而無需使用纜線.藍牙連接不要求保持手機與耳機相互正對,但二者之間的最大距離不應超過10米(約30英尺).藍牙連接可能因牆壁等障礙物或其他電子設備而受到干擾.

此耳機符合第2.0版藍牙規範及EDR(Enhanced Data Rate, 增強型數據速率)標準且支持以下藍牙模式:第1.1版耳機模式和第1.5版免提模式.請向其他設備的制造商諮詢以確定該設備是否與本耳機兼容.

在某些地區,使用藍牙無線技術可能受到一些限制.請向當地主管部門或服務供應商諮詢.

2. 使用入門

■ 概述

耳機由以下部分組成:

- 指示燈(1)
- 接聽/掛斷鍵(2)
- 音量鍵(-)(3)
- 音量鍵(+)(4)
- 充電器插孔(5)
- 麥克風(6)
- 耳掛(7)

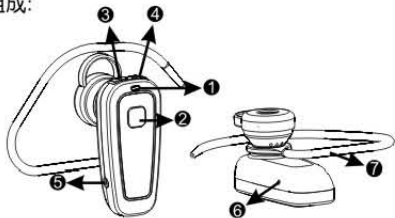

您必須先為電池充電并在兼容手機和耳機間配對, 然後才可以開始使用耳機。

☞ 注意: 耳機的某些部件具有磁性. 金屬物體可能被吸附在耳機上. 請勿使信用卡或其他磁性存儲介質靠近耳機, 以免因消磁而丟失其所儲存的信息。

■ 充電器和電池

使用任何充電器為本耳機充電前, 請先檢查充電器的型號. 藍牙耳機BH-320需經過認可充電器供電才可使用。

⚠ 警告: 僅可使用經過認可, 適用於此特定型號配件的電池和充電器. 使用其他類型的電池和充電器可能違反對設備的認可或保修條款, 并可能導致危險。

■ 為電池充電

本耳機使用內置式不可拆卸充電電池. 請勿嘗試從耳機中取出電池, 以免損壞耳機。

- 1 將充電器的連接綫插頭插入耳機插孔中。
- 2 將充電器插到交流電源插座上. 充電時紅色指示燈亮. 如果充電未開始, 請斷開充電器與耳機的連接, 然後將其重新插入耳機并再試一次. 為電池完全充電可能需要2小時。

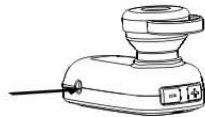

1 充電器的具體型號因插頭類型的不同而不同。

3 電池完全充電后,紅色燈會熄滅藍燈長亮. 斷開充電器與電源插座和耳機的連接.

完全充電的電池可提供上限約為3小時-6小時30分鐘的通話時間或上限約為100小時-180小時的待機時間.但是, 實際通話時間和待機時間可能因與不同的手機或其他采用藍牙連接的產品一起使用, 以及不同的使用設置使用方式和環境而有所不同.

■ 開機或關機

要啟動耳機,請按住電源鍵.耳機會蜂鳴且藍色指示燈會快速閃爍.當耳機連接至配對手機且準備就緒時,藍色指示燈會緩緩閃爍.

要關閉耳機,請按住電源鍵.耳機會蜂鳴且藍紅色指示燈會快速閃爍兩下.

■ 在耳機和兼容手機間配對

- 1 啟動您的耳機.藍燈快速閃爍兩下后藍燈長亮,此時耳機處于配對狀態.
- 2 啟動手機的藍牙功能,然后設置手機以搜索藍牙設備.
- 3 從找到設備的列表中選擇耳機(BH-320).

4 輸入密碼0000以進行配對,藍燈快速閃爍兩下后表明配對成功,并將耳機連接至手機.在部分手機中,您可能需要在配對后單獨建立連接.有關詳情,請參見手機的<<用戶手冊>>.

您只需要為耳機和手機配對一次,

5 如果配對成功,則耳機會蜂鳴并出現在特定的手機功能表中,且您可以經由該功能表查看當前配對的藍牙設備.

斷開耳機與手機的連接

要斷開耳機與手機的連接(例如,將手機連接至其他藍牙設備),請采用以下任一方式:

- 關閉耳機
 - 使用手機的"藍牙"功能表斷開耳機與手機的連接.
 - 將耳機移至距離手機10米(約30英尺)以遠的位置.
- 您不必為了斷開連接而刪除手機與耳機的配對.

將配對耳機重新連接至手機

要連接耳機和手機,請啟動耳機,使用手機的"藍牙"功能表建立連接,或按住接聽/掛斷鍵.

您可以設置手機,使其在耳機啟動時自動與耳機建立連接.在手機中,要實現這一目的,請在"藍牙"功能表中更改配對設備設置.

■ 疑難解答

如果無法將耳機連接至手機,請執行以下操作:

- 確保手機電量充足,已開機,已與手機配對并建立連接.
- 確保手機的藍牙功能已啓動.
- 查看耳機與手機之間的距離是否超過10米(約30英尺),以及二者之間是否存在着牆壁等障礙物或其他電子設備.
- 如果耳機電量充足而仍然停止工作,請將充電器插入耳機,并快速按電源鍵和音量鍵的中央以恢復耳機的設置.恢復設置不會清除您的設置(如配對設置).

3.基本使用方法

■ 佩戴耳機

耳機配有耳挂,可將耳機舒適地佩戴在耳朵上.

要佩戴耳機而不使用耳挂,請將耳機插入耳朵(1),并将耳機朝向您的嘴部.

要佩戴耳機且使用耳挂,請將耳挂插入耳機背面的小開口處(2).要將耳機佩戴在右耳上,請旋轉耳挂以使其位于按鍵的右側.沿耳朵滑動耳挂(3),然后輕按或輕拉耳挂以設置其長度(4).調整耳機以使其朝向您的嘴部!

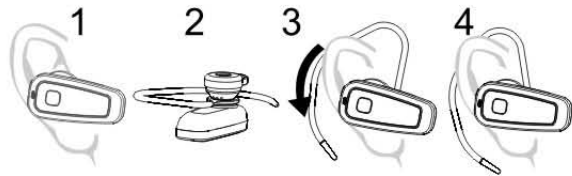

要將耳機佩戴在左耳上,取下耳挂以使其位于按鍵的左側.重新裝上.

5

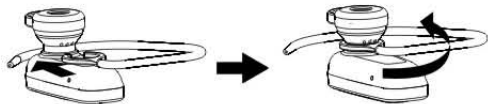

要取下耳挂(例如清潔耳挂時),請輕輕將其從耳機中拔出.

■ 通話管理

當耳機連接至手機時,您可以按普通方式使用手機撥打電話.通話中.藍色指示燈會緩緩閃爍.

如果您的手機支持與此耳機一起操作以重撥號碼,請在未進行通話時快速按兩下接聽/掛斷鍵.

如果手機支持與此耳機一起操作以進行聲控撥號,則可在未進行通話時按住接聽/掛斷鍵,然後按手機<<用戶手冊>>中的說明操作.

當您接到來電時,藍色指示燈會快速閃爍,且您會通過耳機聽到鈴聲.要接聽來電,請按接聽/掛斷鍵,或可使用手機按鍵.如果已啓動了自動接聽功能,則手機會在響鈴一聲后自動接聽來電.要拒絕接聽來電,請快速按兩下接聽/掛斷鍵,或可使用手機按鍵.

要結束通話,請按接聽/掛斷鍵,或可使用手機按鍵.

■ 調節聽筒音量

在通話中,向右按音量鍵可提高音量,向左按音量鍵可降低音量,要快速調節音量,請向所需方向按住音量鍵。

■ 使麥克風靜音或取消靜音

要在通話中使麥克風靜音或取消靜音,請快速按音量鍵的中央。這時會聽到一聲長音,且耳機會按固定間隔蜂鳴直至您取消麥克風靜音。

■ 在手機和耳機間切換通話

要在耳機和兼容手機間切換通話,請按住接聽/掛斷鍵或使用手機的相應功能。

■ 將耳機與多部手機一起使用

耳機最多可與八部手機配對,但每次只能連接一部手機。第一部與耳機配對的手機被稱為首選手機,如果耳機已啓動且在10米(約30英尺)的有效範圍內有多部配對手機,則它會嘗試連接首選首機。如果耳機無法與首選手機建立連接,則會嘗試連接最后使用的手機。如果耳機也無法與該手機建立連接,則其他六部已配對手機中的任何一部就可連接至耳機。要建立連接,請參見手機的<<用戶手冊>>。

■ 清除設置

若要從耳機中清除全部設置(如配對設備列表),請在按住電源鍵的同時向上按音量鍵并持續10秒鐘。設置清除后,耳機會蜂鳴兩次,且在若干秒鐘內,指示燈會交替閃爍。

4 電池信息

本耳機由充電電池供電。新電池只有在經過兩次、三次完全充電和放電的周期后才能達到最佳性能。電池可以充電、放電幾百次，但最終會失效。僅可使用經認可的適用與此耳機的充電器為電池充電。

充電器不用時，請斷開其與耳機的連接，並從電源插座上拔出充電器插頭。請勿將完全充電的電池長時間連接在充電器上，因為過度充電會縮短電池的壽命。如果已完全充電的電池擱置不用，電池本身在一段時間後會放電。

切勿使用任何受損的充電器。

如果把耳機放在過熱或過冷的地方，如在夏天或冬天將其放在封閉的汽車裏，會減少電池的容量和壽命。應盡量將電池溫度保持在15°C和25°C (59°F和77°F)之間。耳機電池過冷或過熱可能會使其暫時無法工作，即使電池電量充足。當溫度遠低於冰點時，電池的性能尤其受到限制。

請勿將電池投入火中，以免電池爆炸，受損電池也可能會爆炸。請按當地規定處理電池。請在可能的情況下回收電池。不可將電池作為生活垃圾處理！

維護和保養

您的設備是具有優良設計和工藝的產品，應小心使用。下列建議將幫助您有效使用保修服務。

- 將所有配件放在小孩接觸不到的地方。
- 保持設備干燥。雨水、濕氣和各種液體或水分都能含有礦物質，會腐蝕電子綫路。如果設備被打濕，請使其完全晾干。
- 不要在有灰塵或骯髒的地方使用或存放設備。這樣會損壞它的可拆卸部件和電子元件。
- 不要將設備存放在過熱的地方。高溫會縮短電子設備的壽命，毀壞電池，使一些塑料部件變形或熔化。
- 不要將設備存放在過冷的地方。否則當設備溫度升高至常溫時，其內部會形成潮氣，這會毀壞電路板。
- 不要試圖拆開設備。
- 不要扔放、敲打或振動設備。粗暴地對待設備會毀壞內部電路板及精密的結構。
- 不要用烈性化學制品、清洗劑或強洗滌劑清洗設備。
- 不要用顏料塗抹設備。塗抹會在可拆卸部件中阻塞雜物從而影響正常操作。

上述建議都適用於您的設備、電池、充電器及配件。如果任何設備不能正常工作，請將其送至距離您最近的授權維修機構維修。

Contents

1. Introduction.....	18
Bluetooth wireless technology.....	18
2. Get started.....	19
Overview.....	19
Chargers and batteries.....	20
Charge the battery.....	20
Switch the headset on or off.....	21
Pair the headset with a compatible phone.....	21
Disconnect the headset from the phone.....	22
Reconnect the paired headset to your phone.....	22
Troubleshooting.....	23
3. Basic use.....	24
Place the headset over your ear.....	24
Calling handling.....	26
Adjust the earphone volume.....	27
Mute or unmute the microphone.....	27
Switch the call between phone and headset.....	27
Use the headset with several phones.....	27
Clear the settings.....	28
4. Battery information.....	29
Care and maintenance.....	30

1. Introduction

The Bluetooth Headset BH-320 allows you freedom to make and receive calls while on the move or in the office. You can connect the headset to a compatible phone that supports Bluetooth wireless technology.

Read this user guide carefully before using the headset. Read also the user guide for your phone, which provides important safety and maintenance information. Keep the headset and its accessories out of reach of small children.

■ Bluetooth wireless technology

Bluetooth wireless technology allows you to connect compatible communication devices without cables. A Bluetooth connection does not require that the phone and the headset be in line of sight, but both devices should be within 10 meters (30 feet) of each other. Connections can be subject to interference from obstructions, such as walls, or other electronic devices.

The headset is compliant with the Bluetooth Specification 2.0+ EDR supporting the following profiles: Headset Profile 1.1 and Hands-Free Profile 1.5. Check with the manufacturers of other devices to determine their compatibility with this device.

There may be restrictions on using Bluetooth technology in some location. Check with your local authorities or service provider.

2. Get started

■ Overview

The headset contains the following parts:

Indicator light (1)

Answer/end key (2)

Volume (-) (3)

Volume (+) (4)

Charger connector (5)

Microphone (6)

Earloop (7)

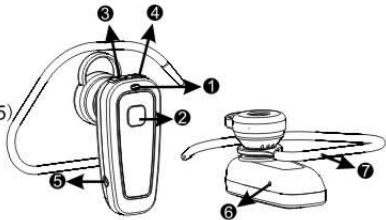

Before you can start using the headset, you must charge the battery and pair the headset with a compatible phone.

➡ Note: Parts of the headset are magnetic. Metallic materials may be attracted to the headset. Do not place credit cards or other magnetic storage media near the headset, because information stored on them may be erased.

■ Chargers and batteries

Check the model number of any charger before using it with this device.



Warning: Use only batteries and chargers approved for use with this particular enhancement. The use of any other types may invalidate any approval or warranty, and may be dangerous.

For availability of approved enhancements, please check with your dealer. When you disconnect the power cord of any enhancement, grasp and pull the plug, not the cord.

■ Charge the battery

This device has an internal, nonremovable, rechargeable battery. Do not attempt to remove the battery from the device as you may damage the device.

1. Connect the charger cable to the headset.
2. Connect the charger to a wall outlet. The red indicator light is during charging. If charging does not start, disconnect the charger, plug it in again, and retry. Charging the battery fully may take up to 2 hours.



3. When the battery is fully charged, the red indicator light turns off
And the blue indicator light turn on. Disconnect the charger from the wall outlet and the headset.

The fully charged battery has power for up to 3 hours–6 hours 30 minutes of talk–time or up to 100 hours–180 hours of stand–by time. However, the talk and standby times may vary with dif–ferent mobile phones, products that use a Bluetooth connection, usage settings, styles. and environments.

■ Switch the headset on or off

To switch on, press and hold the power key, The headset beeps, and the blue indicator light is displayed. When the headset is conne–cted to a paired phone and is ready for use, the blue indicator light flashes slowly.

To switch off, press and hold the power key. The headset beeps, and the blue indicator light is flashing twice.

■ Pair the headset with a compatible phone

1. Press and hold multi–Fuction button until the indictor light turns on in blue
2. Activate the Bluetooth feature on the phone, and set the phone to search for Bluetooth devices.
3. Select the headset from the list of found devices (BH–320).

- 4 Enter the passcode 0000 to pair and connect the headset to your phone. If the pairing was successful, the indictor light will flash in blue 2 times, In some phones you may need to make the connection separately after pairing. See the user guide of your phone for details.

You only need to pair the headset with your phone once.

- 5 If the pairing is successful, the headset beeps and appears in the phone menu where you can view the currently paired Blu–etooth devices.

Disconnect the headset from the phone

To disconnect the headset from your phone (for example, to conn–ect the phone to another Bluetooth device). do one of the follo–wing:

- Switch off the headset.
- Disconnect the headset in the Bluetooth metu of your phone.
- Move the headset more than 10 metters (30 feet) away from the phone.

You do not need to delete the pairing with the headset to disconnect it. Reconnect the paired headset to your phone

To connect the headset to your phone, switch on the headset, make the connection in the Bluetooth metu of your phone, or press and hold the answer/end key

You can set your phone to connect with the headset automatically when the headset is switched on. charge your paired device setting–s in the Bluetooth metu.

■ Troubleshooting

If you cannot connect the headset to your phone, do as follows:

- Ensure that the headset is charged, switched on, and paired with and connected to your phone.
- Ensure that the Bluetooth feature is activated on your phone.
- Check that the headset is within 10 meters (30 feet) of your phone and that there are no obstructions between the headset and the phone, such as walls or other electronic devices.
- To reset the headset if it stops functioning, although it is charged, plug the headset into a charger, and briefly press the power key and the middle of the volume key. This reset does not clear your settings (for example, pairing settings)

3. Basic use

■ Place the headset over your ear

The headset is provided with an earloop that you can use for a better fit on your ear.

To use the headset without the earloop, plug the headset into your ear (1) and point the headset toward your mouth.

To use the headset with the earloop, insert the earloop into the small opening at the back of the headset (2). To wear the headset on the right ear, rotate the earloop so that the loop is to the right of the key. Slide the earloop over your ear (3), and push or pull the earloop to set its length (4). Set the headset so that it points toward your mouth.

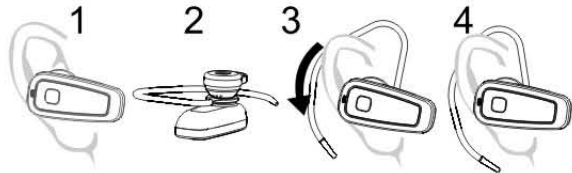

To use the headset on the left ear, take down the earloop and let the loop to the left of the key.

5

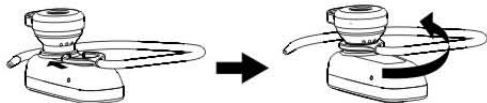

To detach the earloop (for example, to clean it), gently pull it from the headset.

■ Call handling

To make a call, use your phone in the normal way when the headset is connected to your phone. The blue indicator light flashes slowly during the call.

If your phone supports redialing with this device, press the answer/end key twice when no call is in progress.

If your phone supports voice dialing with this device, press and hold the answer/end key when no call is in progress, and proceed as described in the user guide of your phone.

When you receive a call, the blue indicator light flashes quickly, and you hear a ringing tone through the headset. To answer the call, press the answer/end key, or use the phone keys. If the automatic answer function is on, the phone automatically answers the incoming call after one ring.

To reject an incoming call, briefly press the answer/end key twice. Or use the phone keys.

To end a call, press the answer/end key, or use the phone keys.

■ Adjust the earphone volume

Press the volume key right up to increase or left to decrease the volume during a call. To adjust the volume quickly, press and hold the key in the desired direction.

■ Mute or unmute the microphone

To mute or unmute the microphone during a call, briefly press the middle of the volume key. A long is played, and the headset beeps at regular intervals until you unmute the microphone.

■ Switch the call between phone and headset

To switch the call between the headset and a compatible phone, press and hold the answer/end key, or use the respective function in your phone.

■ Use the headset with several phones

You can pair the headset with up to eight phones but connect it to only one phone at a time.

The phone that was first paired with the headset is the default phone. If the headset is switched on within 10 meters (30 feet) of several paired phones, the headset tries to connect to the default phone.

If the headset cannot connect to the default phone, the headset tries to connect to the last used phone. If the headset cannot connect to this phone either, one of the other six paired phones can be connected to the headset. To make the connection, see the user guide for your phone.

■ Clear the settings

If you want to clear all the settings from the headset (for example, the list of paired devices), press and hold the power key and the volume key up for 10 seconds. After the settings are cleared, the headset beeps twice, and the indicator lights alternate for several seconds.

4. Battery information

Your device is powered by a rechargeable battery. The full performance of a new battery is achieved only after two or three complete charge and discharge cycles. The battery can be charged and discharged hundreds of times, but it will eventually wear out. Recharge your battery only with approved chargers designated for this device.

Unplug the charger from the electrical plug and the device when not in use. Do not leave a fully charged battery connected to a charger, since overcharging may shorten its lifetime. If left unused, a fully charged battery will lose its charge over time.

Never use any charger that is damaged.

Leaving the device in hot or cold places, such as in a closed car in summer or winter conditions, will reduce the capacity and life time of the battery.

Always try to keep the battery between 15°C and 25°C (59°F and 77°F). A device with a hot or cold battery may not work temporarily, even when the battery is fully charged. Battery performance is particularly limited in temperatures well below freezing.

Do not dispose of batteries in a fire as they may explode. Batteries may also explode if damaged. Dispose of batteries according to local regulations. Please recycle when possible. Do not dispose as household waste.

Care and maintenance

Your device is a product of superior design and craftsmanship and should be treated with care. The suggestions below will help you protect your warranty coverage.

- Keep all accessories and enhancements out of the reach of small children.
- Keep the device dry. Precipitation, humidity, and all types of liquids or moisture can contain minerals that will corrode electronic circuits. If your device does get wet, allow it to dry completely.
- Do not use or store the device in dusty, dirty areas. Its moving parts and electronic components can be damaged.
- Do not store the device in hot areas. High temperatures can shorten the life of electronic devices, damage batteries, and warp or melt certain plastics.
- Do not store the device in cold areas. When the device returns to its normal temperature, moisture can form inside the device and damage electronic circuit boards.
- Do not attempt to open the device.
- Do not drop, knock, or shake the device. Rough handling can break internal circuit boards and fine mechanics.
- Do not use harsh chemicals, cleaning solvents, or strong detergents to clean the device.
- Do not paint the device. Paint can clog the moving parts and prevent proper operation.

All of the above suggestions apply equally to your device, battery, charger, or any enhancement. If any device is not working properly, take it to the nearest authorized service facility for service.

■ Overview

The headset contains the following parts:

Indicator light (1)

Answer/end key (2)

Volume (-) (3)

Volume (+) (4)

Charger connector (5)

Microphone (6)

Earloop (7)

