

uTV 2 guide

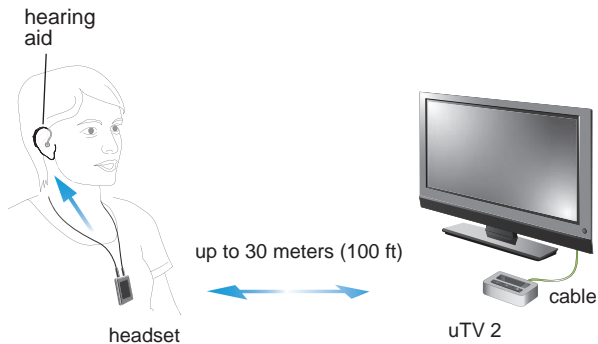

uTV 2 description

The Uniron uTV 2 connects your A2DP Headset wirelessly to your TV or other audio devices.



The uTV 2 is connected to your TV (or any other audio source) and wirelessly sends audio signals from your TV to your headset within a range of up to 30 meters (100 ft).

Legend

Buttons

- (a) ON/OFF button
- (b) TV signal volume (up)
- (c) TV signal volume (down)

Inputs

- (d) Power input (mini-USB)
- (e) Audio input (3.5 mm jack)
- (f) Charging slot

- (g) Status light

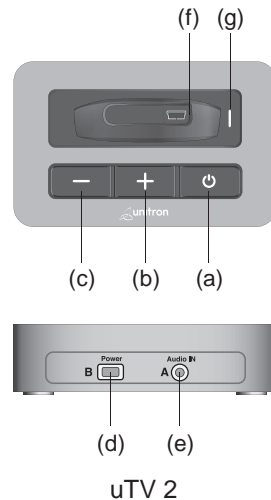

Installation

Step 1: Connecting the uTV 2

To connect the power supply (h):

Place the uTV 2 next to your TV. Connect the mini-USB plug (d) of the power supply to the power input (Power) of the uTV 2. Plug the power supply into the wall socket.

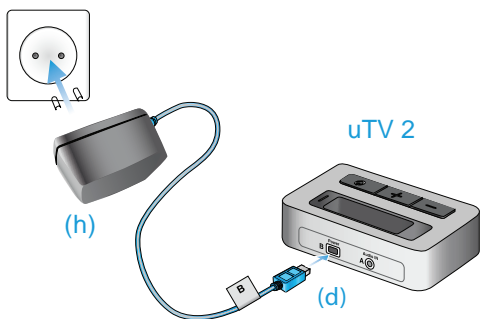

Use the RCA/Cinch cable (i) to connect the uTV 2 to the TV:

Connect the stereo (e) plug to the audio input (Audio IN) of the uTV 2. Connect the red and white plugs (i) to the matching red and white output sockets on your TV.

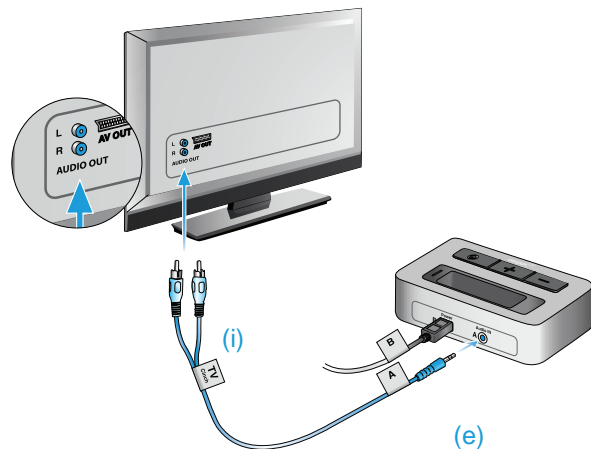



You can also connect your uTV 2 to the headset socket of your TV, using the audio cable:

Connect the stereo plug (e) to the audio input of the uTV 2 (Audio IN).

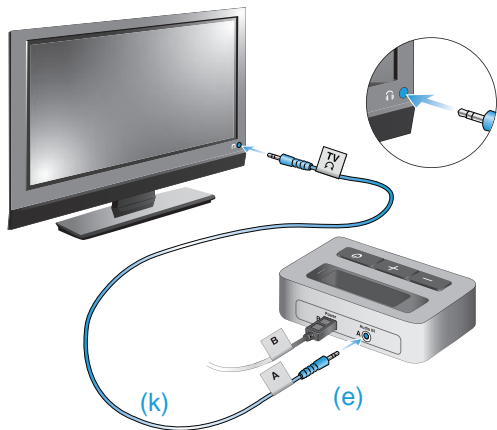
Plug the other end into the headset output socket of your TV.



 *When connecting the uTV 2 to the headset socket of your TV, you are able to adjust the volume via your TV remote control.*

 *Some TVs will switch off their loudspeakers when plugging the jack into the headset socket - the TV will not be audible for other people. In this case use the Cinch/RCA or SCART output socket as described above. For further information on volume adjustment, refer to step 5. The uTV 2 can also be connected to any other audio source such as an MP3 player, PC or home sound system using the stereo plug cable (k).*

Step 2: Switching on

1. Switch on the uTV 2 by a short press of the ON/OFF button (a) as shown in fig. 2. The status light (g) will illuminate green initially and may later switch to blue.

uTV 2

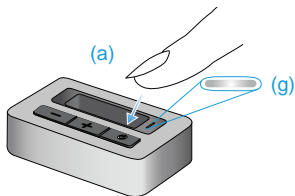

fig. 2

Step 3: Pairing Headset and uTV 2

Before starting to use the uTV 2 and headset, they need to be paired. The pairing procedure controls which Bluetooth® devices are permitted to communicate with each other.



Pairing needs to be completed only once for each device you wish to use with your headset.

- Initiate the pairing process on your headset as stated in its manual.
- If the uTV 2 status light (g) is not rapidly blinking blue already, press the ON/OFF button (a) for 5 seconds until the Bluetooth indicator (g) is rapidly blinking blue as shown in fig 2.
- Wait until the Bluetooth indicator light (g) turns solid blue. This can take up to 2 minutes but typically is done within a few seconds.

Step 4: Listening to your TV

You will hear the sound of your TV directly in your headset.



If you cannot hear the sound of your TV through uTV 2, repeat steps 1 to 4.

The uTV 2 supports Bluetooth operation up to a range of 30 m (100 ft). Line-of-sight between your headset and the uTV 2 is not required. However, interference in the environment by walls or furniture may reduce the operating range.

If the headset moves out of range of the uTV 2, the wireless audio transmission will be terminated. If the headset is then moved back into range of the uTV 2, it will automatically resume streaming to your headset.

 It may take up to 10 seconds until the streaming resumes. Both streaming light indicators (g) should be solid blue during streaming.

 If the uTV 2 status light (g):

- is green, make sure TV sound and headset are switched on.
- blinks blue, you are in paused mode. Press the headset main button (A) to resume streaming.

Step 5: Adjusting the volume of the TV signal

First, set the volume of the TV speakers at the level to suit other viewers.

- If the uTV 2 is connected to your TV with the RCA/Cinch cable (i) or the SCART adaptor (k), adjust the volume via the uTV 2 volume control (b) and (c) until the sound is comfortable.

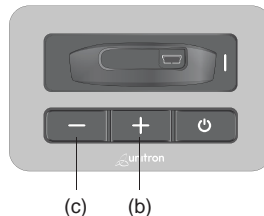

- If your uTV 2 is connected to the headphone socket of your TV, you may also use your TV remote control to adjust volume via the TV directly. Refer to the TV user guide for more details on setting the TV volume.

 If your TV is connected to a satellite receiver or a set-top box, make sure the volumes of these additional devices are set to a medium level for best audio quality results.

Step 6: Switching off uTV 2

To switch off the devices:

- To end the transmission of the TV audio signal, switch off the uTV 2 by pressing the ON/OFF button (a) as shown in fig. 7.

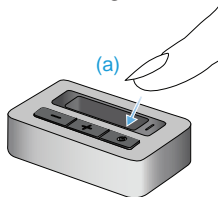

fig. 7



If no audio input is available, the uTV 2 automatically stops the Bluetooth audio transmission to headset after 5 minutes. Its status light will blink green.

Compliance information

Declaration of Conformity

Hereby Unitron declares that this Unitron product is in compliance with the essential requirements of the Radio and Telecommunications Terminal Equipment Directive 1999/5/EC. The full text of the Declaration of Conformity can be obtained from the manufacturer or the local Unitron representative whose address can be taken from the list on www.unitron.com (worldwide locations).

Notice 1:

This device complies with Part 15 of the FCC Rules and with RSS-210 of Industry Canada. Operation is subject to the following two conditions:

- 1.) this device may not cause harmful interference, and
- 2.) this device must accept any interference received, including interference that may cause undesired operation.

Notice 2:

Changes or modifications made to this device not expressly approved by Unitron may void the FCC authorization to operate this device.

Notice 3:

This device has been tested and found to comply with the limits for a Class B digital device, pursuant to Part 15 of the FCC Rules and ICES-003 of Industry Canada.

These limits are designed to provide reasonable protection against harmful interference in a residential installation. This device generates, uses and can radiate radio frequency energy and, if not installed and used in accordance with the instructions, may cause harmful interference to radio communications. However, there is no guarantee that interference will not occur in a particular installation. If this device does cause harmful interference to radio or television reception, which can be determined by turning the equipment off and on, the user is encouraged to try to correct the interference by one or more of the following measures:

- Reorient or relocate the receiving antenna.
- Increase the separation between the device and receiver.
- Connect the device into an outlet on a circuit different from that to which the receiver is connected.
- Consult the dealer or an experienced radio/TV technician for help.

Notice 4:**FCC/IC RF Radiation Exposure Statement**

This equipment complies with FCC/IC radiation exposure limits set forth for an uncontrolled environment. End users must follow the specific operating instructions for satisfying RF exposure compliance. This transmitter must not be co-located or operating in conjunction with any other antenna or transmitter.

More details can be found in the data sheet which can be downloaded from www.unitron.com.

CE The CE symbol is confirmation by Unitron that this Unitron product meets the requirements of the 0678 R&TTE Directive 1999/5/EC on Radio and Telecommunication Terminal Equipment. The numbers after the CE symbol are the numbers of consulted certified bodies under the above mentioned directives. The alert sign means that potential restrictions on its use are applicable in one or more EU Member States.

This device is a class 2 device and can be operated in the EU member states without restrictions for indoor use, but must not operated outdoors in France.

Operating conditions:

This device is designed such that it functions without problems or restrictions if used as intended, unless otherwise noted in these user guides.

0° to 55° Celsius and relative humidity of <95% (non condensing).

Transport and storage conditions:

During transport or storage, the temperature should not exceed the limit values of -20°/60° Celsius and relative humidity of 90% for a long period of time.

The air pressure between 500 and 1100 hPa is appropriate.

 The symbol with the crossed-out garbage bin is to make you aware that this device may not be thrown away as normal household waste.

Please dispose of old or unused device, at waste disposal sites intended for electronic waste, or give your device to your hearing care professional for disposal. Proper disposal protects the environment and health.

Bluetooth®

The Bluetooth® word mark and logos are registered trademarks owned by Bluetooth SIG, Inc. and any use of such marks by Unitron is under license. Other trademarks and trade names are those of their respective owners.

 Australian EMC and Radiocommunications compliance label

DISTRIBUTOR



Unitron Hearing Ltd.
20 Beasley Drive, P.O. Box 9017,
Kitchener, ON N2G 4X1 Canada

European Representative
Max-Eyth-Straße 20, 70736
Fellbach-Oeffingen, Germany

CE 0678  

www.unitron.com

10-035 029-5836-02



 **unitron**[™]