

uTV™ guide

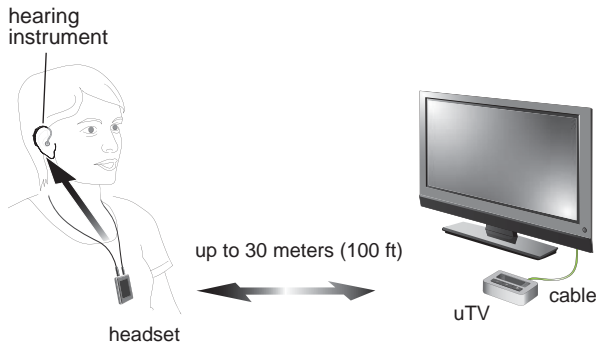

uTV™ description

The Unitron uTV connects your A2DP Headset wirelessly to your TV or other audio devices.



Bluetooth® is a registered trademark owned by the Bluetooth® SIG, Inc. and any use of such marks by Unitron is under license.

Other trademarks and trade names are those of their respective owners.

The uTV is connected to your TV (or any other audio source) and wirelessly sends audio signals from your TV to your headset within a range of up to 30 meters (100 ft).

Legend

Buttons

- (a) ON/OFF button
- (b) Volume control (up)
- (c) Volume control (down)

Inputs

- (d) Power input (mini-USB)
- (e) Audio input (3.5 mm jack)
- (f) Charging slot

- (g) Status light

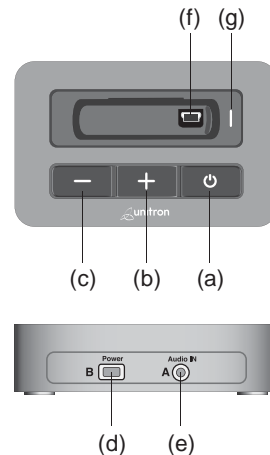

Installation

Step 1: Connecting the uTV

To connect the power supply (h):

Place the uTV next to your TV. Connect the mini-USB plug of the power supply to the power input ("Power") of the uTV. Plug the power supply into the wall socket.

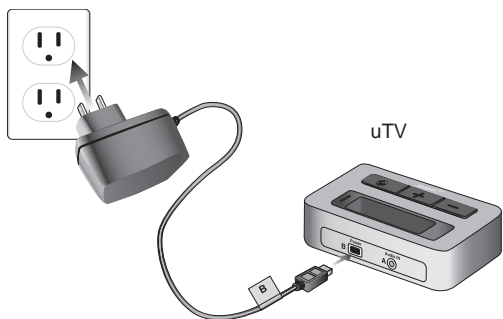

Use the RCA/Cinch cable (i) to connect the uTV to the TV:

Connect the 3.5 mm stereo plug to the audio input ("Audio IN") of the uTV. Connect the red and white RCA/Cinch plugs to the matching red and white RCA/Cinch output sockets on your TV.

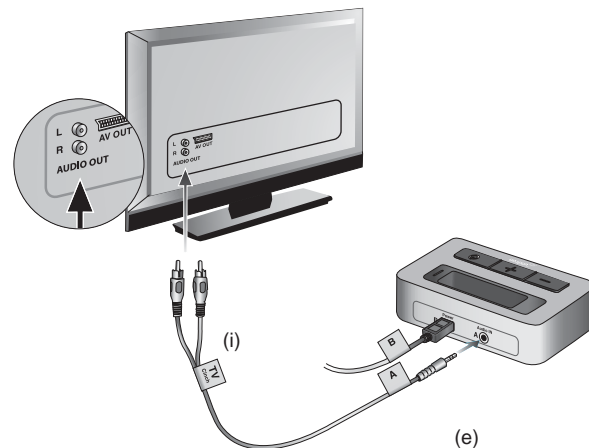



You can also connect your uTV to the 3.5 mm headset socket of your TV, using the 3.5 mm audio cable (k):

Connect the 3.5 mm stereo plug to the audio input of the uTV ("Audio IN").

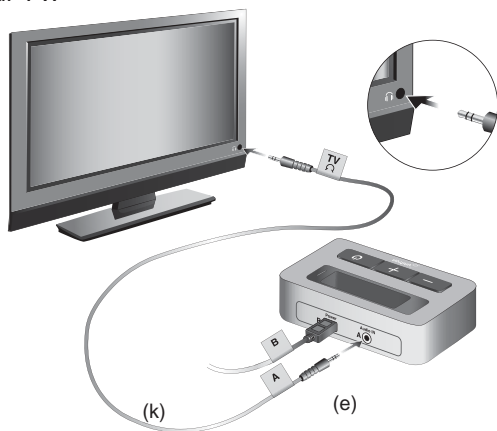
Plug the other end into the headset output socket of your TV.



 *When connecting the uTV to the 3.5 mm headset socket of your TV you are able to adjust the volume via your TV remote control.*

 *Many TVs will switch off their loudspeakers when plugging the 3.5 mm jack into the headset socket - the TV will not be audible for other people. In such a case use the Cinch/RCA or SCART socket as described above. For further information on volume adjustment please refer to step 5 below. The Unitron uTV can also be connected to any other audio source such as an MP3 player, PC or home sound system using the stereo plug cable (k).*

Step 2: Switching on

1. Switch on the uTV by a short press of the ON/OFF button (a) as shown in fig. 2. The status light (g) will illuminate green initially and may switch to blue later.

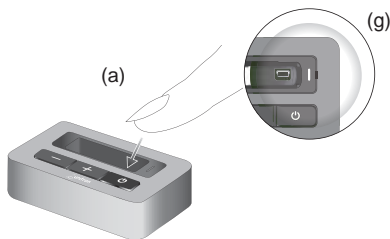



fig. 2

Step 3: Pairing Headset and uTV

Before starting to use the uTV, it must be paired with your headset. The pairing procedure controls which Bluetooth devices are permitted to communicate with each other.

 *Pairing needs to be completed only once for each device you wish to use with your headset.*

- Initiate the pairing process on your headset as stated in its manual.
- If the uTV basestation status light (g) is not flashing blue already, press the ON/OFF button (a) for 5 seconds until the Bluetooth indicator (g) is fast flashing blue.
- Wait until the Bluetooth indicator light (g) turns solid blue. This can take up to 2 minutes but typically is done within a few seconds.

Step 4: Listening to your TV

You will hear the sound of your TV directly in your headset.

 *If you cannot hear the sound of your TV through uTV please repeat steps 1 to 4.*

The uTV system supports Bluetooth operation up to a range of 30 m (100 ft). Line-of-sight between your headset and the uTV is not required. However, interference in the environment by walls or furniture may reduce the operating range.

If the headset moves out of range of the uTV the wireless audio transmission will be terminated. If the headset is then moved back into range of the uTV, it will automatically resume.

It may take up to 10 seconds until the streaming resumes. The Bluetooth streaming light indicator on the uTV (g) should be solid blue during streaming.

If the uTV status light (g)

- is green, make sure TV sound and headset are switched on.
- blinks blue, you are in paused mode. Press the headset main button (b) to resume streaming.

Step 5: Adjusting the volume of the TV signal

First, set the volume of the TV speakers at the level to suit other viewers.

- If the uTV is connected to your TV with the RCA/Cinch cable (i), adjust the volume on the uTV by pressing the +/- volume control (b) and (c).

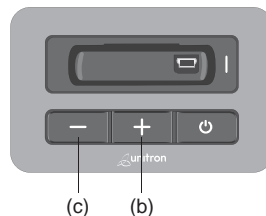

- If your uTV is connected to the headphone socket of your TV, you may also use your TV remote control to adjust volume via the TV directly. Please refer to the TV user guide for more details on setting the TV volume.

 *If your TV is connected to a satellite receiver or a cable box, make sure the volumes of these additional devices are set to a medium level for best audio quality results.*

Step 6: Switching off uTV

To switch off the devices:

- To end the transmission of the TV audio signal, switch off the uTV by pressing the ON/OFF button (a) as shown in fig. 7.

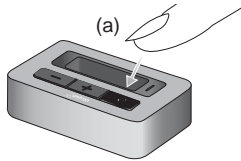



fig. 7

 *If no audio input is available, the uTV automatically stops the Bluetooth audio transmission after 3 minutes. Its status light (g) will turn solid green.*

Declaration of Conformity

Hereby Unitron declares that this uTV meets the requirements of the Radio and Telecommunications Terminal Equipment Directive 1999/5/EC. The full text of the Declaration of Conformity can be obtained from the address below.

Manufacturer:
Unitron Hearing Ltd.
20 Beasley Drive, P.O. Box 9017,
Kitchener, ON N2G4X1 Canada

This device complies with Part 15 of the FCC Rules and with RSS-210 of Industry Canada. Operation is subject to the following two conditions:

- 1.) this device may not cause harmful interference, and
- 2.) this device must accept any interference received, including interference that may cause undesired operation.

Changes or modifications made to this device not expressly approved by Unitron may void the FCC authorization to operate this device.

This equipment has been tested and found to comply with the limits for a Class B digital device, pursuant to part 15 of the FCC/IC rules. These limits are designed to provide reasonable protection against harmful interference in a residential installation. This equipment generates, uses and can radiate radio frequency energy and, if not installed and used in accordance with the instructions, may cause harmful interference to radio communications. However, there is no guarantee that interference will not occur in a particular installation. If this equipment does cause harmful interference to radio or television reception, which can be determined by turning the equipment off and on, the user is encouraged to try to correct the interference by one or more of the following measures:

- Reorient or relocate the receiving antenna.
- Increase the separation between the equipment

and receiver.

- Connect the equipment into an outlet on a circuit different from that to which the receiver is connected.
- Consult the dealer or an experienced radio/TV technician for help.

FCC/IC RF Radiation Exposure Statement

This equipment complies with FCC/IC radiation exposure limits set forth for an uncontrolled environment. End users must follow the specific operating instructions for satisfying RF exposure compliance. This transmitter must not be co-located or operating in conjunction with any other antenna or transmitter.

CE 0678 !

This device is a class 2 device and can be operated in the EU member states without restrictions for indoor use, but must not operated outdoors in France.

Unitron Distributors

CORPORATE OFFICE / INTERNATIONAL

20 Beasley Drive, P.O. Box 9017, Kitchener, ON N2G4X1 Canada

AUSTRALIA

Level 2, Norwest Quay, 21 Solent
Circuit, Baulkham Hills, NSW,
NSW 2153

BELGIUM

Baron de Vironlaan, 60
b-1700 Dilbeek

CANADA

20 Beasley Drive, P.O. Box 9017,
Kitchener, ON N2G4X1

CHINA

No. 78, Qi Ming Road,
Export Processing Zone District B,
Suzhou Industrial Park, P.R. 215021

DENMARK

Nitivej 10, DK-2000 Frederiksberg

EUROPEAN REPRESENTATIVE

Daimlerstrasse 22, 70736
Fellbach-Oeffingen, Germany

FRANCE

5 bis, rue Maryse Bastié - BP 15
69671 Bron Cedex, France

NETHERLANDS

Ir. D.S Tuijnmanweg 10,
4131 PN VIANEN

NEW ZEALAND

10/215 Rosedale Rd., M277 Private
Bag, 300987, Albany, Auckland

SOUTH AFRICA

First Floor - Selborne House,
Fourways Golf Park, Roos Street,
Fourways, Johannesburg

SPAIN

Avenida de la Industria n°13/15,
Polígono de Canastell,
03690 Sant Vicent del Raspeig,
Alicante, España

SWEDEN

Förmansvägen 2, 4 tr
SE-11743, Stockholm, Sweden

UNITED KINGDOM

St. George House, Cygnet Court,
Centre Park, Warrington, Cheshire
WA1 1PD

U.S.A.

Suite A, 2300 Berkshire Lane North,
Plymouth, MN 55441

DISTRIBUTOR



Unitron Hearing Ltd.
20 Beasley Drive, P.O. Box 9017,
Kitchener, ON N2G4X1 Canada

CE 0678  

 unitron™

www.unitron.com

10-035 029-5836-02



 unitron™