



Quick Start Guide

EN



SoundView Indoor Camera

Read me first

At a Glance

Thank you for choosing the [SwannOne SoundView Indoor Camera](#). Please take a moment to familiarize yourself with key areas of the camera.

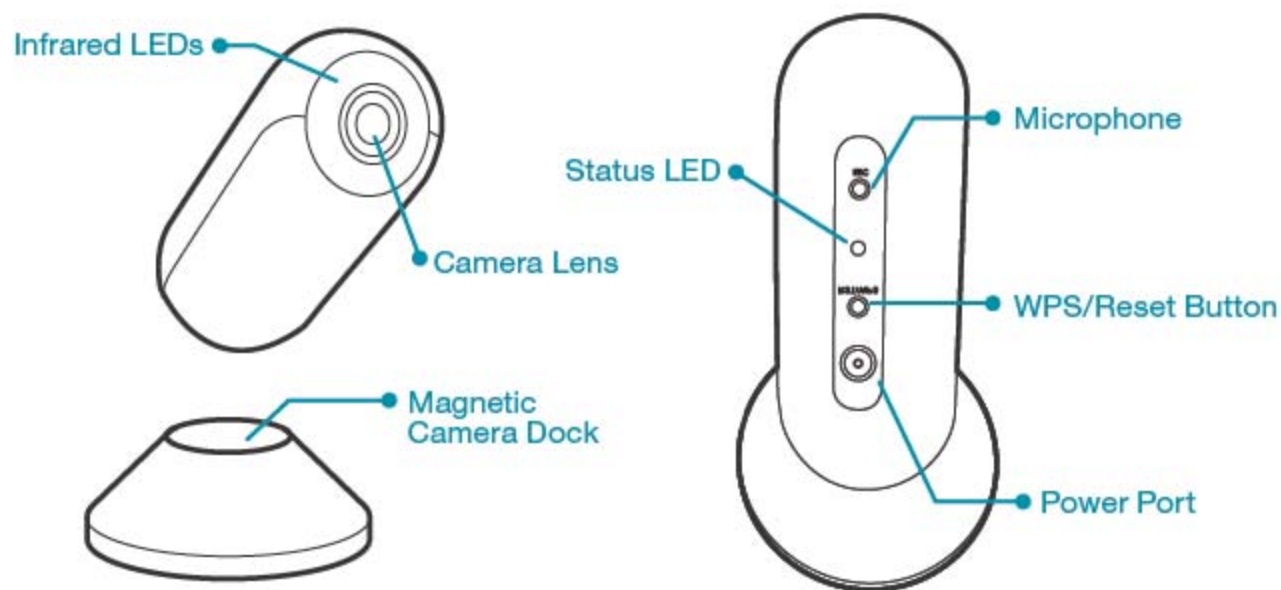

Get Started in Three Easy Steps

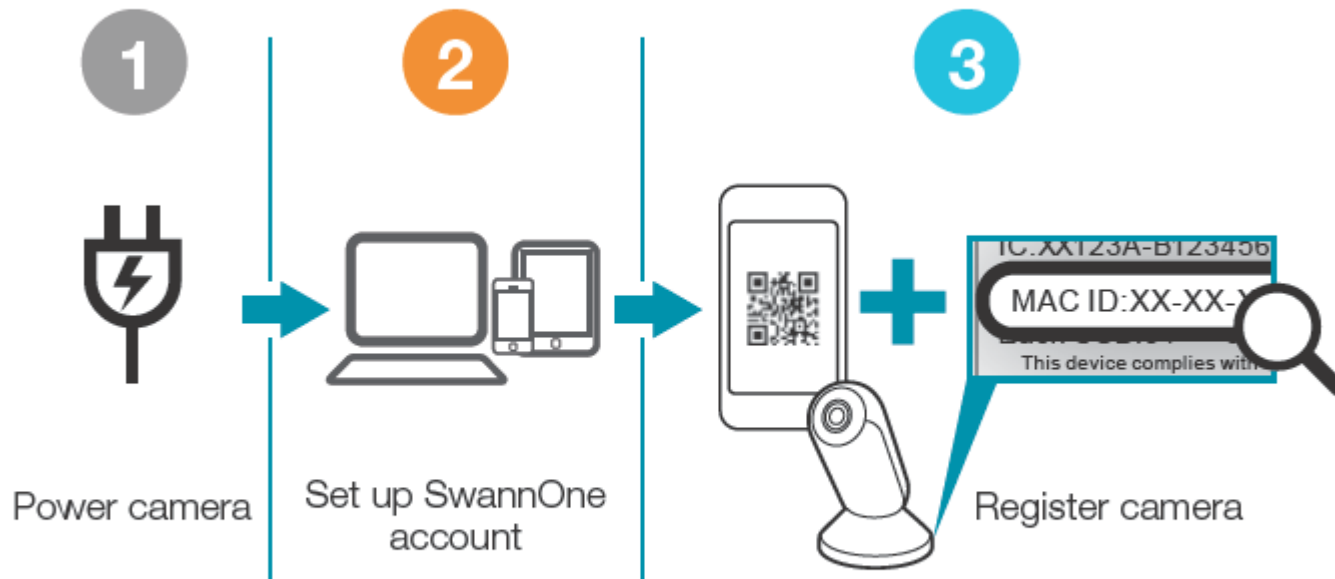

Questions? Please visit swannone.com where you can find answers to frequently asked questions and access tutorials and tips, or simply email us at support@swannone.com.

Discover More SwannOne Smart Home Solutions



These devices comply with part 15 of the FCC Rules. Operation is subject to the following two conditions: (1) These devices may not cause harmful interference, and (2) These devices must accept any interference received, including interference that may cause undesired operation.

QHSWO-SVC01K311014E

© Swann Communications 2015

1 Power Camera

Plug the camera into a wall outlet using the included power adapter and USB cable.

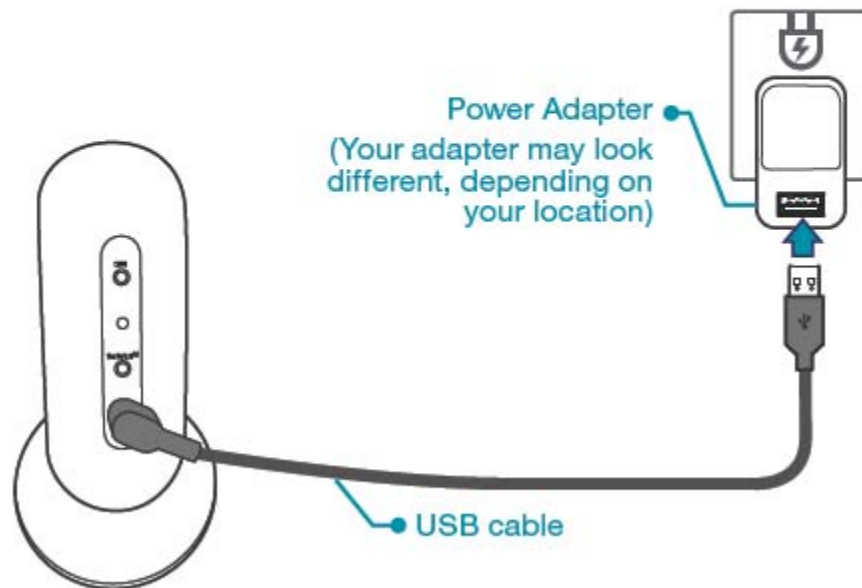

2 Set up SwannOne Account

Creating a SwannOne Account

Before you can view the camera, you will need to create a SwannOne account. Your SwannOne account is what you use to control and manage all your SwannOne devices and services from anywhere.

Go to **home.swannone.com** from your PC, Mac, smartphone or tablet, and follow the instructions on the screen to sign up for a free account.

Downloading the SwannOne App

Once your SwannOne account is created, download the SwannOne App for iOS or Android on your smartphone or tablet from Apple App Store or Google Play.



3 Register Camera

Now that you have your SwannOne account and app ready, getting the camera connected to the Internet using your smartphone is really simple.

1. Launch the SwannOne App and sign in with your account.
2. Follow the on-screen instructions to add the camera to your SwannOne account. During registration, you will be prompted to:
 - configure Wi-Fi network settings
 - scan a unique QR code with the camera
 - enter camera's MAC ID (it's found on the sticker located at the base of the camera dock).



The QR code makes it easy to connect the camera to your wireless network quickly in seconds.



Top Tips

When scanning the QR code, it's best to hold your smartphone at least 10 cm away so the entire QR code can be captured on the camera's view. Guidelines are also printed on the box to show you where to position your smartphone and camera. The camera's Status LED will blink green twice when the QR code is scanned successfully.

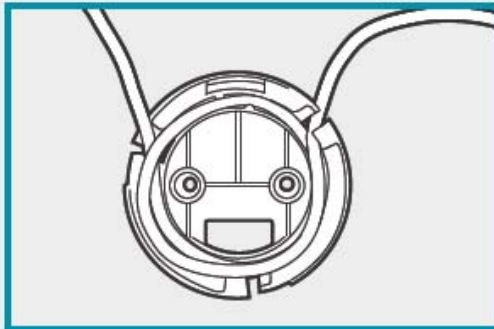
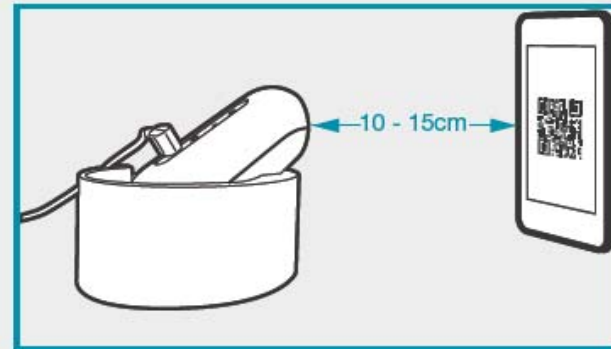

Keep excess USB cable tidy by removing the base of the cameradock and threading the cable around the channels on the inner side of the base. Replace the stand base once cable is neatly routed.

FCC Caution: Any changes or modifications not expressly approved by the party responsible for compliance could void the user's authority to operate this equipment.

This device complies with Part 15 of the FCC Rules. Operation is subject to the following two conditions: (1) This device may not cause harmful interference, and (2) this device must accept any interference received, including interference that may cause undesired operation. This device and its antenna(s) must not be co-located or operating in conjunction with any other antenna or transmitter.

NOTE: This equipment has been tested and found to comply with the limits for a Class B digital device, pursuant to Part 15 of the FCC Rules. These limits are designed to provide reasonable protection against harmful interference in a residential installation. This equipment generates, uses and can radiate radio frequency energy and, if not installed and used in accordance with the instructions, may cause harmful interference to radio communications. However, there is no guarantee that interference will not occur in a particular installation. If this equipment does cause harmful interference to radio or television reception, which can be determined by turning the equipment off and on, the user is encouraged to try to correct the interference by one or more of the following measures:

- Reorient or relocate the receiving antenna.
- Increase the separation between the equipment and receiver.
- Connect the equipment into an outlet on a circuit different from that to which the receiver is connected.
- Consult the dealer or an experienced radio/TV technician for help.