



motorola

VERVEBUDS 300

Frequency Band: 2.402 - 2.480 GHz

Working temperature: -10oC - 45oC

MODEL ID: SH032

Maximum RF power: 6 dBm

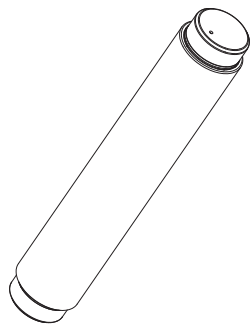

Quick Start Guide

① Charging:

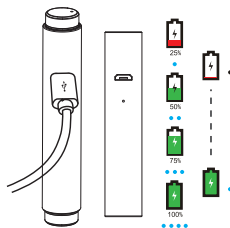

Fully charge before use

The device can be powered through a micro USB from any CE compliant power source that implement the European interface as requested by EN 301 489-52.

② Pairing:

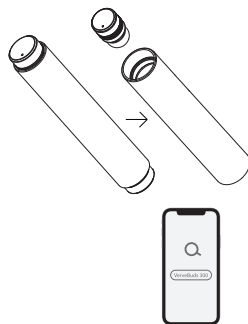

2.1. With both buds in the charging case, take out both endbuds, the LED will flash blue and red.

2.2. Select "VerveBuds 300" from the smartphone Bluetooth menu.

③ Fitting:

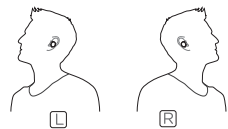

3.1. Insert the VerveBuds into your ear and rotate to fit comfortably

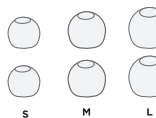

3.2. To optimize the best fit and audio experience, it is recommended to try different earbud sizes.

④ Basic Operation:

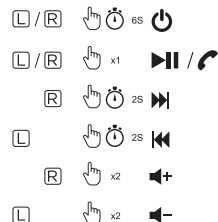
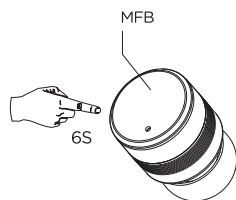

Additional Operation

Factory reset	Switch off both buds, hold the buds for 8 seconds until they flash blue and red. Press the MFB for 7 times, they will flash red and are now it is reset
Reject a call	Double Press MFB
Voice command (Sir/Google/Alexa)	Press MFBx3
LED Indicator	
Pairing	Red-blue flash
Standby	Blue flash
Charging	Red steady
Fully charged	Off
Battery low	Red flash

⑤ Value-added Feature

To use the Left Bud independently as a mono headset.

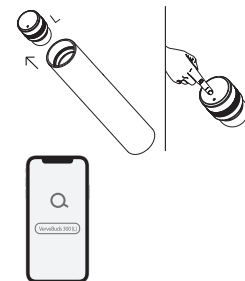

5.1. Take out the L Bud then switch off, hold 6 seconds until they flash blue and red.

5.2. Select "VerveBuds 300(L)"

*Tips: When the VerveBuds are sitting on the case, it will automatically be switched on when taking out. It will automatically be switch OFF when putting back to the case.

*Tips: Both right and left buds can be used as a mono!

This device complies with part 15 of the FCC Rules. Operation is subject to the condition that this device does not cause harmful interference (1) this device may not cause harmful interference, and (2) this device must accept any interference received, including interference that may cause undesired operation.

Changes or modifications not expressly approved by the party responsible for compliance could void the user's authority to operate the equipment.

NOTE: This equipment has been tested and found to comply with the limits for a Class B digital device, pursuant to Part 15 of the FCC Rules. These limits are designed to provide reasonable protection against harmful interference in a residential installation.

This equipment generates, uses and can radiate radio frequency energy and, if not installed and used in accordance with the instructions, may cause harmful interference to radio communications. However, there is no guarantee that interference will not occur in a particular installation.

If this equipment does cause harmful interference to radio or television reception, which can be determined by turning the equipment off and on, the user is encouraged to try to correct the interference by one or more of the following measures:

- Reorient or relocate the receiving antenna.
 - Increase the separation between the equipment and receiver.
 - Connect the equipment into an outlet on a circuit different from that to which the receiver is connected.
 - Consult the dealer or an experienced radio/TV technician for help.
- The device has been evaluated to meet general RF exposure requirement. The device can be used in portable exposure condition without restriction.

FCC ID: VLJ-SH032