

Antenna Info

Radius PPG wireless receiver has below antennas –

Item	Radio Type	Manufacturer	Model Number	Peak Gain (dBi)	Description
1	Near Field Communication [13.56 MHz]	Molex	146236-0101	1	FPC Coil Antenna
2	Bluetooth Low Energy	N/A	N/A	1	Printed inverted-F antenna

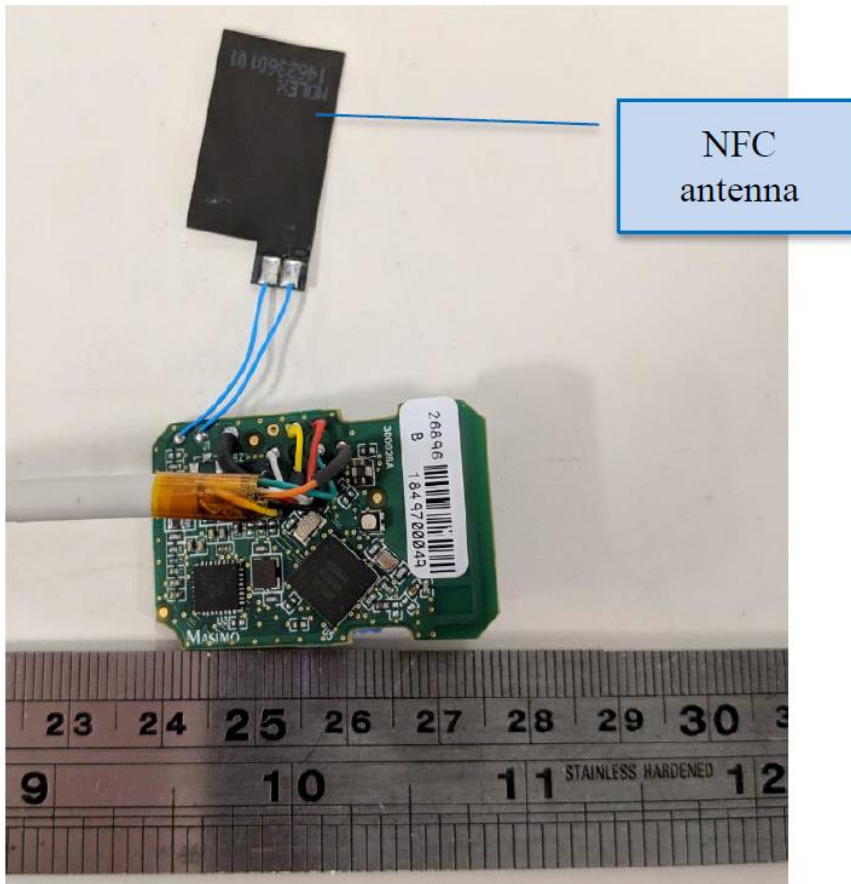

Figure 1: NFC antenna location in Receiver housing

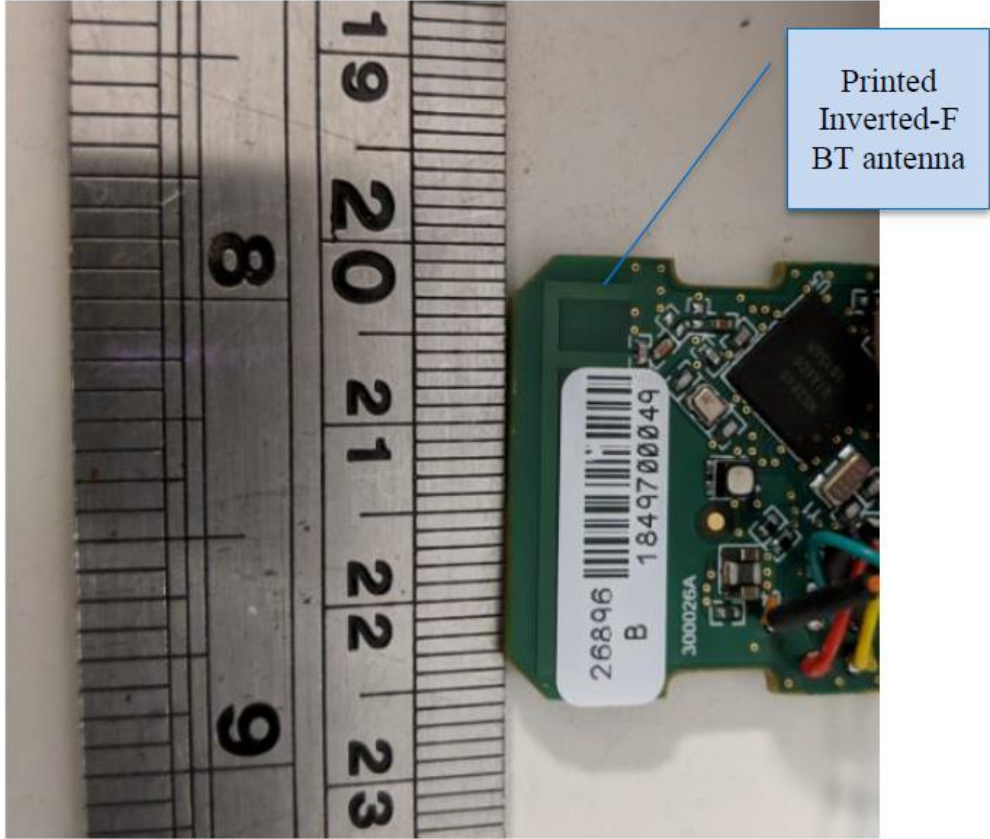

Figure 2: Top Layer of DR-300026 Showing Printed Inverted-F Antenna

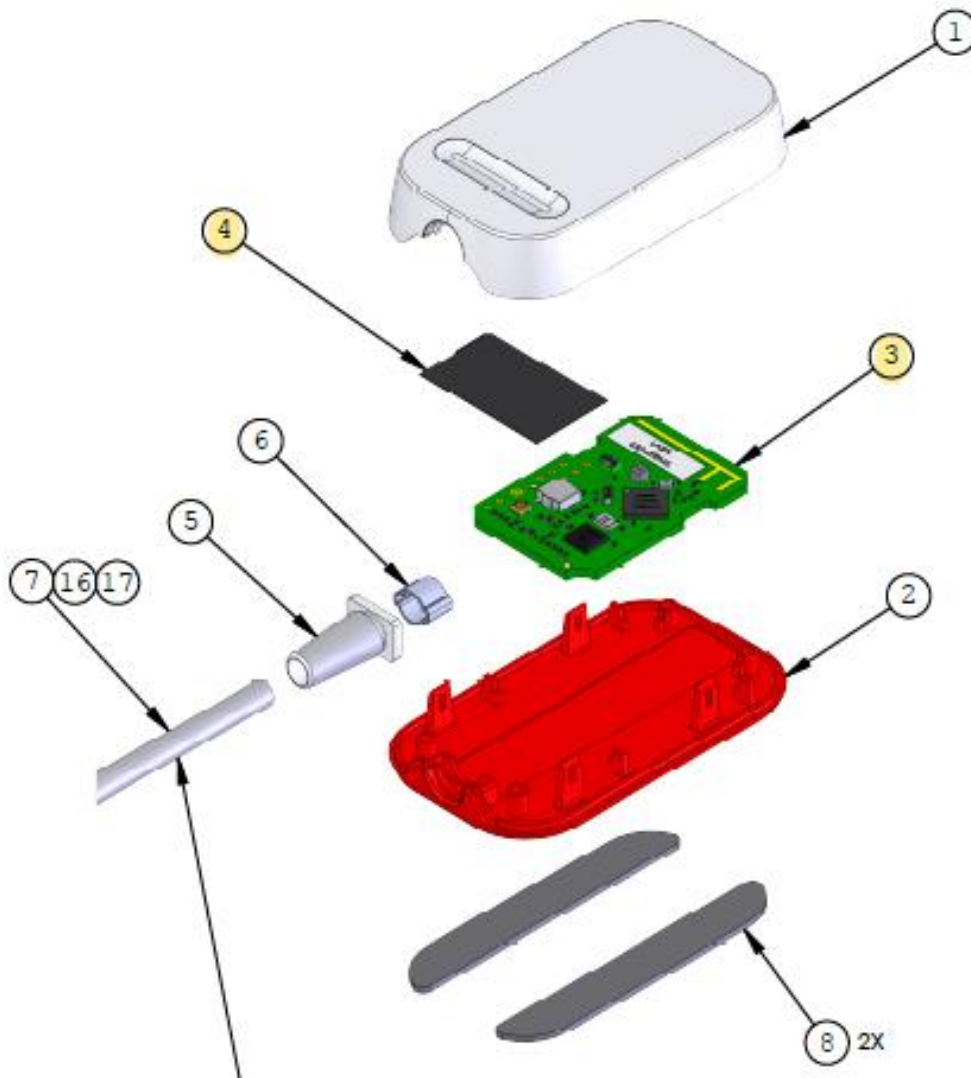

Figure 3: Assembly drawing of Radius PPG wireless receiver showing item # 3 that is Bluetooth antenna and item #4 is NFC antenna, both of these are enclosed in the outer housing indicated by item #1. Both the antennas are permanently attached and are non-replaceable.