

1.1 Labels

Table 10-2 shows the label affixed to the device.

Fig. 10-5 shows the attachment positions for the labels.

Table 10-2: Label types

Name	Position	Shape	Materials
Design label	Main unit front	Fig. 10-1.	ABS resin
Manufacturing control label	Main unit back	Fig. 10-2.	Polyester
FCC label	Main unit back	Fig. 10-3.	Polyester
Battery Pack label	Battery pack back	Fig.10-4.	Polyester

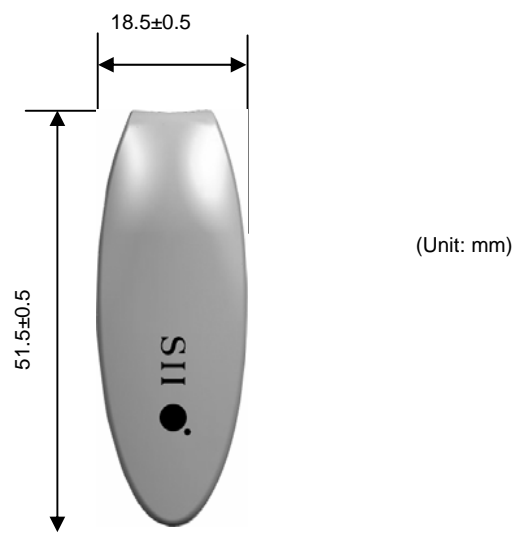

Fig. 10-1.-1: Design label

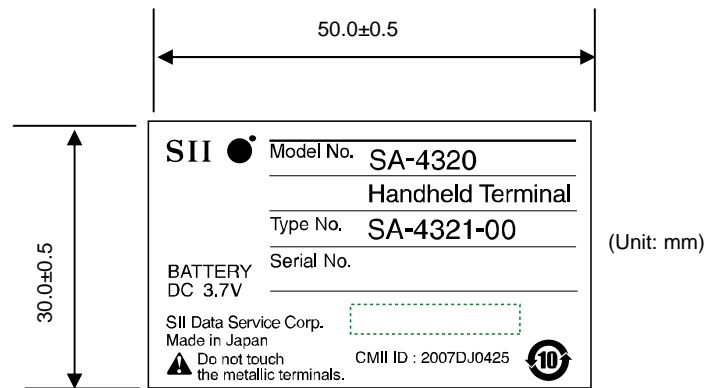

Fig. 10-2: Manufacturing control label

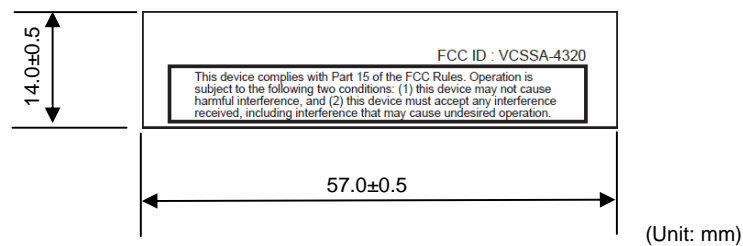

Fig. 10-3: FCC label

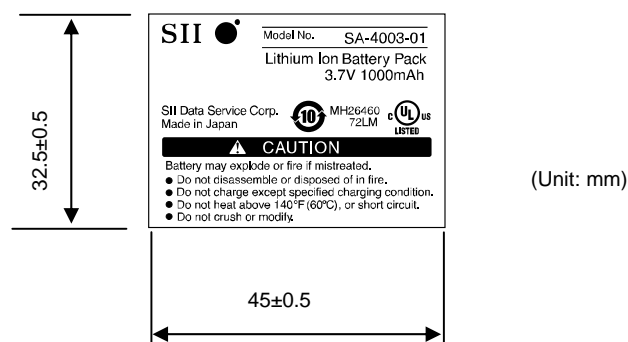

Fig.10-4: Battery pack label

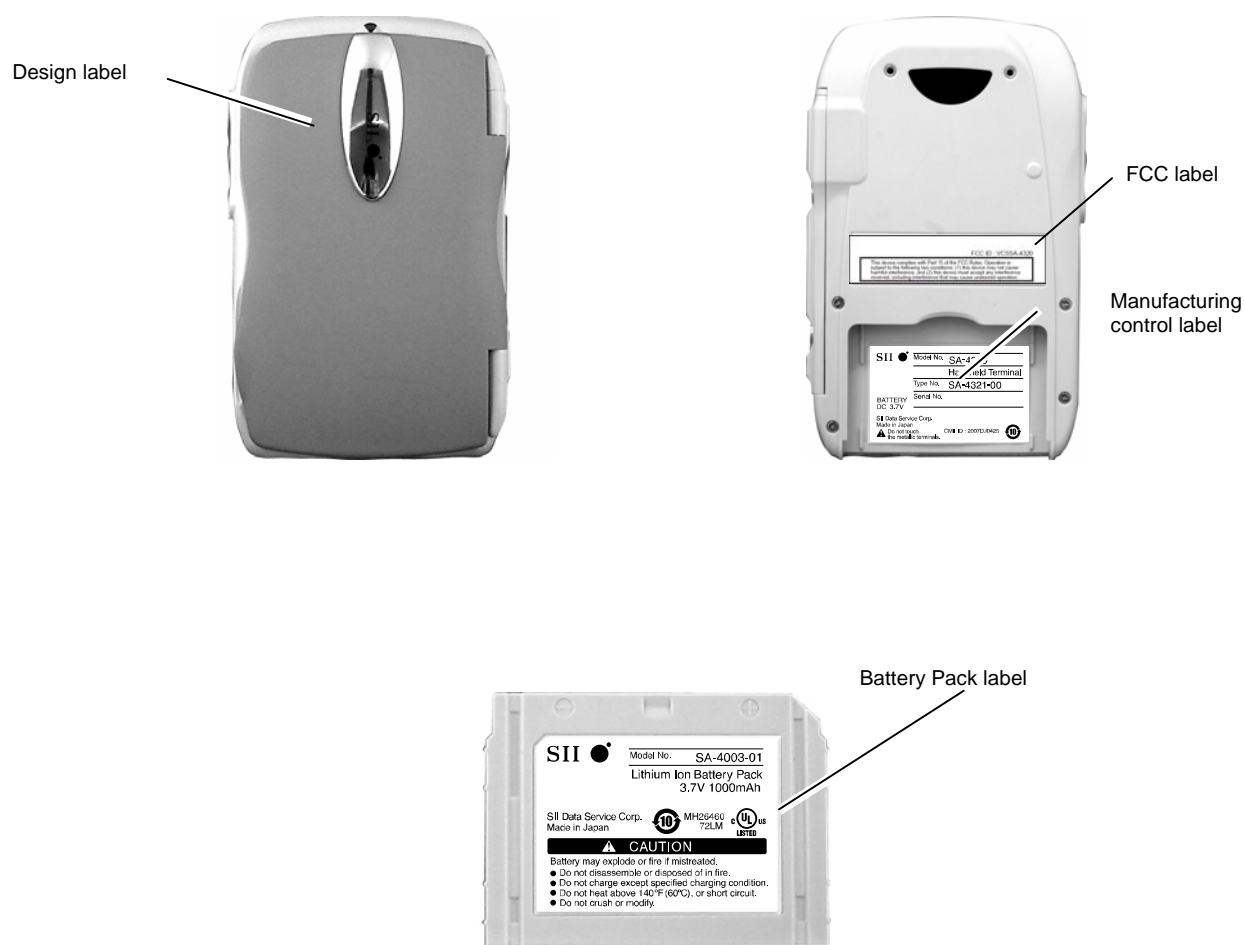

Fig. 10-5: Label attachment positions