

MIGHTY STUNTER

NO. 96105
MADE IN CHINA

INSTRUCTIONS

BATTERY REPLACEMENT:

To replace batteries refer to following directions & illustration:

VEHICLE:

1. Use a Phillips screwdriver to loosen and remove the screw of the battery compartment door as shown.
2. Unlock the battery compartment door and remove the battery compartment.
3. Remove old batteries and replace with 4 new 1.5V "AA" batteries.
4. Cover the battery compartment door and tighten the screw.

TRANSMITTER:

1. Use a Phillips screwdriver to loosen and remove the screw of the battery compartment door as shown.
2. Remove the battery compartment door.
3. Remove old batteries and replace with 1 new "9V" battery.
4. Cover the battery compartment door and tighten the screw.

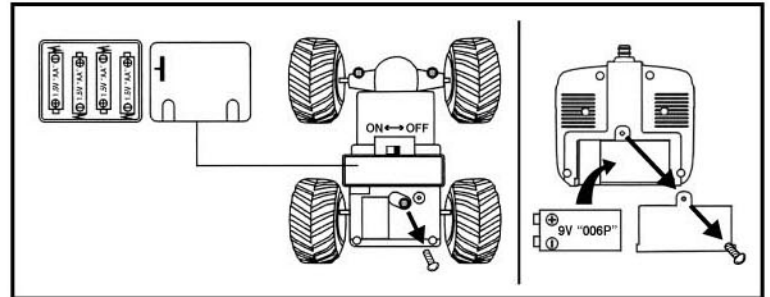

HOW TO OPERATE:

- Install antenna to the transmitter.
- Turn the vehicle and transmitter switch "ON".
- Push speed control stick forwards (upwards) to drive FORWARD.
- Push speed control stick backwards (downwards) to drive BACKWARD.
- Rotate the front wheels to the left or right is controlled by the stunt control stick.

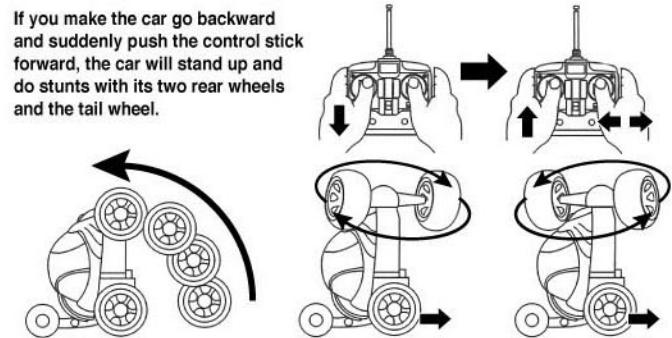
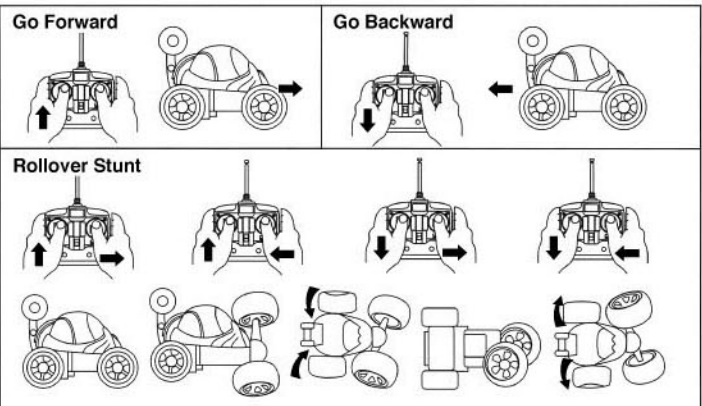
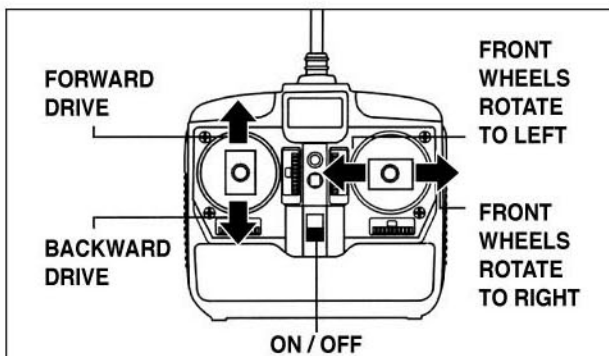

BATTERY CAUTION:

1. Rechargeable batteries are not recommended.
2. Non-rechargeable batteries are not to be recharged.
3. Rechargeable batteries are to be removed from the toy before being charged.
4. Rechargeable batteries are only to be charged under adult supervision.
5. Do not mix alkaline, standard (carbon-zinc), or rechargeable (nickel-cadmium) batteries.
6. Do not mix old and new batteries.
7. Only batteries of the same or equivalent types as recommended are to be used.
8. Batteries are to be inserted with the correct polarity.
9. The supply terminals are not to be short-circuited.
10. If batteries are loose, bend out the contacts for a tight fit.
11. Exhausted batteries are to be removed from the toy and be disposed of immediately; never dispose of batteries in fire.
12. If storing product for long periods of time, make sure to remove batteries.
13. Check the product periodically for signs of damage to electrical parts; do not play with product until damage has been properly assessed.

If the unit malfunctions, please remove the batteries for one minute and reinstall again.

If the malfunctions persist, please replace with new batteries.

BATTERIES SHOULD BE INSTALLED BY ADULTS ONLY.

• Don't forget to remove batteries from the vehicle and transmitter when you have finished operating your vehicle.

All rubber bands, plastic and wire ties, as well as tags, are not part of this toy and should be discarded for your child's safety. Remove wire ties before giving toy to child. Please keep this packaging for future reference. Colors, designs & contents may vary.

NOTE:

THE MANUFACTURER IS NOT RESPONSIBLE FOR ANY RADIO OR TV INTERFERENCE CAUSED BY UNAUTHORIZED MODIFICATIONS TO THIS EQUIPMENT. SUCH MODIFICATIONS COULD VOID THE USER AUTHORITY TO OPERATE THE EQUIPMENT.

NOTE: This equipment has been tested and found to comply with the limits for a Class B digital device, pursuant to Part 15 of the FCC Rules.

These limits are designed to provide reasonable protection against harmful interference in a residential installation. This equipment generates, uses and can radiate radio frequency energy and, if not installed and used in accordance with the instructions, may cause harmful interference to radio communications. However, there is no guarantee that interference will not occur in a particular installation.

If this equipment does cause harmful interference to radio or television reception, which can be determined by turning the equipment off and on, the user is encouraged to try to correct the interference by one or more of the following measures:

- Reorient or relocate the receiving antenna.
- Increase the separation between the equipment and receiver.
- Connect the equipment into an outlet on a circuit different from that to which the receiver is connected.
- Consult the dealer or an experienced radio/TV technician for help.

Any Changes or modifications not expressly approved by the party responsible for compliance could void the user's authority to operate the equipment.

This device complies with part 15 of the FCC Rules. Operation is subject to the following two conditions:

- (1) This device may not cause harmful interference, and (2) this device must accept any interference received, including interference that may cause undesired operation.

