

NOTES:

1. TORQUE SCREWS ITEM 7 TO 2.5 IN-LB (40 IN-OZ).
2. FOR WIRE CONNECTION SEE ASM PROCEDURE 400073-001.

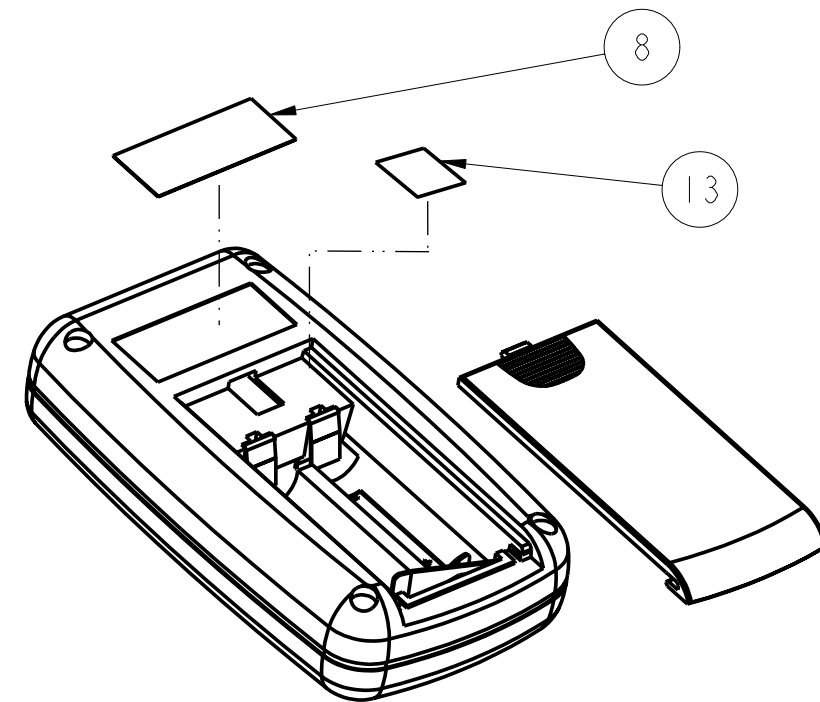

LABEL PLACEMENT AREA

ECO# 2184

UNLESS OTHERWISE SPECIFIED TOLERANCE:		<b>Freedom Scientific</b>	
X.X - ± 0.1		<b>ASM, REMOTE CONTROL</b>	
X.XX - ± 0.01			
X.XXX - ± 0.005		<b>460450-007</b>	
Angle - ± 1.0°		<b>SEE NOTES</b>	
Drawn by: PDT-AGAMI	Date: 01/04/07	Part Number:	REV <b>B</b>
Approved by: W.TUNKIS	Date: 06/13/07	Material / Finish:	Sheet 1 of 1

PART OF  
ITEM 1

\* ALL DIMENSIONS ARE IN INCHES

CONFIDENTIAL: THIS PRINT AND THE DESIGN THEREIN REPRESENTED ARE THE PROPERTY OF FREEDOM SCIENTIFIC AND MAY NOT BE USED IN ANY MANNER DETRIMENTAL TO IT'S INTEREST. THIS PRINT IS ISSUED WITH THE UNDERSTANDING THAT IT WILL NOT BE USED FOR MANUFACTURE FOR OTHERS, AND WILL BE RETURNED UPON REQUEST.