



RUBY® 10

Handheld Video Magnifier
OCR and Touch

Setup and Use

Learn more about the RUBY 10 in *Advanced Features and Functions*, available for download at www.freedomscientific.com/RUBY10 [QR code].

© 2021 Freedom Scientific, Inc. All Rights Reserved. RUBY® is a registered trademark of Freedom Scientific, Inc. in the United States and other countries. Information in this document is subject to change without notice.



Charge and Power On Device

1. Attach a USB-C cable to the left side of the device and to the power adapter.
2. Plug the power adapter into a wall outlet. A full charge takes about 4 hours.
3. Press the orange button above the USB-C port for 3 seconds to power on the RUBY 10. The Freedom Scientific and RUBY 10 splash screens are displayed before going to live view.
4. Briefly press the Power button for sleep mode and to display the battery status. Press the Power button for 7 sec to power off the device.





Power button

Charging LED

Audio jack

USB-C port

Use the Stand

Extend stand

1. Place RUBY 10 in front of you so the screen faces you and the Freedom Scientific logo is below the screen.
2. Hold unit upright with the bottom edge stabilized against a desk.

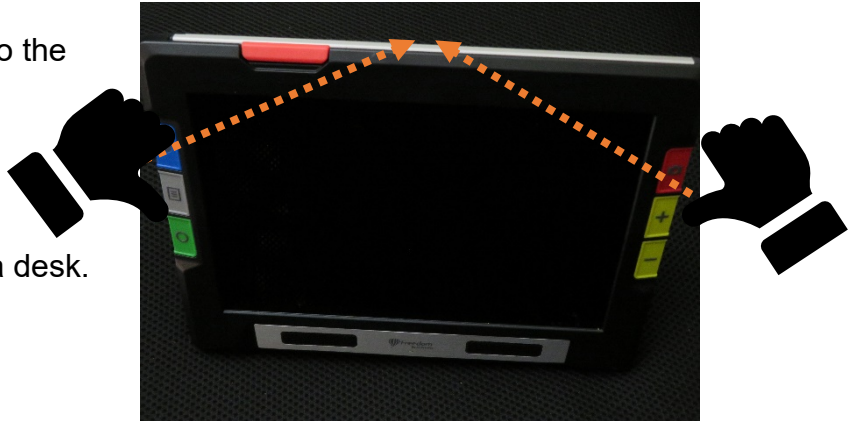

3. Curl your fingers around the unit near the top and push them beneath the edges of the stand.





4. Push out until stand is fully extended and it clicks into place.
5. Gently set the unit down on the stand.

Retract stand

1. Place RUBY 10 in front of you so the screen faces you.
2. Grasp both sides of the unit.
3. Keep your thumbs on the front of the unit to keep it steady.
4. Curl your fingers around unit.
5. Press in on the middle of the stand legs from the outside. The legs will buckle between the feet and the unit.
6. Gently press the stand toward you until it is flush with the unit.

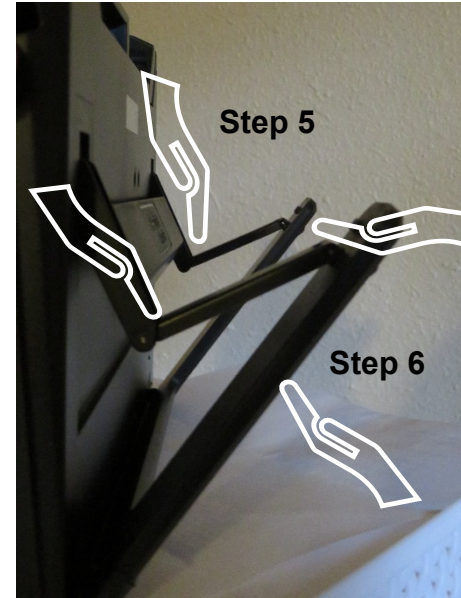

Open Camera Arm

1. Push up on orange tab at top of unit until camera begins to slide out. Show thumb under orange tab and hand wrapped around device.
2. Pull up to extend the camera arm.

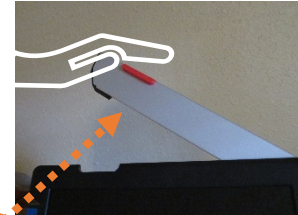



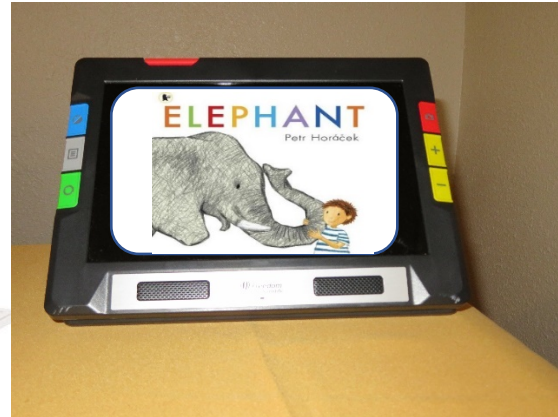

Physical Buttons

Extend stand to easily read a flat book, magazine, or newspaper in live view. Use the buttons on each side of the device to perform basic functions.



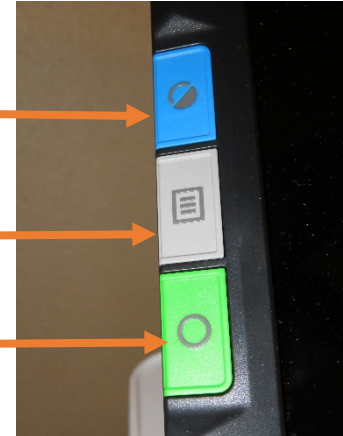

Left side, top to bottom

- 1 **Color mode button**  rotates through configured color combinations
- 2 **Menu button**  opens or closes the button bars
- 3 **Live view button**  makes the camera active so that whatever the camera is pointed at is displayed on the screen



Right side, top to bottom

- 4 **Capture button**  takes a picture of whatever is displayed on the screen or returns to live view. Double press captures, recognizes text and starts reading.
- 5 **Zoom in button**  increases size of image or font size of text, so less of the image or text is shown.
- 6 **Zoom out button**  decreases size of image or font size of text, so more of the image or text is shown.

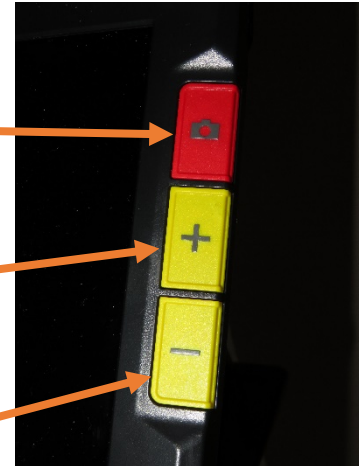

Button names



On-Screen Button Bars

Button Descriptions

Left side, top to bottom:

- 1 Display main menu
- 2 Set brightness level
- 3 Change speaking speed faster or slower
- 4 Change system volume up or down

Right side, top to bottom:

- 1 Turn lights on or off
- 2 Apply reading line or mask
- 3 Set color theme of system menus

Button Names

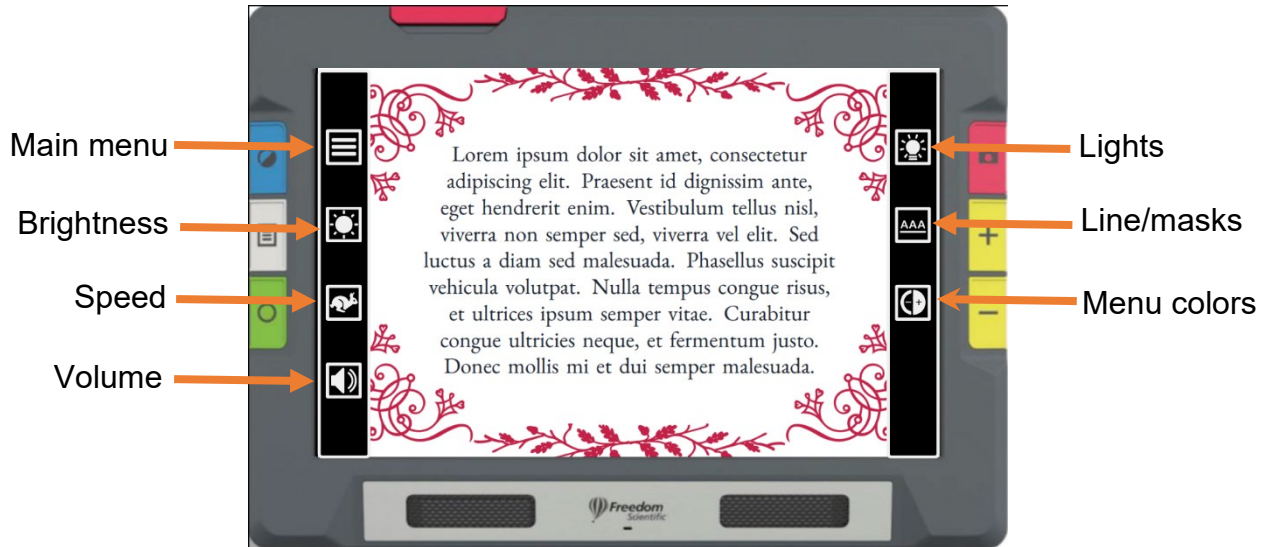

FCC Warning

This device complies with part 15 of the FCC Rules. Operation is subject to the condition that this device does not cause harmful interference.

Any Changes or modifications not expressly approved by the party responsible for compliance could void the user's authority to operate the equipment.

Note: This equipment has been tested and found to comply with the limits for a Class B digital device, pursuant to part 15 of the FCC Rules. These limits are designed to provide reasonable protection against harmful interference in a residential installation. This equipment generates uses and can radiate radio frequency energy and, if not installed and used in accordance with the instructions, may cause harmful interference to radio communications. However, there is no guarantee that interference will not occur in a particular installation. If this equipment does cause harmful interference to radio or television reception, which can be determined by turning the equipment off and on, the user is encouraged to try to correct the interference by one or more of the following measures:

- Reorient or relocate the receiving antenna.
- Increase the separation between the equipment and receiver.
- Connect the equipment into an outlet on a circuit different from that to which the receiver is connected.
- Consult the dealer or an experienced radio/TV technician for help.

IC Warning

This device complies with Industry Canada's licence-exempt RSSs. Operation is subject to the

following two conditions:

- (1) This device may not cause interference; and
- (2) This device must accept any interference, including interference that may cause undesired operation of the device.

Cet appareil est conforme aux CNR exemptes de licence d'Industrie Canada. Son

fonctionnement est soumis aux deux conditions suivantes :

- (1) Ce dispositif ne peut causer d'interférences ; et
- (2) Ce dispositif doit accepter toute interférence , y compris les interférences qui peuvent causer un mauvais fonctionnement de l'appareil.

RF Exposure Information and Statement

The SAR limit of USA (FCC/ISED) is 1.6 W/kg averaged over one gram of tissue. Device types: Ruby 10 (FCC ID: VC2-RUBY10/IC: 8923A-RUBY10) has also been tested against this SAR limit. The highest SAR value reported under this standard during product certification for properly worn on the body is FCC: 0.166 W/kg/ ISED:0.389W/kg. This device was tested for typical body-worn operations with the back of the handset kept 0mm from the body. To maintain compliance with FCC/ISED RF exposure requirements, use accessories that maintain a 0mm separation distance between the user's body and the back of the handset. The use of belt clips, holsters and similar accessories should not contain metallic components in its assembly. The use of accessories that do not satisfy these requirements may not comply with FCC/ISED RF exposure requirements, and should be avoided.

La limite DAS des États-Unis (FCC/ISED) est de 1,6 W/kg en moyenne sur un gramme de tissu. Types d'appareils : Ruby 10 (FCC ID: VC2-RUBY10/IC: 8923A-RUBY10) a également été testé par rapport à cette limite SAR. La valeur SAR la plus élevée signalée en vertu de cette norme lors de la certification du produit pour un port correct sur le corps est de FCC: 0.166 W/kg/ ISED:0.389W/kg.. Cet appareil a été testé pour des opérations typiques portées sur le corps avec l'arrière du combiné à 0 mm du corps. Pour maintenir la conformité aux exigences d'exposition RF FCC/ISED, utilisez des accessoires qui maintiennent une distance de séparation de 0 mm entre le corps de l'utilisateur et l'arrière du combiné. L'utilisation de clips de ceinture, d'étuis et d'accessoires similaires ne doit pas contenir de composants métalliques dans son assemblage. L'utilisation d'accessoires qui ne satisfont pas à ces exigences peut ne pas être conforme aux exigences d'exposition RF de la FCC/ISED et doit être évitée.

Body-worn Operation

This device was tested for typical body-worn operations. To comply with RF exposure requirements, a minimum separation distance of 0mm must be maintained between the user's body and the handset, including the antenna. Third-party belt-clips, holsters, and similar accessories used by this device should not contain any metallic components. Body-worn accessories that do not meet these requirements may not comply with RF exposure requirements and should be avoided. Use only the supplied or an approved antenna.

Cet appareil a été testé pour un fonctionnement typique du corps sous pression, pour satisfaire aux exigences relatives à l'exposition RF, une distance minimale de séparation de 0mm doit être maintenue entre le corps de l'utilisateur et la poignée. Y compris les antennes, les bandes de fréquences et les satellites, Des accessoires similaires utilisés par cet appareil ne doivent pas contenir de composants métalliques. Seule la fourniture ou une antenne agréée.