

CLEANING AND MAINTAINING

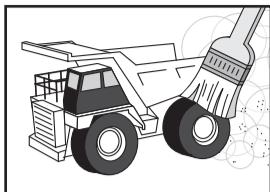

Brush areas where dirt and dust get trapped.

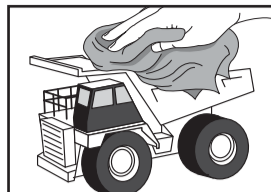

Wipe body off with a soft rag or tact cloth.

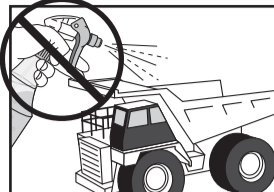

Do not clean machine with chemicals or water.

FEDERAL COMMUNICATIONS COMMISSION COMPLIANCE

NOTE:

This device complies with Part 15 of the FCC Rules. Operation is subject to the following two conditions:

- (1) this device may not cause harmful interference, and
- (2) this device must accept any interference received, including interference that may cause undesired operation.

Warning: Changes or modifications to this unit not expressly approved by the party responsible for compliance could void the user's authority to operate the equipment. NOTE: This equipment has been tested and found to comply with the limits for a Class B digital device, pursuant to Part 15 of the FCC Rules. These limits are designed to provide reasonable protection against harmful interference in a residential installation.

This equipment generates, uses and can radiate radio frequency energy and, if not installed and used in accordance with the instructions, may cause harmful interference to radio communications. However, there is no guarantee that interference will not occur in a particular installation. If this equipment does cause harmful interference to radio or television reception, which can be determined by turning the equipment off and on, the user is encouraged to try to correct the interference by one or more of the following measures:

- Reorient or relocate the receiving antenna.
- Increase the separation between the equipment and receiver.
- Connect the equipment into an outlet on a circuit different from that to which the receiver is connected.
- Consult the dealer or an experienced radio/TV technician for help.

MANUFACTURER'S NOTE

"Modifications not authorized by the manufacturer may void users authority to operate the device."

ATTENTION PARENTS

This toy and all accessories need to be periodically examined for potential hazards and any potentially hazardous parts be repaired or replaced.

www.toystate.com

For questions, e-mail our Consumer Service Dept. at consumerservice@toystate.com
Or Call 1-877-473-8015



MADE IN SHENZHEN, CHINA
TOY STATE INTERNATIONAL LIMITED
1 PEKING ROAD, KOWLOON, HONG KONG



IN THE INTEREST OF BETTER QUALITY AND VALUE, WE ARE CONSTANTLY IMPROVING AND UPDATING OUR PRODUCTS. CONSEQUENTLY, PICTURES IN THIS INSTRUCTION SHEET MAY SOMETIMES DIFFER FROM THE MODEL ENCLOSED.



© 2012 Caterpillar CAT, CATERPILLAR, their respective logos, EQUIPPED TO PLAY, and "Caterpillar Yellow" and the "Power Edge" trade dress as well as corporate and product identity used herein, are trademarks of Caterpillar and may not be used without permission. www.cat.com www.caterpillar.com Toy State, a licensee of Caterpillar Inc.



www.toystate.com



RADIO CONTROL Lil' Worker R/C

OWNER'S MANUAL



CONTROLLER
AAA/R3 x3
Batteries Not Included

MACHINE
AAA/R3 x3
Included



GETTING STARTED

Remove the R/C machine and controller from the package. Replace batteries in the R/C machine and insert batteries into the controller to begin R/C play (see "Battery Installation" section for further details).

CAUTION

Important Battery Information

- Dispose of batteries properly.
- Do not dispose of batteries in fire.
- Use only batteries of the type recommended.
- Do not mix alkaline, standard (carbon-zinc) or rechargeable (nickel-cadmium) batteries.
- Do not mix old and new batteries.
- Remove batteries from R/C machine and controller if machine will not be used for a long period of time.

BATTERY INSTALLATION

CONTROLLER

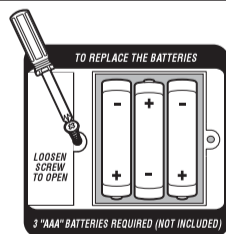

1. To remove battery cover, loosen screw to open.
2. Insert 3 "AAA" batteries into the controller. Be sure the + and - are properly matched.

R/C MACHINE

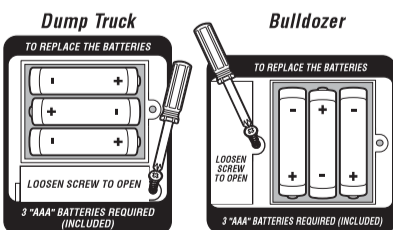

1. To remove battery cover, loosen screw to open.
2. Replace 3 "AAA" batteries in the machine with new batteries. Be sure the + and - are properly matched.

NOTE: For best performance, always use alkaline batteries only.



STRONG BATTERY MEANS OPTIMUM PERFORMANCE
Save the battery by turning off machine when not in use.

OPERATING R/C MACHINE



Switch DEMO/OFF/PLAY switch located on bottom of R/C machine to the PLAY position (as shown)



Press red button on top of machine to activate

Push upward facing arrow for forward drive
Dump Truck bed and Bulldozer blade lower.

Push downward facing arrow for reverse drive
Dump Truck Bed and Bulldozer blade lift.



After play, always turn machine off. Remove batteries from controller and R/C machine when not in use or when storing. Leakage may occur and cause damage if left for a long period of time.



Forward driving with lowering action!

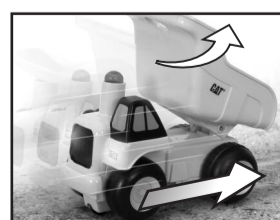

Reverse driving with lifting action!



TROUBLESHOOTING AND CARE FOR R/C MACHINE

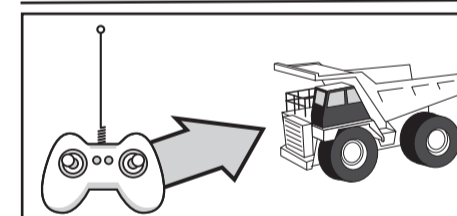

LIMITED RADIO CONTROL RANGE
While R/C machine may be visible at a distance, full operational control may be lost. Hold controller high in the air and direct machine back.

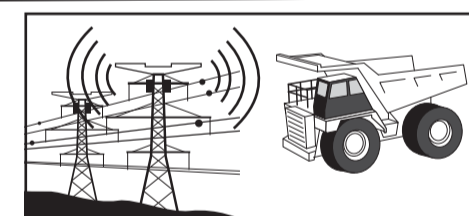

INTERFERENCE
Other radio signals may cause loss of control. Remove machine from an area of interference.

R/C MACHINE DOES NOT MOVE	<ul style="list-style-type: none"> • Are the + and - contacts correctly matched in the controller? • Are the metal contact tabs touching, rusty or dirty in controller? • Are there batteries in the machine and controller? • Is the power switch turned on? • Are the batteries weak or out of power?
R/C MACHINE MOVES BY ITSELF	<ul style="list-style-type: none"> • There is radio interference in the area. • Another R/C machine with the same frequency is close by.
R/C MACHINE RUNS SLOWLY	<ul style="list-style-type: none"> • There is radio interference in the area. • Another R/C machine with the same frequency is close by. • Are the batteries weak or out of power?
PERFORMANCE DROP, INCONSISTENT MOVEMENT OR FAILS TO RUN	Check batteries. If necessary, replace the batteries in the R/C machine and controller with new alkaline batteries.

TREAT YOUR R/C MACHINE WELL

Radio waves control the R/C machine. Care for your machine and it will provide hours of fun!
Avoid water, heat, sand and high impact crashes!

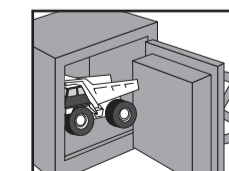

Store in safe place.

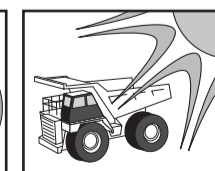

No direct sunlight.

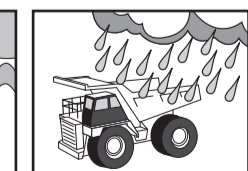

No rain or water.

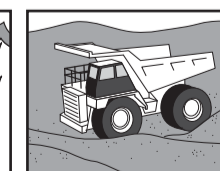

No sand or dust.

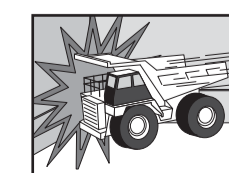

No Collisions.

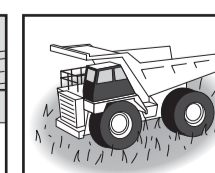

R/C machine may get stuck on carpet or grass.

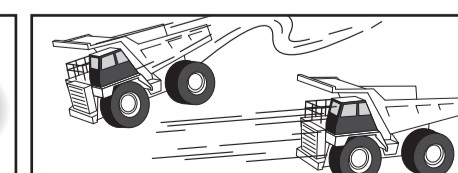

Avoid running 2 machines with the same radio control frequencies.