

Due to limited space on product for marking, the following statements are included in the product user manual:

This device complies with Part 15 of the FCC Rules.

Operation is subject to the following two conditions:
(1) This device may not cause harmful interference, and
(2) this device must accept any interference received, including interference that may cause undesired operation.

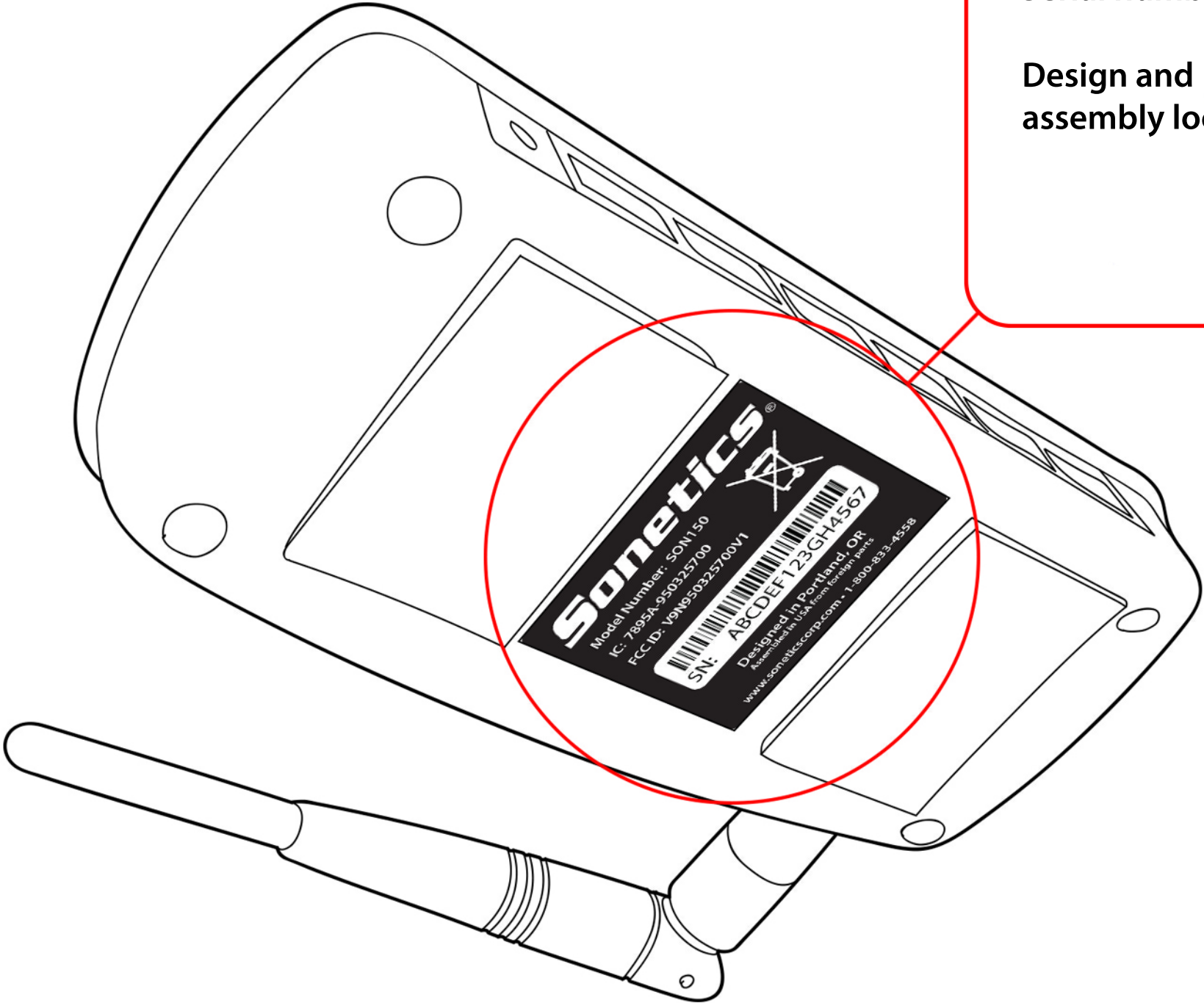

Manufacturer Name

Model number

IC

FCC ID Number

Serial number barcode

Design and assembly location

Sonetics®

Model Number: SON150

IC: 7895A-950325700

FCC ID: V9N950325700V1

SN: ABCDEF123GH4567

Designed in Portland, OR
Assembled in USA from foreign parts

www.soneticscorp.com • 1-800-833-4558

Crossed out garbage bin

Product serial number

Due to limited space on product for marking, the following statements are included in the product user manual:

This device complies with Industry Canada license-exempt RSS standard(s).

Operation is subject to the following two conditions:
(1) this device may not cause interference, and
(2) this device must accept any interference, including interference that may cause undesired operation of the device.

Ce dispositif est conforme à la norme CNR d'Industrie Canada applicable aux appareils radio exempts de licence.

Son fonctionnement est sujet aux deux conditions suivantes:
(1) le dispositif ne doit pas produire de brouillage préjudiciable, et
(2) ce dispositif doit accepter tout brouillage reçu, y compris un brouillage susceptible de provoquer un fonctionnement indésirable.