



# OPERATION GUIDE



## Operating Ways Diagram

Mode (1)	Mode (1)	Remote Controller / Mode (1)
Up and Down Control (CH <sub>1</sub> ) Apply for Helicopter	<p>Climbing ↑</p> <p>Falling ↓</p>	
Left & Right Turning Control (CH <sub>2</sub> ) Apply for Helicopter	<p>Right Turning</p> <p>Left Turning</p>	

Remark: There are two modes in remote controller. ① The throttle control is on the left side. ② The other mode is on the right side.

5

## 直升飞机结构图

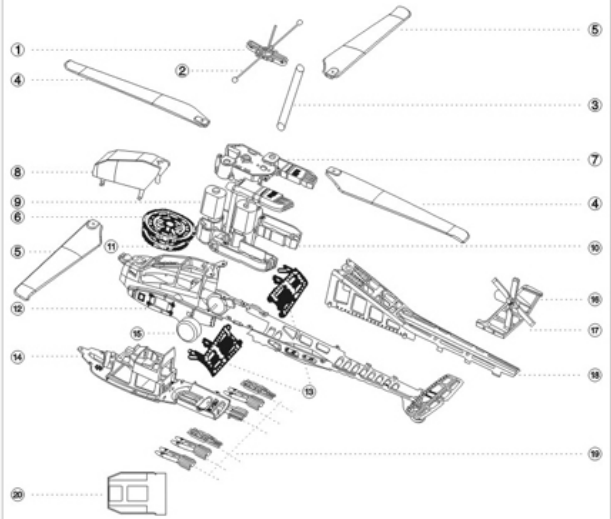

6



# 零件目录表



编号	数量	名称	编号	数量	名称
①	1	上旋翼头	⑳		
②	1	平衡杆	㉑		
③	1	外轴	㉒		
④	2	主旋翼 (A)	㉓		
⑤	2	主旋翼 (B)	㉔		
⑥	1	外轴齿轮	㉕		
⑦	1	上机身架	㉖		
⑧	1	挡风玻璃	㉗		
⑨	2	主马达	㉘		
⑩	1	下机身架	㉙		
⑪	1	内轴齿轮	㉚		
⑫	1	底盘支架	㉛		
⑬	1	导弹挂架	㉜		
⑭	1	驾驶舱与电池架	㉝		
⑮	2	轮胎	㉞		
⑯	1	垂直尾翼	㉟		
⑰	2	尾旋翼	㊱		
⑱	1	尾架	㊲		
㉑	6	导弹	㊳		
㉒	1	电池盒	㊴		
㉓			㊵		
㉔			㊶		
㉕			㊷		
㉖			㊸		
㉗			㊹		
㉘			㊺		
㉙			㊻		
㉚			㊼		
㉛			㊽		
㉜			㊾		
㉝			㊿		
㉞					
㉟					
㊱					
㊲					
㊳					
㊴					
㊵					
㊶					
㊷					
㊸					
㊹					
㊺					
㊻					
㊼					
㊽					
㊾					
㊿					

7



## PROFILE OF APACHE HELICOPTER



VOGUE R/C Model Helicopter copies and reduces Apache AH-64 L ONGBOW Helicopter. It can copy its suspending action, left & right awing basic actions and so on. It is designed with the same axis and double propellers reverse. Up propeller can balance the fuselage when it makes raise force. Down propeller can make the different speed when it makes raise force. The same axis and the double propellers reverse design will balance out the torsion so that the helicopter can fly more steadily and agilely. It is adopted high strength and quality material. It copies the real fuselage design. It has a good appearance with good ability to resist falling.



## THE GUIDE OF THE REMOTE CONTROLLER

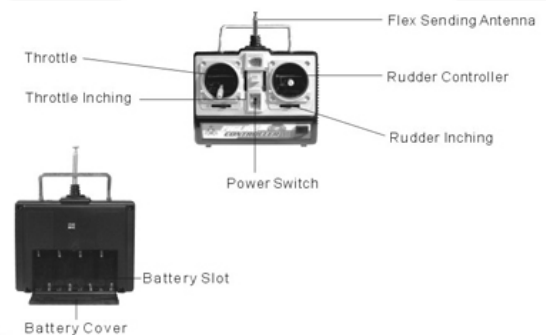

4