



Quick Installation Guide

AX300 Wireless USB Adapter
W311M1 / U2

Package contents

- Wireless USB Adapter x 1
- Quick Installation Guide x 1

Please read this guide before you start with the quick setup upon the first use.
This guide instructs how to install and connect the device. For more information, such as the description of symbols displayed on relevant materials, please visit www.tenda.com or scan the **Product Documents** QR code of this guide.
The product name and model are specified on the label of the device. **W311M1** is used for illustrations here unless otherwise specified. The actual product prevails.

Install the wireless USB adapter

Tips
If a wireless adapter has already been installed on your computer before, please uninstall the existing wireless adapter driver first. For detailed steps, see **Scenario 2** in **Appendix**.

1. Connect your wireless USB adapter to a USB port on your computer. W311M1 is used as an example in the following figure.

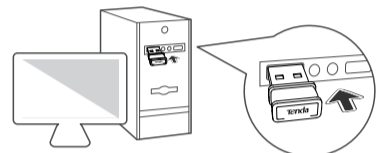

Note
This driver-free wireless USB adapter is compatible with mainstream operating systems, including Windows 7/10/11/Linux.

2. Double-click **Setup.exe** in the pop-up window, and then install the wireless USB adapter according to the prompts.

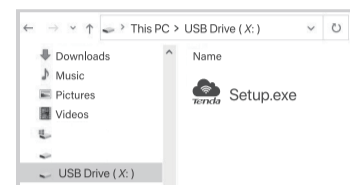

Tips
If the pop-up window does not appear, refer to **Q2** in **FAQ**.

Wait a moment until the initialization finishes. Now you can connect to the Wi-Fi network.



Connect to a Wi-Fi network

1. Click in the lower-right corner of the desktop, select the desired Wi-Fi network, and then click **Connect**.



2. If the wireless network is encrypted, enter its wireless password, click **Next**, and then follow the system prompts.

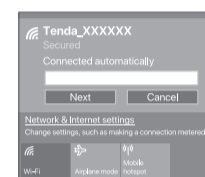

Connected successfully.

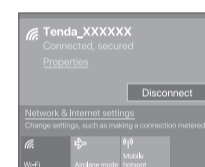

FAQ

Q1. I cannot use the wireless USB adapter after it is installed into Windows 11. What should I do?

- A1. Refer to the following steps:
1. Refer to **Scenario 2** in **Appendix** to uninstall the existing wireless USB adapter driver.
 2. Re-plug the wireless USB adapter and ignore the installation prompts.
 3. Visit tenda.com to download the latest program for this wireless USB adapter to your local computer and unzip it.
 4. Double-click **Setup.exe** to install. You can connect to the Wi-Fi network after the program is installed successfully.

Q2. If the pop-up window does not appear after the wireless USB adapter is connected to the computer. What should I do?

- A2. Refer to the following steps (Example: Windows 10):
1. Double-click **Computer** or on the desktop.
 2. Double-click **USB Drive (X:)** to install.

Safety Precautions

Before performing an operation, read the operation instructions and precautions to be taken, and follow them to prevent accidents. The warning and danger items in other documents do not cover all the safety precautions that must be followed. They are only supplementary information, and the installation and maintenance personnel need to understand the basic safety precautions to be taken.

- Do not use the device in a place where wireless devices are not allowed.
- Operating environment: Temperature: 0°C - 40°C; Humidity: (10% - 90%) RH, non-condensing; Storage environment: Temperature: -40°C - 70°C; Humidity: (5% - 90%) RH, non-condensing.
- Keep the device away from water, fire, high electric field, high magnetic field, and inflammable and explosive items.
- Unplug this device during lightning storms or when the device is unused for long periods.
- If such phenomena as smoke, abnormal sound or smell appear when you use the device, immediately stop using it and contact the after-sales service personnel.
- Disassembling or modifying the device or its accessories without authorization voids the warranty, and might cause safety hazards.

Appendix

Scenario 1:

Disable the wireless USB adapter that comes with the computer (Example: Windows 11)

1. Click or in the lower-right corner of the desktop, and select **Network and Internet Settings**.
2. Click **Wi-Fi** on the left column, and then click **Change adapter options**.
3. Find and right-click the wireless network adapter that comes with the computer, and click **Disable**.

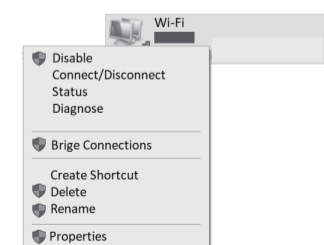

Tips
If you want to use the self-provided network adapter of the computer again, you can refer to the above steps to enable.

Scenario 2:

Uninstall the existing wireless adapter driver on your computer. (Example: Windows 10)

1. Click and click **Settings**.
2. Click **Apps**.
3. Target and click the wireless USB adapter program you want to uninstall, and click **Uninstall**.

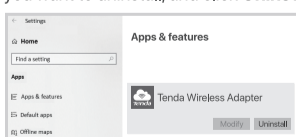
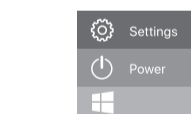

Get support and services

Scan the **Product Documents** QR code to get related documents for more information.



Product Documents
(such as datasheet and user guide)

Tips
The specific product model can be found on the label of the device.



CE Mark Warning

This is a Class B product. In a domestic environment, this product may cause radio interference, in which case the user may be required to take adequate measures.
NOTE: (1) The manufacturer is not responsible for any radio or TV interference caused by unauthorized modifications to this equipment. (2) To avoid unnecessary radiation interference, it is recommended to use a shielded RJ45 cable.

Declaration of Conformity

Hereby, SHENZHEN TENDA TECHNOLOGY CO., LTD. declares that the device is in compliance with Directive 2014/53/EU. The full text of the EU declaration of conformity is available at the following internet address:
<https://www.tenda.com/download/list-9.html>
Operating Frequency: EU/2400-2483.5MHz; (CH1-CH13)
EIRP Power (Max.): 20dBm
Software Version: V1.0.0.X



RECYCLING

This product bears the selective sorting symbol for Waste electrical and electronic equipment (WEEE). This means that this product must be handled pursuant to European directive 2012/19/EU in order to be recycled or dismantled to minimize its impact on the environment.
User has the choice to give his product to a competent recycling organization or to the retailer when he buys a new electrical or electronic equipment.



FCC Statement

This equipment has been tested and found to comply with the limits for a Class B digital device, pursuant to Part 15 of the FCC Rules. These limits are designed to provide reasonable protection against harmful interference in a residential installation. This equipment generates, uses and can radiate radio frequency energy and, if not installed and used in accordance with the instructions, may cause harmful interference to radio communications. However, there is no guarantee that interference will not occur in a particular installation. If this equipment does cause harmful interference to radio or television reception, which can be determined by turning the equipment off and on, the user is encouraged to try to correct the interference by one or more of the following measures:
—Reorient or relocate the receiving antenna.
—Increase the separation between the equipment and receiver.
—Connect the equipment into an outlet on a circuit different from that to which the receiver is connected.
—Consult the dealer or an experienced radio/TV technician for help.
Operation is subject to the following two conditions: (1) this device may not cause harmful interference, and (2) this device must accept any interference received, including interference that may cause undesired operation.

Radiation Exposure Statement

This device has been tested and comply with FCC Body SAR limits at 5mm distance.

Caution:
Any changes or modifications not expressly approved by the party responsible for compliance could void the user's authority to operate this equipment.

This transmitter must not be co-located or operating in conjunction with any other antenna or transmitter.
Operating frequency: 2412-2462 MHz
NOTE: (1) The manufacturer is not responsible for any radio or TV interference caused by unauthorized modifications to this equipment. (2) To avoid unnecessary radiation interference, it is recommended to use a shielded RJ45 cable.



Technical Support

Shenzhen Tenda Technology Co., Ltd.
Floor 6-8, Tower E3, No.1001, Zhongshanyuan Road,
Nanshan District, Shenzhen, China. 518052
Website: www.tenda.com
E-mail: support@tenda.com

Copyright

© 2023 Shenzhen Tenda Technology Co., Ltd. All rights reserved.
Tenda is a registered trademark legally held by Shenzhen Tenda Technology Co., Ltd. Other brand and product names mentioned herein are trademarks or registered trademarks of their respective holders. Specifications are subject to change without notice.

V1.0 Keep for future reference.