

Quick Installation Guide

Wi-Fi 6 Router
 RX12L/TX12L/RX12L Pro/TX12L Pro/
 RX2L/TX2L/RX2L Pro/TX2L Pro

Package Contents

- Wireless router x 1
- Power adapter x 1
- Ethernet cable x 1
- Quick installation guide

RX12L Pro is used for illustrations here unless otherwise specified. The actual product prevails.

Scenario 1: Set up the Device as a Router

I. Connect the Router

The product appearance may vary with models. Please refer to the product you purchased.

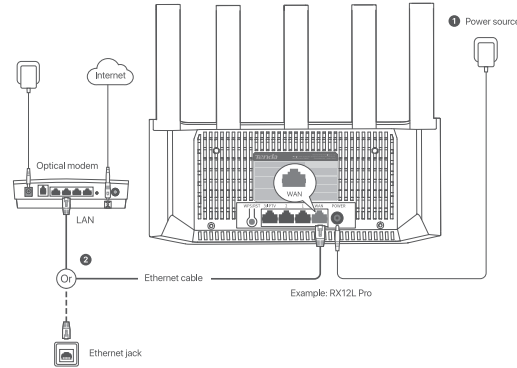

- Tips**
- If you use the modem for internet access, power off the modem first before connecting the WAN port of the router to the LAN port of your modem and power it on after the connection.
 - Refer to the following relocation tips to locate the router to a proper position:
 - Place the router in a high position with few obstacles.
 - Unfold the antenna of the router vertically.
 - Keep your router away from electronics with strong interference, such as microwave ovens, induction cookers, and refrigerators.
 - Keep your router away from metal barriers, such as weak current boxes, and metal frames.

1. Power on the router.
2. Connect the WAN port of the router to the LAN port of your modem or the Ethernet jack using an Ethernet cable.

II. Connect the Router to the Internet

1. Connect your wireless client such as a smartphone to the WiFi network of the router, or use an Ethernet cable to connect the computer to the LAN port of the router. The WiFi name can be found on the label of the router's body.
2. After the client connects to the router, the page will automatically redirect to the web UI of the router. If not, start a web browser on your client and enter **tendawifi.com** in the address bar to access the router's web UI.



3. Perform operations as prompted (smartphone used as an example).

1 Tap **Start**.



2 The router detects your connection type automatically.

- If your internet access is available without further configuration (for example, PPPoE connection through an optical modem is completed), tap **Next**.

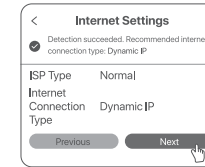

- If the PPPoE user name and password are required for internet access, select the **ISP Type** based on your region and ISP and enter required parameters (if any). If you forget your PPPoE user name and password, you can obtain the PPPoE user name and password from your ISP and manually enter them. Then, tap **Next**.

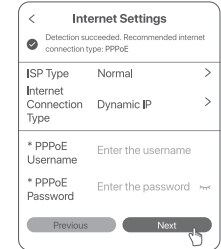

3 Set the WiFi name, WiFi password and login password for the router. Tap **Next**.

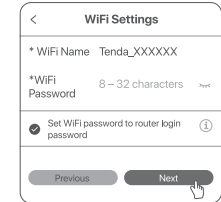

Tips
 The WiFi password is used to connect to the WiFi network, while the login password is used to log in to the web UI of the router.

Scenario 2: Set Up as an Add-on Node

- Tips**
- This router can be networked with **Tenda WiFi+** routers.
 - Ensure that the existing router (primary node) has been connected to the internet and the router (secondary node) to be added has never been used. If not, reset this router first.
 - Two RX12L Pro are used as an example here. If the router fails to be added to an existing network, contact Tenda customer service for help.

I. Add the Router to an Existing Network

1. Place the router in an elevated and open position within 3 meters from your existing router.
2. Use the power adapter to connect the router to a power source.
3. Press the **WPS** button of the router for about 1-3 seconds. The LED indicator blinks green quickly. Within 2 minutes, press the **WPS** button of the existing router for 1-3 seconds to negotiate with this router.

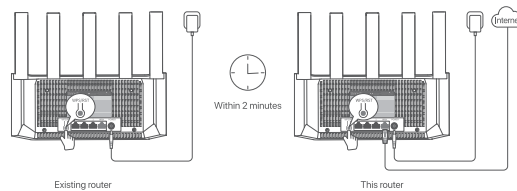

When the LED indicator of the router lights solid green, the networking is successful and the router becomes a secondary node in the network.

II. Relocate the Router

1. Refer to the following relocation tips to locate the router to a proper position:
 - Ensure that the distance between any two nodes is less than 10 meters.
 - Keep your routers away from electronics with strong interference, such as microwave ovens, induction cookers, and refrigerators.
 - Place the routers in a high position with few obstacles.
2. Power on the router again.
3. Wait 1-2 minutes and observe the router's LED indicator. If the LED indicator is solid green, the connection between the primary node and secondary node is good. Otherwise, move the router (secondary node) closer to the existing router for better connection quality.

1 Done.

To access the internet with:

- WiFi-enabled devices: Connect to your WiFi network. (The WiFi name and WiFi password of the new router are the same as the existing router.)
- Wired devices: Connect to a LAN port of the router using an Ethernet cable.

LED Indicator

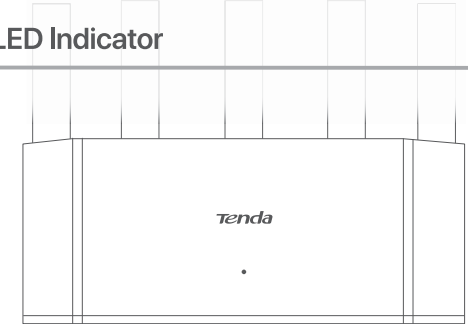

Example: RX12L Pro

LED Indicator	Scenario	Status	Description
Internet connection	Startup	Solid green	The system is starting up.
		Solid green	The router is connected to the internet.
	Primary node	Blinking green slowly	Not configured and the router is not connected to the internet.
		Blinking red slowly	Configured but the router failed to connect to the internet.
		Blinking orange slowly	Configured but no Ethernet cable is connected to the WAN port.
		Solid orange	Networking succeeds. Good connection quality.
Secondary node	Solid orange	Networking succeeds. Fair connection quality.	
	Solid red	Networking succeeds. Poor connection quality.	
LED indicator	WPS	Blinking green slowly	Waiting to connect to another node.
		Blinking red slowly	Configured but the router failed to connect to the internet.
	Ethernet cable connection	Blinking green quickly for 3 seconds	A device is connected to or disconnected from an Ethernet port of the router.
		PPPoE user name and password importing (only for primary node)	Blinking green quickly for 8 seconds
Resetting	Blinking orange quickly	Restoring to factory settings.	

Get Support and Services

For technical specifications, user guides and more information, please visit the product page or service page on www.tendacn.com. Multiple languages are available. You can see the product name and model on the product label.



Jack, Ports and Buttons

The jacks, ports and buttons may vary with models. The actual product prevails.

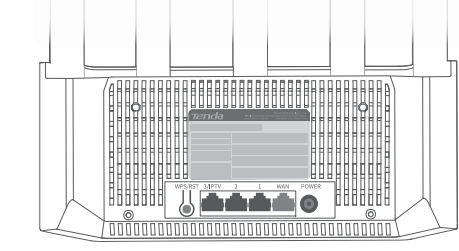

Example: RX12L Pro

Jack/Port/Button	Description
	Used to start the WPS negotiation process, or to reset the router. – WPS : Through the WPS negotiation, you can connect to the WiFi network of the router without entering the password. Method : Press the button for about 1–3 seconds, and the LED indicator blinks green fast. Within 2 minutes, enable the WPS function of the other WPS-supported device to establish a WPS connection. WPS/RSST – Mesh : When it is used as a Mesh networking button, you can extend your network with another device that supports the Mesh function. Method : Press this button for about 1–3 seconds. The LED indicator blinks green fast, which indicates the device is searching for another device to form a network. Within 2 minutes, press the MESH/WPS button of another device for 1–3 seconds to negotiate with this device. – Reset method : Refer to Q3 in FAQ .
3/IPTV	Gigabit LAN/IPTV port. It is a LAN port by default. When the IPTV function is enabled, it can only serve as an IPTV port to connect to a set-top box.
1, 2	Gigabit LAN port. Used to connect to such devices as computers, switches and game machines.
WAN	Gigabit WAN port. Used to connect to a modem or the Ethernet jack for internet access.
POWER	Power Jack.



CE Mark Warning

This is a Class B product. In a domestic environment, this product may cause radio interference, in which case the user may be required to take adequate measures.

This equipment should be installed and operated with a minimum distance 20cm between the device and your body.

NOTE: (1) The manufacturer is not responsible for any radio or TV interference caused by unauthorized modifications to this equipment. (2) To avoid unnecessary radiation interference, it is recommended to use a shielded RJ45 cable.

Declaration of Conformity

Hereby, SHENZHEN TENDA TECHNOLOGY CO., LTD. declares that the device is in compliance with Directive 2014/53/EU.

The full text of the EU declaration of conformity is available at the following internet address:

<https://www.tendacn.com/download/list-9.html>

Operating Frequency/Max Output Power

English : Operating Frequency/Max Output Power Deutsch : Betriebsfrequenz/Max. Ausgangsleistung Italiano : Frequenza operativa/Potenza di uscita massima Español : Frecuencia operativa/Potencia de salida máxima Português : Frequência de Funcionamento/Potência Máxima de Saída Français : Fréquence de fonctionnement/Puissance de sortie maximale Nederlands : Bedrijfsfrequentie/Maximale uitgangsvermogen Svenska : Driftfrekvens/Max. utfångseffekt Dansk : Driftsfrekvens/Maks. Udgangseffekt Suomi : Toimintataajuus/Maksimaaliteho Magyar : Működési frekvencia/Maximális kimeneti teljesítmény Polski : Częstotliwość pracy / Maksymalna moc wyjściowa Russkoye : Рабочая частота/максимальная выходная мощность Cestina : Provozní frekvence/maximální výstupní výkon Ελληνικά : Συχνότητα λειτουργίας/Μαξίμου Ισχύος Εξέλιξης Română : Frecvența de funcționare/Puterea maximă de ieșire Български : Работна честота/максимална изходна мощност Eesti : Töösagedus/Max väljundvõimsus Slovenčina : Dobovna frekvencia/Največja izhodna moč Slovenščina : Prevalovalna frekvencia/maksimalni sstopniški výkon Hrvatski : Radna frekvencija/Maksimalna izlazna snaga Latviešu : Darbības frekvence/Maksimālā jauda Lietuvių : Darbinis dažnis/maksimali išėjimo galia Türkçe : Çalışma Frekansı/Maks. Çıktı Gücü عربي : تردد التشغيل / الحد الأقصى لطاقة الإخراج	2412MHz-2472MHz/20dBm 5150MHz-5250MHz (Indoor use only)/ 23dBm (RX2L/TX2L/RX2L Pro/TX2L Pro) 5150MHz-5350MHz (Indoor use only)/ 23dBm (RX12L/TX12L/RX12L Pro/TX12L Pro)
---	---

FAQ

Q1: I cannot log in to the web UI by visiting tendawifi.com. What should I do?

- A1:** Try the following solutions:
- Ensure that your smartphone or computer is connected to the WiFi network of the router.
 - For the first login, connect the WiFi name (Tenda_XXXXX) on the label of the device's body. XXXXXX is the last six digits of the MAC address on the label.
 - When logging in again after setting, use the changed WiFi name and password to connect to the WiFi network.
 - If you are using a smartphone, ensure that the cellular network (mobile data) of the client is disabled.
 - If you are using a wired device, such as a computer:
 - Ensure that **tendawifi.com** is entered correctly in the address bar, rather than the search bar of the web browser.
 - Ensure that the computer is set to **Obtain an IP address automatically** and **Obtain DNS server address automatically**.
- If the problem persists, reset the router by referring to **Q3** and try again.

Q2: I cannot access the internet after the configuration. What should I do?

- A2:** Try the following solutions:
- Ensure that the WAN port of the router is connected to a modem or Ethernet jack properly.
 - Log in to the web UI of the router and navigate to the **Internet Settings** page. Follow the instructions on the page to solve the problem.
- If the problem persists, try the following solutions:
- For WiFi-enabled devices:
 - Ensure that your devices are connected to the WiFi network of the router.
 - Visit **tendawifi.com** to log in to the web UI and change your WiFi name and WiFi password on the **WiFi Settings** page. Then try again.
 - For wired devices:
 - Ensure that your wired devices are connected to a LAN port properly.
 - Ensure that wired devices are set to **Obtain an IP address automatically** and **Obtain DNS server address automatically**.

Q3: How to restore my device to factory settings?

A3: When your device is working properly, hold down the reset (marked RST or RESET) button of your device for about 8 seconds, and release it when the LED indicator blinks orange fast. After about 1 minute, the router is reset successfully and rebooted. You can configure the router again.

Q4: The router's Wi-Fi signal is poor. What should I do?

- A4:** Try the following solutions:
- Place the router in a high position with few obstacles.
 - Unfold the antenna of the router vertically.
 - Keep your router away from electronics with strong interference, such as microwave ovens, induction cookers, and refrigerators.
 - Keep your router away from metal barriers, such as weak current boxes, and metal frames.



FCC Statement

This equipment has been tested and found to comply with the limits for a Class B digital device, pursuant to Part 15 of the FCC Rules. These limits are designed to provide reasonable protection against harmful interference in a residential installation. This equipment generates, uses and can radiate radio frequency energy and, if not installed and used in accordance with the instructions, may cause harmful interference to radio communications. However, there is no guarantee that interference will not occur in a particular installation. If this equipment does cause harmful interference to radio or television reception, which can be determined by turning the equipment off and on, the user is encouraged to try to correct the interference by one or more of the following measures:

- Reorient or relocate the receiving antenna.
- Increase the separation between the equipment and receiver.
- Connect the equipment into an outlet on a circuit different from that to which the receiver is connected.
- Consult the dealer or an experienced radio/TV technician for help.

Operation is subject to the following two conditions: (1) this device may not cause harmful interference, and (2) this device must accept any interference received, including interference that may cause undesired operation. The device is for indoor usage only.

Radiation Exposure Statement

This device complies with FCC radiation exposure limits set forth for an uncontrolled environment and it also complies with Part 15 of the FCC RF Rules.

This equipment should be installed and operated with minimum distance 20cm between the device and your body.

Caution:

Any changes or modifications not expressly approved by the party responsible for compliance could void the user's authority to operate this equipment.

This transmitter must not be co-located or operating in conjunction with any other antenna or transmitter.

Operating frequency:
2412-2462 MHz
5150-5250 MHz (RX2L/TX2L/RX2L Pro/TX2L Pro)
5150-5350 MHz (RX12L/TX12L/RX12L Pro/TX12L Pro)
5725-5825 MHz

NOTE: (1) The manufacturer is not responsible for any radio or TV interference caused by unauthorized modifications to this equipment. (2) To avoid unnecessary radiation interference, it is recommended to use a shielded RJ45 cable.



Safety Precautions

Before operating, read the operation instructions and precautions to be taken, and follow them to prevent accidents. The warning and danger items in other documents do not cover all the safety precautions that must be followed. They are only supplementary information, and the installation and maintenance personnel must to understand the basic safety precautions to be taken.

- The device is for indoor usage only.
- The device must be horizontally mounted for safe use.
- Do not use the device in a place where wireless devices are not allowed.
- Please use the included power adapter.
- The mains plug is used as the disconnect device, and shall remain readily operable.
- The power socket shall be installed near the device and easily accessible.
- Operating environment: Temperature: 0°C – 40°C; Humidity: (10% – 90%) RH, non-condensing; Storage environment: Temperature: -40°C to +70°C; Humidity: (5% – 90%) RH, non-condensing.
- Keep the device away from water, fire, high electric field, high magnetic field, and inflammable and explosive items.
- Unplug this device and disconnect all cables during lightning storms or when the device is unused for long periods.
- Do not use the power adapter if its plug or cord is damaged.
- If such phenomena as smoke, abnormal sound or smell appear when you use the device, immediately stop using it and disconnect its power supply, unplug all connected cables, and contact the after-sales service personnel.
- Disassembling or modifying the device or its accessories without authorization voids the warranty, and might cause safety hazards.

For the latest safety precautions, see **Safety and Regulatory Information** on **www.tendacn.com**.

IC RSS Warning (RX12L/TX12L/RX12L Pro/TX12L Pro)

This device complies with Innovation, Science and Economic Development Canada licence-exempt RSS standard (s). Operation is subject to the following two conditions:
(1) this device may not cause interference, and
(2) this device must accept any interference, including interference that may cause undesired operation of the device.
Le présent appareil est conforme aux CNR d'Innovation, la science et le développement économique Canada licencés aux aréels radio exempts de licence. L'exploitation est autorisée aux deux conditions suivantes:
(1) l'appareil ne doit pas produire de brouillage, et
(2) l'utilisateur de l'appareil doit accepter tout brouillage radioélectrique subi, on si le brouillage est susceptible d'en compromettre le fonctionnement.

Any changes or modifications not expressly approved by the party responsible for compliance could void the user's authority to operate the equipment.
Tous les changements ou modifications non expressément approuvés par le responsable de la conformité pourraient void l'utilisateur est habilité à exploiter l'équipement.

ISED/C Radiation Exposure Statement:

This equipment complies with ISED/C RF radiation exposure limits set forth for an uncontrolled environment. This transmitter must not be co-located or operating in conjunction with any other antenna or transmitter. This equipment should be installed and operated with minimum distance 20cm between the radiator and your body.
Cet appareil est conforme aux limites d'exposition de rayonnement RF ISED/C établies pour un environnement non contrôlé. Cet équipement ne doit pas être co-implanté/autocouplé en conjonction avec toute autre antenne ou transmetteur. La distance entre le radiateur et le corps doit être d'au moins 20 cm lors de l'installation et du fonctionnement de l'appareil.

Operation of 5150-5350MHz is restricted to indoor use only.
le fonctionnement de 5150-5350MHz est limité à une utilisation en intérieur uniquement.

Slovenčina-Pozor: V členskyh štátoch EÚ, krajinách EFTA, Severnom Írsku a Veľkej Británii je prevádzka vo frekvencnom pásme 5150MHz-5350MHz povolená len v interiéri.
Hrvatski-Pozornost: V državah članicah EU, državah EFTA, Severni Irski in Veliki Britaniji je doajvanje v frekvencnom domnoju 5150MHz-5350MHz dovoljeno samo v zaprtih prostorih.
Latviešu-Uzmanību: ES valstīs, EFTA valstīs, Ziemeļriņī, operācija iekšējās telpās ir atļauta tikai 5150MHz-5350MHz (RX12L/TX12L/RX12L Pro/TX12L Pro) in 5150MHz-5250MHz (RX2L/TX2L/RX2L Pro/TX2L Pro) diapazonā.
Lietuvių-Dėmesio: ES valstybėse narėse, ELPA šalys, Saures Anijos ir Didiosios Britanijos 5150MHz-5350MHz (RX12L/TX12L/RX12L Pro/TX12L Pro) in 5150MHz-5250MHz (RX2L/TX2L/RX2L Pro/TX2L Pro) dažnių diapazone leidžiama veikti tik patalpose.
Isenska-Athúgö: Í aðilríkjum ESB, EFTA-landum, Norðurland-Íslandi og Bretlandi er reksur á 5150MHz-5350MHz (RX12L/TX12L/RX12L Pro/TX12L Pro) og 5150MHz-5250MHz (RX2L/TX2L/RX2L Pro/TX2L Pro) aðeins leyfður innanþyr.
Norsk-ØBS: I EU-landene, EFTA-land, Nord-Irland og Storbritannia er drift i frekvensområdet 5150MHz-5350MHz (RX12L/TX12L/RX12L Pro/TX12L Pro) in 5150MHz-5250MHz (RX2L/TX2L/RX2L Pro/TX2L Pro) kun tillatt innendørs.



Technical Support

Shenzhen Tenda Technology Co., Ltd.
Floor 6-8, Tower E3, No.1001, Zhongshanyuan Road, Nanshan District, Shenzhen, China. 518052
Website: www.tendacn.com
E-mail: support@tendacn.com
support.uk@tendacn.com (United Kingdom)
support.us@tendacn.com (North America)

Copyright © 2024 Shenzhen Tenda Technology Co., Ltd. All rights reserved.
Tenda is a registered trademark legally held by Shenzhen Tenda Technology Co., Ltd. Other brand and product names mentioned herein are trademarks or registered trademarks of their respective holders. Specifications are subject to change without notice.