

English

- 1. Install the HDD**
If you do not include any HDD, please prepare it by yourself. You are recommended to use the HDD dedicated for surveillance.
- 2. Connect the device**
The KBW-3TC can be used as an example here. Please always read the manual for the camera first (12 V 1 A), then power on the NVR (12 V 2 A).
- 3. Install the camera**
The camera and the NVR will automatically establish connections within 2 minutes. When the LED indicator of the camera turns red, the NVR successfully adds the camera and starts recording. When using the default mounting, the NVR must be horizontally mounted for safe use.
- 4. Mount the camera**
This device does not require any wiring and mounting. Please refer to the manual.
- 5. Connect the camera**
This device does not require any wiring and mounting. Please refer to the manual.
- 6. Local management**
After the mouse and monitor are connected to the NVR, you can perform local setup.

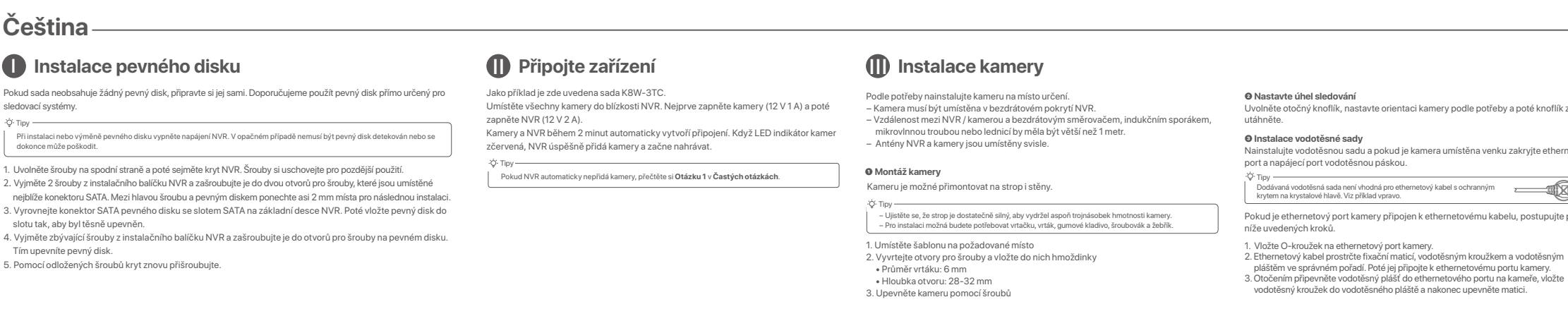

Čeština

- 1. Instalace pevného disku**
Pokud váš model NVR neobsahuje žádný pevný disk, připravte si jej samostatně. Doporučujeme používat pevný disk určený pro dohledové systémy.
- 2. Připojení zařízení**
Příklad použití kamery jako KBW-3TC. Před instalací kamery přečtěte její příručku (12 V 1 A) a poté napájejte NVR (12 V 2 A).
- 3. Instalace kamery**
Kamera a NVR budou automaticky navázat spojení během 2 minut. Když se červená dioda na kamery rozsvítí, bude NVR úspěšně přidat kameru a začne ji zaznamenávat.
- 4. Nastavení kamery**
Tento přístroj nevyžaduje žádné dráty ani montáž. Podívejte se na příručku kamery.
- 5. Připojení kamery**
Tento přístroj nevyžaduje žádné dráty ani montáž. Podívejte se na příručku kamery.
- 6. Základní konfigurace**
Po připojení myši a monitoru můžete provádět místní nastavení.

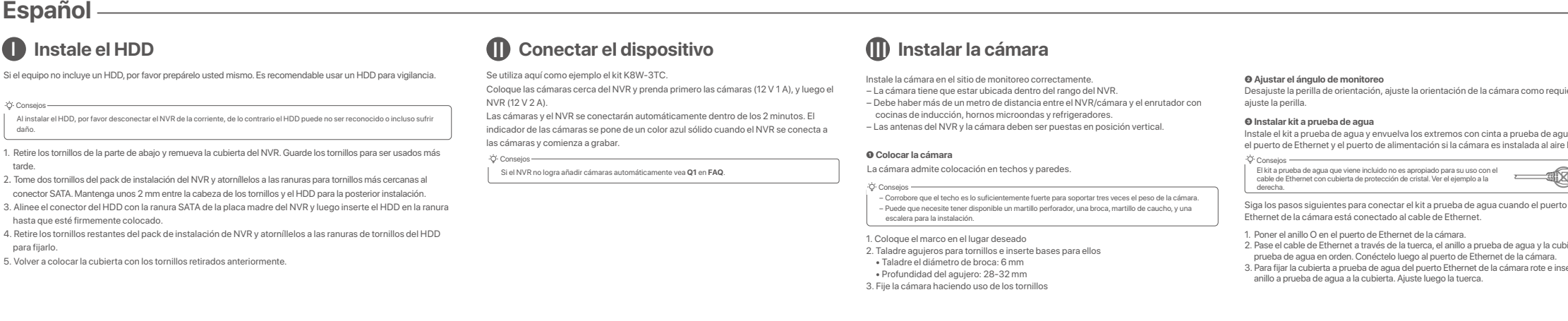

Deutsch

- 1. Montage der Festplatte**
Wenn Sie kein Festplatte enthalten, müssen Sie diese selbst beschaffen. Wir empfehlen Ihnen, eine für die Überwachung geeignete Festplatte zu verwenden.
- 2. Verbinden des Gerätes**
Als Beispiel wird hier eine KBW-3TC-CT gezeigt. Lesen Sie bitte zuerst die Anleitung der Kamera und die des NVR (12 V 2 A).
- 3. Montage der Kamera**
Die Kamera und das NVR werden automatisch verbunden. Sobald die rote LED der Kamera leuchtet, hat die NVR die Kamera erfolgreich hinzugefügt und beginnt mit der Aufnahme.
- 4. Kamera montieren**
Dieses Gerät benötigt keine Verkabelung und Montage. Bitte lesen Sie die Bedienungsanleitung.
- 5. Kamera anschließen**
Dieses Gerät benötigt keine Verkabelung und Montage. Bitte lesen Sie die Bedienungsanleitung.
- 6. Grundkonfiguration**
Nachdem Sie die Maus und den Monitor an den NVR angeschlossen haben, können Sie die Grundkonfiguration durchführen.

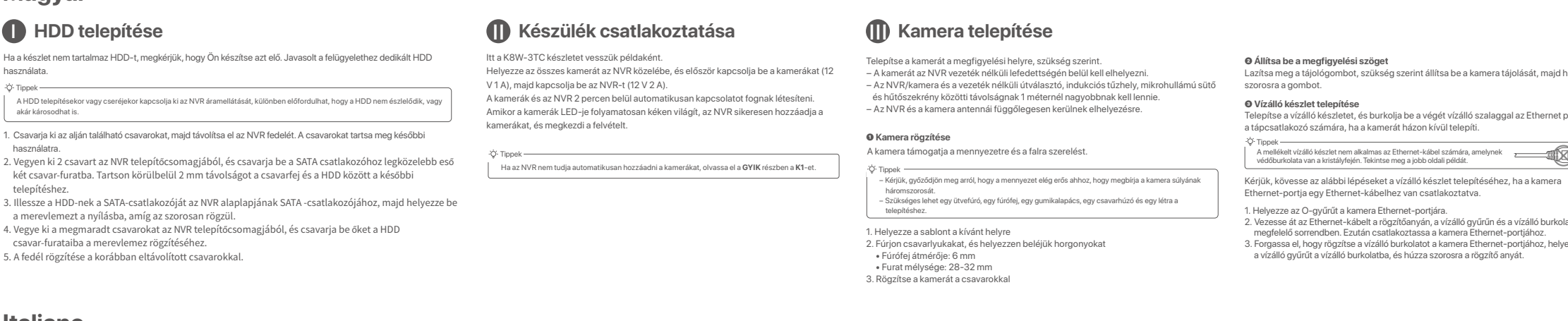

Español

- 1. Instalar el HDD**
Si el equipo no incluye un HDD, por favor prepare uno mismo. Es recomendable usar un HDD para vigilancia.
- 2. Conectar el dispositivo**
Como ejemplo se muestra el uso de la cámara KBW-3TC. Lea primero el manual de la cámara (12 V 1 A) y luego el manual del NVR (12 V 2 A).
- 3. Instalar la cámara**
La cámara y el NVR se conectarán automáticamente en los próximos 2 minutos. El indicador de luz roja de la cámara indica que el NVR ha agregado exitosamente la cámara y comienza a registrar.
- 4. Montar la cámara**
Este dispositivo no requiere cables ni montaje. Consulte el manual de la cámara.
- 5. Conectar la cámara**
Este dispositivo no requiere cables ni montaje. Consulte el manual de la cámara.
- 6. Configuración básica**
Una vez que se conecten el mouse y el monitor, podrá realizar una configuración básica.

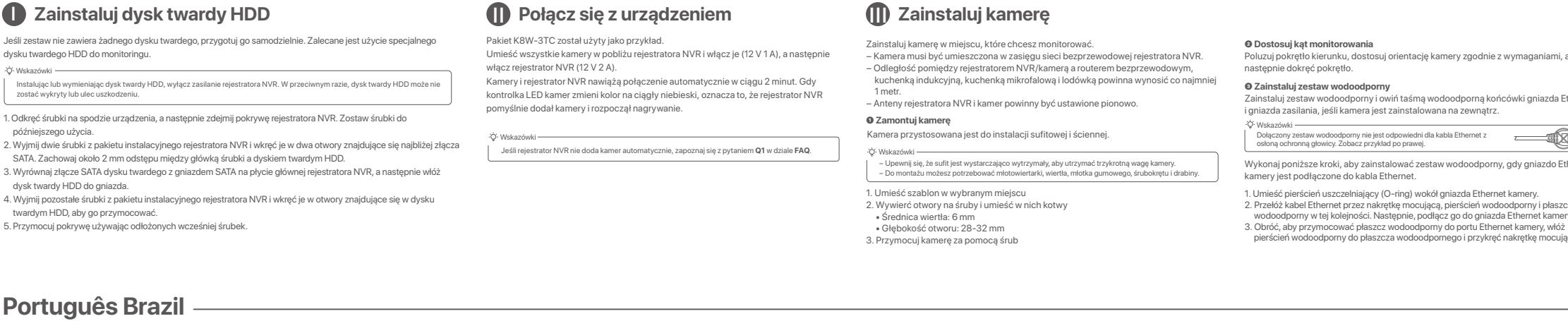

Magyar

- 1. HDD telepítés**
Ha az eszköz nem tartalmaz HDD-t, megvásárolja, hogy Ön elvégezhesse a felrakást. Ajánljuk az Überwachung dedizált HDD használatát.
- 2. Készülék csatlakoztatása**
A példaként megmutatjuk a KBW-3TC-csatlakoztatását. Először olvassa el a kamera kézikönyvét (12 V 1 A), majd a NVR kézikönyvét (12 V 2 A).
- 3. Kamera telepítése**
A kamera és a NVR automatikusan felismerik egymást. Amint a kamera piros LED-j megvilágosodik, a NVR sikeresen hozzáadta a kamerát, és megkezdte a felvételt.
- 4. Kamera szerelése**
Ez a készülék nem igényel drótkötést vagy szerelést. Kérjük, olvassa el a kamera kézikönyvét.
- 5. Kamera csatlakoztatása**
Ez a készülék nem igényel drótkötést vagy szerelést. Kérjük, olvassa el a kamera kézikönyvét.
- 6. Alapkonfiguráció**
A egyszerezés után a számítógép segítségével a NVR-t a kívánt módon állíthatja be.

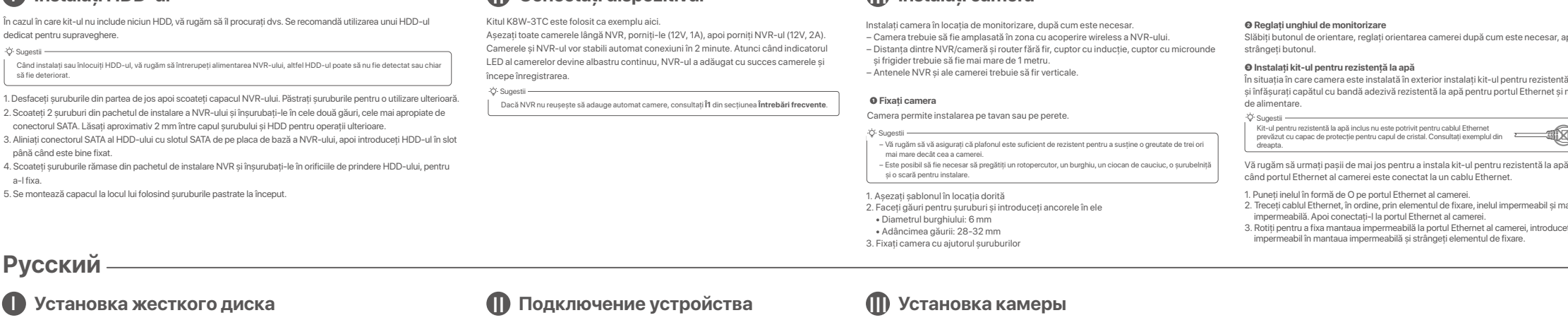

Polish

- 1. Zainstaluj dysk twardego HDD**
Jeśli urządzenie nie zawiera żadnego dysku twardego, przygotuj go samodzielnie. Zalecamy przy użyciu dedykowanego dla nadzoru dysku twardego.
- 2. Połącz się z urządzeniem**
Pobierz przykładowy obraz kamery KBW-3TC. Najpierw przeczytaj instrukcję obsługi kamery (12 V 1 A), a następnie przejdź do instrukcji obsługi NVR (12 V 2 A).
- 3. Zainstaluj kamerę**
Kamera i NVR automatycznie nawiązają połączenie. Gdy na kamerze pojawi się czerwona dioda, NVR pomyślnie doda kamerę i rozpocznie nagrywanie.
- 4. Zamontuj kamerę**
Kamera nie wymaga kabli ani montażu. Proszę przeczytać instrukcję obsługi kamery.
- 5. Podłączyć kamerę**
Kamera nie wymaga kabli ani montażu. Proszę przeczytać instrukcję obsługi kamery.
- 6. Konfiguracja podstawowa**
Po podłączeniu myszy i monitora do NVR można wykonać podstawowe konfiguracje.

Português Brazil

- 1. Instalação do HDD**
Se o seu modelo NVR não incluir um disco rígido, prepare-o por si mesmo. É recomendável usar um HDD dedicado à vigilância.
- 2. Conectar o dispositivo**
Como exemplo, mostramos o uso da câmera KBW-3TC. Leia primeiro o manual da câmera (12 V 1 A) e depois o manual do NVR (12 V 2 A).
- 3. Instalação da câmera**
A câmera e o NVR se conectarão automaticamente em aproximadamente 2 minutos. Quando a luz vermelha da câmera acender, o NVR adiciona a câmera com sucesso e começa a gravar.
- 4. Montar a câmera**
Este dispositivo não requer cabos ou montagem. Consulte o manual da câmera.
- 5. Conectar a câmera**
Este dispositivo não requer cabos ou montagem. Consulte o manual da câmera.
- 6. Configuração básica**
Assim que o mouse e o monitor estiverem conectados ao NVR, você poderá realizar uma configuração básica.

Română

- 1. Instalati HDD-ul**
Dacă modelul dvs. NVR nu include un disc dur, pregătiți-l pe cont propriu. Este recomandată utilizarea unui HDD dedicat sistemului de supraveghere.
- 2. Conectați dispozitivul**
Ca exemplu, este prezentat utilizarea camerei KBW-3TC. Cititi mai intai manualul camerei (12 V 1 A), apoi manualul NVR-ului (12 V 2 A).
- 3. Instalati camera**
Camera si NVR se vor conecta automat in aproximativ 2 minute. Cand lumina rosie de la camera se aprinde, NVR-ul adauga cu succes camera si incepe sa inregistreze.
- 4. Montati camera**
Acest dispozitiv nu necesita cabluri sau montare. Cititi manualul camerei.
- 5. Conectati camera**
Acest dispozitiv nu necesita cabluri sau montare. Cititi manualul camerei.
- 6. Instalati camera**
Dupa ce mouse-ul si monitorul sunt conectate la NVR, puteti realiza o configuratie de baza.

Русский

- 1. Установка жесткого диска**
Если в вашем устройстве не установлен жесткий диск, подготовьте его самостоятельно. Рекомендуется использовать специальный жесткий диск для видеонаблюдения.
- 2. Подключение устройств**
Пример использования камеры KBW-3TC. Сначала прочтите руководство по установке камеры (12 В 1 А), а затем руководство по установке NVR (12 В 2 А).
- 3. Установка камеры**
Камера и NVR автоматически установят соединение. Когда загорится красный светодиод на камере, NVR успешно добавит камеру и начнет запись.
- 4. Установка камеры**
Это устройство не требует проводов и монтажа. Пожалуйста, прочтите руководство по установке камеры.
- 5. Установка камеры**
Это устройство не требует проводов и монтажа. Пожалуйста, прочтите руководство по установке камеры.
- 6. Базовая конфигурация**
После подключения мыши и монитора вы можете выполнять базовую конфигурацию.

Ukrainian

- 1. Установка жесткого диска**
Если в вашем устройстве не установлен жесткий диск, подготовьте его самостоятельно. Рекомендуется использовать специальный жесткий диск для видеонаблюдения.
- 2. Подключение устройств**
Пример использования камеры KBW-3TC. Сначала прочтите руководство по установке камеры (12 В 1 А), а затем руководство по установке NVR (12 В 2 А).
- 3. Установка камеры**
Камера и NVR автоматически установят соединение. Когда загорится красный светодиод на камере, NVR успешно добавит камеру и начнет запись.
- 4. Установка камеры**
Это устройство не требует проводов и монтажа. Пожалуйста, прочтите руководство по установке камеры.
- 5. Установка камеры**
Это устройство не требует проводов и монтажа. Пожалуйста, прочтите руководство по установке камеры.
- 6. Базовая конфигурация**
После подключения мыши и монитора вы можете выполнять базовую конфигурацию.

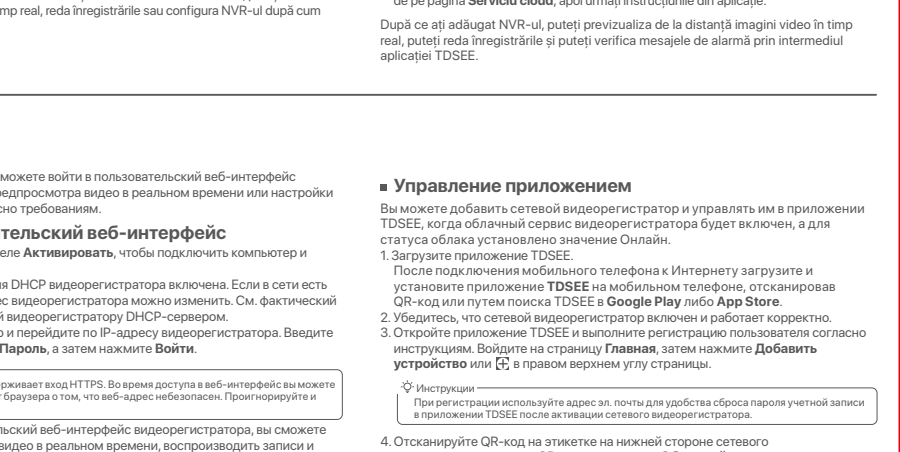
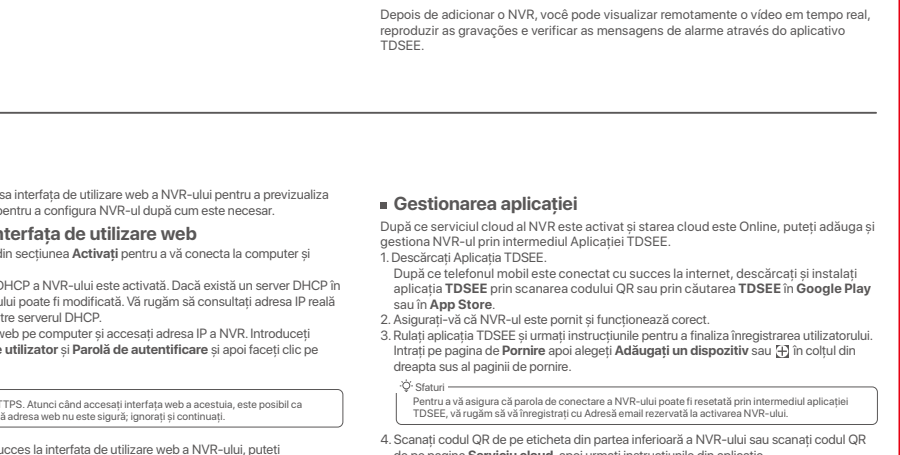
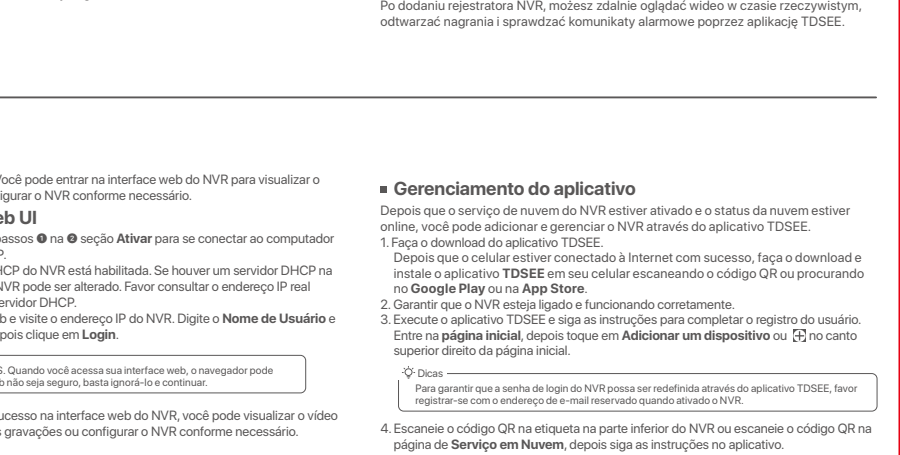
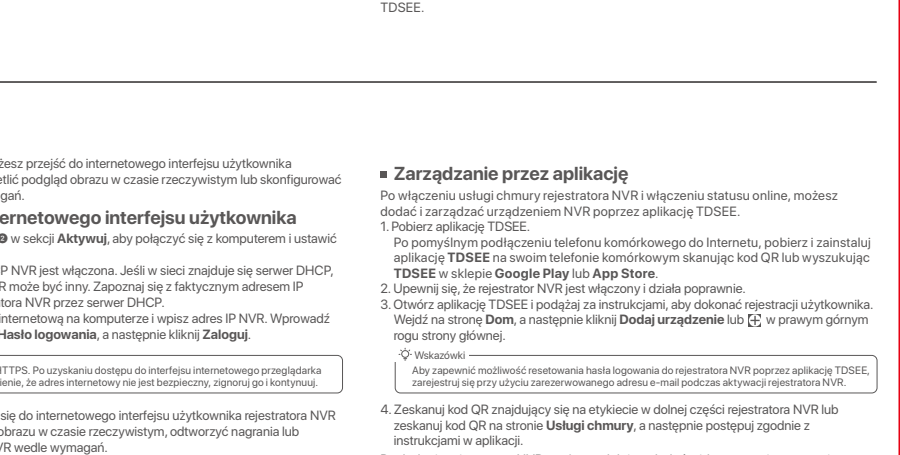
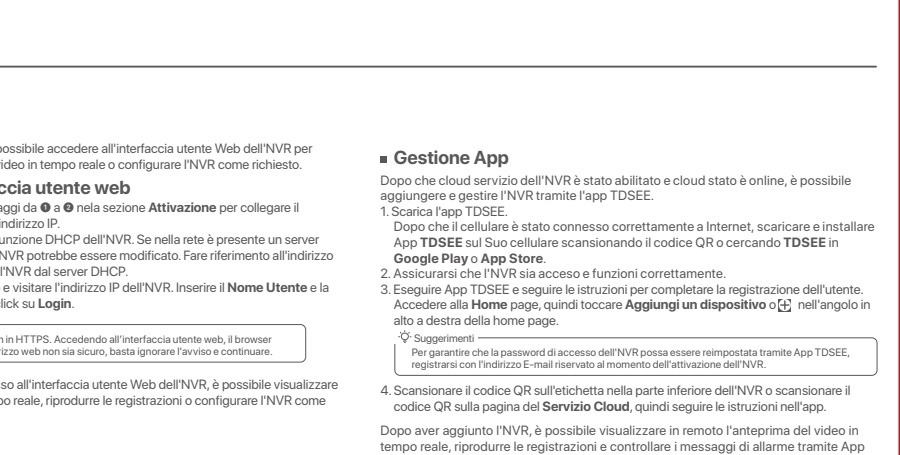
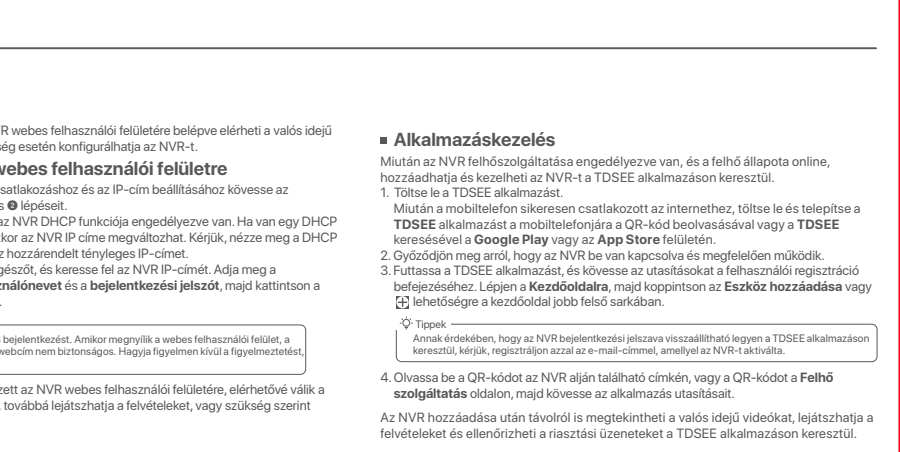
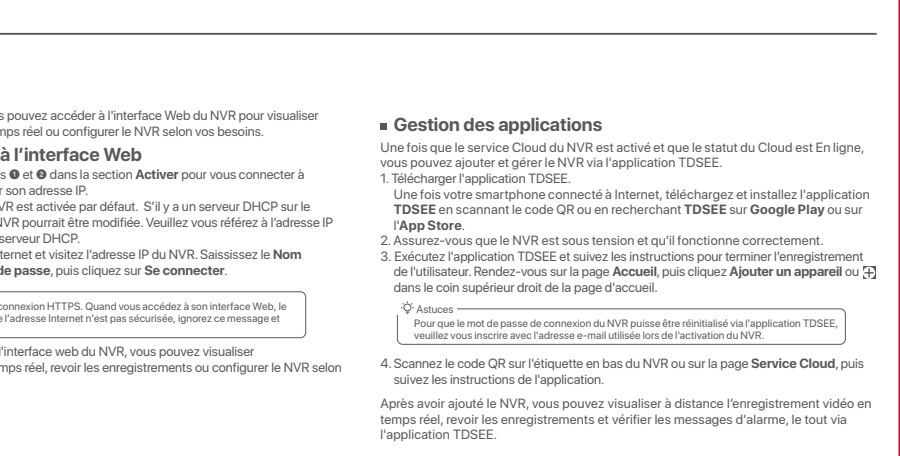
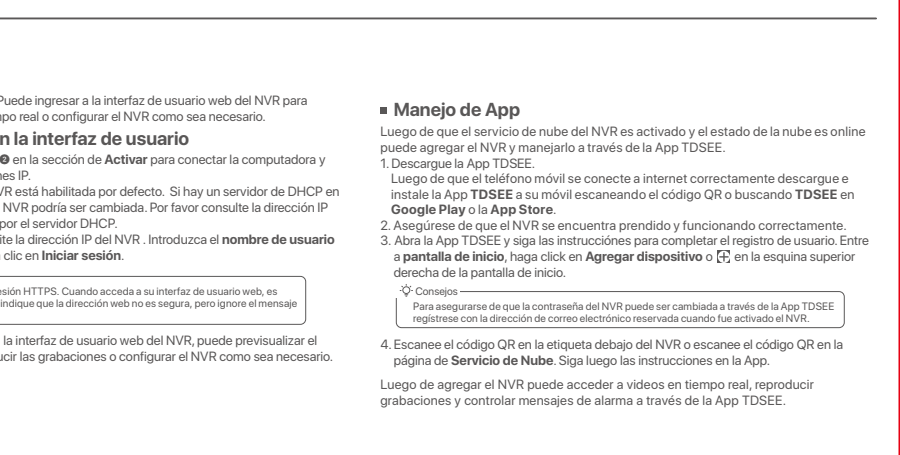
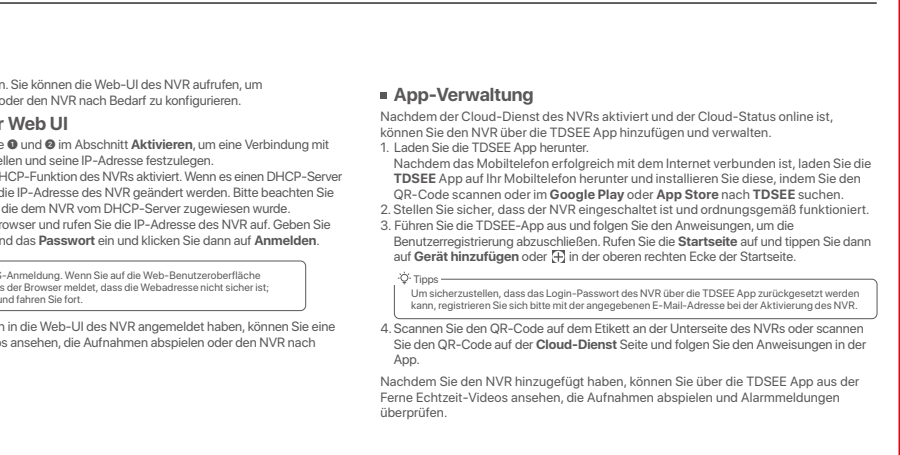
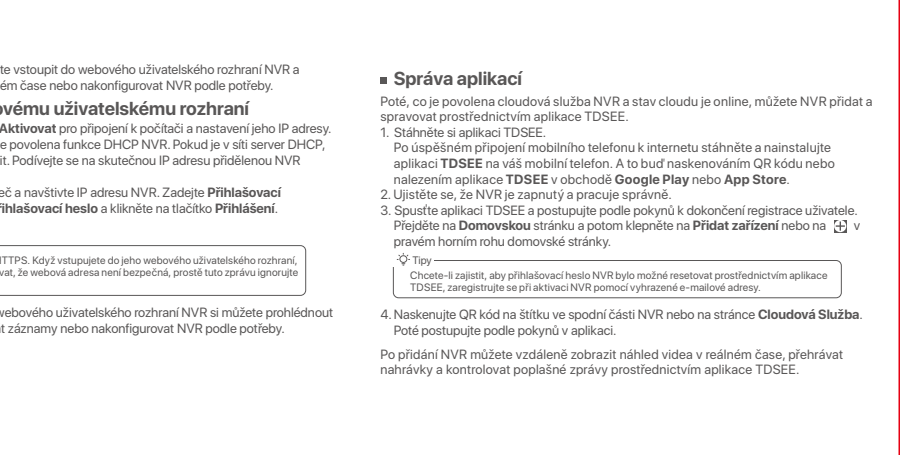
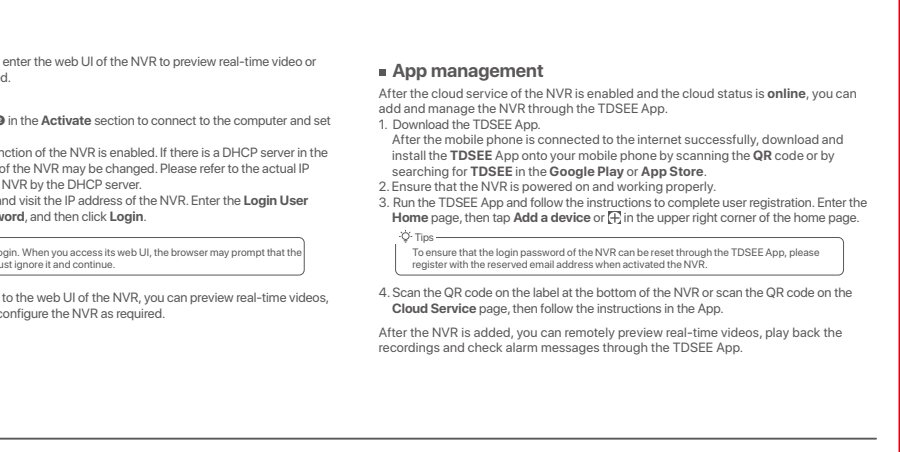
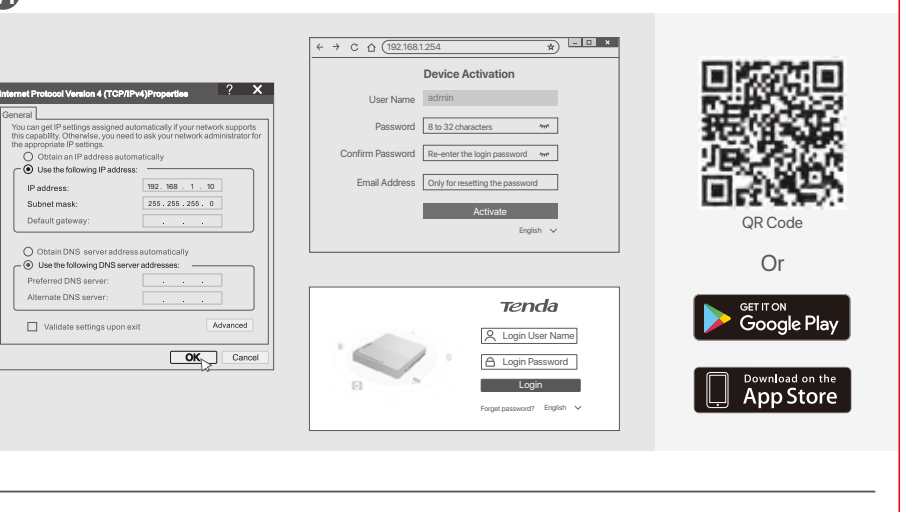
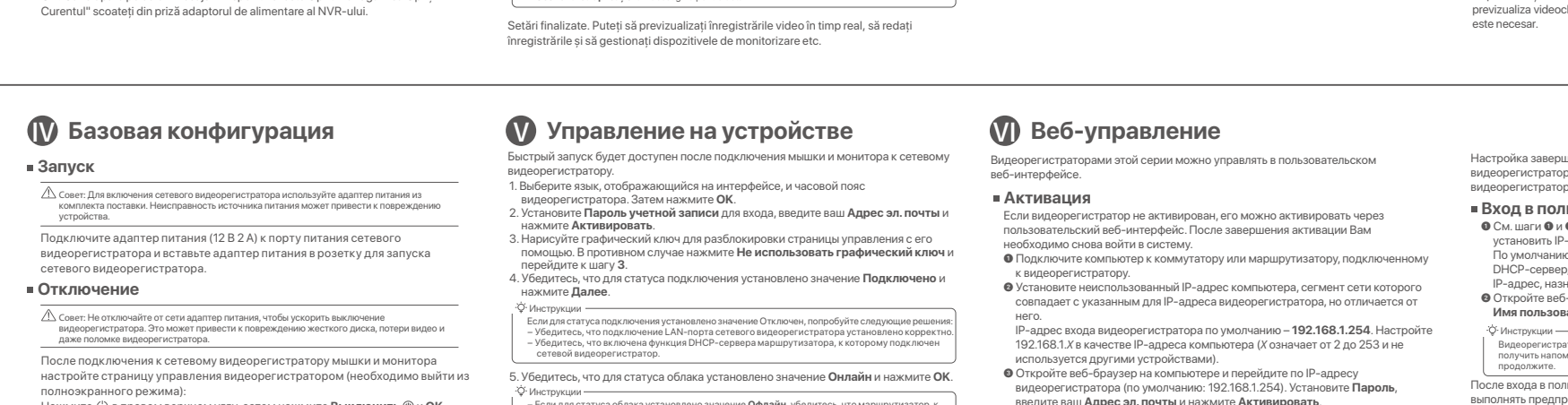
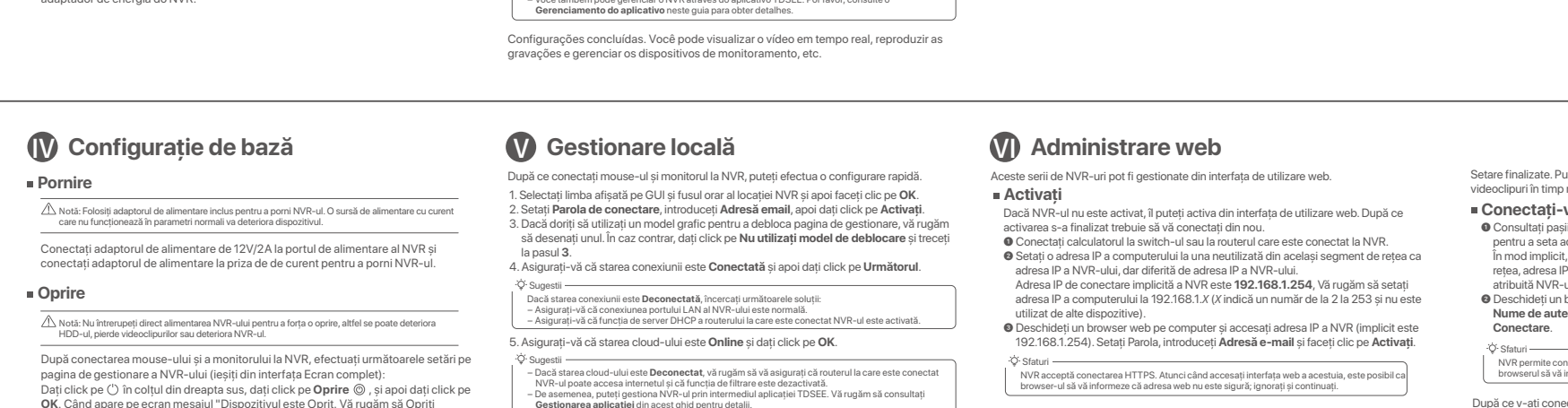
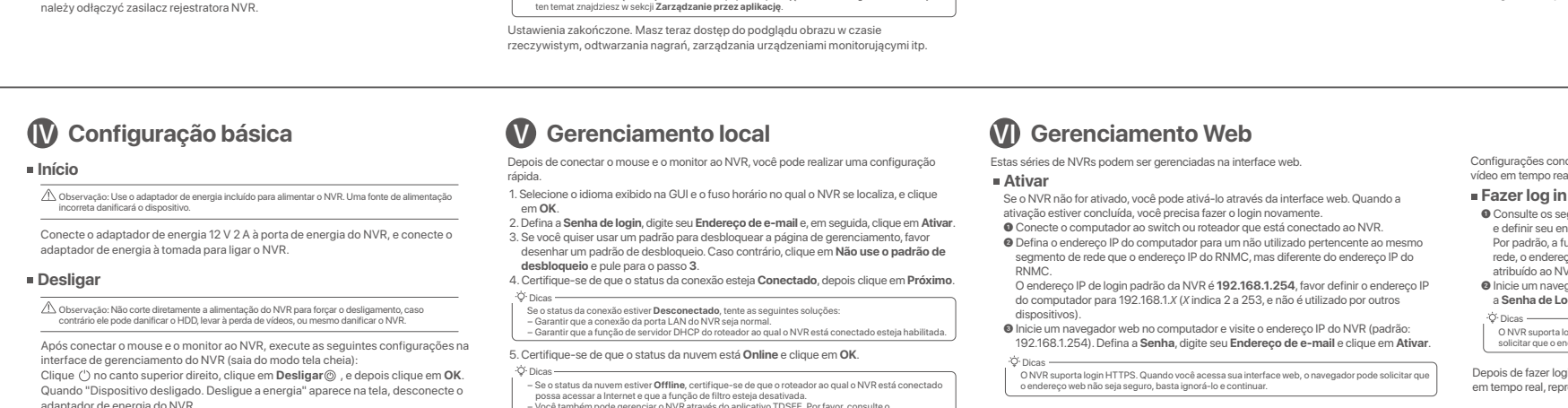
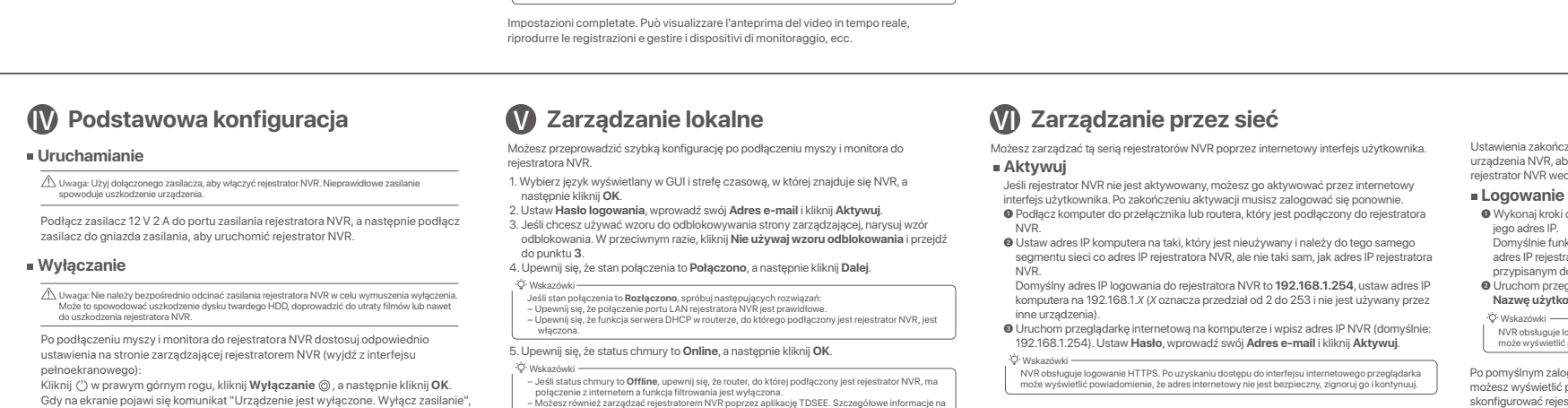
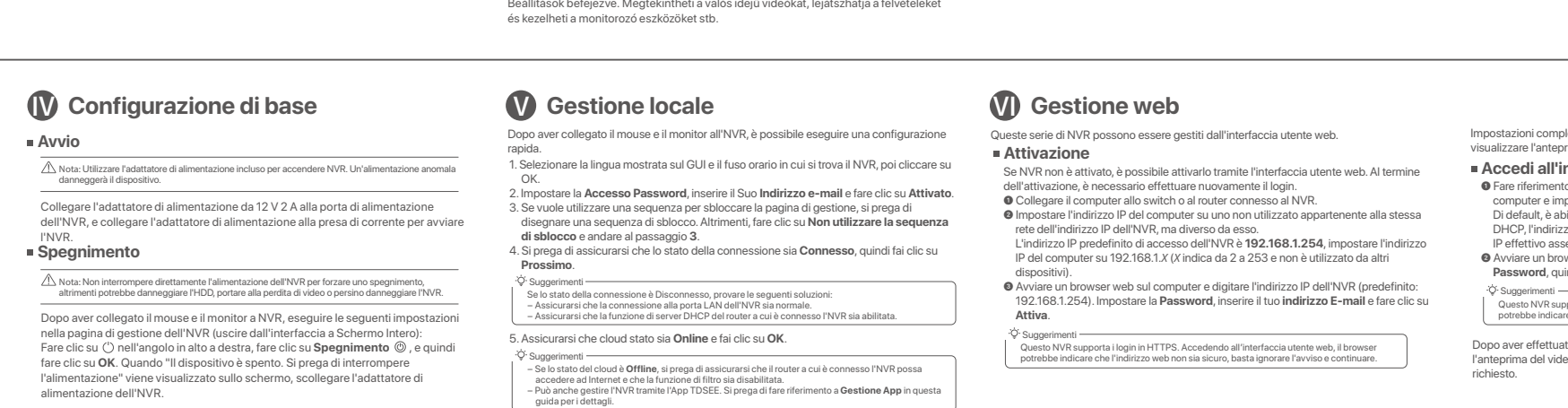
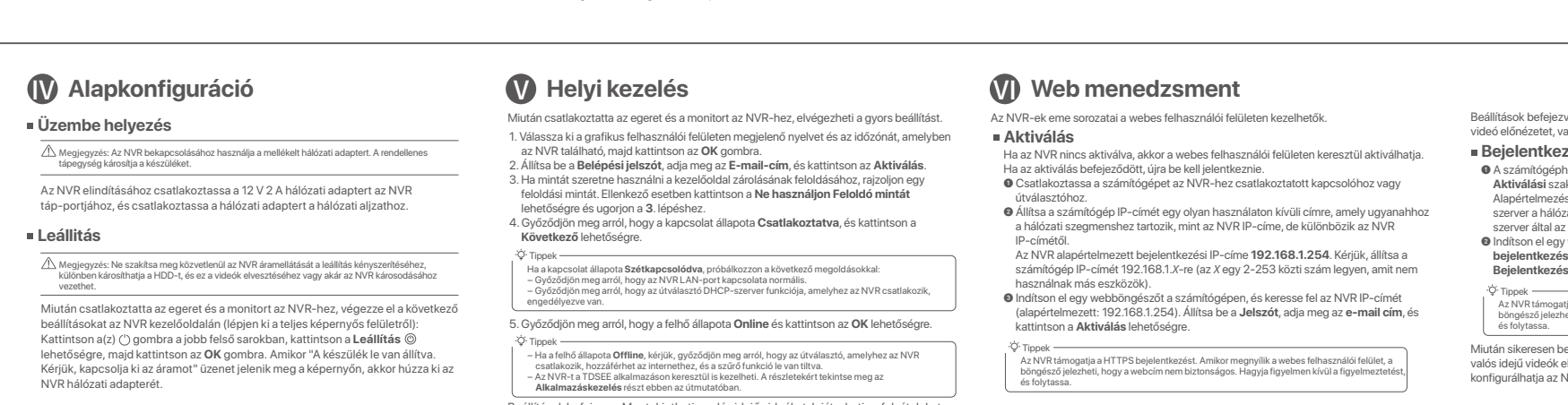
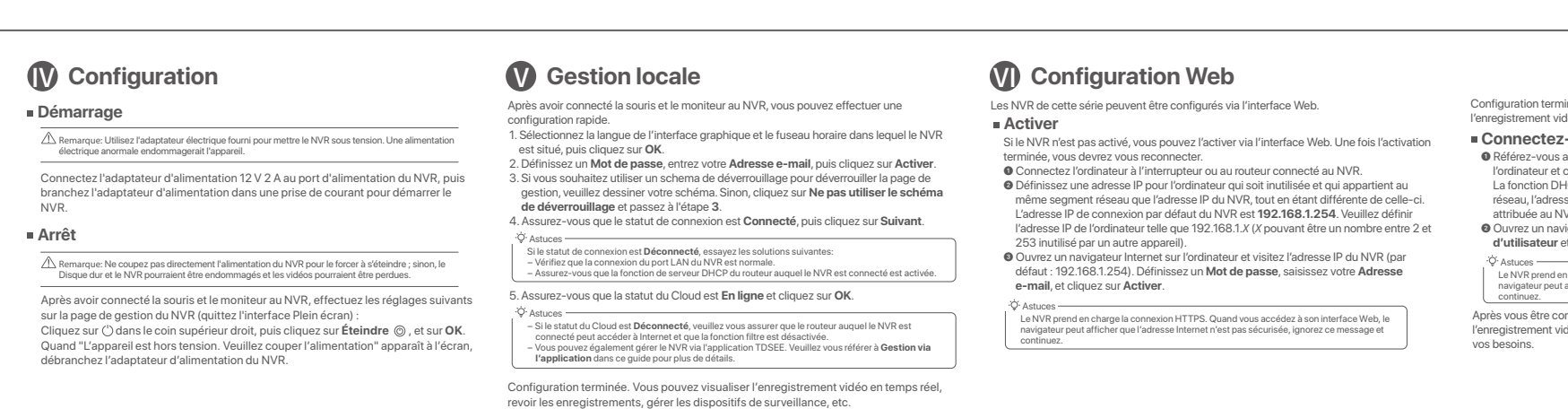
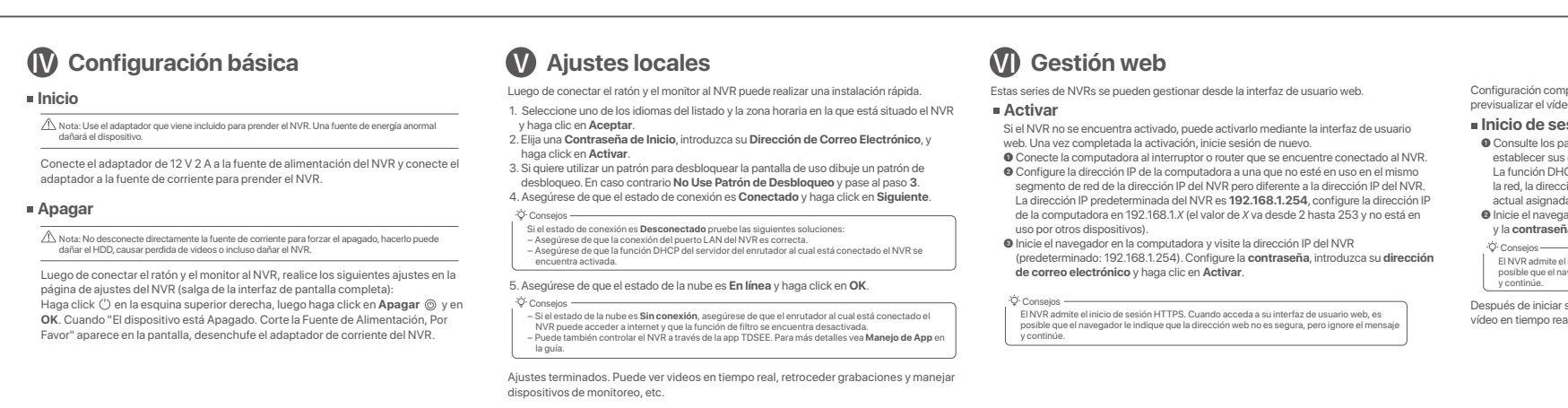
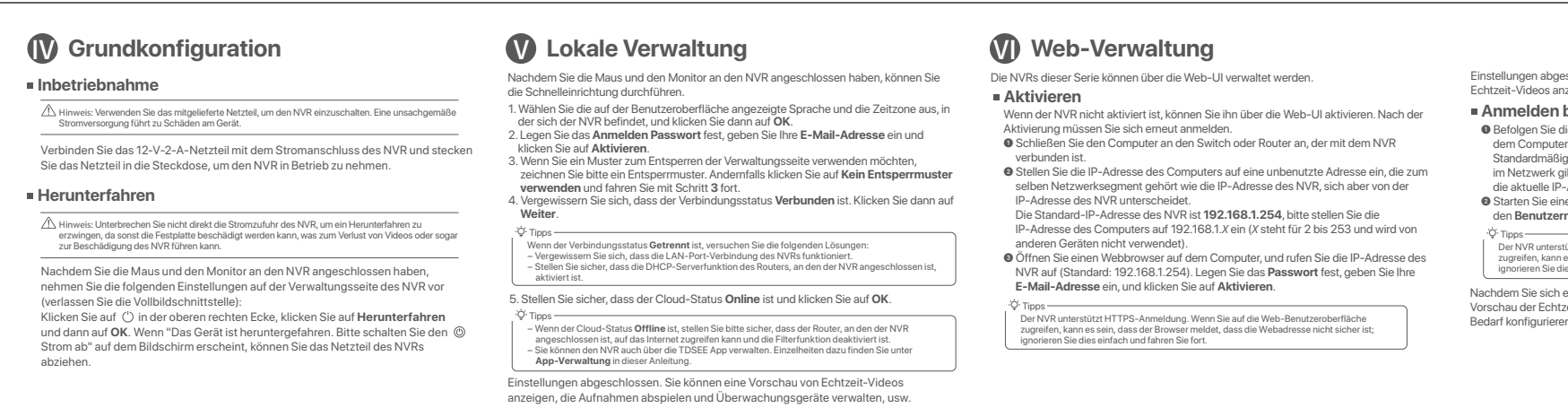
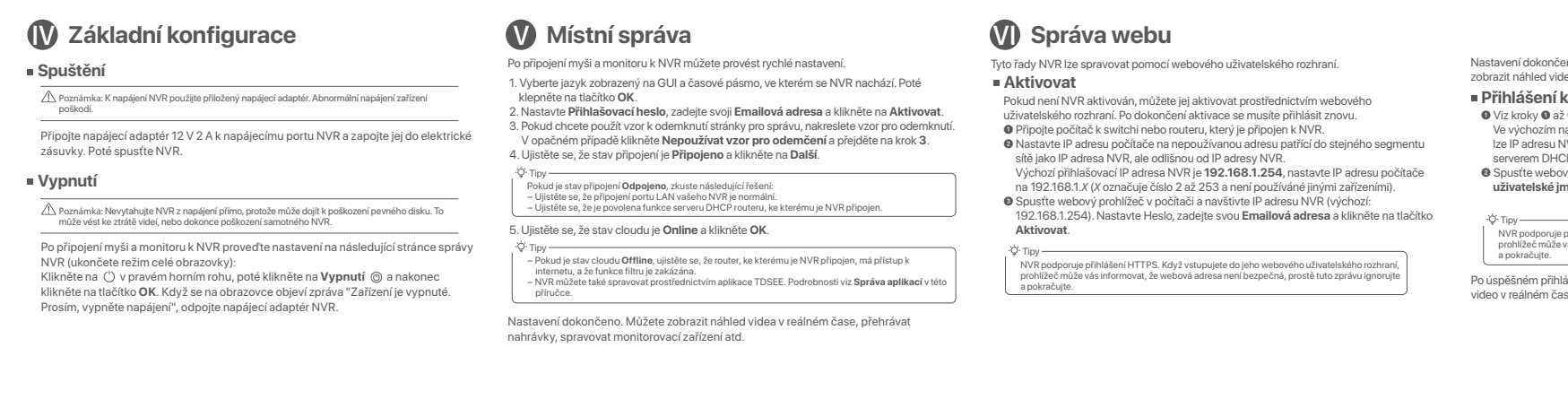
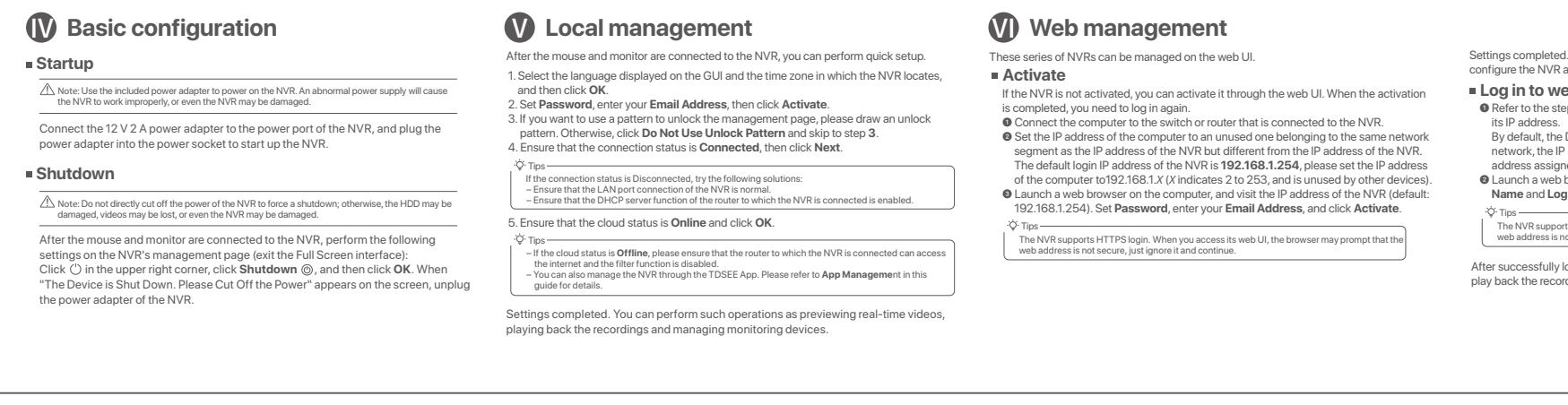
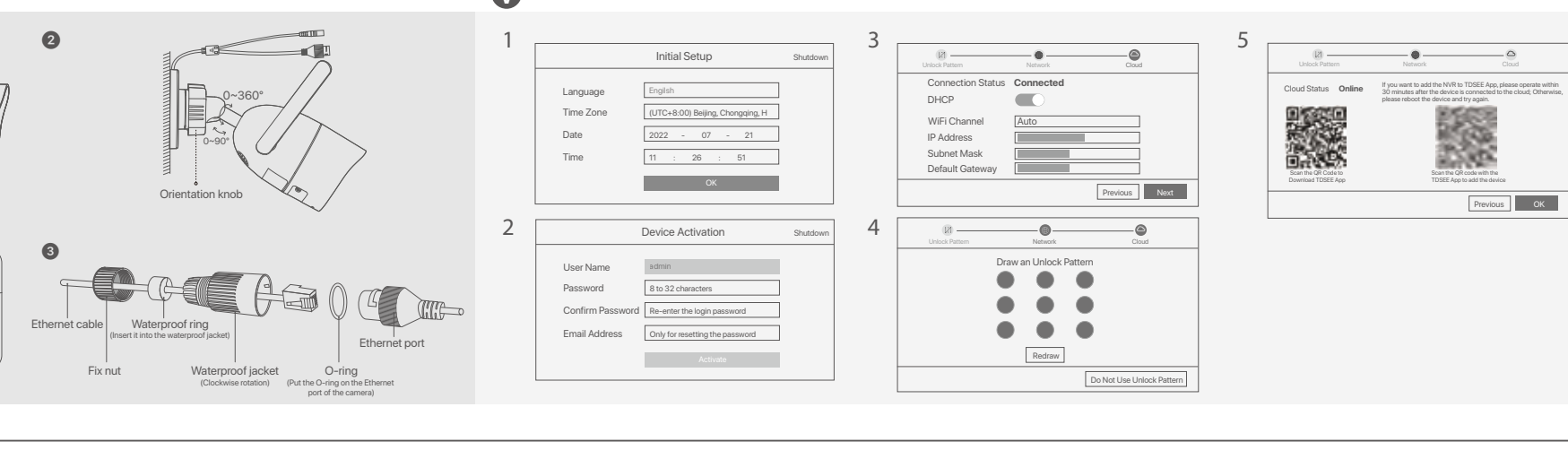

The KAW-3TC kit is taken as an example here. The actual product varies.

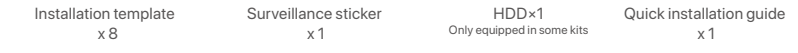
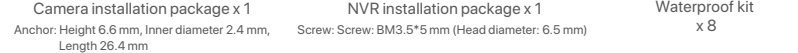
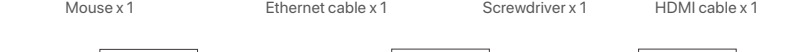

Appearance

NVR

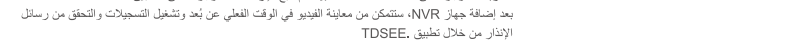
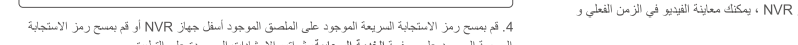
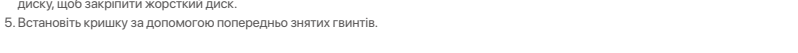
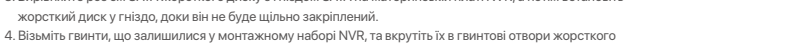
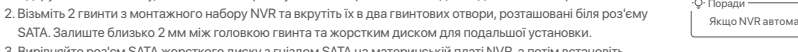
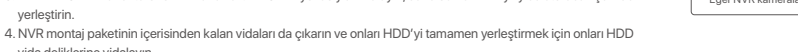
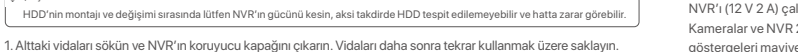
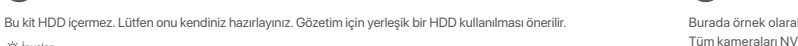
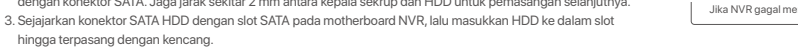
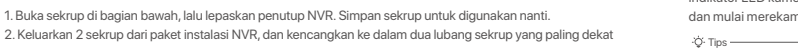
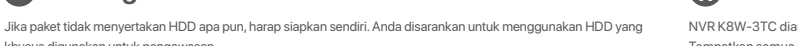
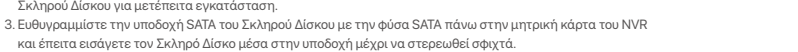
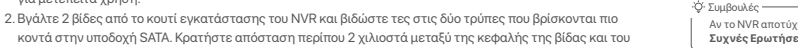
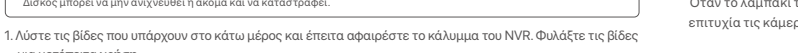
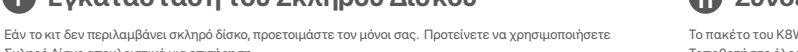
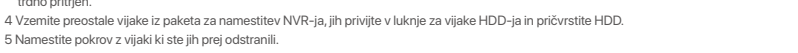
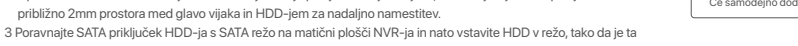
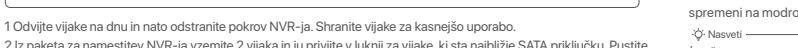
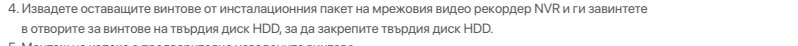
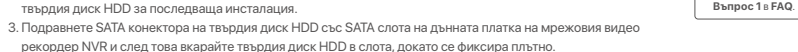
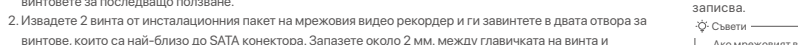
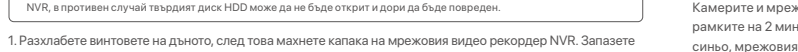
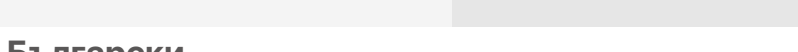
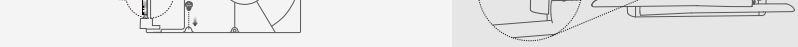
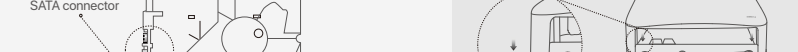
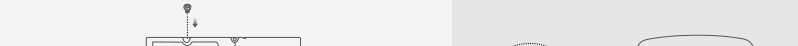
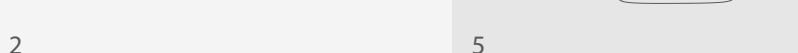
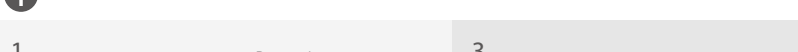
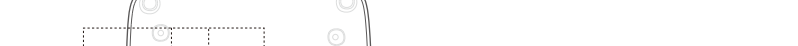

Q1: What should I do if the NVR fails to automatically add the camera?	A1: Try the following options: <ul style="list-style-type: none">— Ensure that the LED indicator of the NVR is on. If the indicator is off, please check the power supply. — Ensure that the LED indicator of the camera is blinking with quality. If it doesn't, please reset the camera and try to Reset method below. Reset button is about 5 seconds and ensure that the LED indicator blinks blue quickly so you can connect to it. — Add the camera in the menu page of NVR.
Q2: What should I do when the video preview is not smooth or the camera is often offline?	A2: Try the following solutions: <ul style="list-style-type: none">— Ensure that the distance between the NVR/camera and the wireless router, induction cooker, microwave oven, and refrigerator is more than 1' (30cm). — If the distance is too far between the NVR and the camera, please adjust the location of the NVR or the camera to reduce the distance. — If there are too many obstacles (such as walls, glass doors) between the NVR and the camera, please adjust the location of the NVR or the camera to reduce the obstacles.
Q3: How to add a new camera when the NVR is under stable operation?	A3: Ensure that the number of added camera has not reached the limit. Then try the following steps: <ol style="list-style-type: none">1. Ensure that the new camera is under default settings. If not, reset it first. 2. Place the new camera into the NVR and power it on. 3. The NVR will automatically detect the camera. Add the camera after you verify the camera on the pop-up window is correct. 4. Upload the camera to the camera and install the camera to the monitoring location as required.

A4: Try the following solutions: <ul style="list-style-type: none">— Ensure that the HDD is working properly. — Navigate to Configuration > Storage Management > HDD Management. — If the HDD is not detected, please disconnect the NVR first, reinstall the HDD and start up the NVR. If the HDD is under abnormal status, shut down the NVR first, reinstall the HDD and start up the NVR. If the problem persists, replace the HDD. — If the formatting fails, shut down the NVR first, replace the HDD and start up the NVR. — If the time that the recording plan is normal. Navigate to Configuration > Storage Management > Recording Schedule, ensure that the channel recording status is enabled. — The recording time and recording type have been set properly. If not, set and save according to the requirements.	
POWER	Power port. Use the included 12 V 2 A power adapter to power on the NVR.
LAN	10/100 Mbps auto-negotiation Ethernet port. Used for connecting such devices as the router and switch.
HDMI	HDMI port. Connect your monitor or TV to this port using an HDMI cable for high-definition audio and video output.
VGA port	VGA port. Connect your monitor to this port using an VGA cable for video signals.
USB 2.0 port	Used for connecting such devices as a mouse and an USB storage device.

Camera

Solid red	Initializing and starting.
Blinking red slowly	Disconnected from a 2.4 GHz Wi-Fi network.
Blinking red quickly	Connecting to the NVR.
Solid blue	Connected to the NVR.
Blinking blue slowly	Upgrading.
Blinking blue quickly	Waiting to upgrade to a 2.4 GHz Wi-Fi network.

Reset button	Only used to upgrade the firmware of the camera and does not support the format.
Micro SD card slot	Only used to upgrade the firmware of the camera and does not support the format.

Reset button	Only used to upgrade the firmware of the camera and does not support the format.
Micro SD card slot	Only used to upgrade the firmware of the camera and does not support the format.

Reset button	Only used to upgrade the firmware of the camera and does not support the format.
Micro SD card slot	Only used to upgrade the firmware of the camera and does not support the format.

Reset button	Only used to upgrade the firmware of the camera and does not support the format.
Micro SD card slot	Only used to upgrade the firmware of the camera and does not support the format.

Reset button	Only used to upgrade the firmware of the camera and does not support the format.
Micro SD card slot	Only used to upgrade the firmware of the camera and does not support the format.

Reset button	Only used to upgrade the firmware of the camera and does not support the format.
Micro SD card slot	Only used to upgrade the firmware of the camera and does not support the format.

Reset button	Only used to upgrade the firmware of the camera and does not support the format.
Micro SD card slot	Only used to upgrade the firmware of the camera and does not support the format.

Reset button	Only used to upgrade the firmware of the camera and does not support the format.
Micro SD card slot	Only used to upgrade the firmware of the camera and does not support the format.

Reset button	Only used to upgrade the firmware of the camera and does not support the format.
Micro SD card slot	Only used to upgrade the firmware of the camera and does not support the format.

Reset button	Only used to upgrade the firmware of the camera and does not support the format.
Micro SD card slot	Only used to upgrade the firmware of the camera and does not support the format.

Reset button	Only used to upgrade the firmware of the camera and does not support the format.
Micro SD card slot	Only used to upgrade the firmware of the camera and does not support the format.

Reset button	Only used to upgrade the firmware of the camera and does not support the format.
Micro SD card slot	Only used to upgrade the firmware of the camera and does not support the format.

Reset button	Only used to upgrade the firmware of the camera and does not support the format.
Micro SD card slot	Only used to upgrade the firmware of the camera and does not support the format.

Reset button	Only used to upgrade the firmware of the camera and does not support the format.
Micro SD card slot	Only used to upgrade the firmware of the camera and does not support the format.

Reset button	Only used to upgrade the firmware of the camera and does not support the format.
Micro SD card slot	Only used to upgrade the firmware of the camera and does not support the format.

Reset button	Only used to upgrade the firmware of the camera and does not support the format.
Micro SD card slot	Only used to upgrade the firmware of the camera and does not support the format.

Reset button	Only used to upgrade the firmware of the camera and does not support the format.
Micro SD card slot	Only used to upgrade the firmware of the camera and does not support the format.

Reset button	Only used to upgrade the firmware of the camera and does not support the format.
Micro SD card slot	Only used to upgrade the firmware of the camera and does not support the format.

Reset button	Only used to upgrade the firmware of the camera and does not support the format.
Micro SD card slot	Only used to upgrade the firmware of the camera and does not support the format.

Reset button	Only used to upgrade the firmware of the camera and does not support the format.
Micro SD card slot	Only used to upgrade the firmware of the camera and does not support the format.

Reset button	Only used to upgrade the firmware of the camera and does not support the format.
Micro SD card slot	Only used to upgrade the firmware of the camera and does not support the format.

Reset button	Only used to upgrade the firmware of the camera and does not support the format.
Micro SD card slot	Only used to upgrade the firmware of the camera and does not support the format.

Reset button	Only used to upgrade the firmware of the camera and does not support the format.
Micro SD card slot	Only used to upgrade the firmware of the camera and does not support the format.

Reset button	Only used to upgrade the firmware of the camera and does not support the format.
Micro SD card slot	Only used to upgrade the firmware of the camera and does not support the format.

Reset button	Only used to upgrade the firmware of the camera and does not support the format.
Micro SD card slot	Only used to upgrade the firmware of the camera and does not support the format.

Reset button	Only used to upgrade the firmware of the camera and does not support the format.
Micro SD card slot	Only used to upgrade the firmware of the camera and does not support the format.

Reset button	Only used to upgrade the firmware of the camera and does not support the format.
Micro SD card slot	Only used to upgrade the firmware of the camera and does not support the format.

Reset button	Only used to upgrade the firmware of the camera and does not support the format.
Micro SD card slot	Only used to upgrade the firmware of the camera and does not support the format.

Reset button	Only used to upgrade the firmware of the camera and does not support the format.
Micro SD card slot	Only used to upgrade the firmware of the camera and does not support the format.

Reset button	Only used to upgrade the firmware of the camera and does not support the format.
Micro SD card slot	Only used to upgrade the firmware of the camera and does not support the format.

Reset button	Only used to upgrade the firmware of the camera and does not support the format.
Micro SD card slot	Only used to upgrade the firmware of the camera and does not support the format.

Reset button	Only used to upgrade the firmware of the camera and does not support the format.
Micro SD card slot	Only used to upgrade the firmware of the camera and does not support the format.

Reset button	Only used to upgrade the firmware of the camera and does not support the format.
Micro SD card slot	Only used to upgrade the firmware of the camera and does not support the format.

Reset button	Only used to upgrade the firmware of the camera and does not support the format.
Micro SD card slot	Only used to upgrade the firmware of the camera and does not support the format.

Reset button	Only used to upgrade the firmware of the camera and does not support the format.
Micro SD card slot	Only used to upgrade the firmware of the camera and does not support the format.

Reset button	Only used to upgrade the firmware of the camera and does not support the format.
Micro SD card slot	Only used to upgrade the firmware of the camera and does not support the format.

Reset button	Only used to upgrade the firmware of the camera and does not support the format.
Micro SD card slot	Only used to upgrade the firmware of the camera and does not support the format.

Reset button	Only used to upgrade the firmware of the camera and does not support the format.
Micro SD card slot	Only used to upgrade the firmware of the camera and does not support the format.

Reset button	Only used to upgrade the firmware of the camera and does not support the format.
Micro SD card slot	Only used to upgrade the firmware of the camera and does not support the format.

Reset button	Only used to upgrade the firmware of the camera and does not support the format.
Micro SD card slot	Only used to upgrade the firmware of the camera and does not support the format.

Reset button	Only used to upgrade the firmware of the camera and does not support the format.
Micro SD card slot	Only used to upgrade the firmware of the camera and does not support the format.

Reset button	Only used to upgrade the firmware of the camera and does not support the format.
Micro SD card slot	Only used to upgrade the firmware of the camera and does not support the format.

Reset button	Only used to upgrade the firmware of the camera and does not support the format.
Micro SD card slot	Only used to upgrade the firmware of the camera and does not support the format.

Reset button	Only used to upgrade the firmware of the camera and does not support the format.
Micro SD card slot	Only used to upgrade the firmware of the camera and does not support the format.

Reset button	Only used to upgrade the firmware of the camera and does not support the format.
Micro SD card slot	Only used to upgrade the firmware of the camera and does not support the format.

Reset button	Only used to upgrade the firmware of the camera and does not support the format.
Micro SD card slot	Only used to upgrade the firmware of the camera and does not support the format.

Reset button	Only used to upgrade the firmware of the camera and does not support the format.
Micro SD card slot	Only used to upgrade the firmware of the camera and does not support the format.

Reset button	Only used to upgrade the firmware of the camera and does not support the format.
Micro SD card slot	Only used to upgrade the firmware of the camera and does not support the format.

Reset button	Only used to upgrade the firmware of the camera and does not support the format.
Micro SD card slot	Only used to upgrade the firmware of the camera and does not support the format.

Reset button	Only used to upgrade the firmware of the camera and does not support the format.
Micro SD card slot	Only used to upgrade the firmware of the camera and does not support the format.

Reset button	Only used to upgrade the firmware of the camera and does not support the format.
Micro SD card slot	Only used to upgrade the firmware of the camera and does not support the format.

Reset button	Only used to upgrade the firmware of the camera and does not support the format.
Micro SD card slot	Only used to upgrade the firmware of the camera and does not support the format.