

Color ideas



LED color technology
16 million colors

User's Manual

Table of Contents

| | |
|---------------------------------------|---|
| Table of Contents..... | 2 |
| Important Safety Precautions..... | 3 |
| Cleaning and Maintenance..... | 3 |
| Replacing Remote Control Battery..... | 4 |
| Product Specification..... | 4 |
| What's in the Box..... | 5 |
| Identifying the Parts..... | 6 |
| How to Use Your Color Ideas..... | 6 |
| Power on/off, Auto Run Mode | 6 |
| Power on/off..... | 6 |
| Auto Run Mode..... | 6 |
| Adjust Colors..... | 7 |
| Dimming | 7 |
| Color Temperature..... | 7 |
| Frequently Asked Questions..... | 7 |

Important Safety Precautions

Always follow these basic safety precautions when using your Color Ideas. This will reduce the risk of fire, electric shock, and injury.

Warning: To reduce the risk of fire or shock hazard, do not expose this product to rain or moisture.

Warning: To prevent the risk of electric shock, do not remove the cover. There are no user-serviceable parts inside. Refer all servicing to qualified personnel.

- ◆ Color Ideas is for indoor use only.
- ◆ Unplug Color Ideas before performing care and maintenance.
- ◆ Keep your Color Ideas out of direct sunlight and heat sources.
- ◆ Protect the power cord. Route power cords so that they are not likely to be walked on or pinched by items placed on or against them. Pay particular attention to the point where the cord attaches to Color Ideas.
- ◆ Only use the AC adapter included with Color Ideas. Using any other power adapter will void your warranty.
- ◆ Unplug the power cord from the outlet when the unit is not in use.

Cleaning and Maintenance

It is recommended to use a soft, non-abrasive cloth such as a camera lens cloth to clean the outer surface of Color Ideas.

Replacing Remote Control Battery

If the remote control stops working or works improperly, replace the battery with a new one.



1. Open the battery cover of the remote control by sliding the button at the back.
2. Insert 3 batteries (+and - as indicated)
3. Insert the battery cover back to the remote control.

Warning

Battery may explode if mistreated. Do not recharge, disassemble or dispose of in fire

Notes

- ♦ When the battery becomes weak, the operating distance of the Remote Control may shorten, or the Remote Control may not function properly. In this case, replace the battery with 3 proper batteries.
- ♦ Dispose the used batteries as specified by the local authorities.
- ♦ Do not leave the Remote Control in a very hot and humid place.
- ♦ Incorrect use of the battery may cause leaking and corrosion.
 - When the Remote control will not be used for a long period of time, remove the battery from the remote control to prevent leaking and corrosion.
 - Incorrectly inserting, shorting, dismantling, or heating the battery, or throwing it into a fire may cause the battery to rupture and leak.

Product Specification

- 1Wx4 LEDs with 16 million colors
- Adjust 16 million different Colors, Brightness and Dim by remote controller
- Fashion Design
- Dimension : 180 x145x145mm
- AC /DC Adaptor: 100~240V,50-60HZ,4V/1.5A

What's in the Box



Identifying the Parts



How to Use Your Color Ideas



Place Color Ideas at this stand with a selected direction which you wish.



Power on/off , Auto Run Mode

Power on/off

- Turn Color Ideas on/off by touching the power button.
- Color Ideas will remember the last color setting.

Auto Run Mode

- Touching the power button for 3 seconds to start the auto run mode while the color will change automatically.
- To switch to normal mode, please click any button.

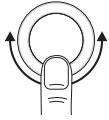

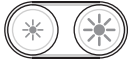

Adjust Colors

Move your finger over the color wheel to select the desired color.



Dimming

Increase () or decrease () the brightness of light by dimming button.



Color Temperature

Move your finger from left to right over the color temperature bar to turn LEDs at white.

Frequently Asked Questions

Q: Why does the Color Ideas can not provide light?

A: Firstly, check the batteries in the remote control. Secondly, check the connection of power cord. Thirdly, check AC/DC Adapter.

Q: Why does the Color Ideas can not adjust dimming or color temperature or can not respond quickly to the remote control?

A: Please follow these steps: check the batteries in the remote control or move Color Ideas away from the wireless access point.

FCC warning statement

This equipment has been tested and found to comply with the limits for a Class B digital device, pursuant to part 15 of the FCC Rules. These limits are designed to provide reasonable protection against harmful interference in a residential installation. This equipment generates, uses and can radiate radio frequency energy and, if not installed and used in accordance with the instructions, may cause harmful interference to radio communications. However, there is no guarantee that interference will not occur in a particular installation. If this equipment does cause harmful interference to radio or television reception, which can be determined by turning the equipment off and on, the user is encouraged to try to correct the interference by one or more of the following measures:

- Reorient or relocate the receiving antenna.
- Increase the separation between the equipment and receiver.
- Connect the equipment into an outlet on a circuit different from that to which the receiver is connected.
- Consult the dealer or an experienced radio/TV technician for help

Changes or modifications not expressly approved by the party responsible for compliance. could void the user's authority to operate the equipment.