

# Installation and Operating Instructions

flinkey  CAN



WITTE Velbert GmbH + Co KG Höferstr. 3-15, D 42551 Velbert GERMANY		
Revision	Datum	Bearbeiter
1.0	09.11.2022	Weber/ Goldschmidt

# Contents

- 1 General .....1-1
  - 1.1 Explanation of symbols .....1-1
  - 1.2 Limitation of liability ..... 1-2
  - 1.3 Service ..... 1-2
- 2 Safety information ..... 2-3
- 3 Product description / Technical data..... 3-1
  - 3.1 Intended use..... 3-1
  - 3.2 General Description ..... 3-1
  - 3.3 Technical data ..... 3-4
  - 3.4 Additional hardware ..... 3-4
- 4 Transport..... 4-1
  - 4.1 Symbols on the packaging ..... 4-1
  - 4.2 Transport inspection ..... 4-1
  - 4.3 Packaging ..... 4-1
  - 4.4 Storage ..... 4-2
- 5 Interface ..... 5-1
  - 5.1 CAN Interface ..... 5-1
  - 5.2 Bluetooth ..... 5-1
  - 5.3 NFC interface ..... 5-1
  - 5.4 RF Sniffer ..... 5-2
- 6 Installation ..... 6-1
  - 6.1 Unpacking ..... 6-1
  - 6.2 Installation instructions KPC (Optional)..... 6-1
  - 6.3 Installation instructions flinkey CAN ..... 6-4

<b>7</b>	<b>Operation</b> .....	<b>7-1</b>
<b>8</b>	<b>Maintenance</b> .....	<b>8-2</b>
<b>8.1</b>	<b>Cleaning</b> .....	<b>8-2</b>
<b>8.2</b>	<b>Inspection</b> .....	<b>8-2</b>
<b>8.3</b>	<b>Troubleshooting</b> .....	<b>8-2</b>
<b>9</b>	<b>Disposal of the Product</b> .....	<b>9-1</b>
<b>10</b>	<b>Declaration of Conformity</b> .....	<b>10-1</b>
<b>11</b>	<b>FCC</b> .....	<b>11-1</b>
<b>12</b>	<b>Cal Prop 65</b> .....	<b>12-1</b>
<b>13</b>	<b>ISED</b> .....	<b>13-1</b>



# 1 General

<b>NOTICE</b>	
	<p>These Instructions are an integral part of the flinke CAN and must be kept in the immediate vicinity at a place accessible by personnel at all times. Personnel must have carefully read and understood these Instructions prior to beginning work. Prerequisite for safe work is the compliance with all safety information and instructions given in these Installation and Operating Instructions.</p> <p>In addition, the local accident prevention regulations and general safety regulations apply to the range of application of the flinke CAN.</p>

Illustrations contained in these Instructions are intended to provide general understanding and may differ from the actual design of the system.

## 1.1 Explanation of symbols

The safety information in these Instructions is marked with symbols. A safety information is precluded by a signal word which expresses the severity of a danger. To avoid personal injury and damage to physical assets, the safety information must be complied mandatorily and caution is required.



	<p><b>⚠ DANGER</b></p>
	<p>... indicates an imminently hazardous situation which, if not avoided, will result in death or serious injury.</p>
	<p><b>⚠ WARNING</b></p>
	<p>... indicates a potentially hazardous situation which, if not avoided, will result in serious injury.</p>
	<p><b>⚠ CAUTION</b></p>
	<p>... indicates a potentially hazardous situation which, if not avoided, may result in minor injury or damage to physical assets.</p>



Tips and recommendations

<b>NOTICE</b>	
<p>... highlights tips and recommendations as well as information required for efficient and trouble-free operation.</p>	

Special safety information

The symbols below are used in safety information to draw the attention to special hazards:

	<p>... indicates general hazards. Failure to comply with the safety information may result in serious injury or death.</p>
	<p>... indicates hazards resulting from electricity. Failure to comply with the safety information may result in serious injury or death.</p>
	<p>... indicates hazards resulting from moving parts. Failure to comply with the safety information may result in serious injury.</p>

	<p>... indicates hazards resulting from hot surfaces. Failure to comply with the safety information may result in serious injury.</p>
	<p>... indicates hazards resulting from cold surfaces. Failure to comply with the safety information may result in serious injury.</p>

## 1.2 Limitation of liability

All data and information given in these Instructions were compiled in accordance with the applicable standards and regulations, the state of the art as well as our extensive knowledge and experience. The manufacturer will not be liable for any damage resulting from:

- Non-compliance with the Instructions
- Improper use
- Employment of unqualified personnel
- Unauthorised modifications
- Technical alterations
- Use of spare parts which have not been approved

In case of special designs, utilisation of additional order options or because of the most recent technical changes the actual scope of supply may deviate from the explanations and presentations described here.

The obligations agreed under the supply contract, the General Terms and Conditions as well as the manufacturer's delivery conditions and the statutory regulations valid at the time of contract conclusion shall apply.

We reserve the right to make technical changes for the purposes of improving the performance characteristics and further development.

These Instructions are protected by copyright.

Transfer of these Instructions to third parties, any reproductions or copies – including excerpts – as well as the utilisation and/or disclosure of their contents other than for internal use are not permitted without the manufacturer's written consent. Infringement shall result in the obligation to pay damages. This shall not affect any further claims.

## 1.3 Service

flinkey  
 WITTE Velbert GmbH & Co. KG  
 Höferstr. 3-15  
 D 42551 Velbert  
 Germany

T: 00 800 99 0000 33  
[service@flinkey.com](mailto:service@flinkey.com)  
[www.flinkey.com](http://www.flinkey.com)

QR Code

## 2 Safety information

<b>NOTICE</b>	
	<p>Please take the time to read the general safety instructions. Follow all instructions. This will avoid fire, explosions, electric shocks or other hazards that may result in damage to property and/or severe or fatal injuries.</p> <p>Please read all safety information and instructions. The manufacturer is not liable for cases of material damage or personal injury caused by incorrect handling or non-compliance with the safety instructions. In such cases, the warranty will be voided. Keep all safety information and instructions for future reference and pass them on to subsequent users of the system.</p>

<b>NOTICE</b>	
<p>This product does not contain any user-serviceable parts. Configuration, servicing, and repairs must only be made by an authorized reseller or installer. Do not attempt to open, modify or repair the flinkey CAN. Do not drop, puncture, break or expose to high pressure. Alterations to the products and technical modifications are not permitted.</p>	

	<b>⚠ WARNING</b>
<p>Installation and maintenance work as well as functional checks of the device must be performed by skilled personnel who, based on their training, are appropriately qualified for this work.</p>	

	<b>⚠ WARNING</b>
<p>Risk of injury! Use the system within the specified performance limits. Do not expose the system to fire, explosions or other hazards. Never touch the flinkey CAN or the components with wet hands. The system must be stored in a dry place between -40°C and +85°C. For detailed information see chapter 4.</p>	

	<b>⚠ WARNING</b>
<p>Risk of frostbite! If the box was stored in the temperature range from -40..0°C for a long time there is a risk of frostbite! Only handle the box with suitable gloves!</p>	

	<b>⚠ WARNING</b>
<p>Risk of burn! Always protect the flinkey CAN from direct sunlight and never place the flinkey CAN in direct sun light. To avoid overheating, do not cover the device, do not use near heat sources or in direct sunlight and only at ambient temperatures of between -40°C and +85°C.</p>	

	<p><b>⚠ WARNING</b></p>
	<p>Risk of injury! Without sufficient fixing the flinkey CAN can cause hazards for the vehicle driver or passengers in case of a full brake application (i.e. head injuries). Make sure that the CAN Box does not cause any risks to the drivers or passengers. Always make sure the flinkey CAN is positioned safely in the vehicle.</p>

	<p><b>⚠ WARNING</b></p>
	<p>Risk of injury! Do not use electrical equipment if you are lacking in concentration or awareness, or are under the influence of drugs, alcohol or medication. Even a moment of inattentiveness can lead to serious accidents and injuries when using electrical equipment. Be vigilant at all times, and always be careful with what you are doing.</p>

	<p><b>⚠ CAUTION</b></p>
	<p>This system is not intended for use by persons (including children) with restricted physical, sensory or intellectual capability or lack of experience and/or knowledge, unless they are supervised by a person who is responsible for their safety or provides them with instructions on how to use the system. Children should be supervised in order to ensure that they do not play with the system.</p>

	<p><b>⚠ WARNING</b></p>
	<p>Risk of injury! There is a risk of crushing fingers while closing the drawer of the box. Be vigilant at all times, and always be careful with what you are doing!</p>

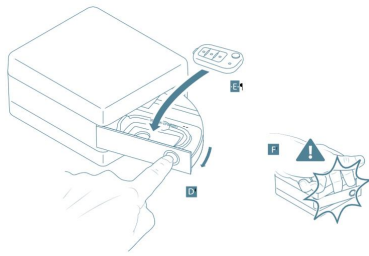

<p><b>NOTICE</b></p>
<p>The key bed in the keyfob drawer is designed to match the intended keyfob only. Only place the original and intended keyfob in the keyfob drawer and make sure to place it in the correct position.</p>

### 3 Product description / Technical data

#### 3.1 Intended use

The WITTE Digital flinkey CAN is intended to be used as a smart actuator to access passenger vehicles, commercial vehicles and transporters. The task of the box is to lock or unlock a motor vehicle after receiving a corresponding command via CAN interface by cable from a partner device.

	<b>⚠ WARNING</b>
	The products may only be used according to the instructions as described in this manual. All use other than described in this manual is seen as unintended use.

	<b>⚠ CAUTION</b>
	Any changes or modifications to this device not explicitly approved by WITTE DIGITAL could void the user's authority to operate the flinkey CAN.

#### 3.2 General Description

The WITTE Digital flinkey CAN is designed as a smart actuator to operate vehicle keys with a central locking function and thus to lock or unlock the vehicle.



Fig. 1:flinkey CAN with open drawer (example)

The vehicle key can be fed to the flinkey CAN via a drawer, and the drawer itself can be locked or unlocked during operation.





Fig. 2: flinkey CAN bottom side (example)

The box uses two camshaft-driven drag levers that can operate the key buttons for locking or unlocking the vehicle via central locking. This makes it possible to implement different forms of key transfer, according to the functionality of the vehicle (steering wheel lock vs keyless start).

The combination of the key receptacle (key bed) and the two towing levers must be adapted to the shape of the vehicle key.

**NOTICE**  
A later adaptation of the flinkey CAN is impossible due to the secure installation.  
Supported key variants can be requested by WITTE digital.

The key bed has an LED backlight, this serves as a comfort function and as status feedback.



Fig. 3: flinkey CAN drawer with keybed (example)

During operation, the flinkey CAN receives well-defined commands in a protocol and performs corresponding operations. This communication is wired (4 wires, +; -; 2 x data) and corresponds to the CAN-BUS standard. (see chapter 5).

In addition to the electromechanical infrastructure, an NFC and BLE gateway are also available, which can be used as a communication interface by the partner device.

Furthermore, an RF sniffer is installed to detect the emitted radio signals of the activated vehicle key.

# Structure

## flinkey CAN Integration

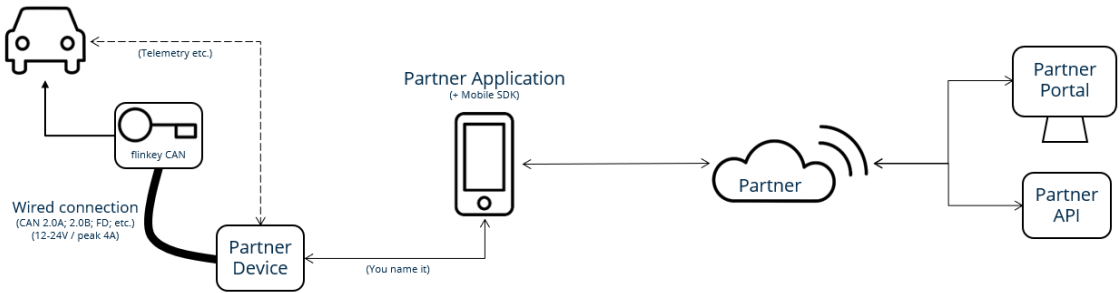



Fig. 4:Communication / data structure

### 3.3 Technical data

Product Design	flinkey CAN 8.0
Trade mark	flinkey
Year of production	2022
Manufacturer	WITTE-Velbert GmbH & Co. KG Höferstr. 3-5 D-42551 Velbert
Total weight	App. 620 g
Dimensions	164 mm x 139 mm x 61 mm
Operating temperature	-40 °C .. +85 °C Rel. air humidity 50% at 60 °C
Power supply	12 VDC neg Ground
Current rating	
Connector	TE-1418888-5 for more details s. chapter 5
Degree of protection	IP30
Protection class	III
Radio technology	BLE (Bluetooth Low energy) BLE 5.1 2.4 GHz ISM Band (2.400 MHz – 2483,5 MHz) Max.  NFC 13.56 MHz / max 340 mW IOS7 IEC 14443 A (or B)  RF Sniffer 315 MHz, 434 MHz und 868 MHz (only functional checks)

	<b>⚠ WARNING</b>
	<p>Risk of hight current! The installation of a 5A Fuse in the power supply for overcurrent protection or a similar device is mandatory.</p>

### 3.4 Additional hardware

A KPC adapter (Keyfob Power Control) is available as an optional extension; this replaces the battery of the vehicle key and enables a targeted power supply. The installation is described in chapter 6.2.

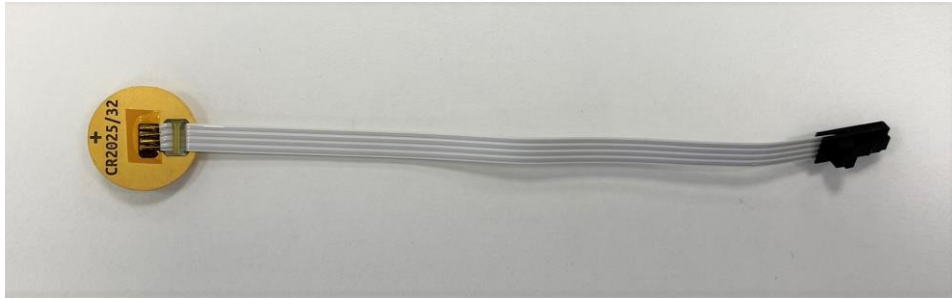

Fig. 5:Keyfob with KPC (example)





Fig. 6:Keyfob with KPC (example)

**NOTICE**

The KPC adapter can only be used for suitable keyfobs.  
Please contact WITTE digital to check if a KPC adapter is available for the keyfob.  
(s. chapter 1.3)

## 4 Transport

### 4.1 Symbols on the packaging

	<p><b>Fragile</b> Marks packages with fragile or sensitive contents. Handle package with care, do not drop or expose to shocks.</p>
	<p><b>Keep dry</b> Keep package dry.</p>

### 4.2 Transport inspection

Check the consignment for completeness and transport damage immediately upon receipt. In case of visible transport damage (defective packaging i.e.) please proceed as follows:

1. Refuse delivery or accept delivery subject to reservation.
2. Note scope of damage on the transport documents or on the transporting agent's delivery note; if applicable, document damage by taking pictures. Confirmation by forwarding agent.
3. A damage has to be reported within 24 hours after delivery in writing (if possible, by fax) or orally (by phone) followed by a written confirmation.
4. The damage report must be sent to the insurance company within this period as well.

**NOTICE**  
Any defect shall be queried as soon as it has been recognised. Claims for damages can only be made within the applicable complaint period. Please observe the insurance conditions!

### 4.3 Packaging

The individual packages have been packed according to the transport conditions to be expected. For packaging only environmentally friendly materials have been used. The packaging serves to protect the individual components from transport damage, corrosion and other damage until the time of installation. Therefore, please do not destroy the packaging and only remove it shortly before installation.

**NOTICE**  
Environmental damage due to improper disposal!  
Packaging materials are valuable raw materials and may be used further or processed and recycled in many cases.

Therefore:

- Dispose of packaging material in an environmentally friendly manner.
- Please observe the applicable local regulations for disposal. If required, call in a specialist company for disposal.

#### 4.4 Storage

The packages must be stored under the conditions below:

- Do not store outdoors.
- Store dry and free from dust.
- Do not expose to aggressive media.
- Protect from solar radiation.
- Avoid mechanical shock and vibration.
- For storage conditions (temperature / air humidity) see chapter 3.3

## 5 Interface

The flinkey CAN is connected via cable with the partner device, the following section describes the basics of the interface

### 5.1 CAN Interface

#### **Main Connector pinout**

Pin 1	Ground (negative)
Pin 2	Supply voltage (positive)
Pin 3	CAN-L (CAN bus low pin)
Pin 4	CAN_H (CAN Bus high pin)
Pin 5	Reserved
Pin 6	Reserved
Note: Pin number marking clearly visible inside receptable-	

#### **CAN bus**

Description	Not galvanically isolated, referred to ground (pin1)
Data rate	Up to 5Mbit/s
Features	CAN FD, bus wake-up

### 5.2 Bluetooth

Specification	BLE 5.1
Operating frequencies	2.4 GHz
Compatibility	Bluetooth low energy 5.1 and earlier LE specifications

BLE antenna type	Integrated
BLE antenna gain	2.11 dBi
BLE frequency range	2400 to 2483.5 MHz
BLE maximum output power	1 dBm
BLE modulation type	Coded, GFSK
BLE data rate	Up to 2 Mbit/s

### 5.3 NFC interface

Operating frequency	13.56 MHz
Possible operating modes	R/W ISO/IEC 14443A/MIFARE and Feli scheme R/W ISO/IEC 14443B
Antenna location	Inside the drawer, below the key fob, above fuel card

Antenna wire diameter	PCB trace 0.5 mm wide 35 $\mu$ m thick
Antenna coil length	566 mm
Maximum power to antenna/coil	0.34 W
Ton (1 cycle)	180ms
Toff (1 cycle)	700ms
Duty cycle	20.45% (max).
Events per 6 minute period (max)	120

### 5.4 RF Sniffer

Operating frequency	315 MHz, 434 MHz, 868 MHz
---------------------	---------------------------



## 6 Installation

	<b>⚠ WARNING</b>
	Risk of injury! Read all safety information in the chapter Safety Information before installing the product.

	<b>⚠ WARNING</b>
	The flinkey CAN is pre-assembled by the manufacturer for a specific keyfob type. This settings couldn't be adjusted after the box left the manufacturer's factory. The box can't be opened without destroying it.

	<b>⚠ WARNING</b>
	Risk of injury! Installation and maintenance work as well as functional checks of the product must be performed by skilled personnel who, based on their training, are appropriately qualified for this work. All local regulations must be followed.

### 6.1 Unpacking

<b>NOTICE</b>
Check the product for any heavy damage before installation. If there is any visible damage, a strong odor, or excessive overheating of components, unplug all the connections immediately and stop using the system.

Make sure the packaging contains the following items:

- flinkey CAN
- Hook-and-loop fastener (2x3 strips)
- Quick Start Guide
- Cable (optional, depending on partner)

### 6.2 Installation instructions KPC (Optional)

<b>NOTICE</b>
The KPC adapter can only be used for suitable keyfobs.

The following steps must be followed during assembly:

1. The keyfob is to be opened in accordance with to the manufacturer's instructions.

- 2. Remove the manufacturer's battery from the keyfob.
- 3. Choose the correct KPC for the replacement. (please contact manufacturer)
- 4. Place the corresponding KPC in the batterie position:

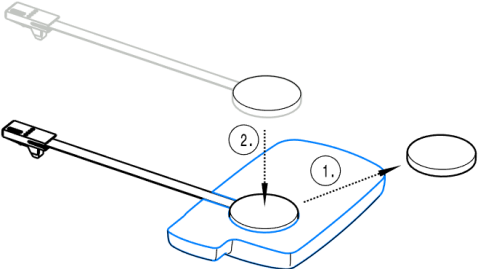

- 5. Close the keyfob with the upper part and bend the cable in the direction as seen in the following figure:

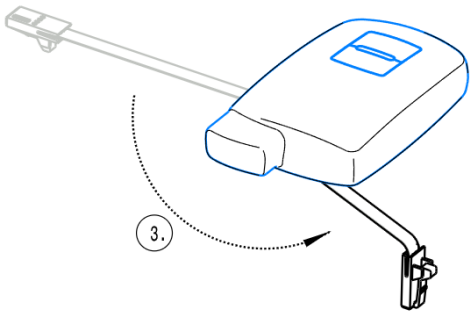

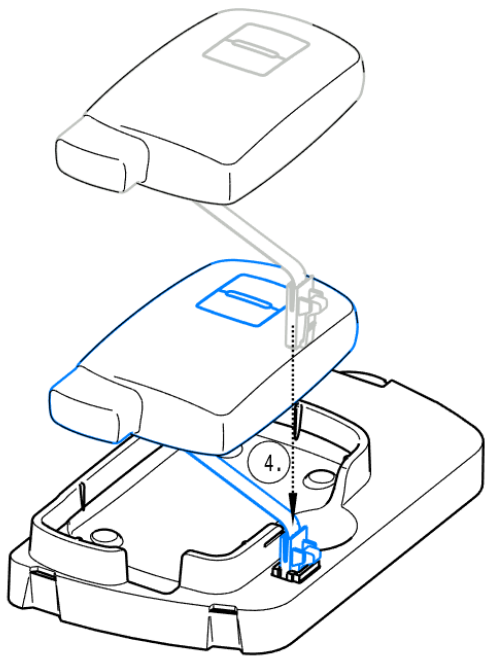

- 6. Connect the plug to the socket in the keybed of the drawer of the box. Then place the keyfob in the keybed.

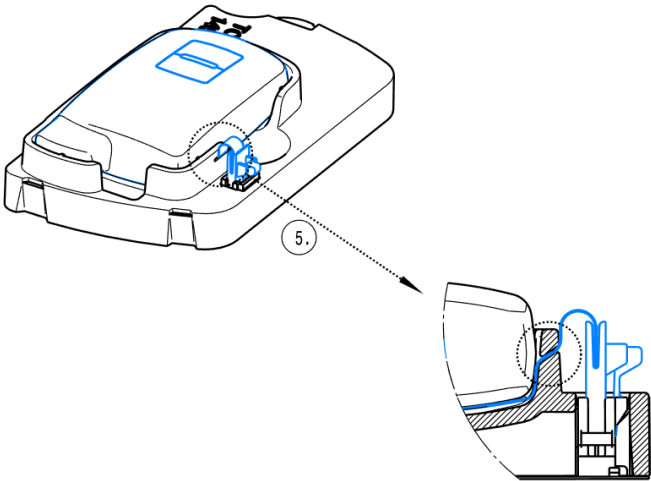

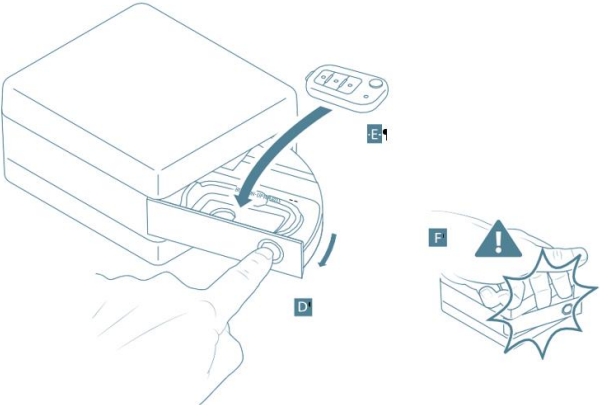

7. Then close carefully the drawer of the box. While closing, be careful not to damage any cables! For further installation, follow the next chapter.



	<b>⚠ WARNING</b>
	Risk of injury! There is a risk of crushing fingers while closing the drawer of the box. Be vigilant at all times, and always be careful with what you are doing!

	<b>⚠ WARNING</b>
	If there are problems with the positioning/ cable connection, please contact our service!

### 6.3 Installation instructions flinkey CAN

	<b>⚠ WARNING</b>
	Risk of injury! Without sufficient fixing the flinkey CAN can cause hazards for the vehicle driver or passengers in case of a full brake application (i.e. head injuries). Make sure that the CAN Box does not cause any risks to the drivers or passengers. Always make sure the flinkey CAN is positioned safely in the vehicle.

Since the flinkey CAN is connected to the partner device by cable and, depending on the type of vehicle, it is necessary to remove the vehicle key, the possible installation positions are limited. The following installation positions are recommended:

- in the glove compartment
- under the drivers' seat
- under the passengers seat
- In the boot

	<b>⚠ WARNING</b>
	Risk of burn! Always protect the flinkey CAN from direct sunlight and never place the flinkey CAN in direct sun light. To avoid overheating, do not cover the device, do not use near heat sources or in direct sunlight and only at ambient temperatures of between -40°C and +85°C.

	<b>⚠ WARNING</b>
	Risk of frostbite! If the box was stored in the temperature range from -40..0°C for a long time there is a risk of frostbite! Only handle the box with suitable gloves!

The flinkey CAN Box can be affixed in the car with the hook-and-loop fasteners, to protect the box from moving when the car is being driven. The steps below describe how to affix both the loop and hook strips. Optionally, you can also use the vehicle floor as loops. In that case, remove the loop strip.

<b>NOTICE</b>
Make sure to place the hook-and-loop strips at room temperature. Make sure that the surface is clean and dry.

To affix the flinkey CAN:

1. Clean the surface of the flinkey CAN Box with a soft, clean, lint-free cloth dampened with a mild detergent solution or water.

2. Make sure the hook-and-loop strips are attached to each other.

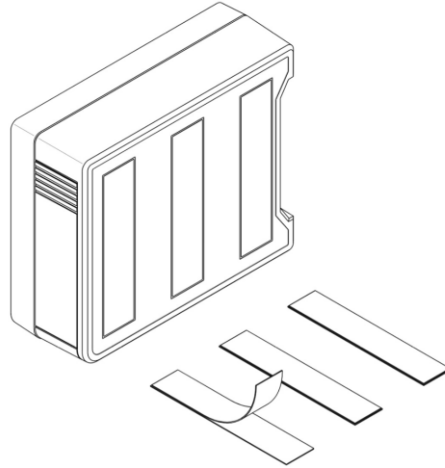

3. Remove the liners from the hook strips.
4. Place the hook strips at an equal distance on the bottom of the flinkey CAN

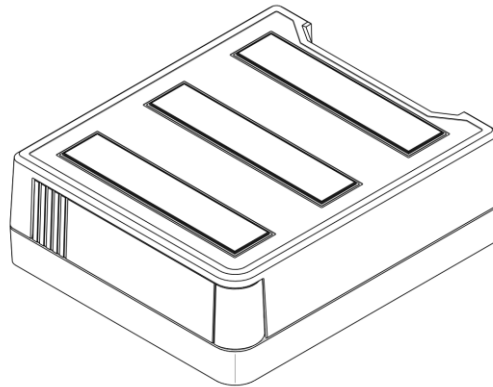

5. Remove the liners from the loop strips.

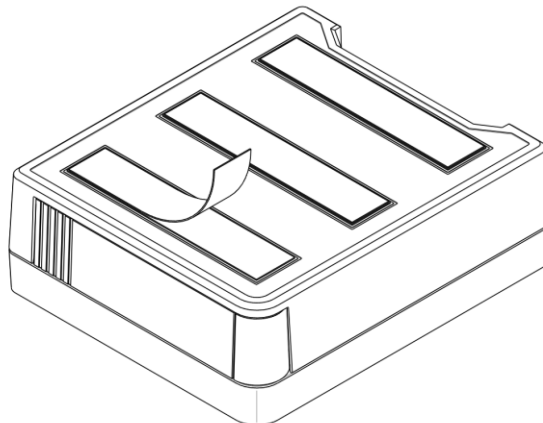

6. Place the flinkey CAN on the surface of the car where you want to affix the box (e.g. carpet, fleece or floor). Press well to make sure the strips stick to the surface.

#### **NOTICE**

In case of malfunctions or deviations please contact the manufacturer's service (see Chapter 1.3)

## 7 Operation

	<b>⚠ WARNING</b>
	Any use of the device exceeding the intended use and/or any other use is regarded as improper use and may lead to dangerous situations.

	<b>⚠ WARNING</b>
	Risk of injury! There is a risk of crushing fingers while closing the drawer.

	<b>⚠ WARNING</b>
	Risk of burn! Always protect the flinkey CAN from direct sunlight and never place the flinkey CAN in direct sun light.  To avoid overheating, do not cover the device, do not use near heat sources or in direct sunlight and only at ambient temperatures of between -40°C and +85°C.

	<b>⚠ WARNING</b>
	Risk of frostbite! If the box was stored in the temperature range from -40..0°C for a long time there is a risk of frostbite! Only handle the box with suitable gloves!

The key bed in the keyfob drawer is designed to match the intended keyfob only. Only place the original and intended keyfob in the keyfob drawer and make sure to place it in the correct position.

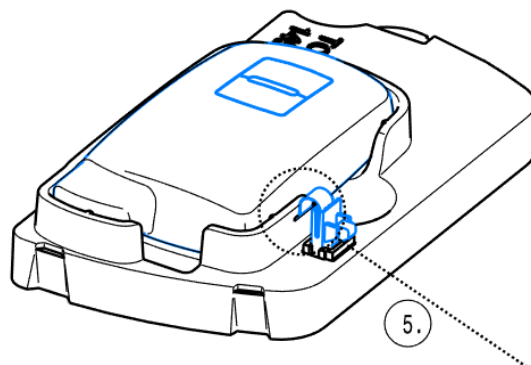

## 8 Maintenance

	<b>⚠ WARNING</b>
	<p>This product does not contain any user-serviceable parts. The flinkey CAN can't be opened without destroying the enclosure. Configuration, servicing, and repairs must only be made by an authorized reseller or installer.</p>

	<b>⚠ WARNING</b>
	<p>Risk of injury! Without sufficient fixing the flinkey CAN can cause hazards for the vehicle driver or passengers in case of a full brake application (i.e. head injuries). Make sure that the CAN Box does not cause any risks to the drivers or passengers. Always make sure the flinkey CAN is positioned safely in the vehicle.</p>

### 8.1 Cleaning

	<b>⚠ CAUTION</b>
	<p>Do not use alcohols (e.g. spirits) or chemical cleansers and solvents as these can damage the plastic components.</p>

- Clean the box at least 1x / month
- Always use a soft, clean, lint-free cloth. Clean the box using a cloth dampened with a mild detergent solution or water.

### 8.2 Inspection

Depending on the position of the installation, the box and its components (cable, connector, housing) should be inspected regularly for any kind of damages.

### 8.3 Troubleshooting

<b>NOTICE</b>
<p>In case of malfunctions or deviations please contact the manufacturer's service (see Chapter 1.3)</p>

## 9 Disposal of the Product

If no agreements have been made for return or disposal, have the product and its component recycled:

- Scrap metals.
- Recycle plastic elements.
- Sort and dispose of other component parts according to their material properties.

### NOTICE

Environmental damage due to improper disposal!  
Electronic waste, electronic components, lubricants and other consumables are subject to special waste treatment and may only be disposed of by competent firms! Please inform manufacturer's after sales service.

The local authority or certified waste management companies will provide information on environmentally sound disposal.



The symbol on the product, the accessories or packaging indicates that this device must not be treated as unsorted municipal waste, but must be collected separately! Dispose of the device via a collection point for the recycling of waste of electrical and electronic equipment if you live within the EU and in other European countries that operate separate collection systems for waste of electrical and electronic equipment.

By disposing of the device in the proper manner, you help to avoid possible hazards to the environment and public health that could otherwise be caused by improper treatment of waste equipment. The recycling of materials contributes to the conservation of natural resources. Therefore do not dispose of your old electrical and electronic equipment with the unsorted municipal waste.



The outer packaging is made of environmentally friendly materials, which may be disposed through your local recycling facilities. By disposing of the packaging and packaging waste in the proper manner, you help to avoid possible hazards for the environment and public health. The symbol on the outer packaging indicates that the packaging is made of PAP.



## 10 Declaration of Conformity

Hereby, WITTE Automotive GmbH declares that the flinkey CAN is in compliance with the Directives 2014/30/EU and 2011/65/EU. The full text of the EU declaration of conformity is available at the following internet address: [www.witte.digital](http://www.witte.digital)

The flinkey CAN has an ECE Approval regard to Regulation No. 10 issued by the KBA (Approval N° E1\*10R06\*XXXX).

## 11 FCC

This equipment complies with FCC radiation exposure limits set forth for an uncontrolled environment. This equipment should be installed and operated with minimum distance 20cm between the radiator and your body.

**Note:**

This equipment has been tested and found to comply with the limits for a Class B digital device, pursuant to part 15 of the FCC Rules. These limits are designed to provide reasonable protection against harmful interference in a residential installation. This equipment generates, uses and can radiate radio frequency energy and, if not installed and used in accordance with the instructions, may cause harmful interference to radio communications. However, there is no guarantee that interference will not occur in a particular installation. If this equipment does cause harmful interference to radio or television reception, which can be determined by turning the equipment off and on, the user is encouraged to try to correct the interference by one or more of the following measures:

- Reorient or relocate the receiving antenna.
- Increase the separation between the equipment and receiver.
- Connect the equipment into an outlet on a circuit different from that to which the receiver is connected.
- Consult the dealer or an experienced radio/TV technician for help.

## 12 Cal Prop 65

Connector

	<p><b>WARNING</b> This product can expose you to chemicals including Bisphenol A which is known to the State of California to cause reproductive harm. For more information go to <a href="http://www.P65Warnings.ca.gov">www.P65Warnings.ca.gov</a>.</p>
---	---

## 13 ISED

This device contains licence-exempt transmitter(s)/receiver(s) that comply with Innovation, Science and Economic Development Canada's licence-exempt RSS(s). Operation is subject to the following two conditions:

This device may not cause interference.

This device must accept any interference, including interference that may cause undesired operation of the device.

Le présent appareil est conforme aux CNR d'ISDE Canada applicables aux appareils radio exempts de licence. L'exploitation est autorisée aux deux conditions suivantes: (1) l'appareil ne doit pas produire de brouillage, et (2) l'appareil doit accepter tout brouillage radioélectrique subi, même si le brouillage est susceptible d'en compromettre le fonctionnement

Copyright © 2022 by WITTE Digital

All rights reserved. No part of this publication may be reproduced, distributed, or transmitted in any form or by any means, including photocopying, recording, or other electronic or mechanical methods, without the prior written permission of the publisher.

For permission requests, write to the publisher, addressed “Attention: Permissions Coordinator,” at the address below.

WITTE Digital

WITTE-Velbert GmbH & Co. KG

Höferstraße 3-15

42551 Velbert Germany

T: 00 800 99 0000 33

[service@witte.digital](mailto:service@witte.digital) [www.witte.digital](http://www.witte.digital)

[service@flinkey.de](mailto:service@flinkey.de) [www.flinkey.de](http://www.flinkey.de)

Manual Version 1.0

Publication date: July 2022

---