

8. LISTENING TO MUSIC (PLAY & CONTROL)

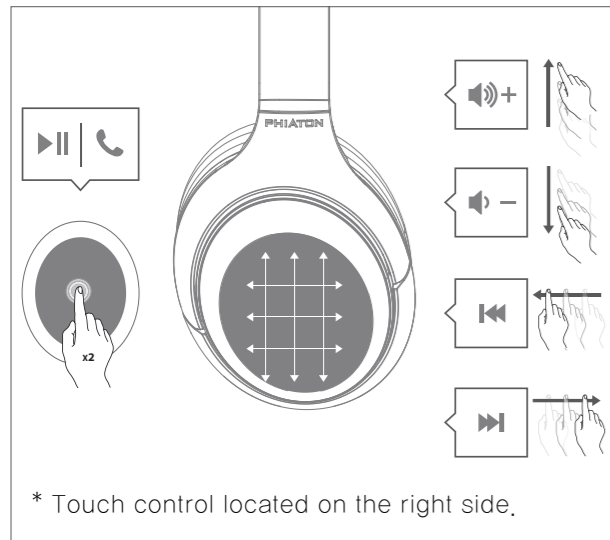

- 1) Playing Music
 - Double tap touch panel or Press the POWER button for about 1 second to play music from the 'Bluetooth Device'
 - While music is playing, double tap touch panel or Press the Power button for about 1 second to pause the playing music. The music will be played from the paused point when playing music again.

- * SBC(Sub Band Codec) is default audio codec installed for any 'Bluetooth Device'.
- * aptX and AAC are high quality audio codec.

2) Controlling Volume and Using Seek

- Sweep the touch panel to top (Vol +) / bottom (Vol-) to control the volume.
- Sweep the touch panel to forward (FF) / backward (REW) to go to the next / previous song.
- * Music can be listened to through 900 LEGACY by directly operating your 'Bluetooth Device'.
- * When the battery is completely drained, you can connect the provided microphone cable to continue listening.

3) Smart Play / Pause

- 900 LEGACY has Smart Play / Pause function which can detect whether the headphone is being worn or not.
- The function can play or pause music automatically.
(Play when headphones are worn on the ears/Pause when the headphones are removed from the ears).
- To continue playing music when the headphones are not worn on the ears, double tap the touch panel or press the Power button.

9. LISTENING TO MUSIC (PLAY & CONTROL)

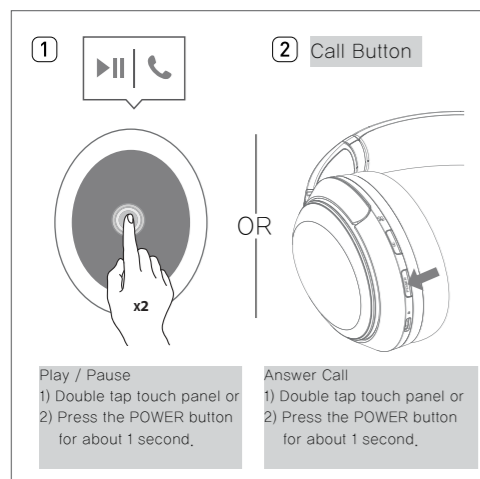

- 1) Accepting a Call while Playing Music
 - When the incoming call tone is heard through the headphone, tap touch panel twice quickly or press the POWER button. The music will be paused and the call is connected.
 - Once the call has ended, tap touch panel twice quickly or press the POWER button to terminate the call. Once the call is terminated, the paused music will play again.

10. ACCEPTING / MAKING A CALL WHILE PLAYING MUSIC

- 1) Accepting a Call
 - When the incoming call tone is heard through the headphones, tap touch panel twice quickly or press the POWER button. (Volume control : While on a call, use the touch panel to control volume)
- 2) Ending a Call
 - While on a call, shortly pressing the POWER Button or tap touch panel twice quickly to end the call.
- 3) Rejecting a Call
 - When the incoming call tone is heard through the headphones, press and holds the POWER Button for about 1 second.
(After hearing the 'beep' signal tone, the incoming call is rejected and the voice guidance "Call Ignored" is heard.)
- 4) Call Waiting
 - When there is another incoming call while on a call.
(Supported only when having applied for this service with your telecom provider.)
 - Press and hold the POWER Button for about 1 second to place the current call on call waiting and connect the second call.
(Press the POWER Button again for about 1 second to switch between the waiting call and connected call.)
 - Shortly press the POWER Button to end the current call and connect the second call.
- 5) Switching between the Device and Mobile Phone
 - To switch the call from mobile phone to the headphone, press the POWER Button for 1 second.

Status	LED Indicator
Incoming Bell/Outgoing Bell	Purple light blinks in 1,5 second intervals
During Call	Blue light slowly blinks every 6 seconds
When there are two calls connected	Purple light slowly blinks every 6 seconds

※ Battery use time

Status	Noise Cancelling 'OFF'	Noise Cancelling 'ON'
Call Time	Max. 41 hours	Max. 39 hours
Music Play Time	Max. 46 hours	Max. 43 hours
Standby Time	Max. 329 hours	Max. 320 hours
10 min. charging	Max. 4 hours	Max. 4 hours
Full Charging Time	about 3,3 hours	

- * The above times may differ depending on the environment in which it is used.

11. DISCONNECT NOTIFICATION



Vibration rings for 2 seconds and beep sound, then beep sound is repeated 5 times in 20 second intervals.

- 1) The 900 LEGACY vibrates when you are out of communication range (about 10 m/33 ft.) from the 'Bluetooth Device'.
- 2) The alarm function first notifies you with a vibration for 2 seconds and beep sound, then beep sound is repeated 5 times in 20 second intervals.
- 3) If you continue to be out of range for more than 20 seconds, the 900 LEGACY will enter 'Connection Waiting Mode' after notifying you with vibration and beep sounds, along with a voice prompt of 'Device Disconnected'.
- 4) If you move back into communication range before the notification completes the fifth interval, you will stay connected to your 'Bluetooth Device'.
- 5) If you do not move back into communication range until after the notification has ended, you will need to manually reconnect to Bluetooth.

12. CONNECTING AND USING THE MICROPHONE CABLE

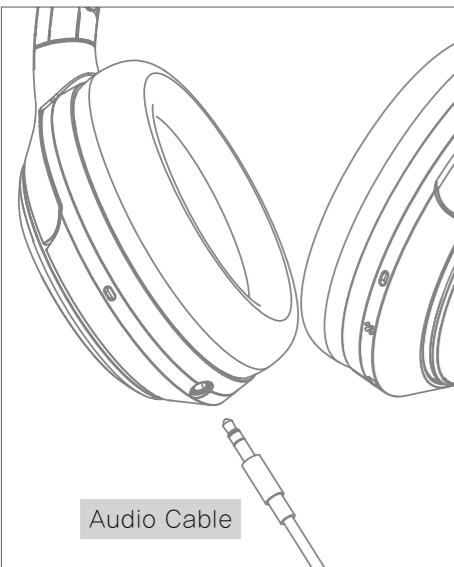

900 LEGACY can also be used with the audio cable connected as shown in the figure.

- * When connected to a device with the provided audio cable, the Bluetooth remote features are disabled and you must use the device you are connected Audio Cable to answer calls and play music.

13. MISCELLANEOUS FEATURES

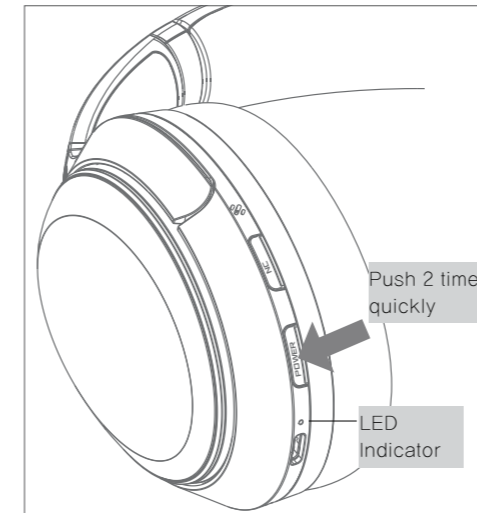

- 1) Checking Remaining Battery
 - With the power on, shortly press the POWER Button twice to display the remaining battery indicator (LED).
 - For Apple iOS version 5 or above, the remaining battery is displayed at the top right side of the screen.

Remaining Battery	Voice Guidance
Over 80%	Battery is full
80% ~ 30%	Battery is moderate
Under 30% Red light	Battery is low
Under 3%	Please recharge

* The Battery Check feature will not operate while the battery is being charged.

* When the battery charge is under 3%, the alarm will sound.

If use is continued for several minutes the battery will be completely drained, the 'Power Off' voice guidance is provided and the power will automatically turn off.

2) Resetting the Device

- To reset to factory settings, at power off, press the POWER Button for over 10 seconds.

Operation	LED Indicator
Factory Settings	5 times Purple light blinking

14. SPECIFICATIONS

1) Main body

- Communication Network: Bluetooth 5.1
 - Output Power: Power Class 2
 - Max. Communication Range: Discoverable within 10 m / 33 ft.
 - Full Charging Time: 3,3 Hours
 - Call Time (NC on / off) : Max. 39 Hours / Max. 41 Hours
 - Music Play Time (NC on / off) : Max. 43 Hours / Max. 46 Hours
 - Standby Time (NC on / off) : Max. 320 Hours / Max. 329 Hours
 - Operating Frequency: 2,4 GHz (2,402 GHz ~ 2,480 GHz)
 - Bluetooth Profile Support: HFP v1,7 / HSP v1,2 / A2DP v1,3,1 / AVRCP v1,6
 - Audio Codec: SBC, Qualcomm® aptX–HD™ , aptX™ , AAC
- (If the 'Bluetooth Device' can not support Qualcomm® aptX™ or aptX–HD™ audio or AAC mode, it will be connected with SBC mode.)
- Battery: Lithium Polymer DC 3,7 V / 1000 mAh
 - Microphone Frequency Range: 50 ~ 4,000 Hz
 - Microphone Sensitivity: –42 dB
 - Support Echo Cancellation and Talk Noise: cVc® Solution
 - Operating Temperature: –20 ~ 45 ° C
 - Size: 180 x 172 x 23 mm (H x W x D) / 7,1 x 6,8 x 0,9 inch (H x W x D)
 - Weight: 256 g (0,56 lb)

2) Headphones

- Type: \varnothing 40 mm Driver Units
- Sensitivity: 100 dB/mW
- Frequency Response: 10 Hz ~ 27 kHz
- Impedance: 16 ohms

* The specifications are subject to change without prior notice for quality improvement.

15. PRODUCT SYMPTOMS AND TROUBLESHOOTING

1) The power does not turn on:

- Charge the device. If the power does not turn on even after charging, contact Phiaton Customer Service.

2) The device does not charge:

- Check whether the USB charging cable has been properly connected with the device.
- Check whether the PC power is on and that it has been properly connected.
- When using a separately purchased USB AC adapter, check to see that it has been properly connected.

3) The device does not pair:

- Check whether the power of the 'Bluetooth Device' you want to connect is on.
- Check whether the Bluetooth feature within the 'Bluetooth Device' you want to connect is enabled.
- Check whether the 'Bluetooth Device' you want to connect is within the supported range. (Pairing is supported only when within 3 feet.)
- Check whether the Bluetooth profile within the 'Bluetooth Device' is compatible.
- Check whether the 900 LEGACY is in 'Pairing Mode'.
- Power OFF, then try again repairing by following direction from 6. PAIRING WITH A 'BLUETOOTH DEVICE'.

4) Music cannot be played:

- Check whether the power of the device and 'Bluetooth Device' is on.
- Check whether music is being played within the connected 'Bluetooth Device'.
- Check whether the volume within the connected 'Bluetooth Device' is low.
- When using an extension cord, check to see that the plug is properly connected.

5) Noise is heard or the sound lags:

- Check whether there is an electronic device using the 2,4 GHz frequency band nearby the device and connected 'Bluetooth Device'.
- Check whether the connected 'Bluetooth Device' is far away from this device. (Maximum communication range: within 33 feet.)

6) The music sound quality is low:

- If the 'Bluetooth Device' you are trying to connect with this device is accessed to HSP, change the access to A2DP.

7) The other party cannot be heard while on a call:

- Check whether the power of the 'Bluetooth Device' you want to connect is on.
- Access Bluetooth through HFP or HSP.
- Check whether the volume within the connected 'Bluetooth Device' is low.

8) Outside noise is too high or not reduced:

- Check whether Noise Cancelling is turned ON.
- Check whether the right size ear tips are chosen. (Noise will not be properly reduced if the ear tips are not properly inserted or the right size ear tips are not chosen.)

9) Product does not operate or operation has stopped:

- Reset the device by simultaneously pressing the power button and connecting the USB charging cable. This will power off the device, but previously paired devices won't be deleted.
- This is Hardware reset. Earphone power will be forced to quit but pairing history will remain.
- This method is recommended when headphone or function keys do not work.

10) The device is paired with PC/Laptop but does not work:

- PC/Laptop is equipped with various Bluetooth drivers depending on the manufacturer and it is possible it does not support 900 LEGACY.
- Please contact to PC/Laptop manufacturer to download the latest software driver or for further assistance in connecting to a 'Bluetooth Device'.

16. FCC COMPLIANCE INFORMATION

FCC ID: V2R-900LEGACY

This device complies with part 15 of FCC Rules. Operation is subject to the following two conditions:

(1) This device may not cause harmful interference, and (2) this device must accept any interference received, including

interference that may cause undesired operation.

Information to the user:

NOTE: This equipment has been tested and found to comply with limits for a Class B digital device, pursuant to part 15 of the FCC Rules. These limits are designed to provide reasonable protection against harmful interference in a residential installation. This equipment generates, use and can radiate radio frequency energy and, if not installed and used in accordance with the instructions, may cause harmful interference to radio communications. However there is no guarantee that interference will not occur in a particular installation. If this equipment does cause harmful interference to radio or television reception, which can be determined by turning the equipment off and on, the user is encouraged to try the correct interference by one or more of the following measures:

- Reorient or relocate the receiving antenna.
- Increase the separation between the equipment and receiver.
- Connect the equipment into an outlet on a circuit different from that to which the receiver is connected.
- Consult the dealer or an experienced radio/TV technician for help.

CAUTION TO USER: Changes or modifications not expressly approved by the party responsible for compliance could void the user's authority to operate the equipment.

CE COMPLIANCE INFORMATION

Phiaton, hereby declares that this 900 LEGACY is in compliance with the essential requirements and other relevant provisions of directive 1999/5/EC.

-

Qualcomm is a trademark of Qualcomm Incorporated, registered in the United States and other countries.
aptx is a trademark of Qualcomm Technologies International, Ltd., registered in the United States and other countries.



PHIATON Corporation

10231 Slater Ave., #211, Fountain Valley, CA 92708, USA

To learn more, visit our website, www.phiaton.com

Phiaton is a trademark of Phiaton Corporation.

Quick Start Guide

900 LEGACY

PHIATON

Superior Digital Hybrid Noise Cancelling



Charging The Headphone
헤드폰 충전하기
abroqueamiento
耳机充电

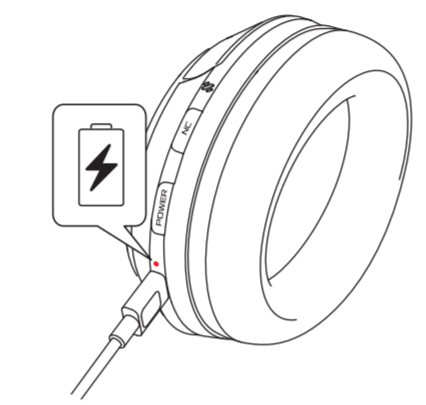
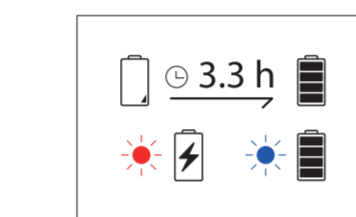
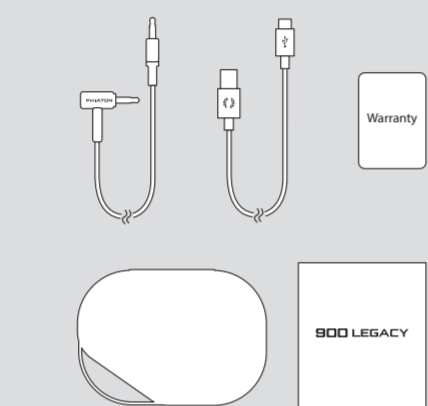
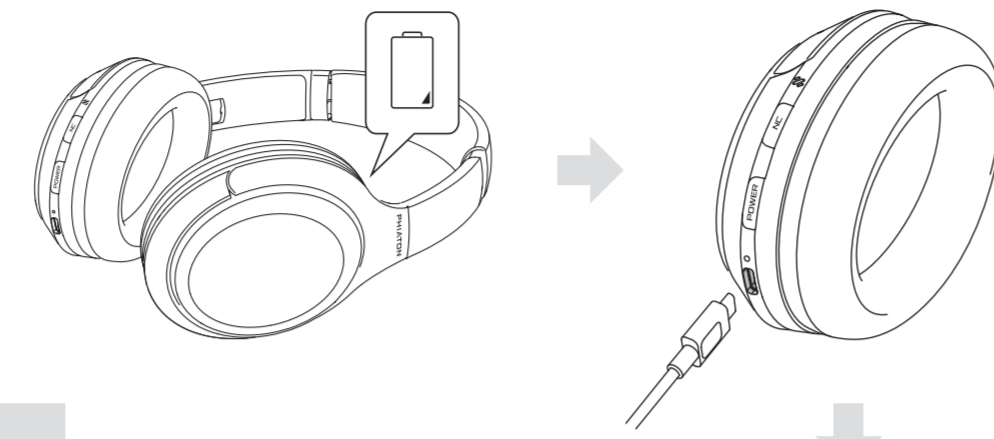

Pairing
연결하기
Emparejamiento
配对

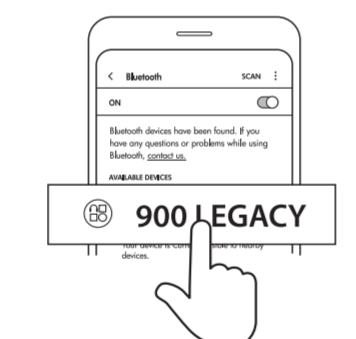
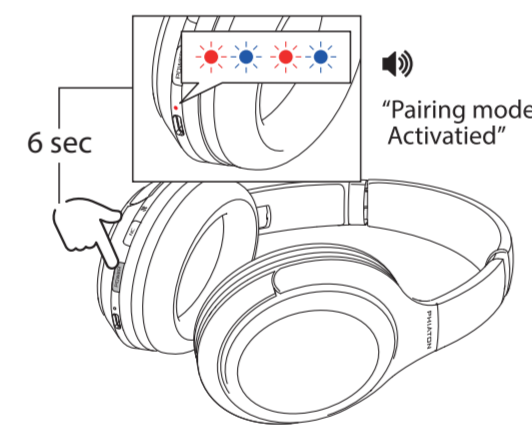
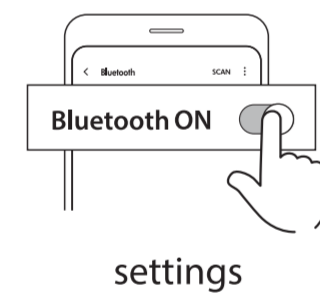

Power On / Off
전원 켜기 / 끄기
Enciende la luz. Apaga la luz.
开机 / 关机

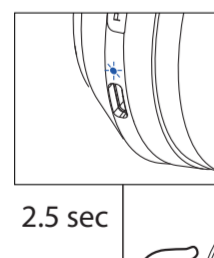

"Power On,
Device Connected"

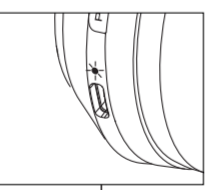
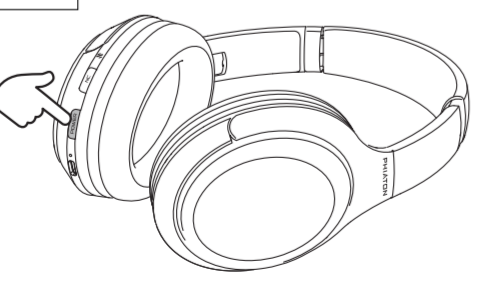

"Power Off"

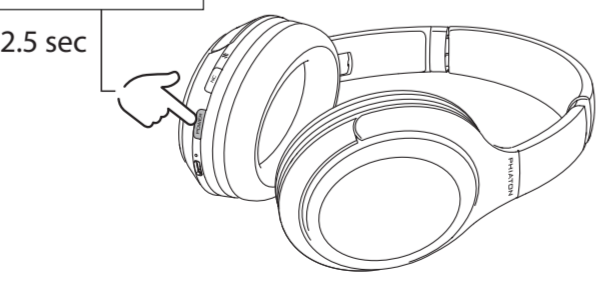

Music
음악
Música
音乐

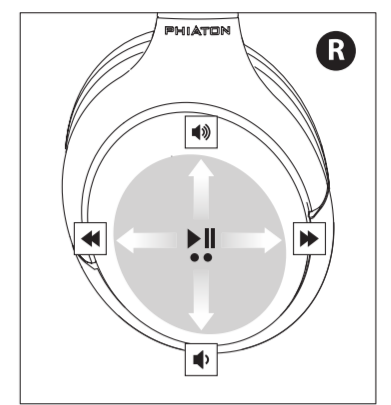
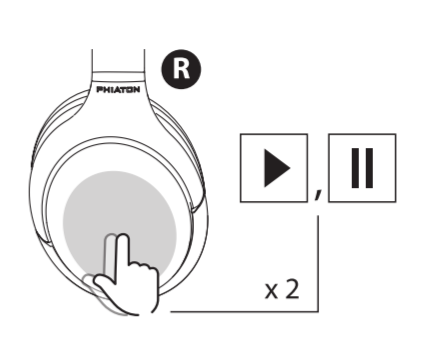

Receiving A Call
전화 받기
Aceptar una llamada
接听电话

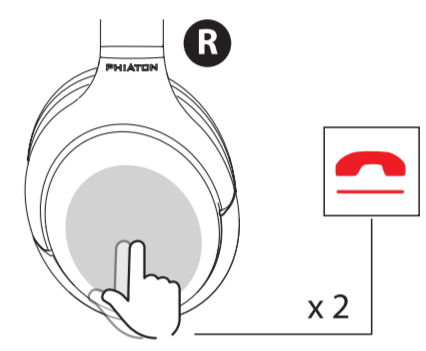
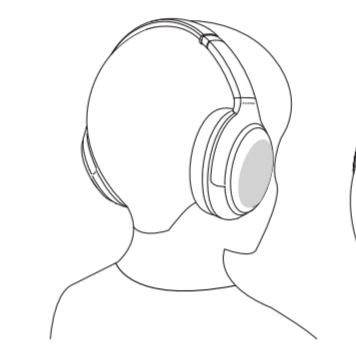

Monitoring / Noise cancelling
외부 소리듣기 / 소음제거
escucha externa / discontinuación
听外音 / 降噪

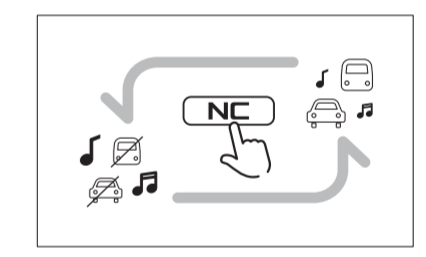
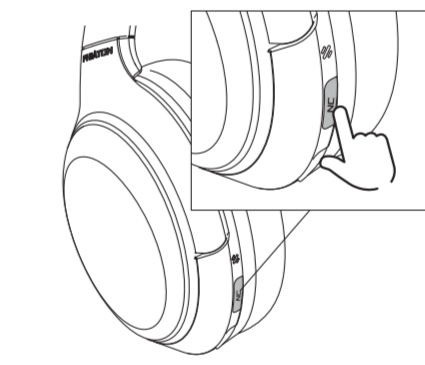
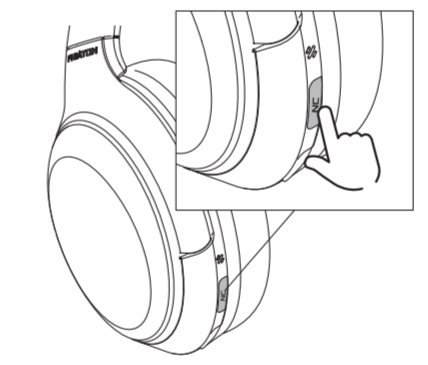

FCC Compliance Information

FCC ID : V2R-900LEGACY
Product Name : Bluetooth Headphone
This device complies with part 15 of FCC Rules.
Operation is subject to the following two conditions:
(1) This device may not cause harmful interference, and (2) this device must accept any interference received, including interference that may cause undesired operation.
Information to the user:
NOTE: This equipment has been tested and found to comply with limits for a Class B digital device, pursuant to part 15 of the FCC Rules. These limits are designed to provide reasonable protection against harmful interference in a residential installation. This equipment generates, use and can radiate radio frequency energy and, if not installed and used in accordance with the instructions, may cause harmful interference to radio communications. However there is no guarantee Ainterference will not occur in a particular installation. If this equipment does cause harmful interference to radio or

television reception, which can be determined by turning the equipment off and on, the user is encouraged to try the correct interference by one or more of the following measures:
- Reorient or relocate the receiving antenna.
- Increase the separation between the equipment and receiver.
- Connect the equipment into an outlet on a circuit different from that to which the receiver is connected.
- Consult the dealer or an experienced radio/TV technician for help.

CAUTION TO USER:
Changes or modifications not expressly approved by the party reasonable for compliance could void the user's authority to operate the equipment.

Warning
To comply with FCC RF exposure requirements, a minimum separation distance of 5 mm

must be maintained between the human head and the radiator of device.

CE Compliance Information
Phiaton, hereby declares that this 900LEGACY is in compliance with the essential requirements and other relevant provisions of directive 1999/5/EC.

Qualcomm is a trademark of Qualcomm Incorporated, registered in the United States and other countries. aptx is a trademark of Qualcomm Technologies International, Ltd., registered in the United States and other countries.

