

WILLIAMS-SONOMA

WSBS2000 Bluetooth® Speaker

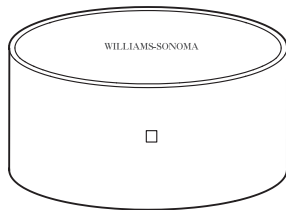

Instruction Book

Design and specifications are subject to change without notice.



Safety Information

To reduce the risk of fire or electric shock, do not expose this apparatus to rain or moisture.

To reduce the risk of fire or electric shock, do not expose this apparatus to dripping or splashing, and do not place objects filled with liquids, such as vases, on the apparatus.

To reduce the risk of fire, do not cover the ventilation opening of the apparatus with newspapers, tablecloths, curtains, etc.

Do not place the naked flame sources such as lighted candles on the apparatus. Do not install the appliance in a confined space, such as a bookcase or built-in cabinet.

As the main plug of AC adaptor is used to disconnect the AC adaptor from the mains, connect it to an easily accessible AC outlet. Should you notice an abnormality in it, disconnect it from the AC outlet immediately.

The AC adaptor is not disconnected from the mains as long as it is connected to

the AC outlet, even if the main unit itself has been turned off.

The nameplate is located on the bottom exterior of the main unit and on the surface of the AC adaptor.

IMPORTANT SAFETY INSTRUCTIONS

1. Read these instructions.
2. Keep these Instructions.
3. Heed all Warnings.
4. Follow all instructions.
5. Do not use this apparatus near water.
6. Clean only with dry cloth.
7. Do not block any ventilation openings. Install in accordance with the manufacturer's instructions.
8. Do not install near any heat sources such as radiators, heat registers, stoves, or other apparatus (including amplifiers) that produce heat.
9. Do not defeat the safety purpose of the polarized or grounding - type plug. A polarized plug has two blades with one wider than the other. A grounding type plug has two blades and a third grounding prong. The wide blade or

the third prong is provided for your safety. If the provided plug does not fit into your outlet, consult an electrician for replacement of the obsolete outlet.

10. Protect the power cord from being walked on or pinched particularly at plugs, convenience receptacles, and the point where they exit from the apparatus.

11. Only use attachments/accessories specified by the manufacturer.

12. Use only with the cart, stand, tripod, bracket or table specified by the manufacturer, or sold with the apparatus. When a cart is used, use caution when moving the cart/apparatus combination to avoid injury from tip-over.



13. Unplug this apparatus during lightning storms or when unused for long periods of time.

14. Refer all servicing to qualified service personnel. Servicing is required when the apparatus has been damaged in any way, such as power-supply cord or plug is damaged, liquid has been spilled or objects have fallen into the apparatus, the apparatus has been exposed to rain or moisture, does not operate normally, or has been dropped.

Please read rating label at the bottom of system for power input and other safety information.

FCC and IC Information:

This device complies with Part 15 of the FCC Rules and RSS-210 of the IC Rules. Operation is subject to the following two conditions: (1) This device may not cause harmful interference, and (2) this device must accept any interference received, including interference that may cause undesired operation.

Warnings: The device meets the exemption from the routine evaluation limits in section 2.5 of RSS 102 and users can obtain Canadian information on RF exposure and compliance from the Canadian Representative Burnport Holdings Ltd. 72MT Belcher Pls, East, Calgary, Alberta, T2Z 2G1, CANADA. Tel: 403-257-4961

Canada IC statments

Le présent appareil est conforme aux CNR d'Industrie Canada applicables aux appareils radio exempts de licence. L'exploitation est autorisée aux deux conditions suivantes : (1) l'appareil ne doit pas produire de brouillage, et (2) l'utilisateur de l'appareil doit accepter tout brouillage radioélectrique subi, même si le brouillage est susceptible d'en compromettre le fonctionnement.

FCC&IC Radiation Exposure Statement

This equipment complies with FCC radiation exposure limits set forth for an uncontrolled environment and meets the exemption from the routine evaluation limits in section 2.5 of RSS 102.

1. This Transmitter must not be co-located or operating in conjunction with any other antenna or transmitter.
2. This equipment complies with FCC RF radiation exposure limits set forth for an uncontrolled environment. This equipment should be installed and operated with a minimum distance of 20 centimeters from user and bystanders.

Warning: Changes or modifications to this unit not expressly approved by the party responsible for compliance could void the user's authority to operate the equipment.

NOTE: This equipment has been tested and found to comply with the limits for a Class B digital device, pursuant to Part 15 of the FCC Rules. These limits are designed to provide reasonable protection against harmful interference in a residential installation. This equipment generates, uses, and can radiate radio frequency energy and, if not installed and used in accordance with the instructions, may cause harmful interference to radio communications. However, there is no guarantee that interference will not occur in a particular installation. If this equipment does cause harmful interference to radio or television reception, which can be determined by turning the equipment off and on, the user is encouraged to try to correct the interference by one or more of the following measures:

- Reorient or relocate the receiving antenna.
- Increase the separation between the equipment and receiver.
- Connect the equipment into an outlet on a circuit different from that to which the receiver is connected.
- Consult the dealer or an experienced radio TV technician for help.

Information for Users on Disposal of Old Equipment



Attention: This symbol is only valid in the European Union.

[European Union]

This symbol indicates that the electrical and electronic equipment should not be disposed as general household waste at its end-of-life.

Instead, the product should be handed over to the applicable collection point for the recycling in accordance with your national legislation.

By disposing of this product correctly, you will help to conserve natural resources and will help prevent potential negative effects on the environment and human health that could otherwise be caused by inappropriate waste handling of this product. For more information about collection point and recycling of this product, please contact your local municipal office, your household waste

disposal service or the shop where you purchased the product. Penalties may be applicable for incorrect disposal of this waste, in accordance with national legislation.

[Other Countries outside the European Union]

If you wish to dispose of this product, please do so in accordance with applicable national legislation or other rules in your country for the treatment of old electrical and electronic equipment.

QDID:

Setting up the System

Place the System on a Flat Surface

CAUTION - Proper Installation

- Install the system in a place which is level, dry and neither too hot nor too cold. The appropriate temperature is between 5 °C and 35 °C.
- Install the system in a location with adequate ventilation to prevent internal heat from building up inside the unit.
- Leave sufficient distance between the system and TV.
- Keep the system away from TV to avoid interference with TV.

CAUTION - Proper Ventilation!

To avoid risk of electric shock and fire, and to prevent damage, locate the apparatus as follows:

Front: No obstructions and open spacing.

Sides / Top / Back: No obstructions should be placed in the areas shown by the dimensions below.

Bottom: Place on the level surface. Maintain an adequate air path for ventilation by placing on a stand with a height of 10 cm (3-15/16") or more.

Front view:

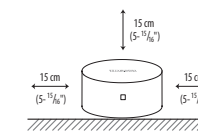

Side view:

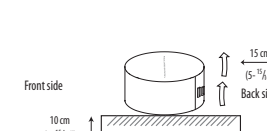

Connecting AC Adaptor

To Connect the AC Adaptor

WARNING! For optimal performance, use only the supplied AC adaptor.

- Ensure that power supply outlet matches with the unit AC's input 100-240V~, 50/60Hz before connection.

Connect one end of the AC adaptor to the DC IN jack of the unit and the other end to a power outlet.

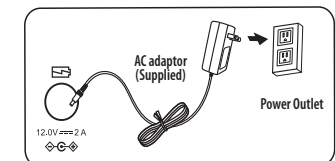

Location of Controls

Front Panel

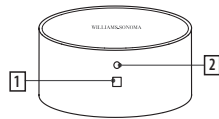

Back Panel

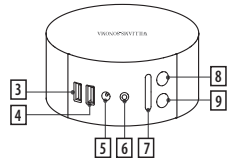

1 LED indicator	4 Charging port for iPad	7 Volume +/- buttons
2 Microphone	5 DC IN jack (12.0V ⚡ 2A ⚡)	8 Bluetooth button
3 Charging port for iPod/iPhone	6 LINE-IN jack	9 Power on/Standby button

Connections & Operations

Listening to an External Device

You can enjoy the sound from an optional component such as a portable digital music player through the speakers of System. Be sure to turn off the power of each component before making any connections. For details, refer to the instruction manual of the component to be connected.

1. Set the volume level of the System to minimum.
2. Connect an external device to the **LINE IN** jack [6] on the back of System using a stereo mini plug cord.
3. Hold the [9] button to power on the System.

NOTE: The LED indicator [1] starts blinking slowly.

4. Start playback of the external device.
5. Adjust the volume of the System and of the external device.

NOTE: Before enjoying music from an external device, you need to unplug the iPod from the System and disconnect your Bluetooth connection.

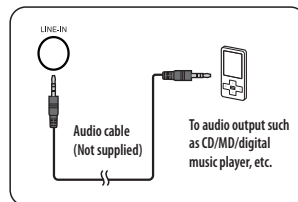

Making Calls with a Bluetooth Mobile Phone

Before you make a call with the System, you need to pair and link your Bluetooth-enabled phone with the System. Please refer to "Registering a Bluetooth device for the first time".

Answering a call

1. To answer a call, press the [8] button.
2. Speaker into the Microphone [2] (hidden on the behind of the speaker grill) and press the Volume button [7] to adjust the call volume.

3. To end the call, press the [8] button again.

Dialing a call

1. Once the System is paired to a Bluetooth mobile phone, you can use the keypad on your phone to dial a phone number.
2. Press the Volume button [7] to adjust the call volume.
3. Press the [8] button to end the call.

Playing back via Bluetooth

You can listen to music from a target Bluetooth device through the System. Once the pairing is successful, the System will switch the current source mode to Bluetooth mode automatically.

NOTE:

- In order to use these functions, the device must be compatible with AVRCP and A2DP profiles.
- Some Bluetooth devices may not be available to the System.

Registering a Bluetooth device for the first time

1. Press the [9] button to power on the System.
2. Press the Volume down button [7] to turn down the volume.
3. Hold the [8] button for more than 5 seconds. The LED indicator [1] blinks red and white alternately.
4. Perform the pairing operation on the target Bluetooth device. For information on operating the target Bluetooth device, see the instruction manual for the Bluetooth device.

Charging the Built-in Battery

The System has a built-in Lithium-Ion battery to give you portable power when not using the AC adaptor. When the adaptor is plugged in, the unit will charge. When operating the unit in battery mode, a red LED indicator means the battery is below. You must charge this unit for 12 hours before using for the first time.

NOTE:

- When the battery is in low, the LED indicator [1] lights red for 10 seconds, and then the System is powered off.
- The battery cannot be replaced by the user.

Charging an iPod/iPhone or an iPad

NOTE: In this user manual, "iPod" is used as a general reference to functions on an iPod, iPhone or iPad, unless otherwise specified by the text or illustrations.

The two USB ports [3] [4] can be used to charge iPod devices.

The battery of the iPod is always charged through the unit when it is connecting to a wall outlet.

5. Select "Williams-Sonoma" from the list. When the target device requests the passkey during pairing operation, enter "0000". The pairing is completed and the target Bluetooth device is connected to the System automatically. The LED indicator [1] lights solidly.
- You can operate the target device to pair with the System within the range of 33 feet (10m).
- Try again above steps 3-5 if the LED indicator [1] starts blinking slowly after blinking for 3 minutes.
6. Start playback of the target Bluetooth device. The sound from the Bluetooth device is emitted from the System.
- Playback may start automatically with some Bluetooth devices.

NOTE: The pairing is necessary only when connecting for the first time. If registering other Bluetooth devices, you can repeat the above steps 3-5.

- It takes about 3 hours to charge the battery from empty to full.
- Do not dispose of unit in fire; battery may explode or leak.

Type: Lithium-Ion Rechargeable Battery
Rated Voltage: 3.7 V (* 1)
Capacity: 1200 mAh

WARNING! There is a danger of explosion if the battery is incorrectly replaced. Replace it only with the same or equivalent type. Do not expose it to excessive heat such as sunshine, fire, etc.

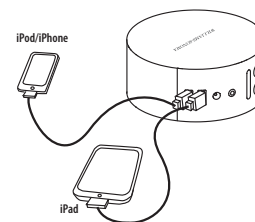

Troubleshooting

If you are having a problem with the System, check this list for a possible solution before calling for service.

General

Power does not come on.

⇒ No power is supplied. Check the power cord connection.

The System turns off automatically.

⇒ Auto power save function is working. If the System is idle (no operation and no sound output) for more than 20 minutes.

No sound is heard.

⇒ The volume is set to the minimum.

iPod Operations

No sound is heard through the System.

⇒ Disconnect the Bluetooth connection and then the System will restore the LINE IN mode automatically.

⇒ Adjust the volume of the external device.

Bluetooth Operations

No sound is heard through the System.

⇒ The volume of the target Bluetooth device connected to the System is set to the minimum.

⇒ The target Bluetooth device is out of the Bluetooth connection effective range.

Unable to connect/operation a Bluetooth device.

⇒ When performing a Bluetooth connection between the System and your target device for first time, if the connection is not completed, you need to disconnect the AC power cable from the wall outlet, wait for a while, then connect the cable again and then power on again to clear the target device name. Perform a Bluetooth connection again.

⇒ The device does not support A2DP/AVRCP Bluetooth profile. A2DP/AVRCP profile is necessary to stream music data. Refer to the instruction manual of the Bluetooth device.

Calling Operations

Cannot hear caller's voice.

⇒ The Bluetooth mobile phone is out of the Bluetooth connection effect range.

⇒ The volume of the System is too low.

Cannot hear my voice/Voice is not clear to listener.

⇒ You are too far from unit microphone.

Technical Specification

Model		WSBS2000 Bluetooth® Speaker	
Bluetooth	version	Bluetooth 2.1 + EDR certified	
	Profile	A2DP (Advanced Audio Distribution Profile), AVRCP (Audio/Video Remote Control Profile)	
	Output power	Bluetooth power class 2	
Input Sensitivity	AUX Input	1100 mV	
Speaker	Output power	1.8 W	
AC Adaptor	Input: AC 100-240V, 50/60Hz		
	Output: DC 12 V ⚡ 2 A		
Dimensions (Diameter)	120 mm		
Weight	351 Kg		