

Cyder

Bluetooth Adapter with iPod Connector

Model No.: BAS03

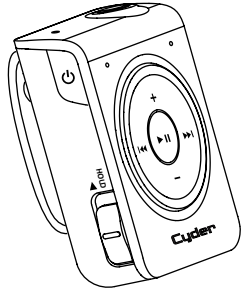

Instruction Book



3

Introduction

Congratulations on your purchase of another high-quality Cyder product. Compact and easy-to-clip on your apparel, the BAS03 uses Stereo Bluetooth technology and provides seem less connectivity that allows you to enjoy music and communicate on the go - connecting with another Bluetooth-enabled device up to 33 feet away. Simply pair the BAS03 with a music source such as your mobile phone or computer with a Bluetooth function, you can then listen to music through the BAS03 with the supplied earphones or your speaker system or with an iPod dock connector.

Without the worry of missing a call, the BAS03 enables you to receive calls and pause music automatically. The music resumes when the call ends.

This manual explains how to establish connection and operate this Bluetooth Adapter. Read this user manual carefully before using it.

Safety Information

Information for Users on Disposal of Old Equipment



Attention:
This symbol is only valid in the European Union.

[European Union]

This symbol indicates that electrical and electronic equipment should not be disposed as general household waste at its end-of-life. Instead, the product should be handed over to the applicable collection point for recycling in accordance with your national legislation.

By disposing of this product correctly, you will help to conserve natural resources and will help prevent potential negative effects on the environment and human health that could otherwise be caused by inappropriate waste handling of this product. For more information about collection point and recycling of this product, please contact your local municipal office, your household waste disposal service or the shop where you purchased the product.

Penalties may be applicable for incorrect disposal of this waste, in accordance with national legislation.

[Other Countries outside the European Union]

If you wish to dispose of this product, please do so in accordance with applicable national legislation or other rules in your country for the treatment of old electrical and electronic equipment.

1

Features

- Compatible with Bluetooth-enabled devices, speaker systems and with 30-pin iPod dock connector.
- Receives streaming audio from Bluetooth-enabled devices, and provides playback through the supplied earphones or your speaker system
- Bluetooth music pauses when a call comes in, and resumes from where the music stops when the call ends.
- Up to 33 feet (10m) wireless range
- Quick Bluetooth pairing for easy installation
- Plays all music formats from the Bluetooth-enabled device

Packing Contents

Examine the contents of the box for your Bluetooth Adapter. There should be the follows :



Bluetooth Adapter



Earphones



AC Adapter



3.5 Stereo Cable



User Manual

4

Warning: Permanent hearing loss may occur if headphones are used at high volume. You can adapt over time to higher volume of sound, which may sound normal but can be damaging to your hearing.

For compatibility between the Bluetooth Adapter (BAS03) and another device with Bluetooth technology, consult the device's documentation and dealer. In some countries, there may be restrictions on using Bluetooth devices. Check with your local authorities.

Bluetooth is a registered trademark of Bluetooth SIG, Inc

Never use any charger that is damaged. Do not dispose of batteries in a fire as they may explode. Batteries may also explode if damaged. Dispose of batteries according to local regulations. Please recycle when possible. Do not dispose as household waste.



This device complies with part 15 of the FCC rules. Operation is subject to the following two conditions: (1) this device may not cause harmful interference, and (2) this device must accept any interference received, including interference that may cause undesired operation.

NOTE: The manufacturer is not responsible for any radio or TV interference caused by unauthorized modifications to this equipment. Such modifications could void the user's authority to operate the equipment.

2

Functional Overview

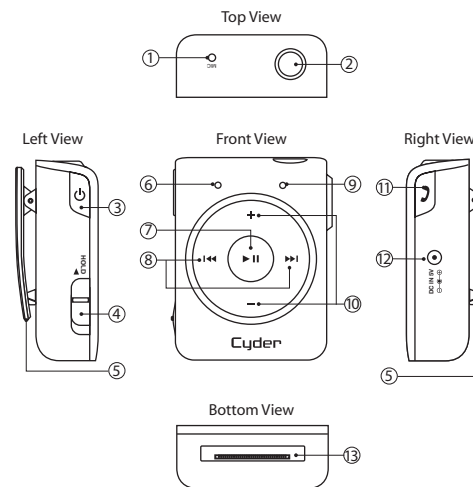

1. MIC Port
2. Stereo Earphones Jack

Continued on the next page.

5

Save This Manual

3. Button
Power on/off the Bluetooth Adapter.
Establish a link between the Bluetooth Adapter and your Bluetooth-enabled device.
4. Hold Switch
Enable/Disable all the controls on Bluetooth Adapter.
5. Clip
Enable you to wear the Bluetooth Adapter on apparel.
6. Charging indicator
7. button
Play/Pause a track.
8. Button
Press to skip the previous/next track.
9. Power/Pair indicator
10. Button
Press to increase/decrease volume level.
11. Button
Press to answer/hang up a call.
12. 5V DC IN Jack
13. iPod Connector Port

6

Basic Operation

Charging the Bluetooth Adapter

Caution: Before using the Bluetooth Adapter for the first time, make sure the built-in battery is fully charged for at least 10 hours.

To connect the AC adapter

1. Connect the AC adapter's connector to the DC IN jack on Bluetooth Adapter.
2. Connect the AC adapter's plug to a wall outlet.

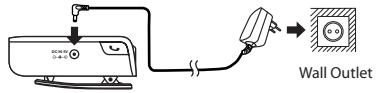

- The Bluetooth Adapter can be charged through the supplied AC adapter, or your speaker system if it has an iPod dock connector.
- The Charging indicator illuminates green solidly when the unit is in charging mode.
- When the Charging indicator blinks green it means that the battery is low.
- The Charging indicator goes off when the built-in battery is fully charged. Charging time is approximately two hours for a full charge.
- The built-in battery runs up to four hours based on a full charge.

7

Breaking up the Link

1. Once you finish using the Bluetooth Adapter, you must hold the **⏻** button for about 3 seconds to power off the unit directly.
- To connect to another Bluetooth device, you must stop the connection with the current Bluetooth-enabled device.

Troubleshooting

Check this list for a possible troubleshooting solution before calling for service.

Problem	Solution
Power does not come on.	<ul style="list-style-type: none"> • The built-in battery is exhausted. • AC adapter is not inserted correctly. Plug in securely.
All controls on Bluetooth Adapter are not available.	<ul style="list-style-type: none"> • Slide the HOLD switch to enable.
Bluetooth Adapter hangs up.	<ul style="list-style-type: none"> • Hold the ⏻ button, ⏸ button and ▶ button at one time for a few seconds.

11

Establishing a Link

Note: If your mobile phone supports A2DP protocol, its music will play through the Bluetooth Adapter.

1. Press and hold the **⏻** button for about 5 seconds to turn on the Bluetooth Adapter and enter search a link mode.
 - The Power/Pair indicator starts blinking between red and blue alternatively at a fast rate.
 - If the unit has previously linked with your Bluetooth-enabled device, you only need to hold the **⏻** button for about 3 seconds to turn on the unit, no further operation is needed. The Power/Pair indicator will blink blue at a low rate.
2. During this period, you can operate your mobile phone or Bluetooth-enabled device to pair with the Bluetooth Adapter within a 33 feet (10m) range.
 - Please check the user manual of your Bluetooth-enabled device with which you are initiating pair to learn about Bluetooth connection with other devices.
3. Once the Bluetooth Adapter is detected and its name "BAS03" appears on the display of your Bluetooth-enabled device, key in the default password "0000" to accept the pair.
 - You may change the device name on your Bluetooth-enabled device after the pair is successfully set up.
 - When an active link is established between the two devices, the Power/Pair indicator on the Bluetooth Adapter blinks blue at a low rate, when the Adapter is in transmission mode, the Power/Pair indicator blinks blue at a fast rate.

8

- Try again above step 1 to 3 if the Power/Pair indicator shows red all the time.

Using the Bluetooth Adapter

A. To Listen to Music using Earphones

1. Wear it on your sleeve or lapel using the clip.
2. Ensure the supplied earphones jack is connected to the Bluetooth Adapter.

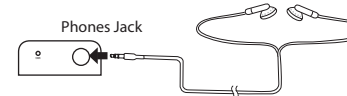

3. Select a track using the **◀◀** / **▶▶** buttons and press the **▶||** button to play the desired music.

B. To Receive Calls while listening to music

1. When an incoming call arrives, the music will be suspended.
2. Press the **📞** button on the Bluetooth Adapter to pick up the call.
3. Aim at the MIC port while speaking.
4. When the call ends, press the **📞** button again to hang up. The music resumes automatically.

9

C. To Listen to Music using Speaker System

1. Turn on your speaker system.
2. Select "iPod" play mode by pressing the source/mode button on your speaker system.
3. Remove the iPod dock adapter from the cradle on your speaker system if any.
4. Insert the iPod connector plug of your speaker system into the connector port of the Bluetooth Adapter.
 - The Power/Pair indicator illuminates red indicating that the Bluetooth Adapter is connected to your speaker system correctly.
 - Meanwhile, the Charging indicator will turn green to indicate that the Bluetooth Adapter is under charging if it has no full power.
5. Select a track using the **◀◀** / **▶▶** button and press the **▶||** button to play the desired music. Your speaker system is now playing!

D. To Enjoy music from a Computer

1. Launch "Window Media Player" or another software of same type to select your favourite songs for playback.
2. Adjust volume and use controls on the Bluetooth Adapter for basic playback operation.

10

Troubleshooting(Cont.)

Problem	Solution
No sound comes from speaker system.	<ul style="list-style-type: none"> • Make sure that an active link is established between the Bluetooth Adapter and your Bluetooth-enabled device. • Ensure that either the unit's iPod connector is sitting correctly or that the connector sockets are correctly fitted.
No sound comes from earphones.	<ul style="list-style-type: none"> • Test the earphones on another product. • Make sure that an active link is established between the Bluetooth Adapter and your Bluetooth-enabled device.

12

Troubleshooting(Cont.)

Problem	Solution
Built-in battery does not charge.	<ul style="list-style-type: none"> • Unplug the Bluetooth Adapter from the speaker system, and then plug again. • Insert the connector plug of the speaker system into the iPod connector port of the Bluetooth Adapter firmly. • Make sure the AC adapter is firmly connected to a wall outlet.
Sound interference.	<ul style="list-style-type: none"> • Shorten the distance between the Bluetooth Adapter and Bluetooth-enabled device. • Make sure that there are no interference sources near your devices.

13

Technical Specification

Support Bluetooth	Bluetooth 1.2 and 2.0 compliant
Support Profile	A2DP/AVRCP/HSP
RF Range	2.402~2.480 GHz
RF Class	Class 2
Operation Range	up to 33 feet (10 meters)
Power	DC IN 5V
Operating Temperature	0 ~ 40 °C

14