

WIRELESS BACKUP SYSTEM #ACA250

BEFORE YOU INSTALL

If you have vehicle specific questions, contact the vehicle's manufacturer, or consider having the WIRELESS BACKUP SYSTEM professionally installed.

WARNING: This device, as well as other wireless devices, may be subject to interference. Interference may be caused by cell phones, Bluetooth headsets, WiFi routers, power lines and other various electrical equipment, etc.

Make sure the parking brake is applied before installing your WIRELESS BACKUP SYSTEM.

PARTS LIST

- 1 - Back UP Camera
- 1 - 3" TFT LCD Monitor
- 1 - Monitor power cable with 12 Volt Adaptor
- 2 - License plate bolts
- 2 - Nuts
- 4 - Flat Washers
- 2 - Lock Washers
- 2 - Wiring harness
- 1 - Test Light
- 2 - Quick Splices

INSTALLATION

The following instructions may not apply to all vehicles. It is meant to serve as a general guide for installation. For questions regarding specific vehicle, contact your vehicle's manufacturer.

CAMERA INSTALLATION

You may mount the camera using the license plate's top or bottom mounting bolts or screws, make sure that its field of view is not obstructed. You may mount the camera on the top or bottom of the license plate.

1. Remove two rear license plate bolts/screws from the license plate bracket
2. Re-insert the bolts/screws through the camera's mounting holes onto the license plate bracket.

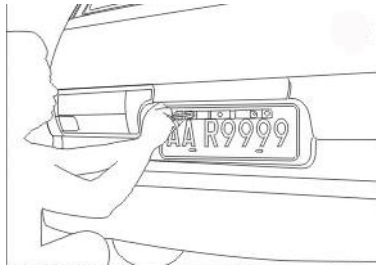

3. Find an access hole to the interior of vehicle, then route the camera's power cord to the reverse light. You may have to remove some of the interior trim panels.



4. With the parking brake applied, turn the ignition key to the ON position without starting the vehicle and shift in to reverse gear, the reverse WARNING lights should come on at the back of the vehicle. (You may need to apply the brake pedal in order to shift in to reverse gear)

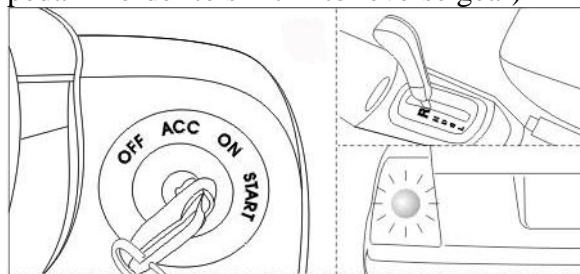

5. Use the test light provided in the kit, identify the power and ground wire to the reverse light. Make sure the alligator clip on the test light is attached to a good ground (For help in locating the vehicle's reverse light circuit, contact your vehicle's manufacturer for vehicle specific wiring diagrams) If the test light lights up, then the wire corresponding to that contact is the power wire. Connect the red wire from the camera's power cord to the power wire, and the black wire to the ground wire.

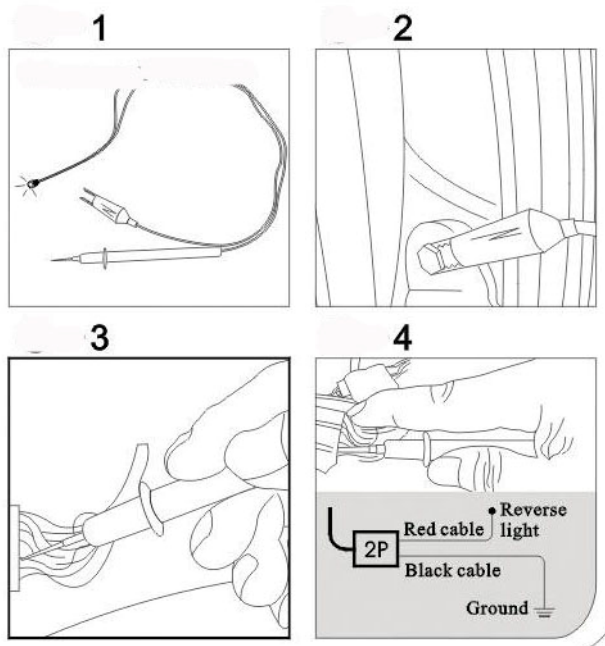

Use the quick splices included in the package for wire connection. Securely fasten the wire to prevent it from being caught on any vehicle component such as the trunk hinge. Never route the cable on the outside of the vehicle.



Insert the existing wire to be tapped



Insert the wire to be attached



Crimp tap with pliers then close lock

6. Shift the gear lever in the Park position and turn the ignition key to the OFF position.

FCC Statement:

1. This device complies with part 15 of FCC Rules. Operation is subject to the following two conditions
 - (1) this device may not cause harmful interference, and
 - (2) this device must accept any interference received, including interference that may cause undesired operation
2. Changes or modifications not expressly approved by the party responsible for compliance could void the user's authority to operate the equipment.

MONITOR INSTALLATION

There are two ways to supply the monitor with power, one uses a 12 Volt cigarette lighter adaptor plugged into the vehicle's cigarette lighter socket, the other uses a wiring harness hard wired to the vehicle's fuse box.

POWER CABLE WITH 12 VOLT CIGARETTE LIGHTER ADAPTOR

1. Place the monitor temporarily in an area that will not obstruct your vision but is visible when reversing.
2. Route the power cord to the monitor so it can be plugged in to the cigarette lighter.
3. Secure the cord so it will not interfere with the safe operation of the vehicle and plug it in to the cigarette lighter outlet.
4. Permanently mount the monitor by peeling off the protective cover at the bottom of the stand.

HARD WIRED TO THE FUSE BOX

Please consider having the WIRELESS REVERSE VIDEO SYSTEM professionally installed by using the wiring harness included in the kit to route the power cable to the vehicle's fuse box.

Check the system by starting the vehicle and placing the shift lever in the reverse position, the monitor should be displaying the view of the camera.

Reinstall the trim panels that were removed during the camera and monitor installation.

FCC Statement:

This equipment has been tested and found to comply with the limits for a Class B digital devices, pursuant to Part 15 of the FCC Rules. These limits are designed to provide reasonable protection against harmful interference in a residential installation. This equipment generates, uses, and can radiate radio frequency energy and, if not installed and used in accordance with the instruction manual, may cause harmful interference to radio communications. However, there is no guarantee that interference will not occur in a particular installation. If this equipment does cause harmful interference to radio or television reception, which can be determined by turning the equipment off and on, the user is encouraged to try to correct the interference by one of more of the following measures:

- Reorient or relocate the receiving antenna
- Increase the separation between the equipment and receiver
- Connect the equipment into an outlet on a circuit different from that to which the receiver is connected.
- Consult the dealer or an experienced radio/TV technician for help.

Warning: Changes or modifications not expressly approved by the party responsible for compliance could void the user's authority to operate the equipment.