

PS30

Personal Shopper

DRAFT



ZEBRA

Quick Start Guide

2024/01/26

ZEBRA and the stylized Zebra head are trademarks of Zebra Technologies Corporation, registered in many jurisdictions worldwide. All other trademarks are the property of their respective owners. ©2023 Zebra Technologies Corporation and/or its affiliates. All rights reserved.

Information in this document is subject to change without notice. The software described in this document is furnished under a license agreement or nondisclosure agreement. The software may be used or copied only in accordance with the terms of those agreements.

For further information regarding legal and proprietary statements, please go to:

SOFTWARE: zebra.com/linkoslegal.

COPYRIGHTS: zebra.com/copyright.

PATENTS: ip.zebra.com.

WARRANTY: zebra.com/warranty.

END USER LICENSE AGREEMENT: zebra.com/eula.

Terms of Use

Proprietary Statement

This manual contains proprietary information of Zebra Technologies Corporation and its subsidiaries ("Zebra Technologies"). It is intended solely for the information and use of parties operating and maintaining the equipment described herein. Such proprietary information may not be used, reproduced, or disclosed to any other parties for any other purpose without the express, written permission of Zebra Technologies.

Product Improvements

Continuous improvement of products is a policy of Zebra Technologies. All specifications and designs are subject to change without notice.

Liability Disclaimer

Zebra Technologies takes steps to ensure that its published Engineering specifications and manuals are correct; however, errors do occur. Zebra Technologies reserves the right to correct any such errors and disclaims liability resulting therefrom.

Limitation of Liability

In no event shall Zebra Technologies or anyone else involved in the creation, production, or delivery of the accompanying product (including hardware and software) be liable for any damages whatsoever (including, without limitation, consequential damages including loss of business profits, business interruption, or loss of business information) arising out of the use of, the results of use of, or inability to use such product, even if Zebra Technologies has been advised of the possibility of such damages. Some jurisdictions do not allow the exclusion or limitation of incidental or consequential damages, so the above limitation or exclusion may not apply to you.

Unpacking the Device

Unpacking the PS30 from the box.

- 1.** Carefully remove all protective material from the device and save the shipping container for later storage and shipping.
- 2.** Verify the following items are in the box:
 - PS30 Personal Shopper
 - Lithium-ion battery
 - Regulatory Guide.
- 3.** Inspect the equipment for damage. If any equipment is missing or damaged, contact the Global Customer Support Center immediately.
- 4.** Before using the device for the first time, remove the protective shipping film that covers the display.

Device Features

This section lists the features of the PS30 personal shopper.

Figure 1 Front View

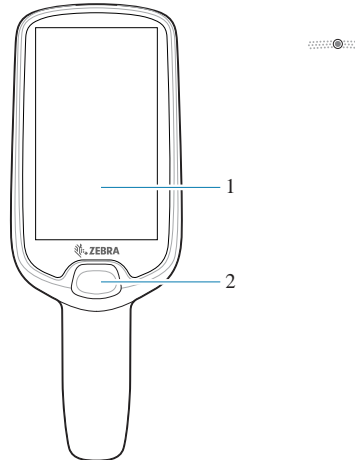
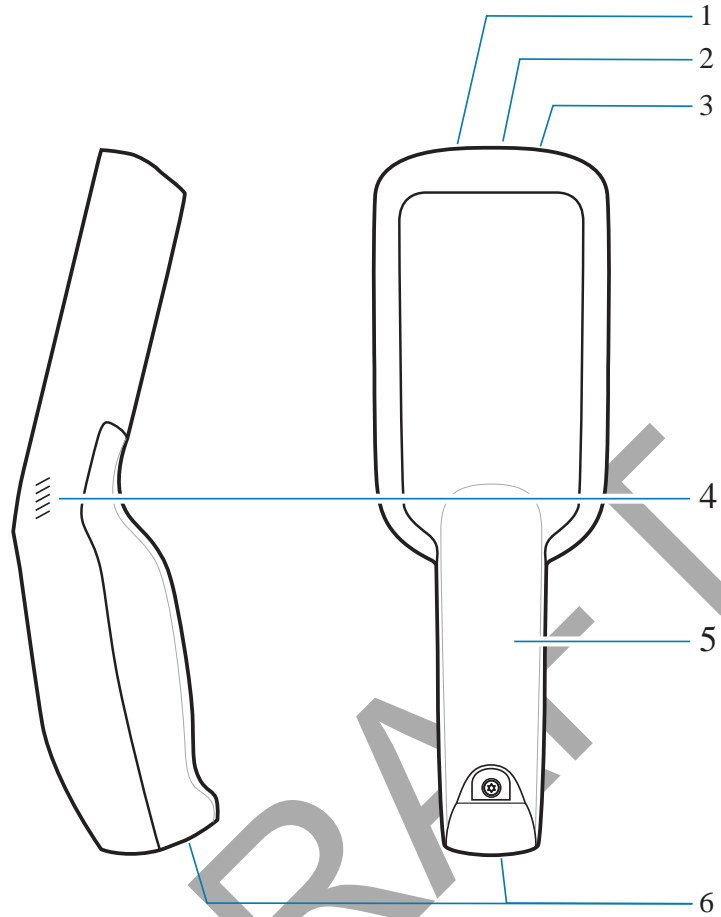

Table 2 Device Front View

Number	Item	Description
1	Touch screen	Displays all information needed to operate the device.
2	Power/Scan key	Use for trigger input for scanner or as a Select/Enter key. Operates the imager when a scanning application is active. Press and hold to turn on the device.

Figure 2 Side and Rear View**Table 3** Device Rear and Side View

Number	Item	Description
1	Camera	With the front-facing camera, the device supports Visible Light Communications (VLC) indoor positioning/ locationing applications. In addition, the camera is used for image/face recognition. Available on Plus configurations.
2	Scan exit window	Provides data capture using the scanner.
3	Microphone	Use for audio input and SmartLens locationing. Allows shoppers to speak to a store associate via push-to-talk or to a virtual assistant via speech-to-text.
4	Speaker	Provides audio output for video, music, notifications.
5	Battery cover	Encloses the battery and attaches to the device's handle.
6	Power/Cradle I/ OConnector	Provides charging via cradle and cradle communication to lock/unlock the cradle slots. Use to perform a hard reset with the terminal reboot tool.

2. Insert the PS30 into a cradle. The PS30 turns on and begins charging.

Figure 3 Single Slot Cradle

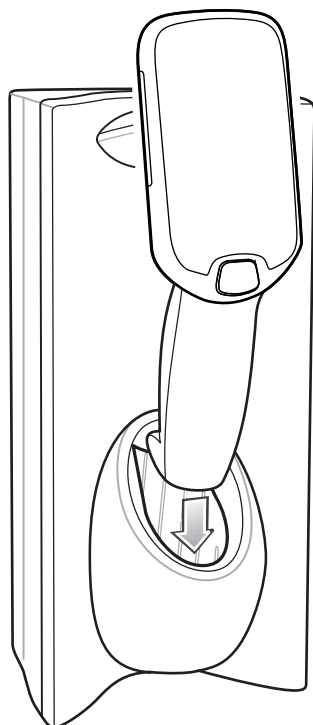
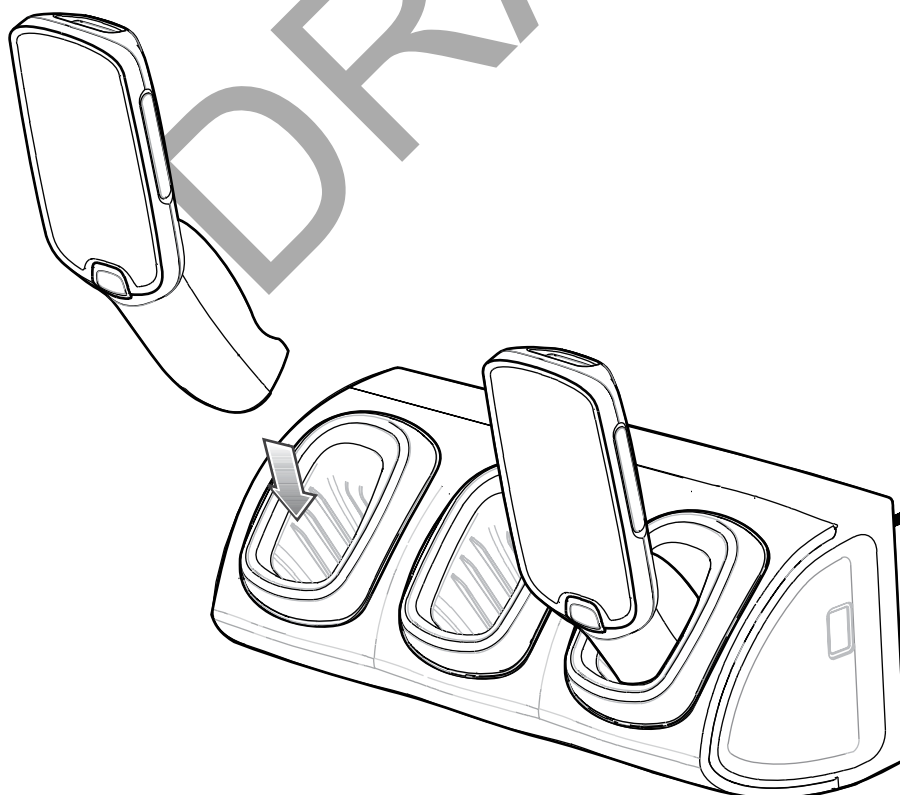

Figure 4 Three Slot Cradle



The battery charges 0 to 90% depending on the following conditions, measured at room temperature:

- When connected to a 1.0 cradle (normal charge mode), the charge time is less than 4 hours.
- When connected to a 1.5 cradle (fast charge mode), the charge time is less than 3 hours.



NOTE: To charge the device battery, Zebra recommends using the charging cradle instead of the USB cable because it is more time-efficient.

Replacing the Battery

Replacing the battery in the PS30.

1. Touch and hold the soft power button until the menu appears.
2. Touch Power Off.
3. Touch OK.



CAUTION: The PS30 must be off before removing the battery. Failing to turn off the PS30 before removing the battery may damage the data stored on flash memory or corrupt the operating system files.

4. Loosen the captive screw that secures the battery cover, using a Phillips (PH00) screwdriver.
5. Lift the battery cover from the handle.
6. Inside the battery compartment, press down the plastic tab of the battery cable connector and slide it out of the shrouded male pin connector.
7. Press down the plastic tab to release the battery, and remove the battery from the battery compartment.

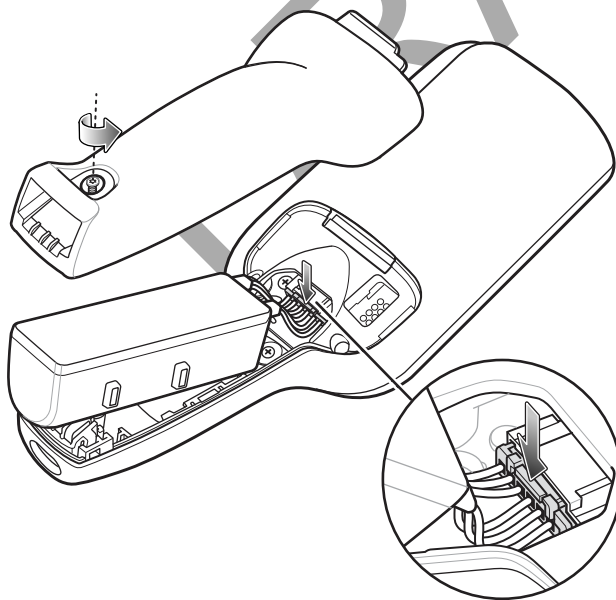

8. With the replacement battery, guide and press the battery cable connector into the shrouded male pin connector inside the battery compartment. The connector is designed to only fit one way.
9. Place the battery inside the battery compartment.

10. Place the battery cover onto the handle.
11. Secure the battery cover with the screw, using a Phillips (PH00) screwdriver.

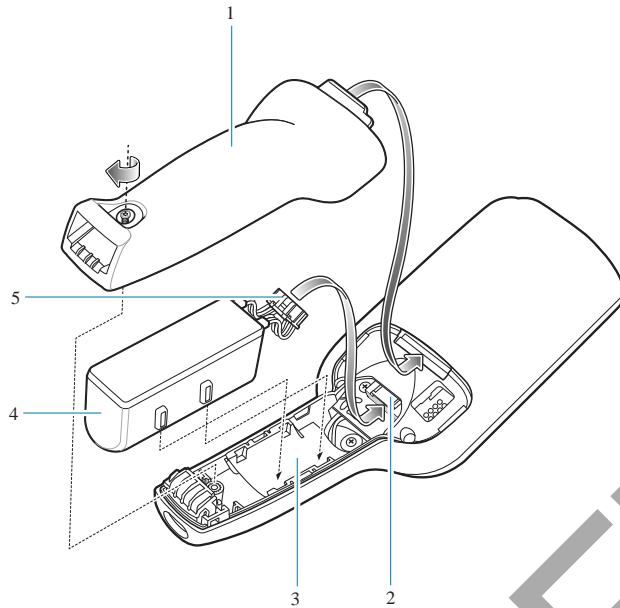

1	Battery cover
2	Shrouded male pin connector
3	Battery compartment
4	Battery
5	Battery cable connector

Releasing the Device from the Charging Cradles

Use one of the following methods to release the PS30 from the charging cradles:

- Software Release Using the Menu
- Software Release Using the Cradle Utility
- Manual Release using a Release Key.



NOTE: Devices can also be removed via any customer application that used the EMDK personal shopper interface.

Software Release Using the Menu

The device cradles contain a locking mechanism that locks the device inside the cradle when docked. The device releases from the cradle when a software command is received from the system.

1. Touch and hold the soft **Power** button until the menu appears.
2. Touch **Cradle unlock**.

The cradle unlocks the PS30.

3. Remove the PS30 from the cradle.

Software Release Using the Cradle Utility

The device cradles contain a locking mechanism that locks the device inside the cradle when docked. The device releases from the cradle when a software command is received from the system.

1. On the Home screen, swipe up from the bottom of the screen.
2. Touch **CradleUtility**.
3. Tap the **CRADLE UNLOCK** tab to set the cradle unlock information.
4. Touch **Unlock Cradle**.

Manual Release Using a Release Key

The device cradles contain a locking mechanism that locks the PS30 inside the cradle when docked. If the device fails to unlock during normal operation, use a release key (KT-MC18-CKEY-20) to unlock the device.



CAUTION: Do not use any device to unlock the cradle other than the tools described below. Failure to comply could result in damage to the cradle and void the warranty.

Manual Release of the Device from the Single Slot Cradle

1. Insert the release key into the slot located at the bottom side of the cradle.
2. While pressing the release key all the way into the slot, remove the device from the cradle.

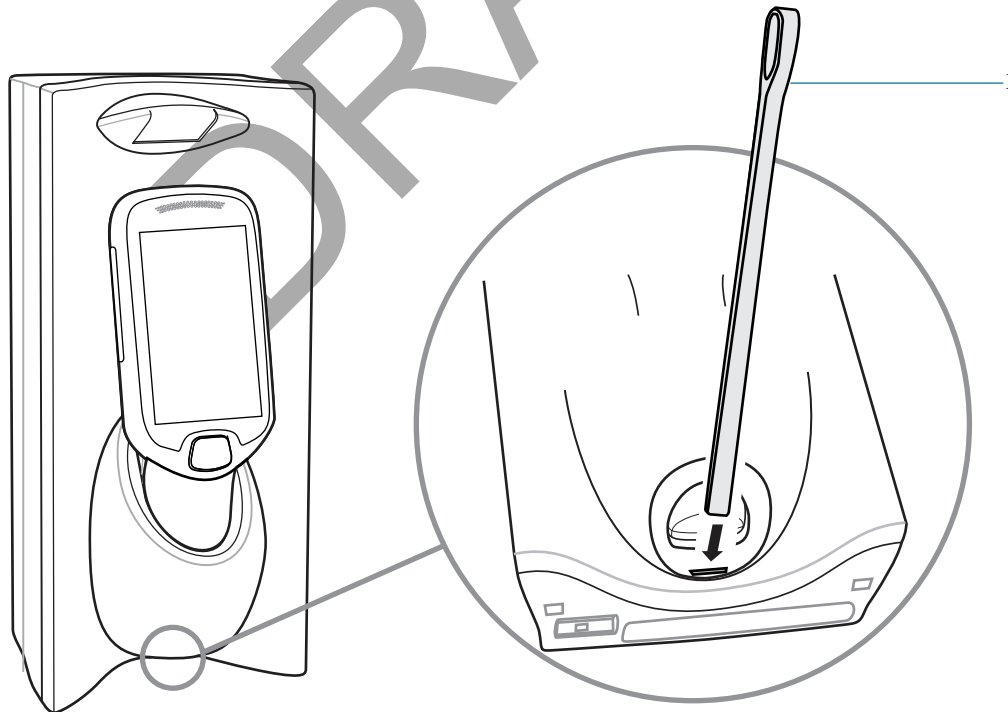

1

Release key

Manual Release of the Device from the Three Slot Cradle

1. Insert the release key straight into the slot, to a point where the bend stops.
2. Hold the release key pressed inside the slot and remove the PS30 from the slot.

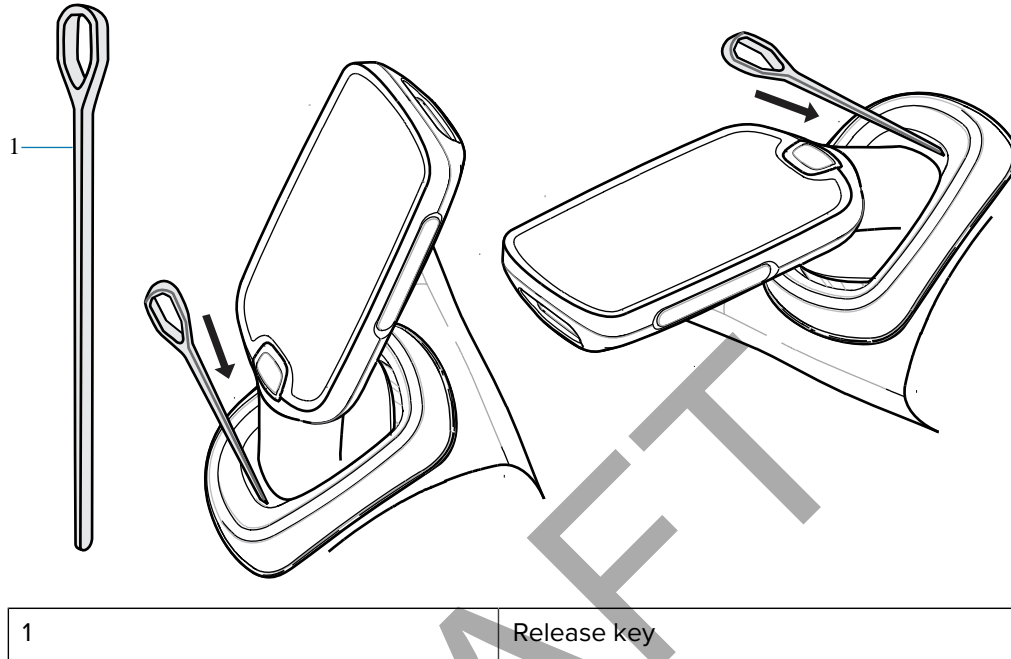

Installing the USB Programming Cable

1. Power off the device.
2. Remove the standard battery cover that comes installed on the device, if it is not already removed.
 - a) Loosen the captive screw that secures the battery cover, using a Phillips (PH00) screwdriver.
 - b) Lift the battery cover from the handle.

3. Slide the tab at the top of the battery cover with the USB programming cable into the slot on the back of the device.

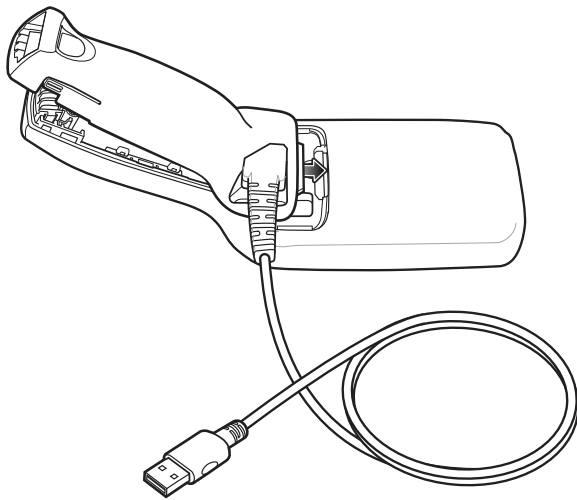

4. Push the bottom of the battery cover down until it snaps into place.

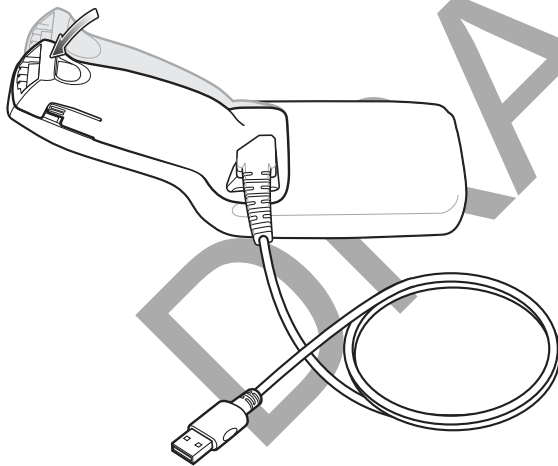

Removing the USB Programming Cable

1. Lift the bottom of the battery cover up.

2. Slide the top of the battery cover out to remove.

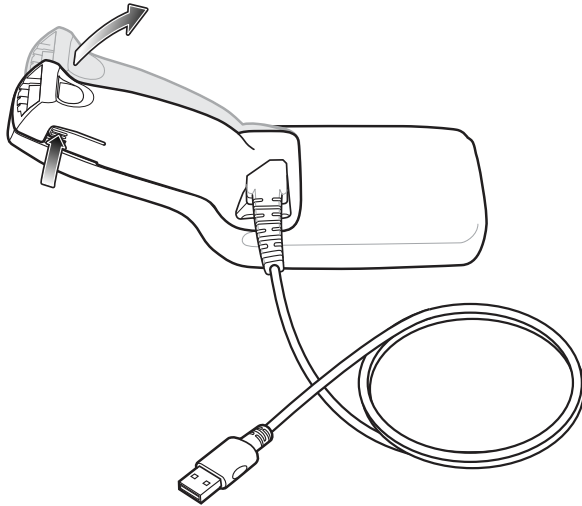

Soft Holster

The soft holster provides a holder for the MC18/PS30 and allows for wearing the device on the hip, using a belt clip, or crossbody, using the detachable shoulder strap.

Always place the device with the correct orientation when using the soft holster with a belt clip or shoulder strap, as shown in the following diagrams.

Using the Belt Clip

1. Secure the belt clip on the soft holster, if it is not already attached.

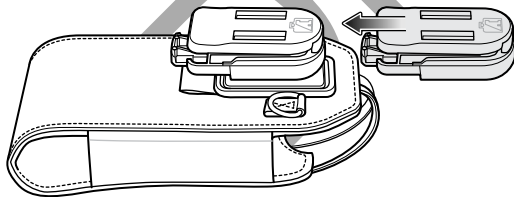

2. Secure the belt clip on the belt or waistband.

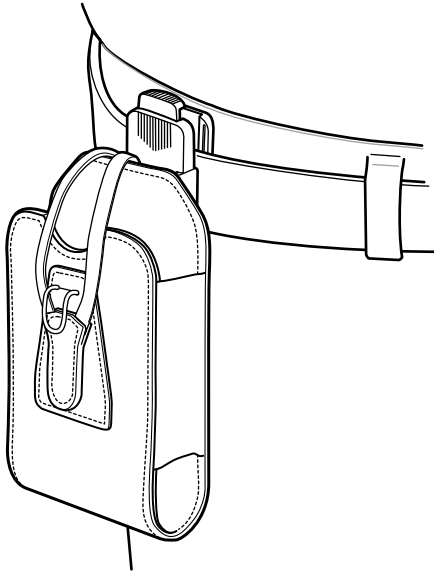

3. To insert the device, slide the device into the soft holster, with the screen facing the user.

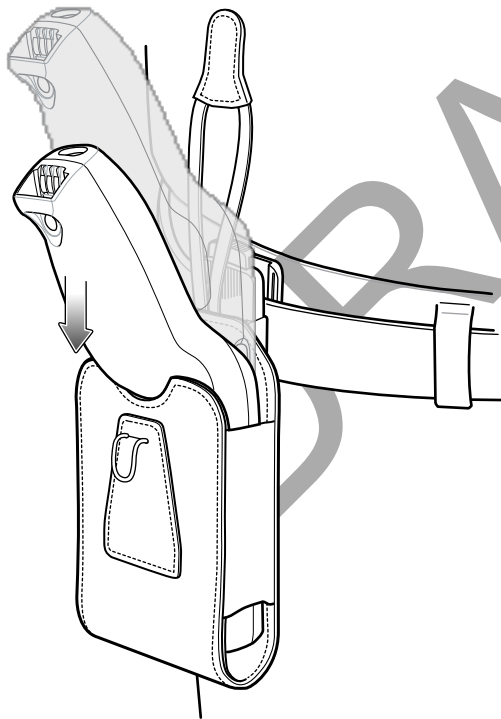

4. Secure the device with the restraining strap and place over the device and hook to secure in place.

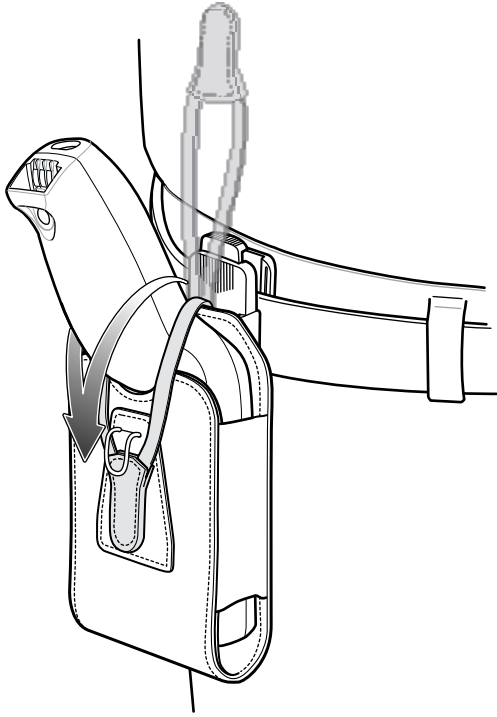

5. To remove the device, lift the restraining strap to release. Lift the device out of the soft holster.

Using the Shoulder Strap

1. Connect the clips on the shoulder strap to the rings on the soft holster, if not already attached.

2. Place the shoulder strap over your head and rest on your shoulder.



3. Lift the strap and insert the device into the soft holster, with the screen facing the user.
4. Secure the device with the restraining strap and place over the device and hook to secure in place.

Scanning Barcodes

Use the PS30 to capture barcode data.



NOTE: To read a barcode, a scan-enabled app is required. The device contains the DataWedge app, which allows you to enable the scanner to decode barcode data and display the barcode content.

To scan a barcode:

1. Launch a scanning application.
2. Press the Scan key and aim the device at a barcode.

A red aiming dot, used for increased visibility in bright lighting conditions, displays.

3. Adjust the position of the device so that the red aiming dot appears at the center of the barcode.
Ensure that the barcode is within the area formed by the aiming pattern.

Figure 5 SE4710 Imager Decode Mode

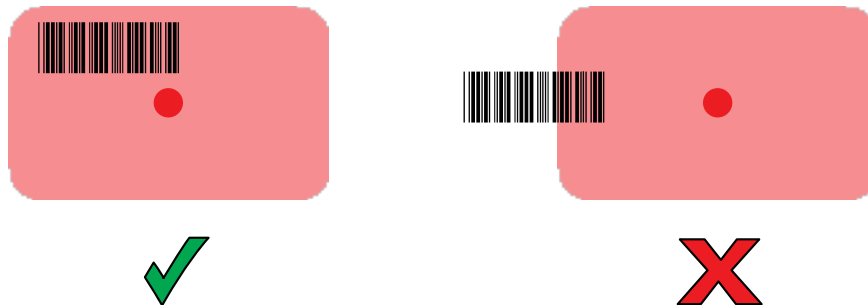
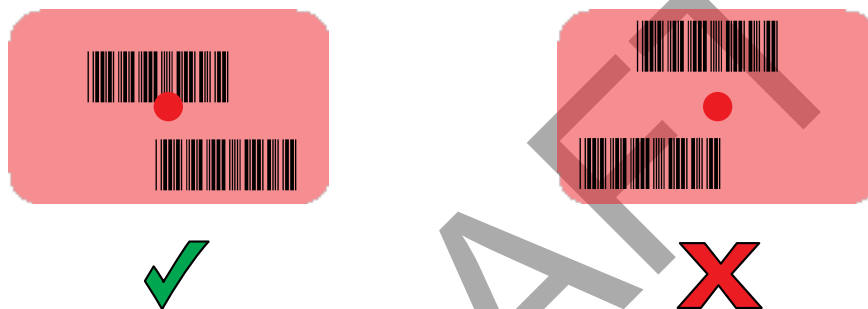

Figure 6 SE4710 Imager Picklist Mode



NOTE: When the PS30 is in Picklist Mode, the imager does not decode the barcode until the crosshair or aiming dot touches the barcode.

4. Release the Scan key.

The barcode data displays on the screen.

Ergonomic Considerations

Follow these ergonomic guidelines when using the device.

Zebra recommends taking breaks and rotating tasks to prevent strain.

Avoid Bending

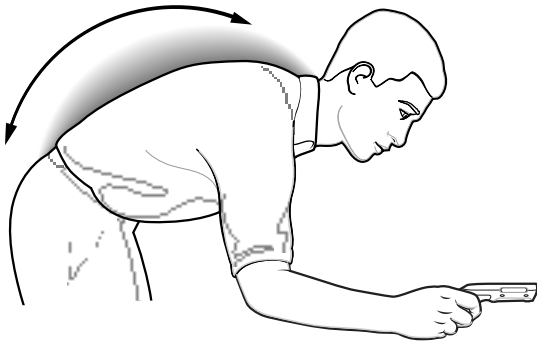

Avoid Reaching



Avoid Extreme Wrist Angles

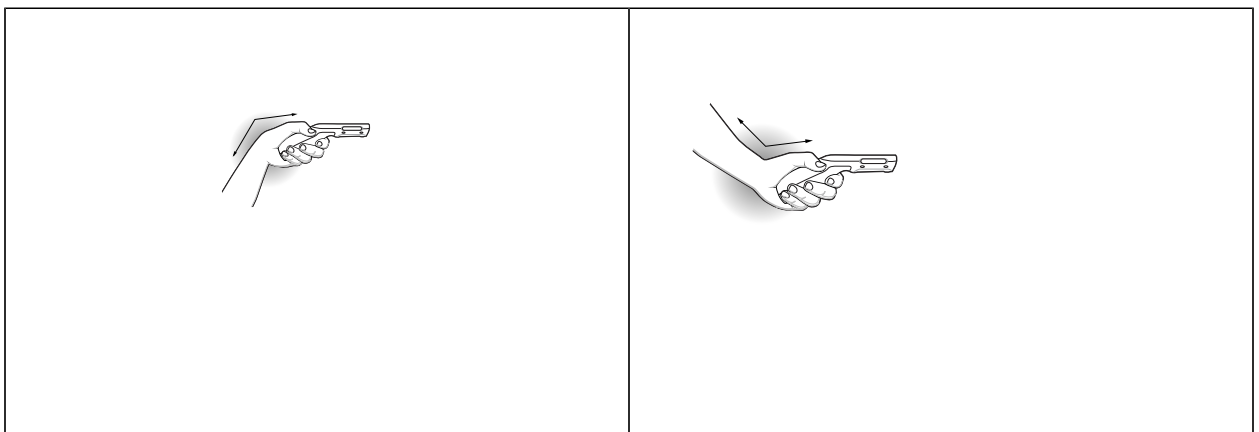

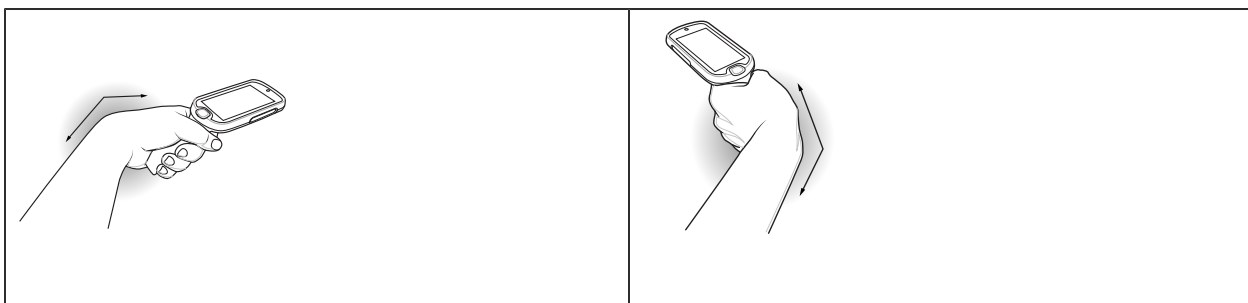

DRAFT

DRAFT