

Rhein Tech Laboratories, Inc.
360 Herndon Parkway
Suite 1400
Herndon, VA 20170
<http://www.rheintech.com>

Client: Zylaya Corporation
Model Name: ZSEN
Standards: FCC 15.247/IC RSS-210
FCC/IC ID: UVV-ZSEN/7070A-ZSEN
Report #: 2007146

Appendix K: Manual

Please refer to the following pages.

INDOOR SENSOR INSTALLATION INSTRUCTIONS



GENERAL INFORMATION

Federal Communications Commission and Industry Canada Compliance. This equipment has been tested and found to comply with the limits for a Class B digital device, pursuant to Part 15 of the FCC rules and with IC rules set in RSS-210. These limits are designed to provide reasonable protection against harmful interference in a residential installation. The equipment generates, uses, and can radiate radio frequency energy and, if not installed and used in accordance with the instructions, may cause harmful interference to radio communications.

However, there is no guarantee that interference will not occur in a particular installation. If this equipment does cause harmful interference to radio or television reception, which can be determined by turning the equipment off and on, the user is encouraged to try to correct the interference by one or more of the following measures:

- Reorient or relocate the radio or television receiving antenna.
- Increase the separation between the computer equipment and receiver.
- Connect the equipment to an outlet on a circuit different from that to which the radio or television receiver is connected.
- Consult the dealer or an experienced radio television technician for help.



Changes or modifications not expressly approved by Zylaya could void the user's authority to operate this equipment.



This radio meets the FCC RF exposure guidelines when used with Zylaya accessories supplied or designated for this product. Use of any other accessories may not ensure compliance with these guidelines.



Use of any other transmitting devices within 20cm (8 in) of this radio could void the user's authority to operate this equipment.



BEFORE YOU INSTALL

Tools you will need:

- Ladder, scaffold, or personnel hoist
- Power and hand tools
 - Drill, various bits
 - Hammer
 - Utility knife
 - Indoor Installation kit (includes hardware for typical installations)
 - Phillips screwdriver
 - Tape measure

Locate an appropriate place for the Sensor and Battery. If the Battery will be installed above a dropped ceiling, make sure there is just enough slack in the battery cable from the Battery location to the Sensor location to comfortably attach and reattach the battery cable from either end.

DO NOT affix the Sensor and Battery:

- To hot water supply pipes
- To plenums, fan-powered boxes, or similar HVAC fixtures
- Above, below or directly adjacent to lighting fixtures
- To electrical conduit (flex or rigid), free or bundled telecommunications or security wires
- To any location that could cause mechanical interference with the proper operation of other building safety and security systems, i.e. sprinkler systems, etc.

DO affix the Sensor and Battery:

- To dropped ceiling support grids, support wires or structures
- To drywall, concrete, or brick walls
- Above a dropped ceiling (Battery only), to cable trays or similar structures capable of supporting an additional 5 lbs or 2.3kg



Watch surrounding areas for electrical hazards, lighting fixtures, plumbing fixtures and pipes, and/or HVAC or other environmental fixtures such as vents, grates, or exhaust fixtures. Do not install the Sensor or Battery within 12" of these types of fixtures or similar machines.

1a

DROPPED CEILING BATTERY INSTALLATION

For installations where the Battery will be located above a dropped ceiling, begin by removing a ceiling tile directly adjacent to the desired mounting location of the Sensor. The Battery should be installed anywhere above the Sensor *within the length of the Battery Cable* to a suitable location such as a dropped ceiling support:

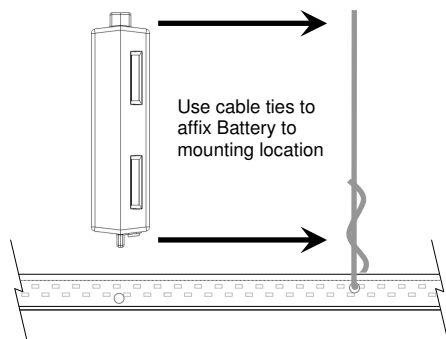

1b

SOLID WALL BATTERY INSTALLATION

For installations where the Battery cannot be installed above a dropped ceiling or where a dropped ceiling is not available, the Wall Mount Battery Holder must be installed. Install the Battery Holder 7" to 12" below the finished ceiling height. Be sure to use the mounting hardware that corresponds to the wall material (i.e. drywall anchors for drywall mount, etc.)

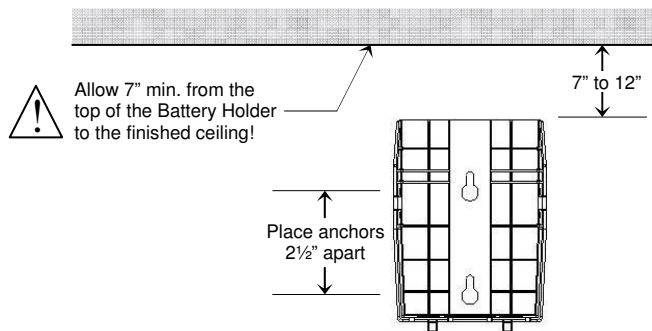

2a

DROPPED CEILING SENSOR INSTALLATION

For installations where the Sensor will be affixed to a dropped ceiling or on a wall below or adjacent to a dropped ceiling mounted Battery:

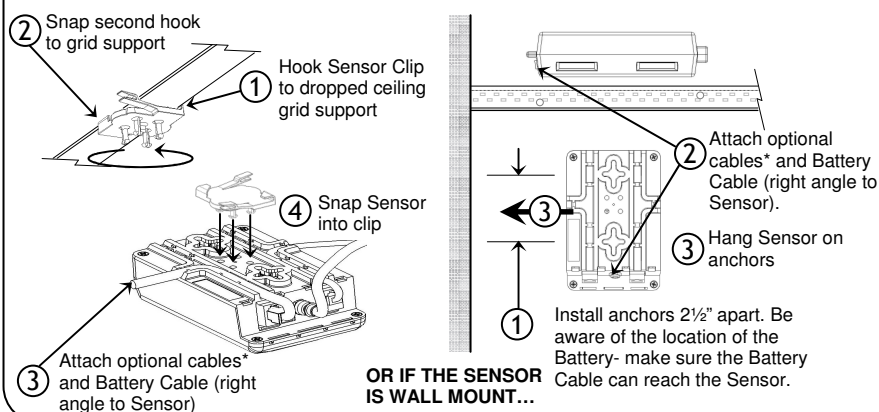

2b

SOLID WALL SENSOR INSTALLATION

For installations where the Battery Holder was used (Step 3b), the Sensor can be installed onto the Battery Holder bracket:

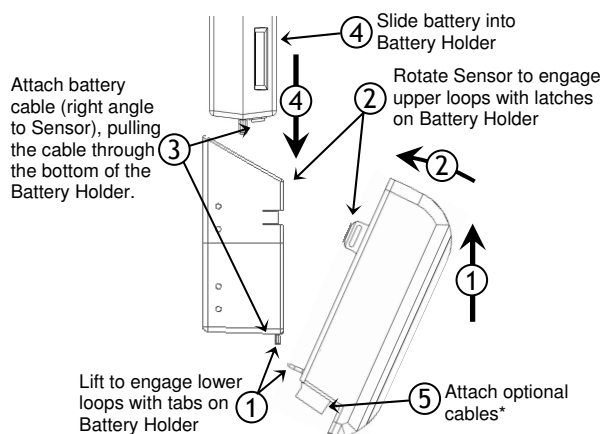

3

ATTACH THE CABLE SHROUD

Once the Sensor and Battery are installed and all necessary cables are connected, attach the Cable Shroud:

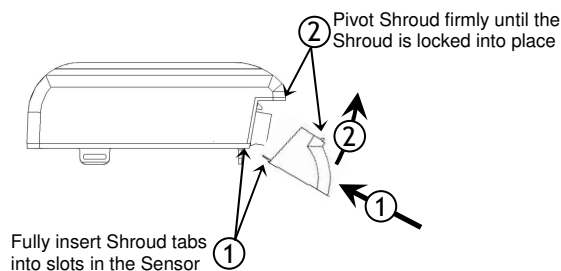

QUESTIONS OR CONCERNS?

Product Support is available by telephone between 9:00am and 5:00pm EST in the U.S. and Canada 301-740-3825

Product Support Tip- be prepared to provide the following information:

- Name, address, and telephone number
- The name of the Zylaya product
- Model and option (if applicable) of the Zylaya product
- Symptoms of the problem

*Additional cables are required if the Sensor is equipped with the ZLPA001 Panic Alarm Option, the ZGWM001 Gateway Option or both. Check the documentation for these options for additional information regarding these interfaces and connections.

