

Hardware Installation Guide

1. Power off the PC. Do not operate when power on.
2. Open PC case
3. Set MASTER or SLAVE mode.

If your PC support only one E-IDE or has only one E-IDE cable, please set HDD as MASTER mode and set DW18XX as SLAVE mode. See Chart No.1

If your PC has two E-IDE cable and only DW18XX as optical storage drive, it is recommended to set HDD and DW18XX as MASTER mode and insert into Primary and Secondary slot respectively. See Chart No.2

If your PC has two E-IDE cables and two optical storage drive, it is recommended to set HDD as MASTER mode and insert into Primary slot ; set two optical storage drives as MASTER and SLAVE mode respectively, insert into Secondary slot. See Chart No.3

4. Put optical storage in and fasten screw.
5. Connect E-IDE and 4pin power, please be attention to the direction See chart No.4 Item 6,7 as optional
6. Connect analog audio line with Sound card(need Sound card supported) See Chart No.4
7. Connect digital audio line with Sound card(need Sound card supported) See Chart No.4
8. Close PC case
9. Power on the PC. System will auto recognize DW18XX.

Caution:

-----Do not attempt to disassemble DW18XX to avoid eyes exposure to laser emanations (harmful to human eyes).

-----Ensure power supply to DW18XX comply with 5V \pm 5% and 12V \pm 10%

Software Installation Guide

-----Please refer to Hardware Installation Guide for details on how to install your new optical drive before installation the bundled software.

-----The software CD contents: Nero recording, hardware installation guide and software installation guide.

1. Close all other running programs.
 2. Insert software CD into the CD-ROM drive of your PC. The CD should automatically run and software installation menu should appear on screen.(Or double click autorun.exe)
 3. Follow the on screen instructions to complete the installation.
- Suggesting refer to Nero help file and know more about Nero.

FCC Statement

NOTE: This equipment has been tested and found to comply with the limits for a class B digital device, pursuant to Part 15 of the FCC Rules. These limits are designed to provide reasonable protection against harmful interference in a residential installation. This equipment generates, uses and can radiate radio frequency energy and, if not installed and used in accordance with the instructions, may cause harmful interference to radio communications.

However, there is no guarantee that interference will not occur in a particular installation. If this equipment does cause harmful interference to radio or television reception, which can be determined by turning the equipment off and on, the user is encouraged to try to correct the interference by one or more of the following measures:

1. Reorient or relocate the receiving antenna
2. Increase the separation between the equipment and receiver.
3. Connect the equipment into an outlet on a circuit different from that to which the receiver is connected.
4. Consult the dealer or an experienced radio/TV technician for help.

Amtec

Amtec

DVD Re-Writer

硬件安装指南

软件安装指南

Hardware Installation Guide

Software Installation Guide

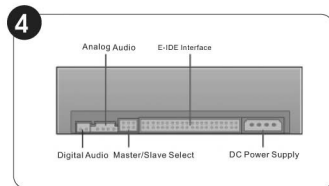
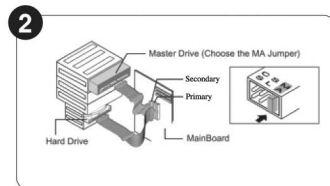
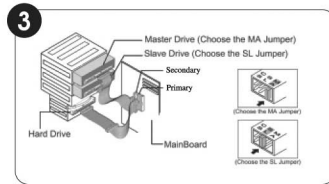
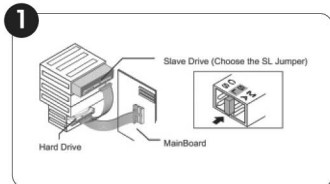

CAUTION

⚠ Use of any controls or adjustments or procedure other than those specified herein may result in Hazardous radiation exposure.

⚠ To prevent exposure to laser emanations (harmful to human eye), do not attempt to disassemble this unit.

⚠ Plug off the power cord before installation

Warning: Changes or modifications to this unit not expressly approved by the party responsible for compliance could void the user's authority to operate the equipment.

硬件安装指南:

1. 关闭电脑电源。切忌带电操作。
 2. 打开机箱盖。
 3. 设置主 (MA) 从 (SL) 模式。
如果电脑只支持一条 E-IDE 线或者只有一条 E-IDE 线:
硬盘设为主模式(MA), DW18XX 设为从模式 (SL)。如图1
如果电脑有两条 E-IDE 线, 且只有 DW18XX 一个光驱:
推荐硬盘和 DW18XX 都设为 MA, 分别插在两个主板插槽上(PPrimary and Secondary)。如图2
如果电脑有两条 E-IDE 线, 且有两个光驱:
推荐硬盘设为 MA 插在其中一个主板插槽 (Primary), 两个光驱分别设置成主(MA) 模式, 从 (SL) 模式插在另外一个插槽 (Secondary)。如图3
 4. 放置光驱, 并锁紧螺丝。
 5. 连接 E-IDE 线和 4pin 电源线, 注意缺口方向。如图4
下面 6, 7 为可选项:
 6. 连接模拟音频线到声卡 (需要声卡支持)。如图4
 7. 连接数字音频线到声卡 (需要声卡支持)。如图4
 8. 合上电脑机箱盖。
 9. 通电, 系统将自动识别到 DW18XX 光驱。
- 注意:
-----请勿拆解 DW18XX 避免眼睛被光头发出的激光直射。
-----确保供给 DW18XX 的电源符合 5V \pm 5% 和 12V \pm 10%。

软件安装指南:

- 软件安装之前, 请正确安装光驱。参阅“硬件安装指南”。
-----随机光盘中包含: Nero 刻录软件, 硬件安装指南, 软件安装指南。
1. 关闭执行中的应用程序。
 2. 放入随机光盘, 自动出现安装菜单界面。(或在文件管理器中双击 autorun.exe)
 3. 按照安装指南, 完成 Nero 软件的安装。
- 建议参阅 Nero 软件帮助文件, 了解 Nero 强大丰富的功能。

Amtec

Amtec