

LABEL DRAFT

FCC/IC LABEL DRAFT

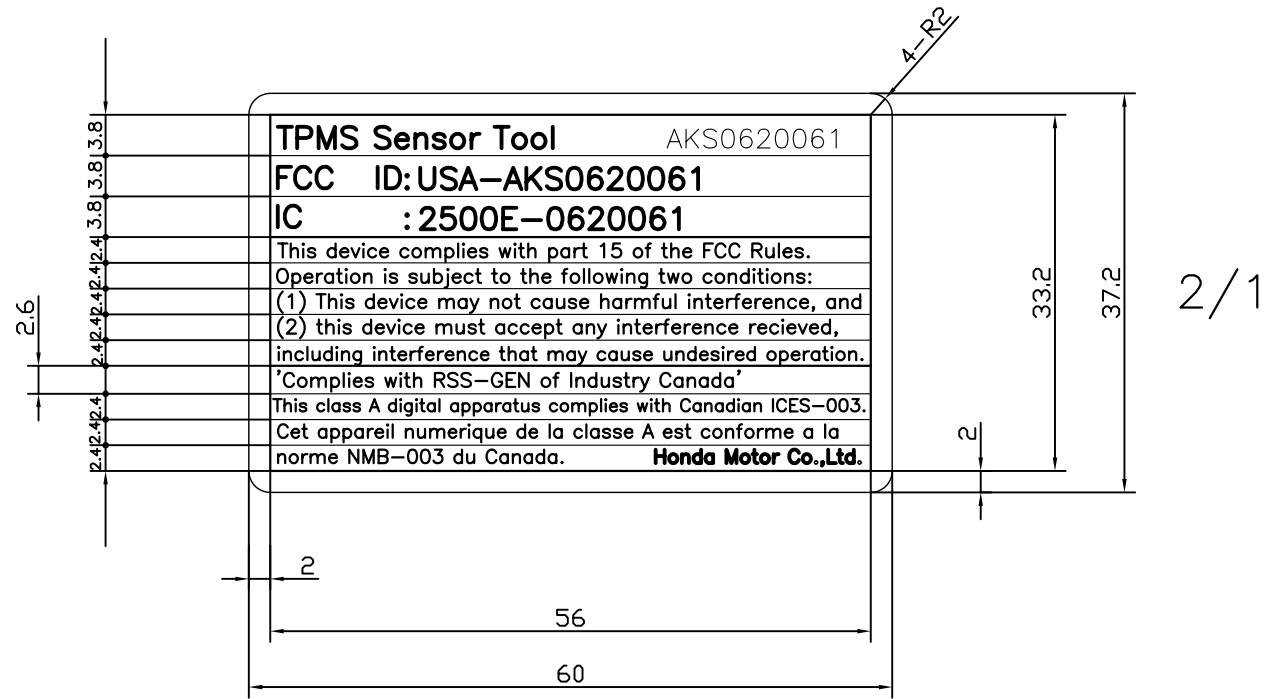

2/1

TPMS Sensor Tool	AKS0620061
FCC ID:USA-AKS0620061	
IC :2500E-0620061	
This device complies with part 15 of the FCC Rules.	
Operation is subject to the following two conditions:	
(1) This device may not cause harmful interference, and	
(2) this device must accept any interference received, including interference that may cause undesired operation.	
'Complies with RSS-GEN of Industry Canada'	
This class A digital apparatus complies with Canadian ICES-003.	
Cet appareil numerique de la classe A est conforme a la norme NMB-003 du Canada.	
Honda Motor Co.,Ltd.	

2/1

TPMS Sensor Tool	AKS0620061
FCC ID:USA-AKS0620061	
IC :2500E-0620061	
This device complies with part 15 of the FCC Rules.	
Operation is subject to the following two conditions:	
(1) This device may not cause harmful interference, and	
(2) this device must accept any interference received, including interference that may cause undesired operation.	
'Complies with RSS-GEN of Industry Canada'	
This class A digital apparatus complies with Canadian ICES-003.	
Cet appareil numerique de la classe A est conforme a la norme NMB-003 du Canada.	
Honda Motor Co.,Ltd.	

1/1

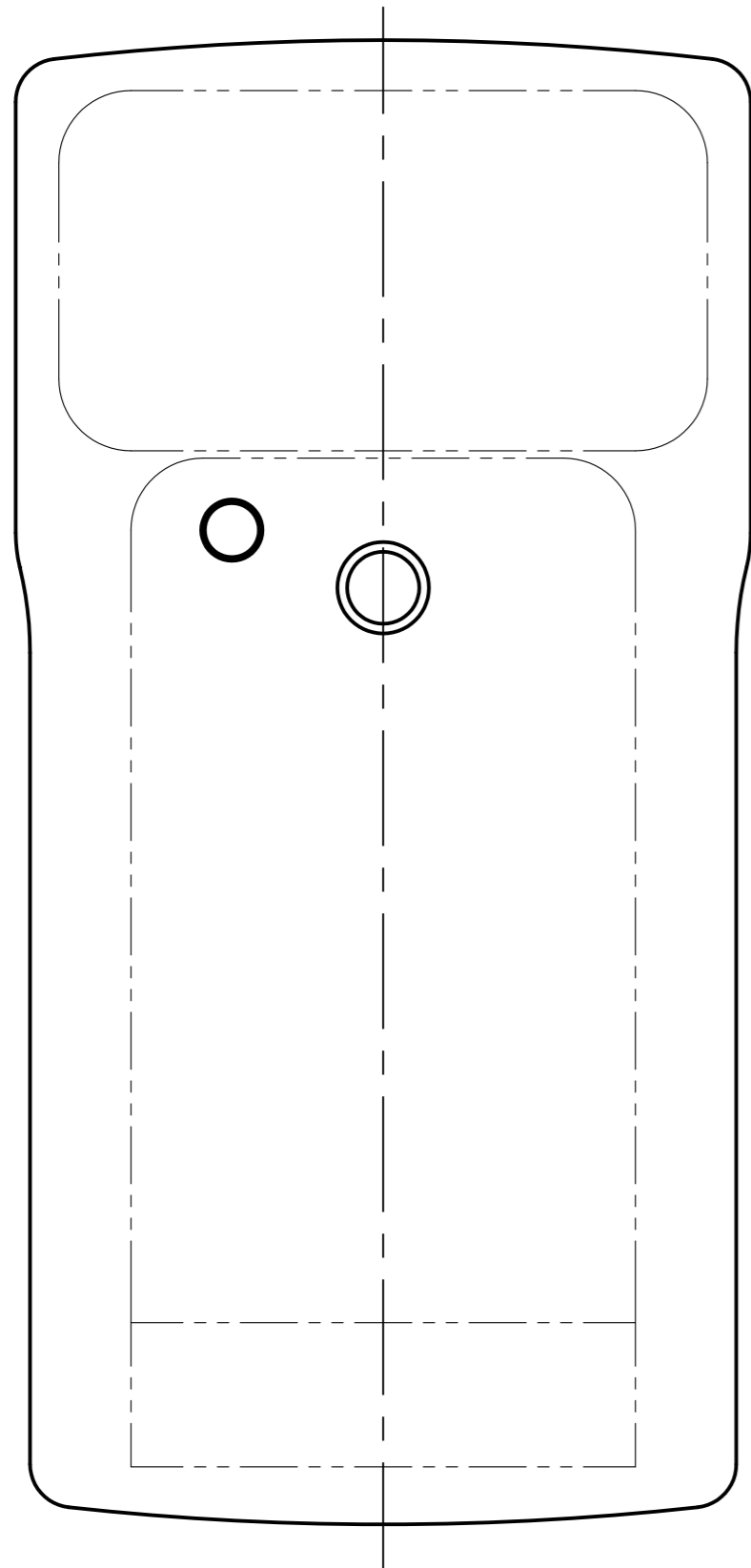

Top View

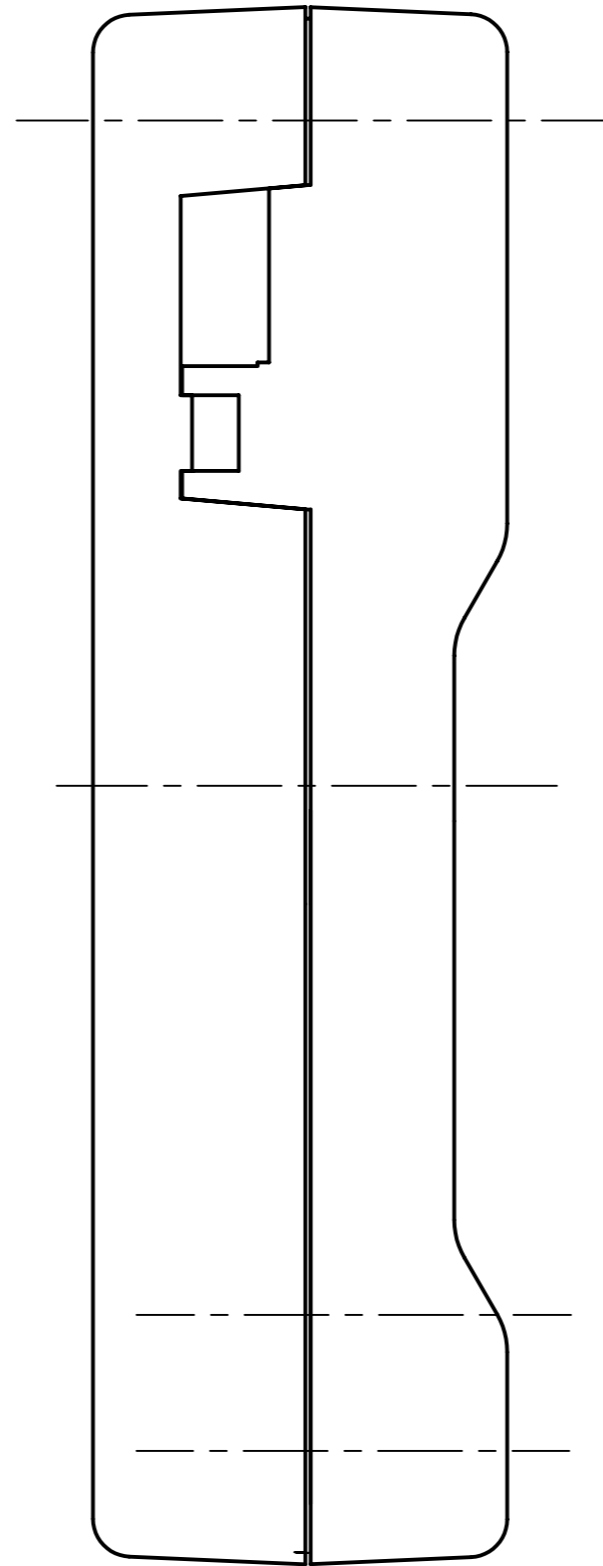

Side View

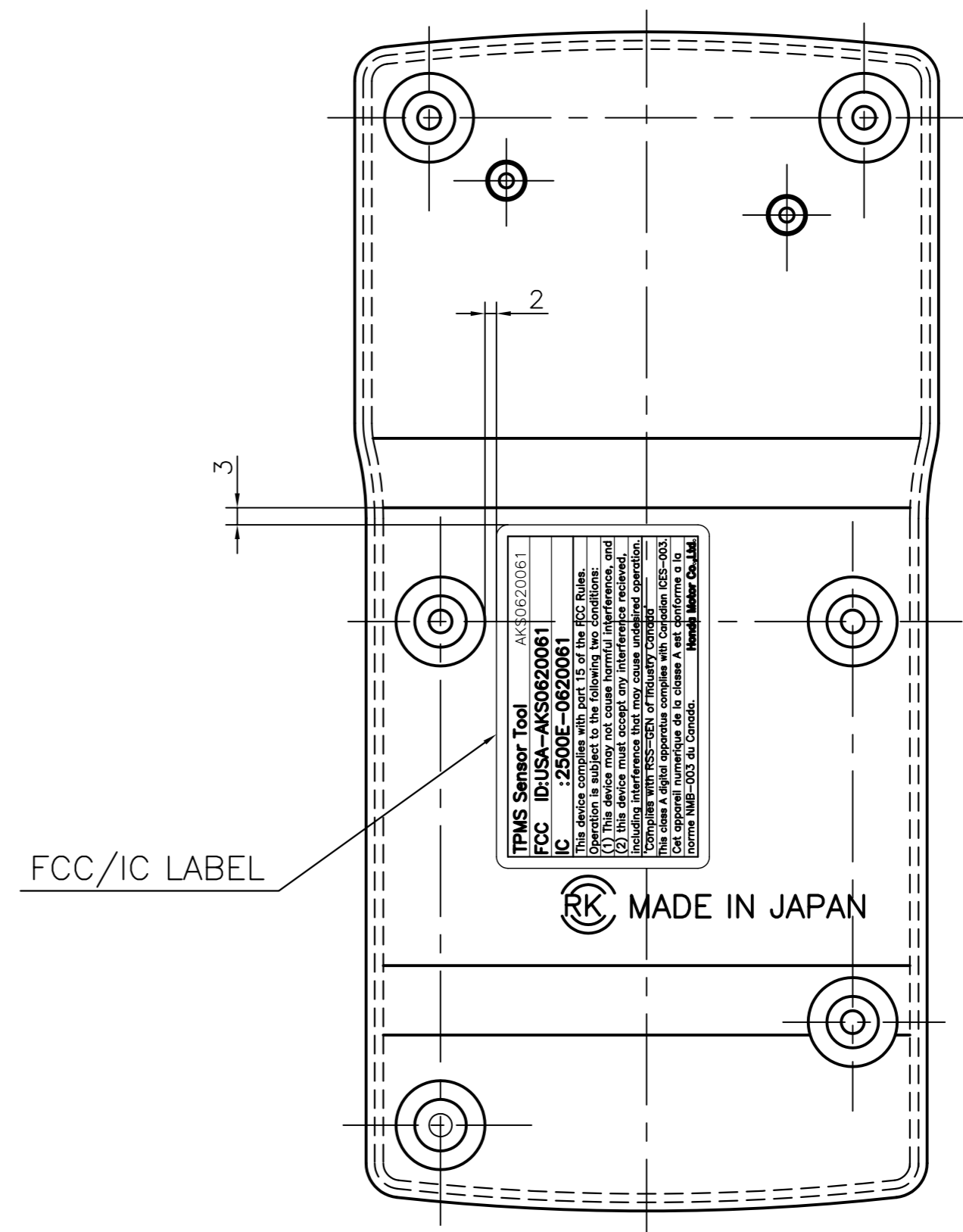

Bottom View
(LABEL LOCATION)

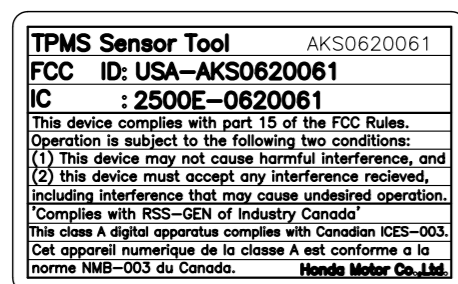

LABEL Spec.

- 1.Material:Polyethylene terephthalate was coated to aluminum seat.
- 2.Paste:Modacrylic solvent type strong sticking type.
- 3.Lamination material: Polypropylene 50% and polyethylene 50%

SPECIFICATION		SCALE		MATERIAL		MASS R T M	
(H)	(Q)	(NF)					
APPLICABLE DWG.		DRAW	DESIGNED	RESPONSIBLE		kg	
		Tanaka	Tanaka	D			
		2006-11-15		P			
		NAME					
		FCC/IC LABEL SPEC. & LOCATION					
		AKS-0620061 LABEL LOCATION					
NEW DRWING		2006	11/15	-	-		
(REFERENCE) REVISION RECORD		DATE	DR	CHK			