

## 1.5m (Outdoor Version) Instructions For

Model Name:WS-22001

### 1. BLUETOOTH PAIRING

Power on after long pressing the power button for 3 seconds, then turn on the phone bluetooth to enter search condition, and click "Dispho" in the searched equipment. Green light of the remote control will be off after connected.

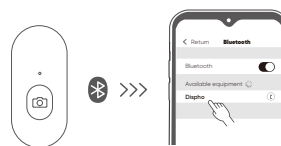

### 2. USE TRIPOD

This product comes with a tripod. Open the selfie holder from the bottom and fix it on a steady horizontal plane.

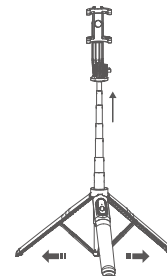

### 3. FIX THE PHONE

Rotate the phone holder till you can pull open the holder handle and fix the phone securely on the holder.

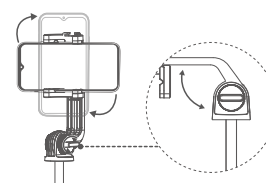

### 4. UNIVERSAL COLD SHOE PORT (OPTIONAL)

The cold shoe port can be connected to the adaptable live broadcast accessories to expand the multi-functional usage scenarios.

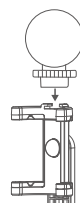

### 5. REPLACE THE ACCESSORIES

Take the bracket off and put it Screw installation.

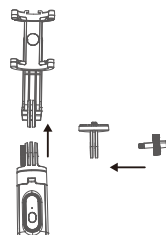

### 6. UNIVERSAL 1/4 BRITISH SCREW ROD

The 1/4 British Screw Rod can be connected to the adaptable live broadcast accessories to expand the multi-functional usage scenarios.



### Battery replace of the remote control

Remove rear cover of remote controller and replace button battery (CR1632).

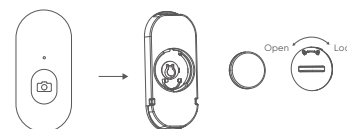

\*On first use, remove rear cover of remote controller and take insulator out of battery chamber.

### Warnings

1. Watch your hands during use.
2. The product is not designed for children under 14 years old. Do not swallow it.
3. Do not dismantle or modify the product.
4. Do not store the product in a humid environment.
5. Keep the product away from heat sources.
6. Do not expose the product to water or other liquids in case of damage.