

'DRUMI' Bluetooth wireless speaker (for smart phones; with NFC pairing function)

Product Features

- Big deco top design
- *Bluetooth® v3.0 wireless connection up to 10M
- NFC™ pairing function
- Superb sound portable speaker
- Built-in 3W amplified speaker
- Bass enhancer built-in
- Built-in battery rechargeable via. USB
- Speaker phone call-pick function
- Portable simplicity design
- AUX 3.5mm audio input
- Ideal audio mate for smart phones or other multimedia player devices



This superb sound stereo speakers is compliant with Bluetooth v3.0 wireless standard, and powered by its built-in battery which is rechargeable by USB port from. The simplicity drum shape casing is a stylistic desktop design which can be portable as well. An ideal wireless audio companion for smart phones.

Charging the speaker

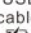
As shown (fig.1), connect the micro USB port with the charging cable and its USB plug with  marking to an USB port with power on the other end. Red LED will light up to indicate charging. When the speaker is fully charged (approx. in 1.5 hrs every recharging), LED will turn into blue.

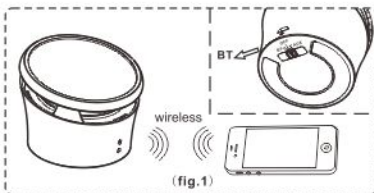

NFC™ Pairing with your phone

Turn on the slide switch to [BT] to switch on the speaker, and then If your smart phone is NFC enabled,

- Firstly, locate the NFC antenna spot on your smart phone (fig.2)
- NFC antenna is now 'at the top' of our BT-18N speakers (fig.2)
- Align NFC antennas as close as possible, you will hear a 'cling' sound when they matched (fig.3)
- Wait for a few second and you will hear a "Bloop" sound from the speaker and its blue LED will lit continuously. The pairing is completed now.

Note-

1. "The N-Mark is a trademark or registered trademark of NFC Forum, Inc. in the United States and in other countries."

2. Some phone models are NFC enabled, but their NFC Apps were not built-in. For these models you will need to install a NFC Apps and activate the NFC function on your phone- Please visit our website to download the driver installer : <http://www.manova.com.hk/download.php>

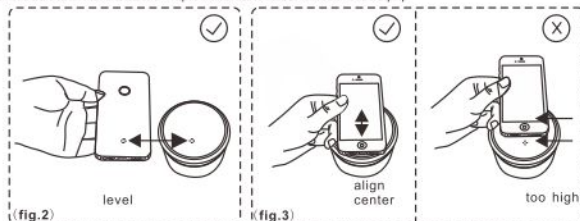

Pairing the speaker (manually)- if your phone is NOT NFC enabled.)

a.) Turn on the slide switch to [BT] to switch on the speaker, power is auto ON within 3 sec. and LED indicates blue on front. For first time use, the blue LED will be flashing fast (8 times every sec.) to show it is ready for pairing. Browse your smart phone Bluetooth device list found, and select the one named 'DRUMI' to confirm pairing on your smart phone. You will hear a beep tone on the speakers which is sent from your phone, and then the speakers' blue LED flashes steadily (1.5 times every sec.). Pairing connection is successful then.

b.) When you need to disconnect the speaker, you first switch off Bluetooth function on your smart phone, the speaker's blue LED will flash slowly (1 time every sec.) Then you switch to [OFF] (side switch to middle) the

speaker, the pairing memory will be then kept there.

Next time when you switch to [BT] to turn ON the speaker, it will automatically connect to your smart phone again and blue LED lit continuously (when your smart phone's Bluetooth function is also ON and nearby <5M).

c) If you need to pair the speaker with a new smart phone, switch off Bluetooth function on your old smart phone first. Then power on your new smart phone's Bluetooth function. After that switch OFF and switch to [BT] to power on the speaker until the speakers' blue LED will be flashing fast again (8 times every sec.), and then you repeat steps as in above paragraph a.).

Call-pick function

When speakers is connected to your smart phone (blue LED lit continuously), whenever there is an incoming call ring, you can operate your phone to select pick up and use it as speaker phone, or select to receive call from your phone.

How to Use / Controls

After switch to [BT] to turn ON speaker and paired to your phone as described above, you can adjust volume to desire level; select play songs ...etc. by operating your phone.

If battery power becomes low, there will be some beeping alert sound during playback, and LED flashes RED and BLUE quickly (8 times every sec., Red light interval every 4 sec.). Then charge the speaker as mentioned in above section. (You can play music at the same time while charging the built-in battery...)

Switch the button to [AUX] position. Then you can use the AUX 3.5mm audio cable connection to smart phones or other player devices for music playback (fig.4).

(You will need to operate the smart phone to resume music playback when you disconnect the AUX cable, and switch to [BT] position, and use it wireless again)

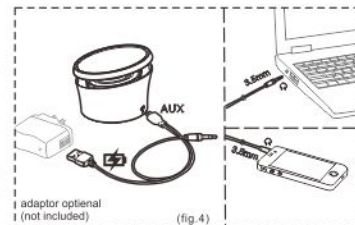

Specifications:

dimensions:
product weight:
bluetooth wireless connection
support multiple pairing:
driver:
frequency response (0dB at 1KHz):
amplifier output :
amplifier max. output :
signal to noise ratio:
operation voltage
built-in 3.7V Li-polymer rechargeable battery
battery charging voltage
battery charging current
battery charging time
drain current (power on, no input)
playback time
standby time

W 80 x D 80 x H 63 mm
180g
v3.0 +EDR; class II; typ. 8M
visible distance; max. 10M
up to 4 devices**
dia. 50mm
100 Hz ~ 20,000 Hz
2.2W (THD=10%, 1KHz@0dB)
2.7W (1KHz@0dB)
>60dB
min. 3V; max. 4.2V DC
typ. 5V; max. 5.5V DC (via. USB port)
500mA max.
1.5 hours.
20mA
~10hours(fully charged, volume at 1/3 level)
up to 18 hours

Note-

*The Bluetooth® word mark and logos are registered trademarks owned by Bluetooth SIG, Inc. and any use of such marks by Manova International Limited is under license. Other trademarks and trade names are those of their respective owners.

*Design and specifications are subject to change per technical needs, without prior notice

*This speaker supports pairing 'records' up to 4 devices, but NOT 'connection' to 4 devices at the same time

FCC WARNING

This device complies with Part 15 of the FCC Rules. Operation is subject to the following two conditions:

- (1) This device may not cause harmful interference, and
- (2) this device must accept any interference received, including interference that may cause undesired operation.

NOTE 1: Any changes or modifications to this unit not expressly approved by the party responsible for compliance could void the user's authority to operate the equipment.