

## **Introduction**

Thank you for buying a Mitsubishi Motors product.

In order to fully utilise the functionality of this product and ensure safe and correct operation, please read the "User Manual" carefully before operation.  
After reading the "User Manual", ensure this is kept readily available, and refer to it again if you do not understand any points, or in the event of problems.

# Table of contents

<b>Introduction</b>	
<b>Before Use</b> .....	<b>4</b>
Disclaimers.....	4
Important Points on Usage.....	4
Restrictions on Operations while the Vehicle Is Driving.....	5
How to Clean.....	5
Trademarks.....	5
<b>Important Points on Safety for the Customer.....</b>	<b>8</b>
<b>How to Read This Manual.....</b>	<b>9</b>
<b>Basic Operation</b> ..... <b>10</b>	
<b>This Product.....</b>	<b>10</b>
Main Unit Panel.....	10
Start.....	11
<b>How to Perform Touch Operations.....</b>	<b>12</b>
When Touching.....	12
Searching Items from a List.....	12
<b>Home Screen.....</b>	<b>13</b>
Display Contents.....	13
Switch the Sources.....	14
<b>AV</b>	
<b>Audio Functions</b> .....	<b>15</b>
<b>Basic Operation.....</b>	<b>15</b>
Switch Audio ON/OFF.....	15
Adjust Volume.....	15
Insert/Eject Discs.....	16
Steering Remote Control Switch Operation.....	17
<b>Handling of Discs.....</b>	<b>18</b>
Types of Disc That Can Be Played Back.....	19
<b>Audio Files (MP3/WMA/AAC).....</b>	<b>21</b>
Folder Structure.....	22
What Is MP3?.....	23
What Is WMA?.....	24
What Is AAC?.....	25
<b>Video files (DivX/MP4).....</b>	<b>26</b>
<b>Radio</b> ..... <b>27</b>	
<b>Listen to Radio.....</b>	<b>27</b>
Display Contents.....	27
Register Your Favourite Broadcast Stations.....	28
Search for Broadcast Stations with Strong Signals.....	28
Search for Broadcast Stations from the Station List.....	28
<b>DISC</b> ..... <b>30</b>	
<b>Listen to CDs.....</b>	<b>30</b>
Display a List.....	30
Display Contents.....	31
Switch Playback Mode.....	32
<b>Listen to Audio Files on a Disc.....</b>	<b>33</b>
Display a List.....	33
Display Contents.....	34
Switch Playback Mode.....	36
<b>Watch Movie Files on a Disc.....</b>	<b>37</b>
Display a List.....	37
Display Contents.....	38
<b>Watch DVDs.....</b>	<b>39</b>
Display DVD Operation Screen.....	39
Display Contents.....	40
Select Title Number or Chapter Number.....	41
Change Audio.....	41
Change Subtitles.....	41
Change Display Modes.....	42
Change Angles.....	42
Operate the Menu.....	42
<b>iPod/USB</b> ..... <b>44</b>	
<b>Use an iPod.....</b>	<b>44</b>
Play iPod.....	44
Display Contents.....	45
Switch Playback Mode.....	45
Search by List.....	46
<b>Listen to Audio Files on a USB Device.....</b>	<b>47</b>
Display Contents.....	48
Display a List.....	49
Switch Playback Mode.....	50
<b>External Input Devices</b> ..... <b>51</b>	
<b>Use Bluetooth Audio.....</b>	<b>51</b>
Connect a Bluetooth-capable Audio Device.....	51
Listen to a Bluetooth-capable Audio Device.....	51
Display Contents.....	52
Switch Playback Mode.....	52
<b>Use AUX.....</b>	<b>54</b>
Displaying.....	54
<b>Use HDMI.....</b>	<b>55</b>
Displaying.....	55
<b>Use Rear Display.....</b>	<b>56</b>
Displaying.....	56
<b>INFO/SETTINGS</b>	
<b>INFO</b> .....	<b>57</b>
<b>Mobile Phone.....</b>	<b>57</b>
Connect Your Mobile Phone.....	57
Display the Phonebook.....	58
Dial a Telephone.....	58
Incoming Calls.....	59
<b>Other Info.....</b>	<b>61</b>
Camera.....	61

**SETTINGS 62**

**Adjust the Sound Quality ..... 62**  
Setting Items..... 62  
**System Settings..... 64**  
Beep sound ..... 64  
Display Setting..... 64  
DVD Display Setting ..... 65  
Day/Night Display Setting..... 65  
Clock..... 66  
Language..... 66  
**Other Settings..... 67**  
Display Off ..... 67  
Clock Screen ..... 67  
Bluetooth Setting ..... 67

**Other**

**Troubleshooting ..... 70**  
If This Message Appears..... 70  
If You Think Something Is Not Working Properly..... 71  
MEMO..... 72

# Introduction

The following is what you need to know before using this product.

## Before Use

### Disclaimers

- Mitsubishi Motors will in no way be held responsible for losses resulting from fire, earthquake, tsunami, flood, or other natural disasters; from actions of third parties; from other accidents; or from inappropriate or abnormal usage conditions utilised by the customer, be said conditions deliberate or unintentional.
- There will be no indemnification for alteration or loss of any information stored upon this product by the customer or a third party resulting from improper use of this product, the influence of static electricity or electric noise, or at the time of malfunction or repair or similar circumstances. We recommend that you create backups of important information as a precautionary measure.
- Some personal information (telephone numbers etc.) entered into this product may remain in memory even if this product is removed. The customer is responsible for proper handling and management (including deleting) of personal information to protect privacy when handing this product over to anyone else or disposing of it. Mitsubishi Motors will in no way be held responsible.

- Mitsubishi Motors will in no way be held responsible for any collateral losses (loss of business profits, alteration or loss of recorded data) resulting from the usage or inability to use this product.
- For the purpose of product improvement, specifications and external appearance may be subject to change without advance notice. Accordingly, while the contents of the User Manual may differ, please be aware that returns, refunds, exchange, or conversion are not possible.
- This User Manual explains details for multiple models together. Depending on the model, there may be functions that may be described but not available, or requirements for separately purchased-products. Thank you for your understanding.
- Images and illustrations used in the User Manual are either those used in development, or used for explanations. Please be aware that these may differ from the actual images and illustrations used in the product.
- Please be aware that Mitsubishi Motors, including after-sales service departments, will in no way be held responsible for any losses or detriment resulting from alteration or loss of information stored in this product.

## Important Points on Usage

### Common

- During operation, ensure that the vehicle is not stationary in a garage or other confined area with bad ventilation while the engine is running. Doing so may result in gas poisoning.
- For safety, the driver is not to operate this product while the vehicle is moving. The driver should also minimize as much as possible the time spent viewing the screen. Being distracted by the screen can result in an accident.
- Do not turn the volume up to the extent that you cannot hear sounds from outside the vehicle while driving. Driving without being able to hear sounds from outside the vehicle can result in an accident.
- Do not disassemble or modify the product. This may lead to malfunction, smoking, or fire.
- When operating, ensure that the vehicle is stopped in a safe area in which stopping is permitted.
- Continued usage of this product without the engine running may deplete the vehicle battery, meaning that the engine may not be able to start. Ensure this product is used while the engine is running.

- The following phenomena are characteristic of LCD screens. They do not indicate a malfunction.
  - Small black dots or bright dots (red, blue, green) on the screen.
  - Screen movement is slow during cold weather.
  - The screen is sometimes dark during hot weather.
  - The colour tones and brightness vary with the viewing angle.
- It is a characteristic of LCD screens that the picture quality varies with the viewing angle. When using this product for the first time, adjust the picture quality.
- If you paste an commercially-available LCD protective film or the like on the screen, it may interfere with touch panel operation.
- If you operate the touch panel with a sharp object (pen tip, finger nail, etc.), the screen may be scratched and this unit may be damaged, leading to faulty operation.
- Operating the touch panel with gloves on may cause faulty operation.
- When cleaning the screen, wipe it with a soft cloth. Do not use benzene, paint thinners, anti-static agents, or other chemical wipes. They could scratch the screen.

### iPod/iPhone Playback Function (Option)

- This product supports audio playback from iPod/iPhone devices, however differing versions mean that playback cannot be guaranteed.
- Please be aware that depending on the iPod/iPhone model or version, operation may differ.

### Restrictions on Operations while the Vehicle Is Driving

Some operations are restricted while the vehicle is driving. The driver should refrain from operating this product while the vehicle is moving. First stop the vehicle in a safe location, then operate this product.

### How to Clean

- If the product becomes dirty, wipe with a soft cloth.
- If very dirty, use a soft cloth dipped in neutral detergent diluted in water, and then wrung out. Do not use benzene, thinners, or other chemical wipes. This may harm the surface.

### Trademarks

- Product names and other proper names are the trademarks or registered trademarks of their respective owners.
- Furthermore, even if there is no specific denotation of trademarks or registered trademarks, these are to be observed in their entirety.

**PremiDIA**  
— HD —

"PremiDIA HD" and "PremiDIA WIDE" are trademarks of Mitsubishi Electric Corporation. Trademarks are pending in some regions.

**PremiDIA**  
— WIDE —



Manufactured under license from Dolby Laboratories. Dolby and the double-D symbol are trademarks of Dolby Laboratories.



The Bluetooth® word mark and logos are owned by the Bluetooth SIG, Inc. and any use of such marks by Mitsubishi Motors Corporation is under license. Other trademarks and trade names are those of their respective owners.



DivX®, DivX Certified® and associated logos are trademarks of DivX, LLC and are used under license.

*Continued on the next page*



"Made for iPod," "Made for iPhone" mean that an electronic accessory has been designed to connect specifically to iPod or iPhone, respectively, and has been certified by the developer to meet Apple performance standards.

iPhone, iPod, iPod classic, iPod nano, and iPod touch are trademarks of Apple Inc., registered in the U.S. and other countries.

Apple is not responsible for the operation of this device or its compliance with safety and regulatory standards

\* iPod and iTunes licensing allows individual users to privately reproduce and play back non-copyrighted material as well as material that may be legally copied and reproduced. Infringement of copyright is prohibited.

\* The supported devices for vehicles equipped with a Bluetooth<sup>®</sup> 2.0 interface vary. For details, see the vehicle's user manual.

**iPod**



**iPod**  
5th generation  
(video)  
60GB 80GB



**iPod**  
5th generation  
(video)  
30GB

**iPod classic**



**iPod classic**  
160GB (2009)



**iPod classic**  
160GB (2007)



**iPod classic**  
80GB

**iPod nano**



**iPod nano**  
7th generation  
16GB



**iPod nano**  
6th generation  
8GB 16GB



**iPod nano**  
5th generation (video camera)  
8GB 16GB



**iPod nano**  
4th generation (video)  
8GB 16GB



**iPod nano**  
3rd generation  
(video)  
4GB 8GB



**iPod nano**  
2nd generation  
(aluminum)  
2GB 4GB 8GB



**iPod nano**  
1st generation  
1GB 2GB 4GB

**iPod touch**



**iPod touch**  
4th generation  
8GB 32GB 64GB



**iPod touch**  
3rd generation  
32GB 64GB



**iPod touch**  
2nd generation  
8GB 16GB 32GB



**iPod touch**  
1st generation  
8GB 16GB 32GB



**iPod touch**  
5th generation  
16GB 32GB 64GB

iPhone



iPhone 5  
iPhone 5c iPhone 5s  
16GB 32GB 64GB



iPhone 4S  
16GB 32GB 64GB



iPhone 4  
16GB 32GB



iPhone 3GS  
8GB 16GB 32GB



iPhone 3G  
8GB 16GB



iPhone 6  
16GB 64GB 128GB



iPhone 6 Plus  
16GB 64GB 128GB



## Important Points on Safety for the Customer

This product features a number of pictorial indications as well as points concerning handling so that you can use the product correctly and in a safe manner, as well as prevent injury or damage to yourself, other users, or property.

**⚠ WARNING** This indicates details regarding handling of the product that if ignored, could be expected to result in death or serious injury.

**⚠ CAUTION** This indicates details regarding handling of the product that if ignored, could be expected to result in personal injury or property loss.

### ⚠ WARNING

- **The driver should not pay close attention to the images on the screen while driving.**  
This may prevent the driver looking where they are going, and cause an accident.
- **The driver should not perform complicated operations while driving.**  
Performing complicated operations while driving may prevent the driver looking where they are going, and cause an accident. Therefore stop the vehicle in a safe location before performing such operations.
- **Do not use during malfunctions, such as when the screen does not light up or no sound is audible.**  
This may lead to accident, fire, or electric shock.
- **Ensure water or other foreign objects do not enter the product.**  
This may lead to smoking, fire, electric shock, or malfunction.
- **Do not insert foreign objects into the disc slot.**  
This may lead to fire, electric shock, or malfunction.

### ⚠ WARNING

- **In the event of abnormalities occurring when foreign objects or water enter the product, resulting in smoke or a strange smell, immediately stop using the product, and consult with your dealer.**  
Continuing to use the product may result in accident, fire, or electric shock.
- **Do not disassemble or modify the product.**  
This may lead to malfunction, fire, or electric shock.
- **During thunderstorms, do not touch the antenna or the front panel.**  
This may lead to electrical shock from lightning.

### ⚠ CAUTION

- **Do not block ventilation holes or heat sinks on the product.**  
Blocking ventilation holes or heat sinks may prevent heat from escaping from within the product, leading to fire or malfunction.
- **Do not turn the volume up to the extent that you cannot hear sounds from outside the vehicle while driving.**  
Driving without being able to hear sounds from outside the vehicle may result in an accident.
- **Do not insert your hand or fingers into the disc slot.**  
This may result in injury.



# How to Read This Manual

The notation used in this manual and what it means are as follows.

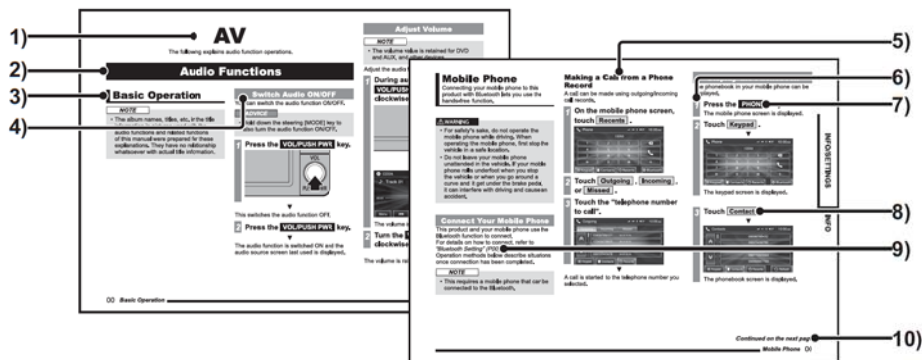

- 1) **Volume Header**  
Classified by main functions.
- 2) **Chapter Header**  
Classifies more finely the main functions in the volume header. A chapter header appears at the head of each chapter. You can also check the index on the right edge.
- 3) **Major Header**  
Classifies the main operations and functions in a chapter.
- 4) **Intermediate Header**  
Classifies the operations and functions under the major header.

- 5) **Minor Header**  
Classifies more finely the operations and functions classified under the intermediate header.
- 6) **Operation procedure**  
These are numbers that shows the operation procedure. Perform the procedure in the order of these numbers.
- 7) **key or key**  
Shows an operation key on the panel.

- 8) **touch switch** or **key**  
Shows a touch switch displayed on the screen.
- 9) **(P000)**  
Shows the page to refer to. It contains relevant explanations etc.
- 10) **Continued on the next page**  
Used when the explanation of operations is continued.

# Basic Operation

## This Product

### Main Unit Panel

This gives the names of each section of the main unit panel and explains their functions.

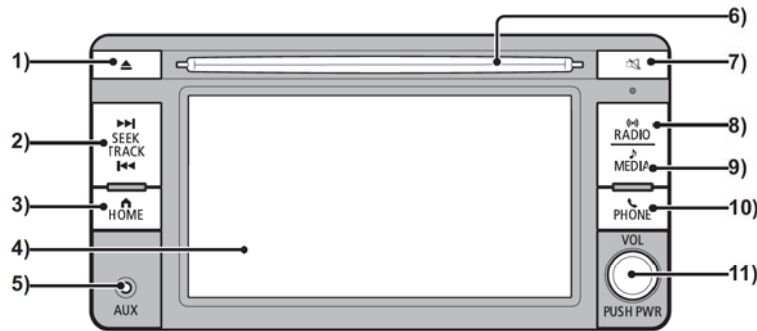

- 1) **▲ key**  
Used to eject a disc (P16).
- 2) **◀◀ SEEK TRACK key / SEEK TRACK ▶▶ key**  
Allows you to seek a radio station, or select a track. Also, holding down either of these keys allows you to fast-forward/fast-rewind a track.
- 3) **HOME key**  
Displays the home screen. → "Home Screen" (P13)

- 4) **Display**  
Almost all operations can be performed by touching the touch switches displayed on this display.  
→ "How to Perform Touch Operations" (P12)
- 5) **AUX**  
Allows you to connect external input devices. → "Use AUX" (P54)
- 6) **Disc slot**  
When a disc is inserted that can be played by this product, starts playback.  
→ "Inserting the Disc" (P16)

- 7) **🔇 key**  
Allows you to mute the audio.
- 8) **RADIO key**  
When the radio screen is displayed, the radio source changes each time the key is pressed.  
When the radio screen is not displayed, the radio screen is displayed.
- 9) **MEDIA key**  
When the media screen is displayed, the media source changes each time the key is pressed.  
When the media screen is not displayed, the media screen is displayed.  
When no media is connected or inserted, this operation becomes invalid.
- 10) **PHONE key**  
Displays the phone menu.  
When the phone has not been registered, the Bluetooth connection setting screen is displayed.
- 11) **VOL/PUSH PWR key**  
Allows you to adjust the volume for the audio function and telephone function.  
It also allows you to switch the audio function ON/OFF. When the audio function is OFF, the clock screen is displayed.  
→ "Adjust Volume" (P15)

**Start**

Start the system.

- 1 Switch the vehicle's ignition key to "ACC" or "ON".**



The display switches to the last screen, the screen for the function used last the previous time.

**ADVICE**

- Immediately after the ignition key is switched to "ACC" or "ON", some functions cannot be used immediately because data is being read in. Please wait until the reading is completed.

## How to Perform Touch Operations

This system uses a touch panel that is operated by touching the display directly.

### When Touching

This manual indicates the operation of touching the screen to "Enter" with "Touch \_\_\_\_\_".

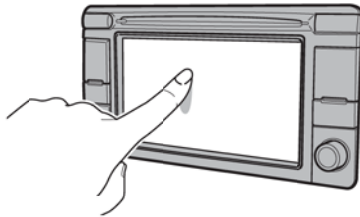



Also, the menu of operations executed by touch is indicated as "Touch Switch".

### CAUTION

- The surface of the display scratches easily. Do not push on it too hard or rub it with a stiff cloth.
- If the screen is dirty, wipe it gently with an eyeglass wipe or other soft cloth.

## Searching Items from a List

You can move the display one page by touching  or .

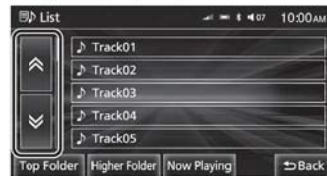

When the item you are searching for is displayed, touch it directly.

## Home Screen

By pressing the [HOME] key to display the home screen, then selecting a source from that menu, you can use various functions.

### Display Contents

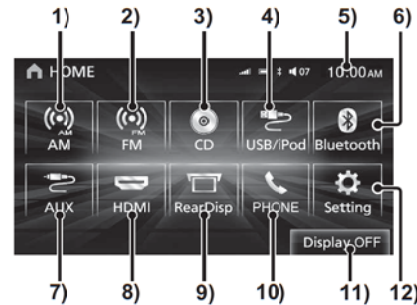

- 1) **AM** (P27)  
Allows you to use the AM radio function.
- 2) **FM** (P27)  
Allows you to use the FM radio function.
- 3) **CD/DVD**  
Plays disc media inserted into this product.  
Audio CD (P30)  
Audio files (MP3/WMA/AAC) (P33)  
DVD (P39)  
Video files(DivX/MP4)(P37)
- 4) **USB/iPod** \*1,\*2  
When an iPod is connected to this product, **iPod** is displayed and when you touch this, the iPod screen is displayed. (P44)  
When a USB device is connected to this product, **USB** is displayed and when you touch this, the USB screen is displayed. (P47)  
When nothing is connected to this product, **USB/iPod** is displayed.
- 5) **Clock**  
Displays the current time using 24-hour time or 12-hour time.→“Clock”(P66)
- 6) **Bluetooth** \*3(P51)  
When a Bluetooth-capable audio device is connected to this product, the Bluetooth audio function can be used.
- 7) **AUX** \*1(P54)  
When an external input device is connected to AUX JACK, the external input device is played.
- 8) **HDMI** \*1,\*2(P55)  
When an external input device is connected with an HDMI, the external input device is played.
- 9) **RearDisp** \*2(P56)  
Plays the audio from the rear display.
- 10) **PHONE** \*4(P57)  
Allows you to make and receive telephone calls.
- 11) **DisplayOFF** (P67)  
Turns off the screen display.
- 12) **Setting** (P62)  
Displays the settings screen, on which you can make various settings for this product.

\*1) This requires an external input device and a cable.

\*2) This is equipment that only some vehicle types have.

\*3) This requires an audio device that is Bluetooth capable (available separately).

\*4) This requires a mobile phone that is Bluetooth capable (available separately).

### Switch the Sources

A source can be selected on the home screen.

#### NOTE

- This manual uses the term “source” as the general name for all audio functions, including radio, CD, etc.

#### 1 Press the **HOME** key.

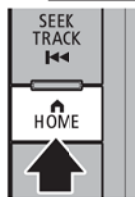

The home screen is displayed.

#### 2 Touch any “source”.



The screen for the selected source is displayed.

#### ADVICE

- [RearDisp] is displayed only when the rear display is connected.
- The contents of the menu depend on the model and on what optional equipment is connected.



# AV

The following explains audio function operations.

## Audio Functions

### Basic Operation

#### NOTE

- The album names, titles, etc. in the title information in pictures used with the audio functions and related functions of this manual were prepared for these explanations. They have no relationship whatsoever with actual title information.

### Switch Audio ON/OFF

You can switch the audio function ON/OFF.

#### ADVICE

- Hold down the steering [MODE] key to also turn the audio function ON/OFF.

- 1 Press the **VOL/PUSH PWR** key.



This switches the audio function OFF.

- 2 Press the **VOL/PUSH PWR** key.

The audio function is switched ON and the audio source screen last used is displayed.

### Adjust Volume

#### NOTE

- The volume value is retained for DVD and AUX, and other devices.

Adjust the audio function volume.

- 1 During audio play, turn the **VOL/PUSH PWR** key counter-clockwise.



The volume is lowered.

- 2 Turn the **VOL/PUSH PWR** key clockwise.

The volume is raised.

### Insert/Eject Discs

The following explains how to insert a disc into this product.

#### **CAUTION**

- When replacing discs, first ensure that the vehicle is stopped in an area in which stopping is permitted.
- Do not insert your hand, fingers, or foreign objects into the disc slot. This may lead to injury, smoking, or fire.

### Ejecting the Disc

- 1 Press the  key.



This will eject the disc from the product, so remove the disc.

### Inserting the Disc

- 1 Insert the disc into the disc slot with the label surface up.

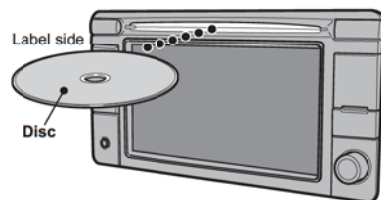

Push the disc in a certain amount, and the product will pull the disc in.



Playback starts.

## Steering Remote Control Switch Operation

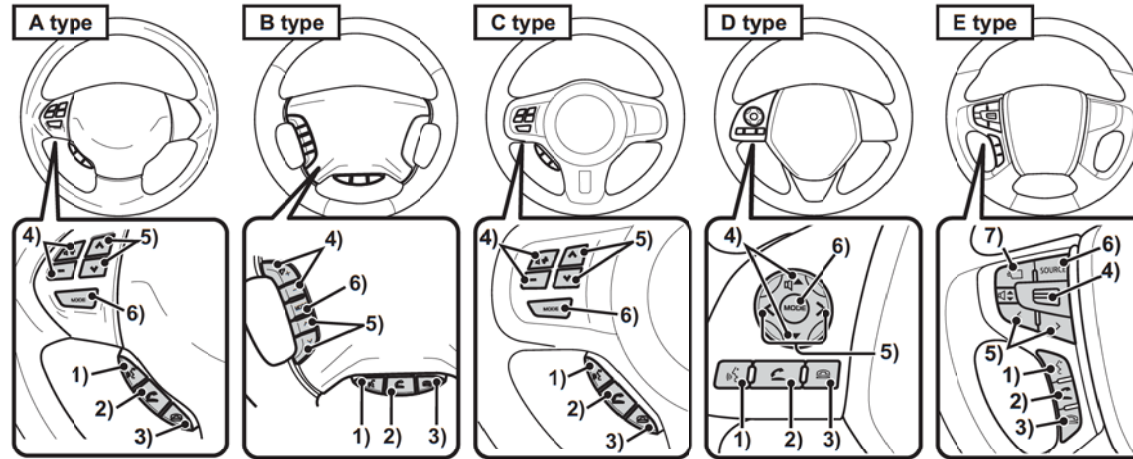

- 1) **“SPEECH” key**<sup>\*1</sup>  
Do not use.
- 2) **“OFF HOOK” key**<sup>\*1</sup>  
Used to receive a telephone call.
- 3) **“ON HOOK” key**<sup>\*1</sup>  
Used to end a telephone call.
- 4) **Vol + , - key / ▲ , ▼ key**  
Adjust audio functions and the telephone function volume.
- 5) **CH ▼ , ▲ key / ◀ , ▶ key**  
Select CD and other audio source tracks and radio stations.  
Hold down for fast forward and rewind.

- 6) **MODE key/ SOURCE key**  
Hold down to turn the audio function ON/OFF. Additionally, each time this is pressed, this switches the audio source. The order of switching is as shown below. If devices are not connected, then these are to be skipped, and the next source selected.  
[AM]→[FM]→[DISC]→[iPod]  
or[USB device]→[Bluetooth  
Audio]→[AUX]→[HDMI]→[Rear  
Display]→[AM]→\_\_\_

- 7) **CAMERA key**<sup>\*1</sup>  
Allows you to display the picture from the camera or switch the picture mode.  
<sup>\*1</sup>) This is equipment that only some vehicle types have.